

B2541 SERIES

2.54mm pitch board to board connector

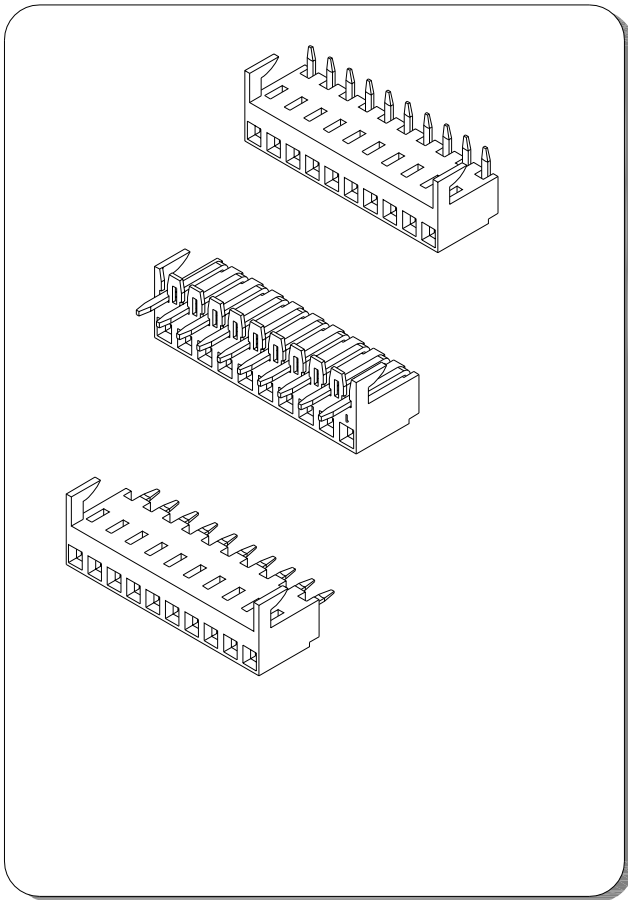

Specifications

- Current rating: 2.5A AC, DC
- Voltage rating: 250V AC, DC
- Temperature range: -40°C ~ +105°C
- Contact resistance: 20mΩ Max.
- Insulation resistance: 100MΩ Min.
- Withstanding voltage: 500V AC/minute
- *Compliant with RoHS and REACH*
- *Meet the HF/Halogen Free need to customize*
- *Contact for details*

Standards



Assembly layout

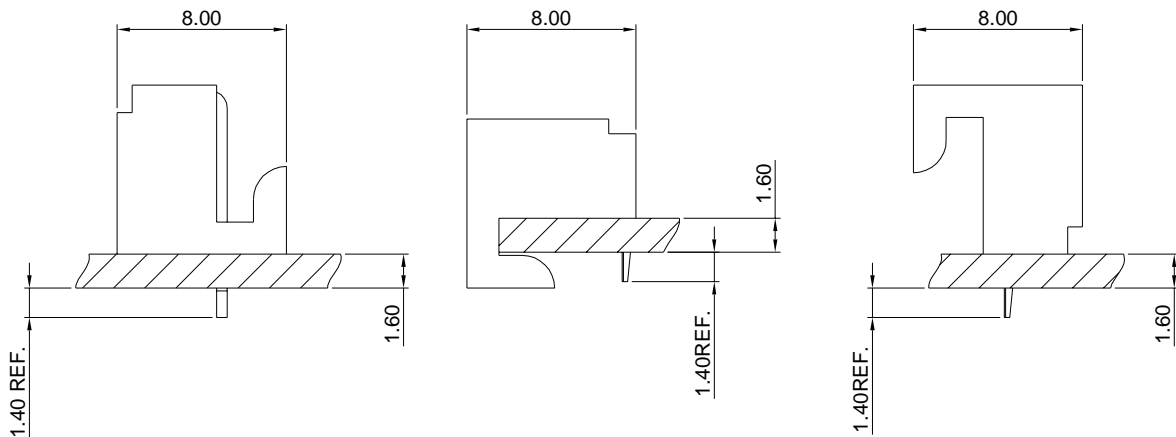

B2541 SERIES

2.54mm pitch board to board connector

B2541AW

2.54mm Pitch Bottom Entry Housing

Reference Informations:

- *Material:Nylon 66,UL94V-0
- *Mates with A2541 A2543 series Wafer
- *Color:Natural

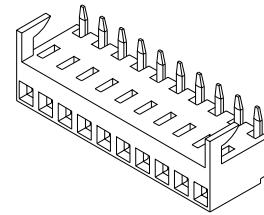
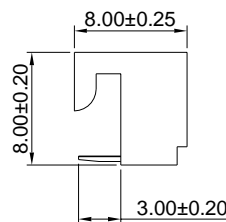
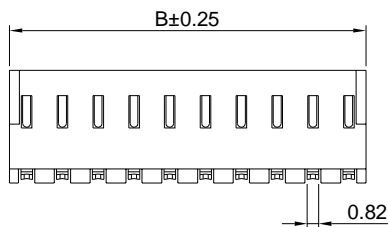
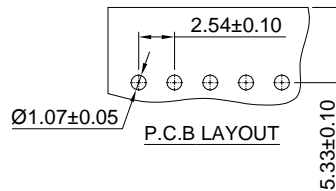
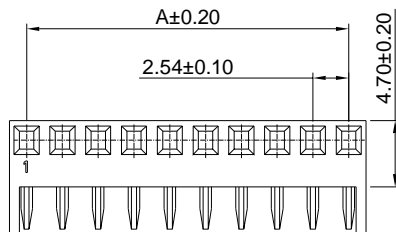

Ordering Information & Dimensions:

PART NO.	Dimensions	
	A	B
B2541AW-2P	2.54	4.98
B2541AW-3P	5.08	7.52
B2541AW-4P	7.62	10.06
B2541AW-5P	10.16	12.60
B2541AW-6P	12.70	15.14
B2541AW-7P	15.24	17.68
B2541AW-8P	17.78	20.22
B2541AW-9P	20.32	22.76
B2541AW-10P	22.86	25.30
B2541AW-11P	25.40	27.84
B2541AW-12P	27.94	30.38
B2541AW-13P	30.48	32.92
B2541AW-14P	33.02	35.46
B2541AW-15P	35.56	38.00
B2541AW-16P	45.72	48.16

Unit: mm

B2541BW

2.54mm Pitch Bottom Entry Housing

Reference Informations:

- *Material:Nylon 66,UL94V-0
- *Mates with A2541 A2543 series Wafer
- *Color:Natural

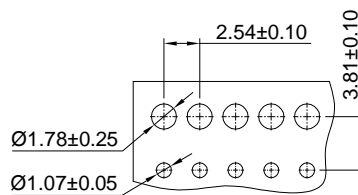
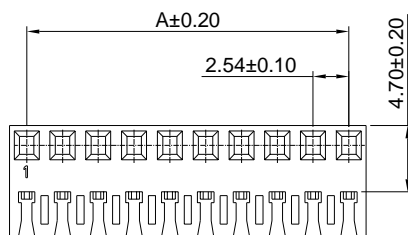

P.C.B LAYOUT

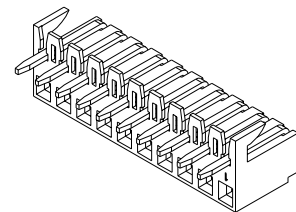
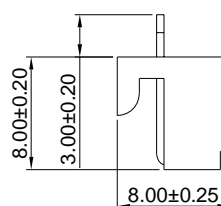
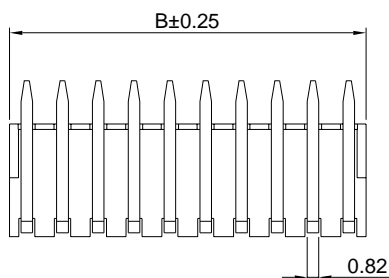

Ordering Information & Dimensions:

PART NO.	Dimensions	
	A	B
B2541BW-2P	2.54	4.98
B2541BW-3P	5.08	7.52
B2541BW-4P	7.62	10.06
B2541BW-5P	10.16	12.60
B2541BW-6P	12.70	15.14
B2541BW-7P	15.24	17.68
B2541BW-8P	17.78	20.22
B2541BW-9P	20.32	22.76
B2541BW-10P	22.86	25.30
B2541BW-11P	25.40	27.84
B2541BW-12P	27.94	30.38
B2541BW-13P	30.48	32.92
B2541BW-14P	33.02	35.46
B2541BW-15P	35.56	38.00
B2541BW-16P	45.72	48.16

Unit: mm

B2541 SERIES

2.54mm pitch board to board connector

B2541CW

2.54mm Pitch Bottom Entry Housing

Reference Informations:

- *Material: Nylon 66, UL94V-0
- *Mates with A2541 A2543 series Wafer
- *Color: Natural

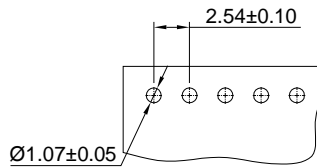
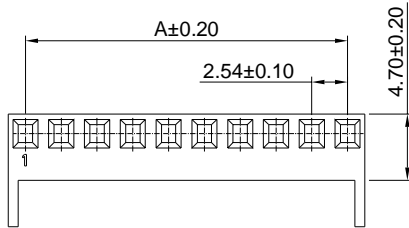
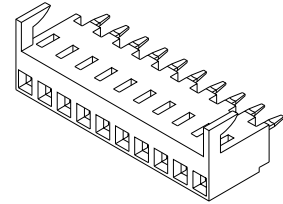

P.C.B LAYOUT

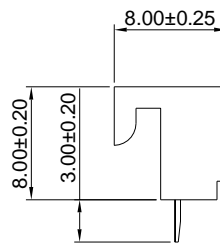
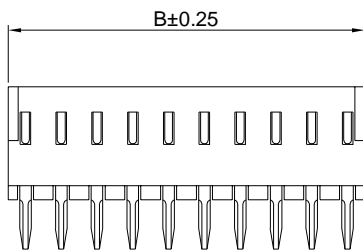

Ordering Information & Dimensions:

PART NO.	Dimensions	
	A	B
B2541CW-2P	2.54	4.98
B2541CW-3P	5.08	7.52
B2541CW-4P	7.62	10.06
B2541CW-5P	10.16	12.60
B2541CW-6P	12.70	15.14
B2541CW-7P	15.24	17.68
B2541CW-8P	17.78	20.22
B2541CW-9P	20.32	22.76
B2541CW-10P	22.86	25.30
B2541CW-11P	25.40	27.84
B2541CW-12P	27.94	30.38
B2541CW-13P	30.48	32.92
B2541CW-14P	33.02	35.46
B2541CW-15P	35.56	38.00
B2541CW-16P	45.72	48.16

Unit: mm