

C6201 SERIES

6.20mm pitch wire to wire and wire to board connector

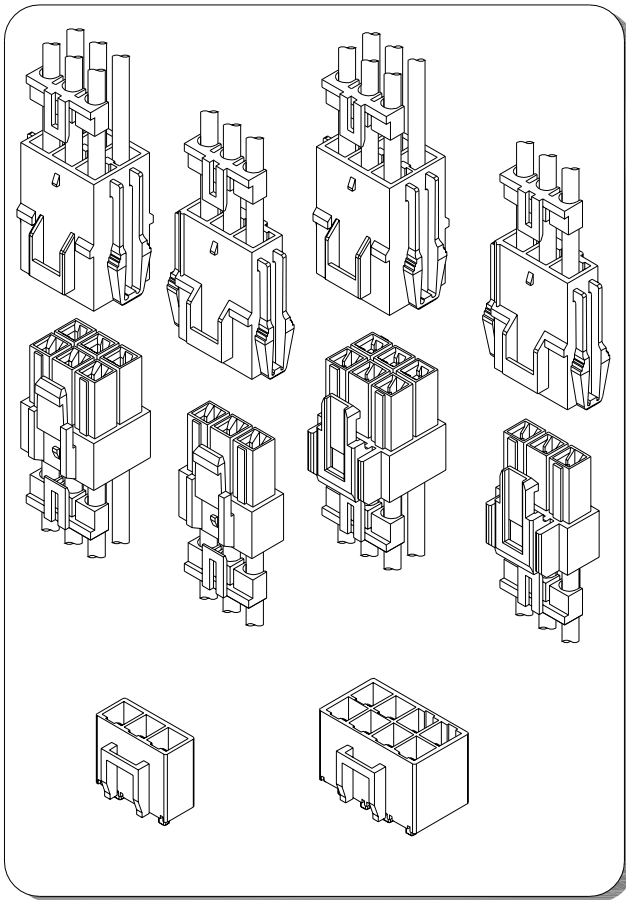

Specifications

- Current rating: 20A AC, DC
- Voltage rating: 600V AC, DC
- Temperature range: -40°C ~ +105°C
- Contact resistance: 7mΩ Max.
- Insulation resistance: 1000MΩ Min.
- Withstanding voltage: 2000V AC/minute
- *Compliant with RoHS and REACH*
- *Meet the HF/Halogen Free, GWT/Glow wire Test (IEC60335-1) request, need to customize*
- *Contact for details*

Standards



Assembly layout

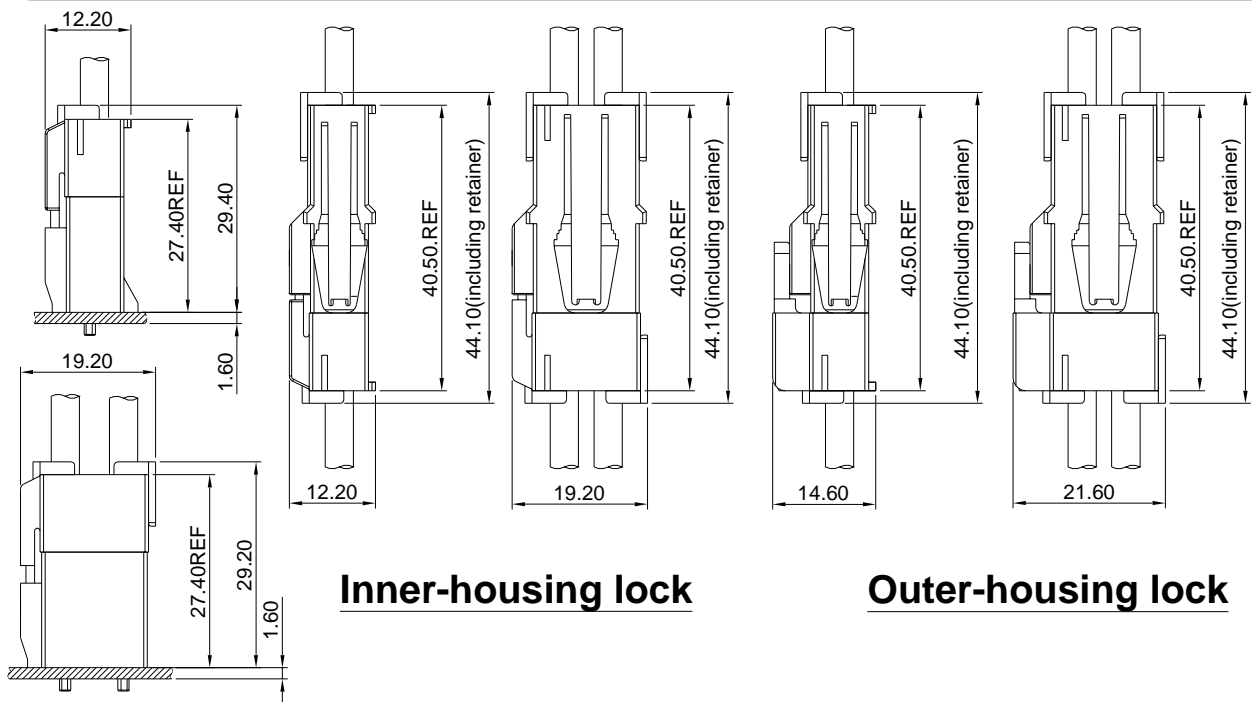

C6201 SERIES

6.20mm pitch wire to wire and wire to board connector

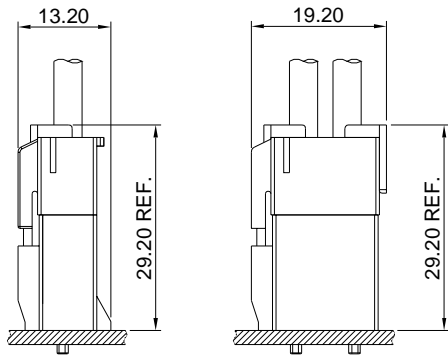

Inner-housing lock

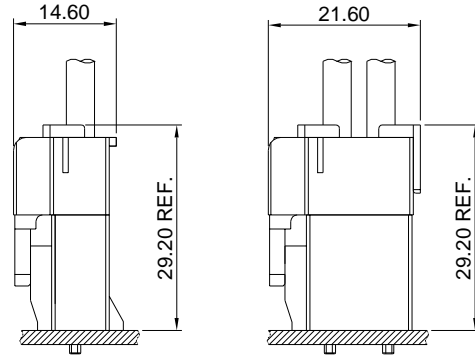

Outer-housing lock

Panel hole layout

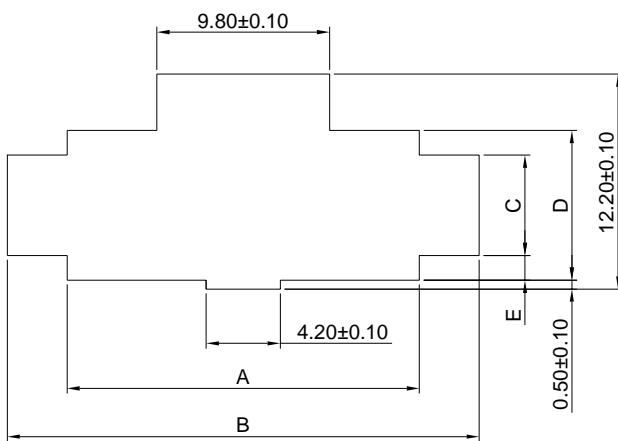

Shape I

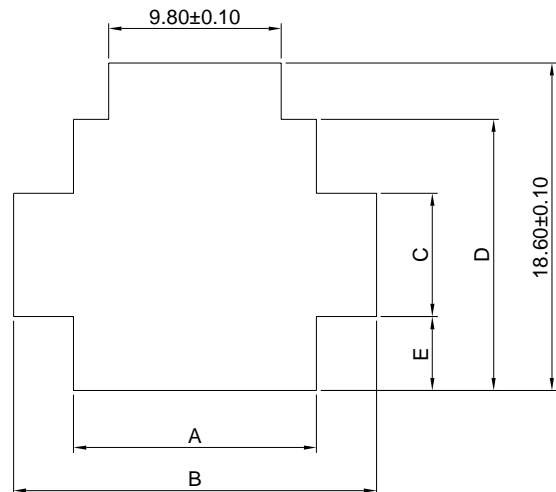

Shape II

PART NO.	Panel hole shape	Panel hole Dimensions					applicable panel thickness (mm)
		A	B	C	D	E	
C6201HM-2P	I	13.80	20.60	5.70	8.50	1.40	0.5-2.0
C6201HM-3P	I	20.00	26.80	5.70	8.50	1.40	
C6201HM-4P	I	26.20	33.00	5.70	8.50	1.40	
C6201HM-2X2P	II	13.80	20.60	7.00	15.40	4.20	
C6201HM-2X3P	II	20.00	26.80	7.00	15.40	4.20	
C6201HM-2X4P	II	26.20	33.00	7.00	15.40	4.20	
C6201HM-2X6P	II	38.90	45.40	7.00	15.40	4.20	

- Note: 1. Punch holes in the panel according to the sketch and table shown above. Burrs must be removed
 2. The strength of the panel must be considered when punching two or more holes.
 3. The connector must be inserted from the same side as the hole is punched

C6201 SERIES

6.20mm pitch wire to wire and wire to board connector

C6201H

6.20mm Pitch Housing

Reference Informations:

*Material:Housing:Nylon 66,UL94V-0
Retainer:Nylon 66,UL94V-0

*Suitable C6201 series Terminal

*Color:White

Ordering Information:

C6201S-XP - **
1 2

1.Part No.

2.Color:
(blank):Blue
IV:Ivory

C6201HM	C6201HF<HFA>	Retainer
<p><u>C6201HM-1P</u></p>	<p><u>C6201HF-1P</u></p>	<p><u>C6201S-1P</u></p>
<p><u>C6201HM-2P</u></p>	<p><u>C6201HF-2P</u></p>	<p><u>C6201S-2P</u></p>
<p><u>C6201HMA-2P</u></p>	<p><u>C6201HFA-2P</u></p>	

C6201 SERIES

6.20mm pitch wire to wire and wire to board connector

C6201H

6.20mm Pitch Housing

Reference Informations:

- *Material:Housing:Nylon 66,UL94V-0
Retainer:Nylon 66,UL94V-0
- *Suitable C6201 series Terminal
- *Color:White

Ordering Information:

- C6201S-XP - **
1 2
- 1.Part No.
 - 2.Color:
(blank):Blue
IV:Ivory

C6201HM	C6201HF<HFA>	Retainer
<p><u>C6201HM-1P</u></p>	<p><u>C6201HF-1P</u></p>	<p><u>C6201S-1P</u></p>
<p><u>C6201HM-2P</u></p>	<p><u>C6201HF-2P</u></p>	<p><u>C6201S-2P</u></p>
<p><u>C6201HMA-2P</u></p>	<p><u>C6201HFA-2P</u></p>	

C6201 SERIES

6.20mm pitch wire to wire and wire to board connector

C6201H

6.20mm Pitch Housing

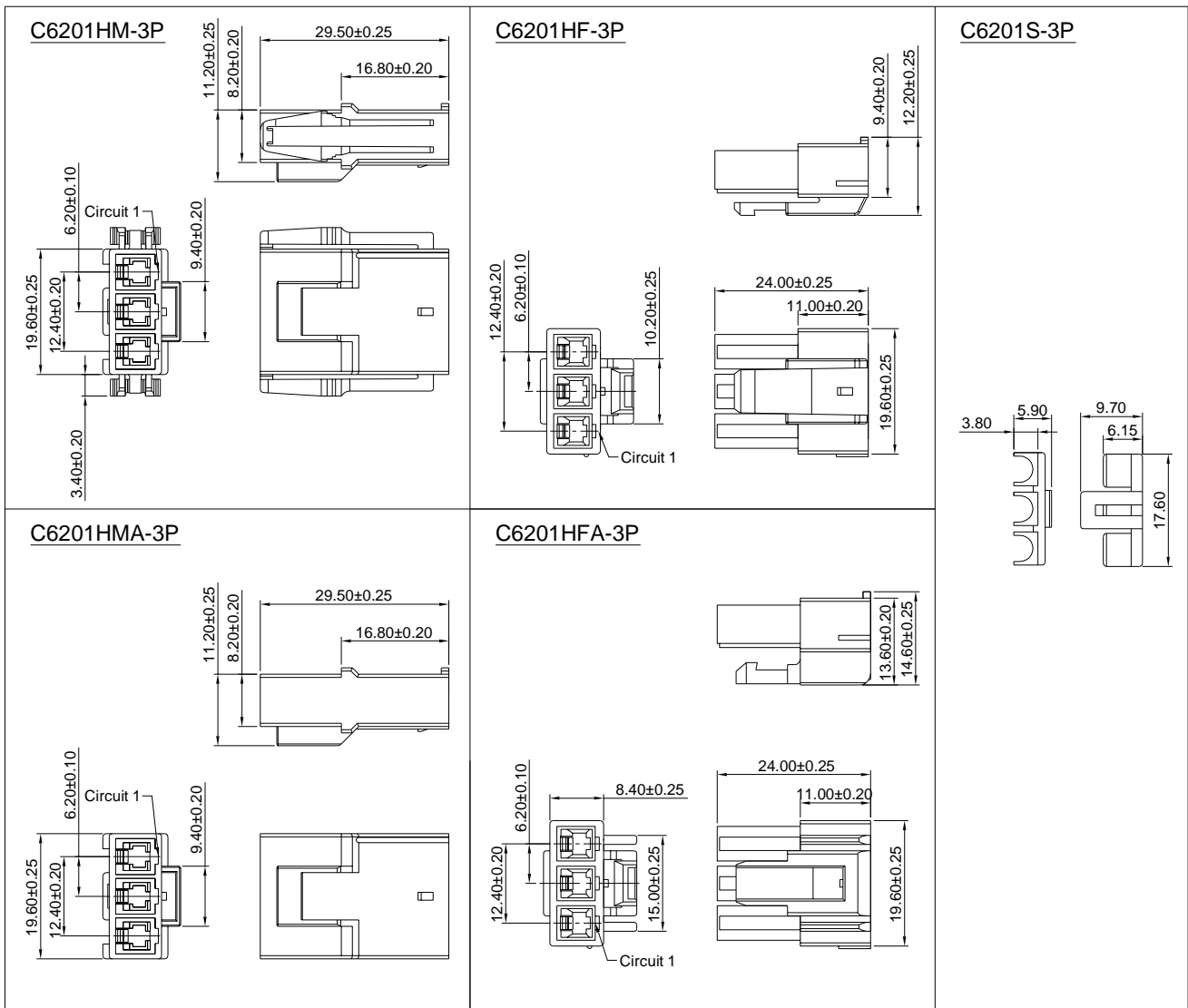

C6201 SERIES

6.20mm pitch wire to wire and wire to board connector

C6201H

6.20mm Pitch Housing

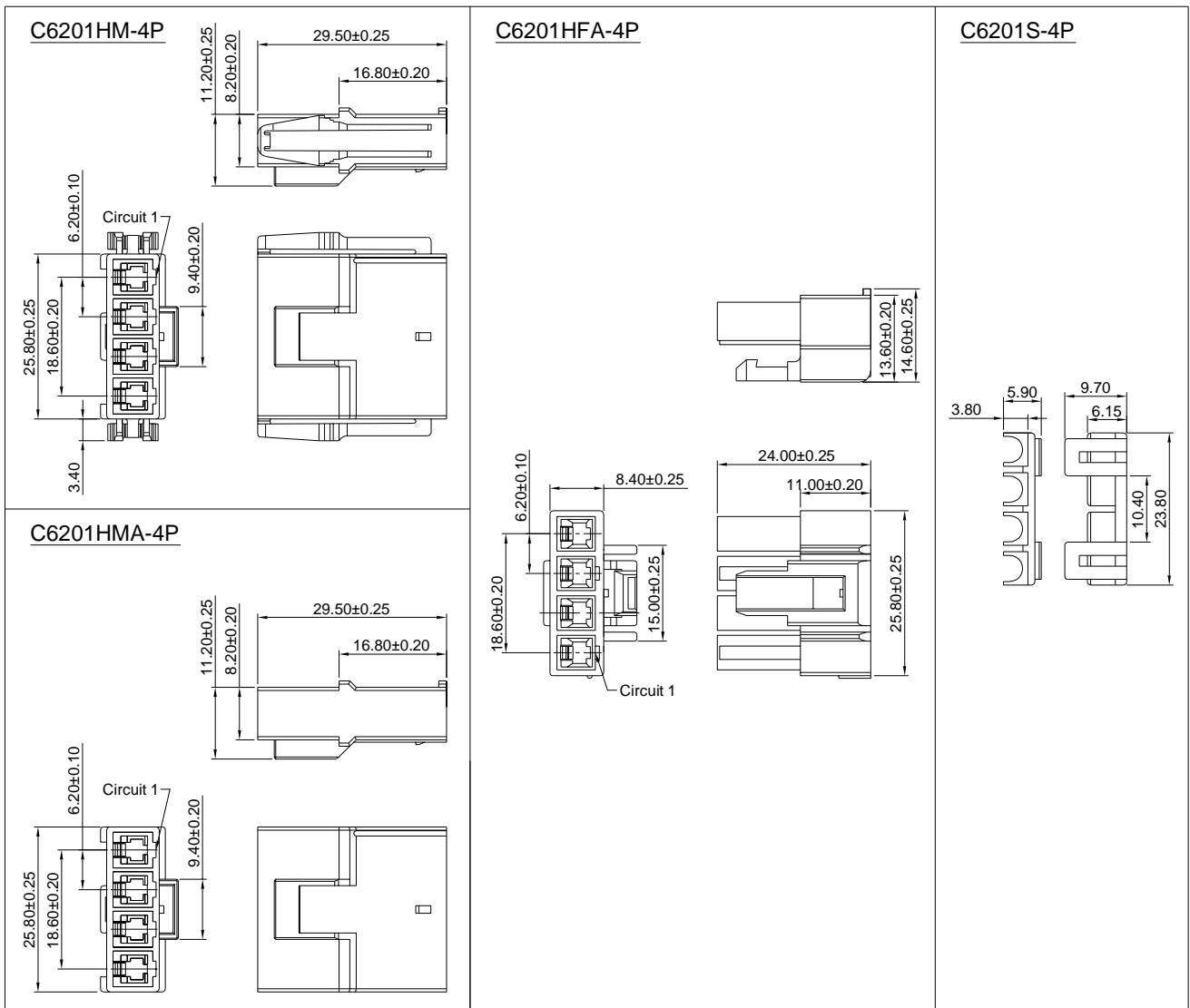

C6201 SERIES

6.20mm pitch wire to wire and wire to board connector

C6201H

6.20mm Pitch Housing

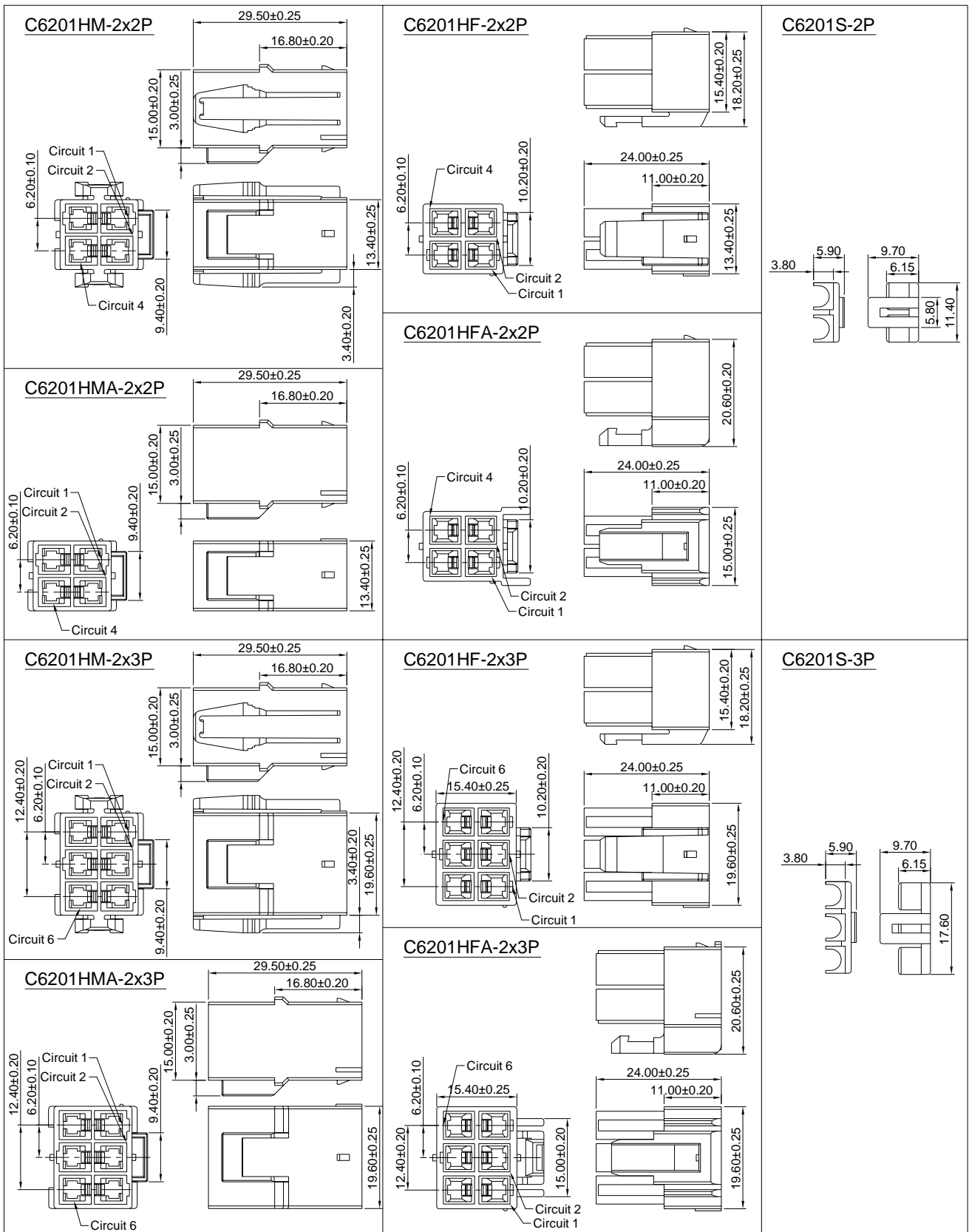

C6201 SERIES

6.20mm pitch wire to wire and wire to board connector

C6201H

6.20mm Pitch Housing

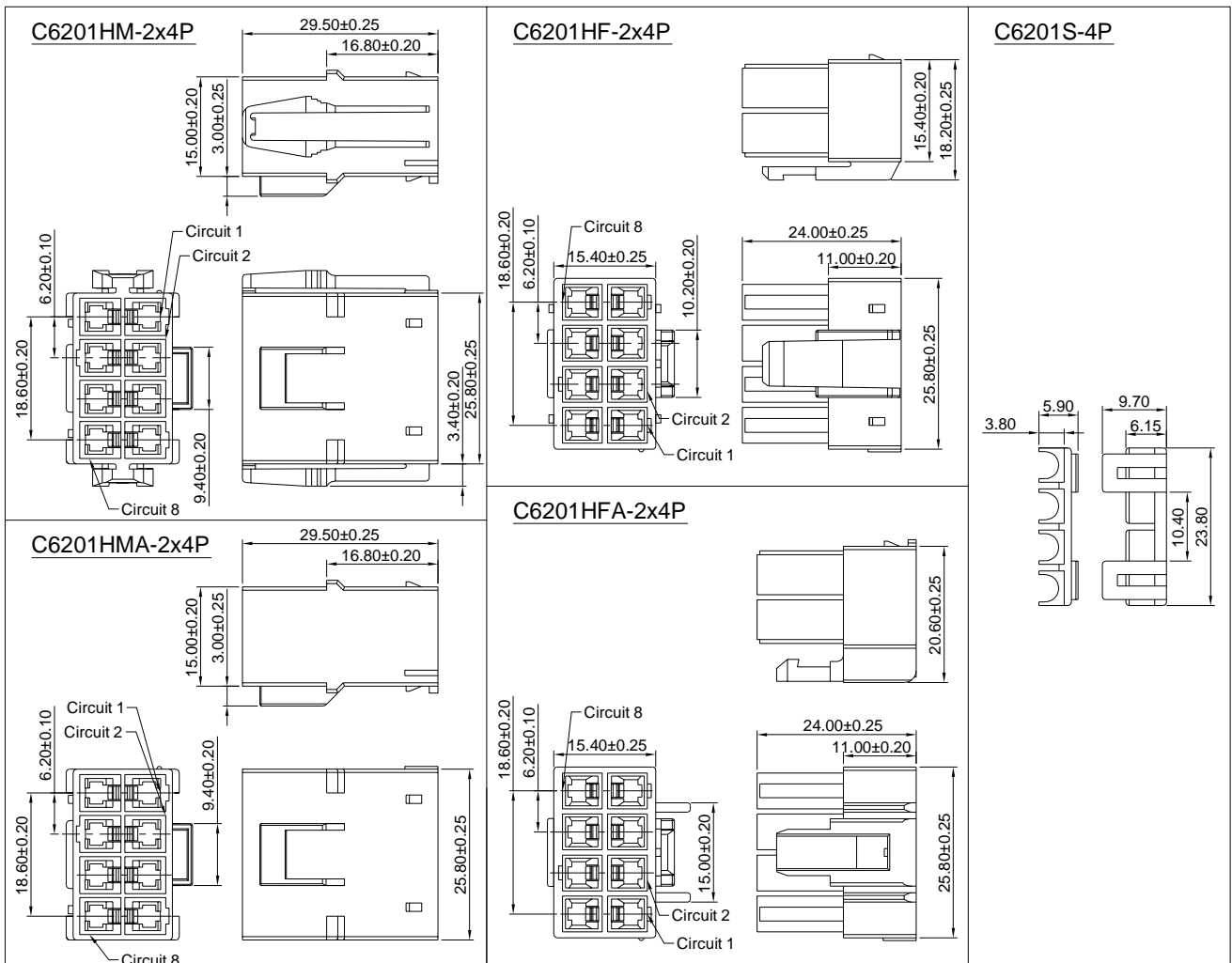

C6201 SERIES

6.20mm pitch wire to wire and wire to board connector

C6201H

6.20mm Pitch Housing

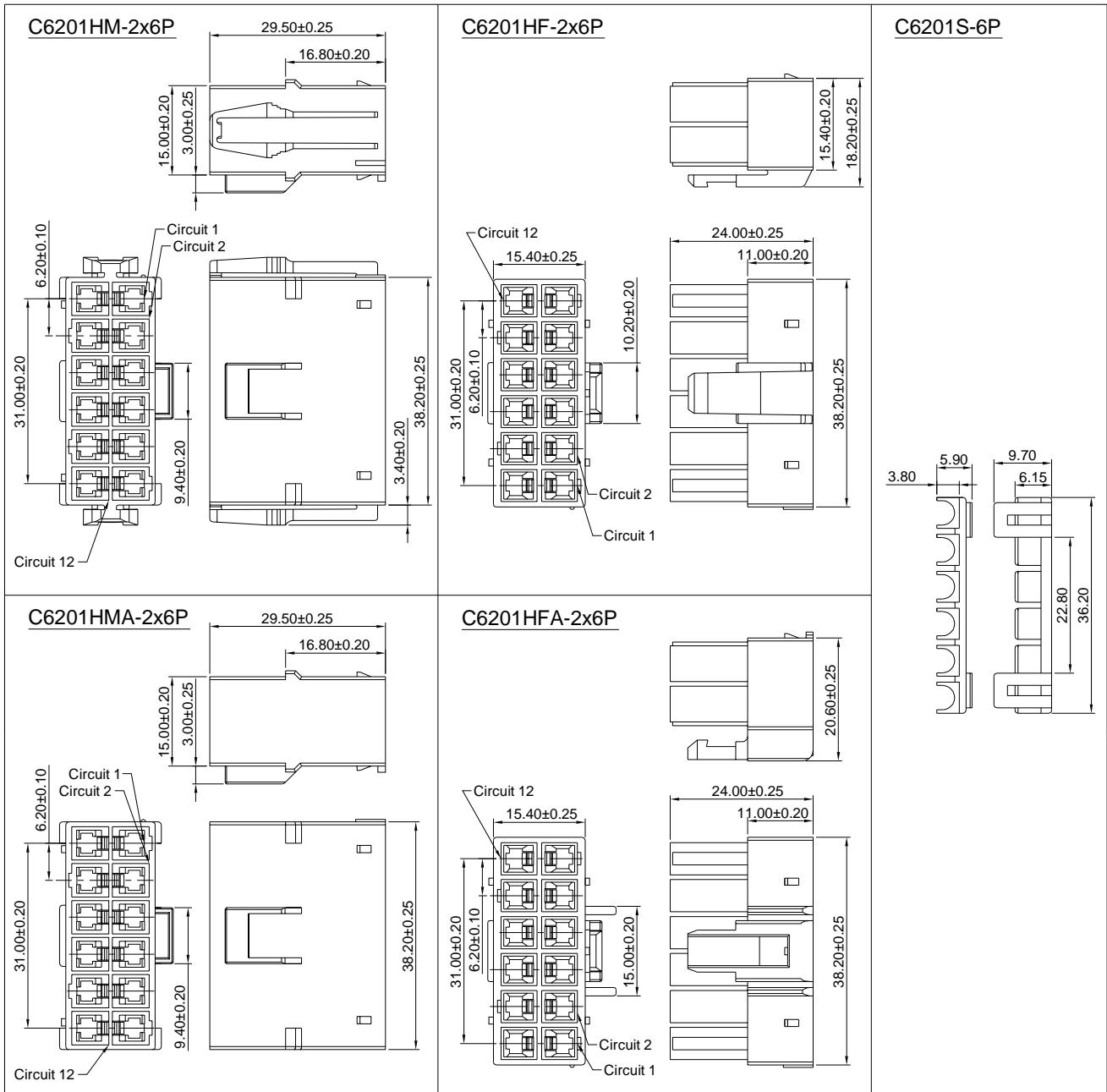

C6201 SERIES

6.20mm pitch wire to wire and wire to board connector

C6201WV

6.20mm pitch 180° Single Row Wafer

Reference Informations:

- *Material: Pin: Brass/Tin over Nickel
Insulator: Nylon66, UL94V-0
- *Mates with C6201HF series single row Housing
- *Color: White

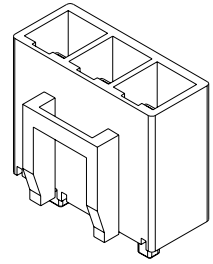
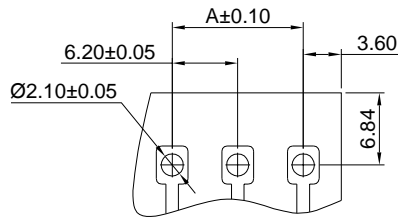
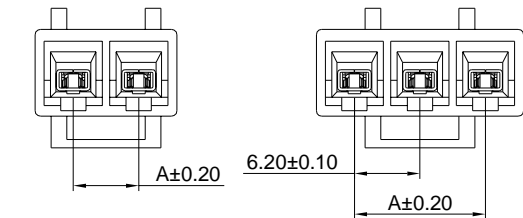

P.C.B LAYOUT

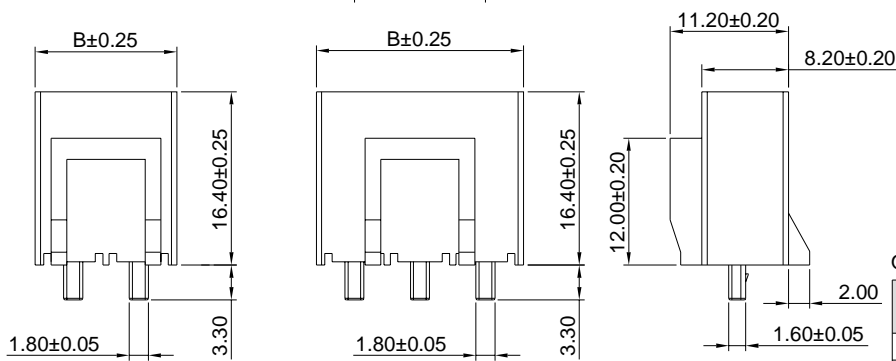

C6201WV-2P

C6201WV-3P

Ordering Information & Dimensions:

PART NO.	Dimensions	
	A	B
C6201WV-2P	6.20	13.40
C6201WV-3P	12.40	19.60
C6201WV-4P	18.60	25.80

Unit:mm

C6201WV-2

6.20mm pitch 180° Dual Row Wafer

Reference Informations:

- *Material: Pin: Brass/Tin over Nickel
Insulator: Nylon66, UL94V-0
- *Mates with CJT C6201HF series dual row Housing
- *Color: White

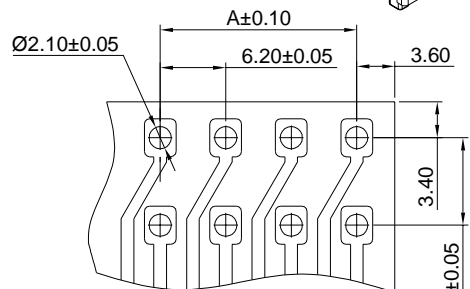
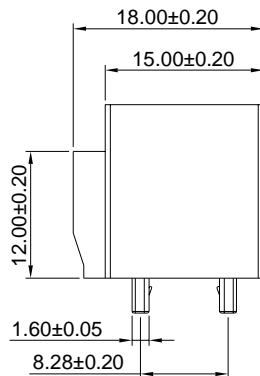
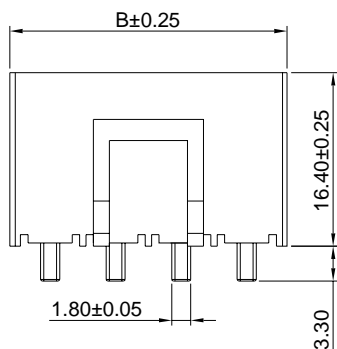
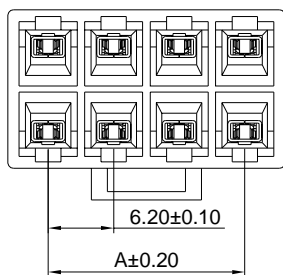

P.C.B LAYOUT

Ordering Information & Dimensions:

PART NO.	Dimensions	
	A	B
C6201WV-2X2P	6.20	13.40
C6201WV-2X3P	12.40	19.60
C6201WV-2X4P	18.60	25.80
C6201WV-2X6P	31.00	38.20

Unit: mm