

C5030 SERIES

5.03mm pitch wire to wire and wire to board connector

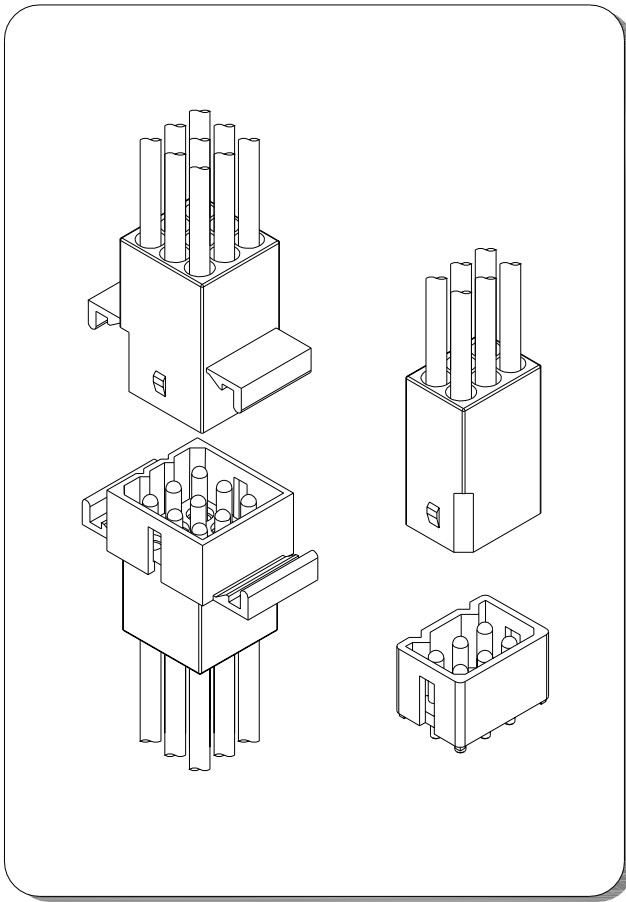

Specifications

- Current rating:12A AC,DC
- Voltage rating:250V AC,DC
- Temperature range:-40°C~+105°C
- Contact resistance:10mΩ Max.
- Insulation resistance:1000MΩ Min.
- Withstanding voltage:1500V AC/minute
- *Compliant with RoHS and REACH*
- *Meet the HF/Halogen Free,GWT/Glow wire Test (IEC60335-1) request,need to customize*
- *Contact for details*

Standards



Assembly layout

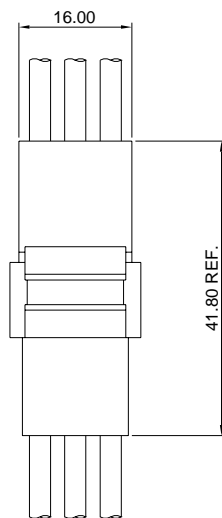

wire to wire

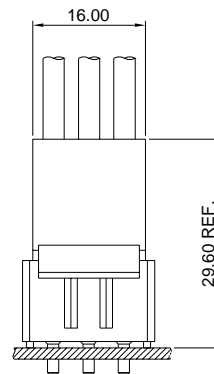

wire to board

C5030 SERIES

5.03mm pitch wire to wire and wire to board connector

C5030F-T

5.03mm pitch Crimp Terminal

Reference Informations:

*Used in C5030HF C5030HM series Housing

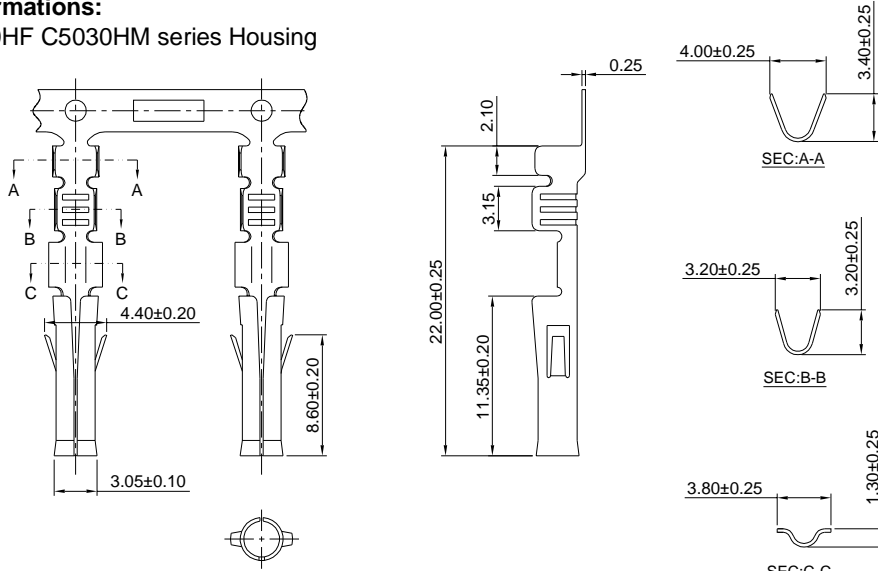

Ordering information & Specifications:

Unit:mm

Part NO.	Wire Range	Insulation O.D.	Material	Finish	Qty/reel
C5030F-TB	AWG#18-#24	3.10mm(max)	Brass	Tin over Nickel	5,000 PCS
C5030F-TP	AWG#18-#24	3.10mm(max)	Phosphor Bronze	Tin over Nickel	5,000 PCS
C5030F-GB	AWG#18-#24	3.10mm(max)	Brass	Gold over Nickel	5,000 PCS
C5030F-GP	AWG#18-#24	3.10mm(max)	Phosphor Bronze	Gold over Nickel	5,000 PCS

Optional Gold plating available but MOQ requested

C5030M-T

5.03mm pitch Crimp Terminal

Reference Informations:

*Used in C5030HM C5030HF series Housing

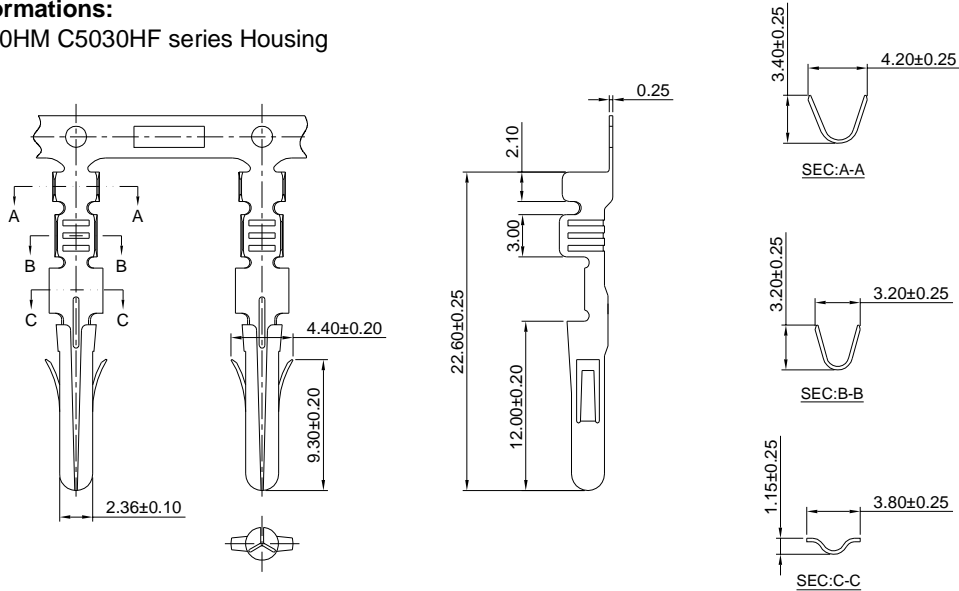

Ordering information & Specifications:

Unit:mm

Part NO.	Wire Range	Insulation O.D.	Material	Finish	Qty/reel
C5030M-TB	AWG#18-#24	3.10mm(max)	Brass	Tin over Nickel	5,000 PCS
C5030M-TP	AWG#18-#24	3.10mm(max)	Phosphor Bronze	Tin over Nickel	5,000 PCS
C5030M-GB	AWG#18-#24	3.10mm(max)	Brass	Gold over Nickel	5,000 PCS
C5030M-GP	AWG#18-#24	3.10mm(max)	Phosphor Bronze	Gold over Nickel	5,000 PCS

Optional Gold plating available but MOQ requested

C5030 SERIES

5.03mm pitch wire to wire and wire to board connector

C5030F-T-H

5.03mm pitch Crimp Terminal

Reference Informations:

*Used in C5030HF C5030HM series Housing

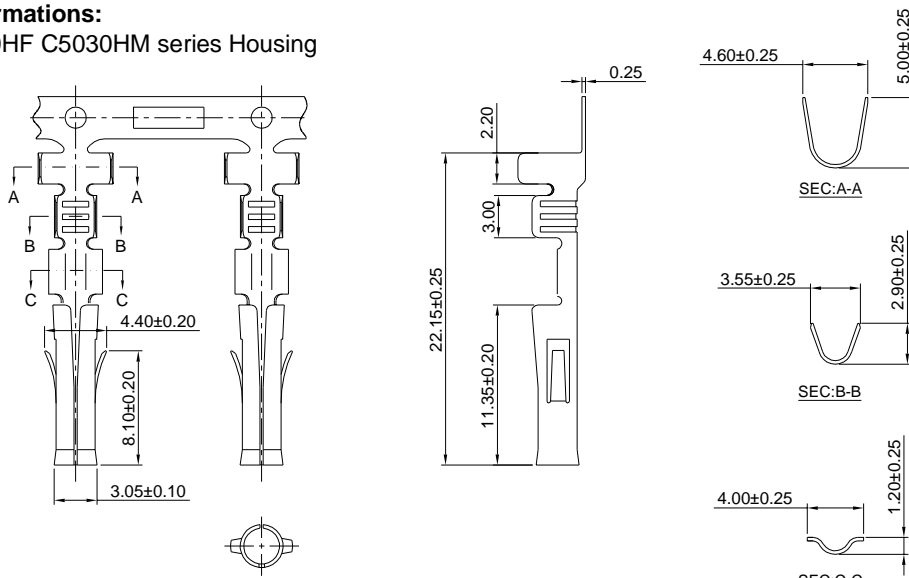

Ordering information & Specifications:

Unit:mm

Part NO.	Wire Range	Insulation O.D.	Material	Finish	Qty/reel
C5030F-TB-H	AWG#14-#20	4.10mm(max)	Brass	Tin over Nickel	5,000 PCS
C5030F-TP-H	AWG#14-#20	4.10mm(max)	Phosphor Bronze	Tin over Nickel	5,000 PCS
C5030F-GB-H	AWG#14-#20	4.10mm(max)	Brass	Gold over Nickel	5,000 PCS
C5030F-GP-H	AWG#14-#20	4.10mm(max)	Phosphor Bronze	Gold over Nickel	5,000 PCS

Optional Gold plating available but MOQ requested

C5030M-T-H

5.03mm pitch Crimp Terminal

Reference Informations:

*Used in C5030HM C5030HF series Housing

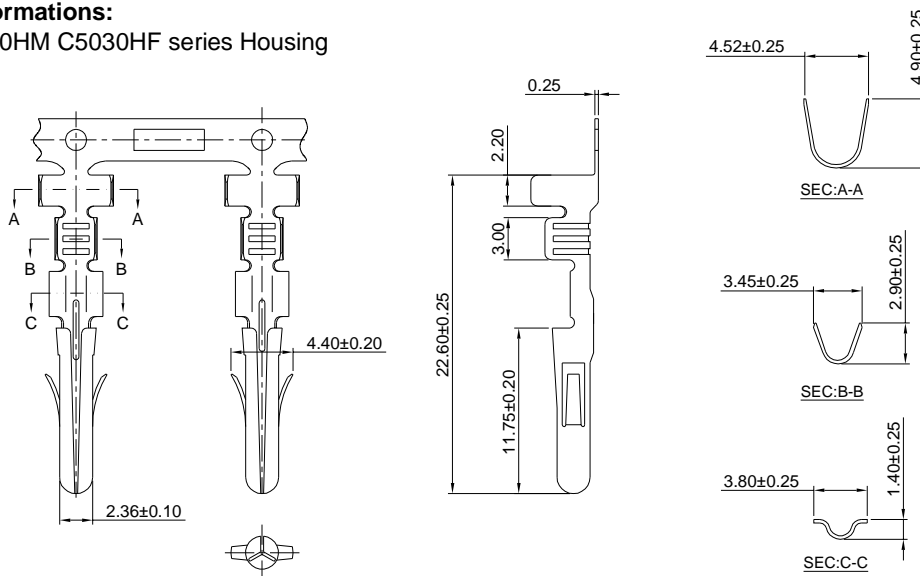

Ordering information & Specifications:

Unit:mm

Part NO.	Wire Range	Insulation O.D.	Material	Finish	Qty/reel
C5030M-TB-H	AWG#14-#20	4.10mm(max)	Brass	Tin over Nickel	5,000 PCS
C5030M-TP-H	AWG#14-#20	4.10mm(max)	Phosphor Bronze	Tin over Nickel	5,000 PCS
C5030M-GB-H	AWG#14-#20	4.10mm(max)	Brass	Gold over Nickel	5,000 PCS
C5030M-GP-H	AWG#14-#20	4.10mm(max)	Phosphor Bronze	Gold over Nickel	5,000 PCS

Optional Gold plating available but MOQ requested

C5030 SERIES

5.03mm pitch wire to wire and wire to board connector

C5030H

5.03mm Pitch Housing

Reference Informations:

*Material: Nylon 66, UL94V-2

*Suitable C5030F(H) and C5030M(H) series Terminal

*Color: Natural

Unit: mm

C5030HF	C5030HM
<p>C5030HF-1P</p>	<p>C5030HM-1P</p>
<p>C5030HF-2P</p>	<p>C5030HM-2P</p>
<p>C5030HF-3P</p>	<p>C5030HM-3P</p>
<p>C5030HF-4P</p>	<p>C5030HM-4P</p>

C5030 SERIES

5.03mm pitch wire to wire and wire to board connector

C5030H

5.03mm Pitch Housing

Reference Informations:

*Material: Nylon 66, UL94V-2

*Suitable C5030F(H) and C5030M(H) series Terminal

*Color: Natural

Unit: mm

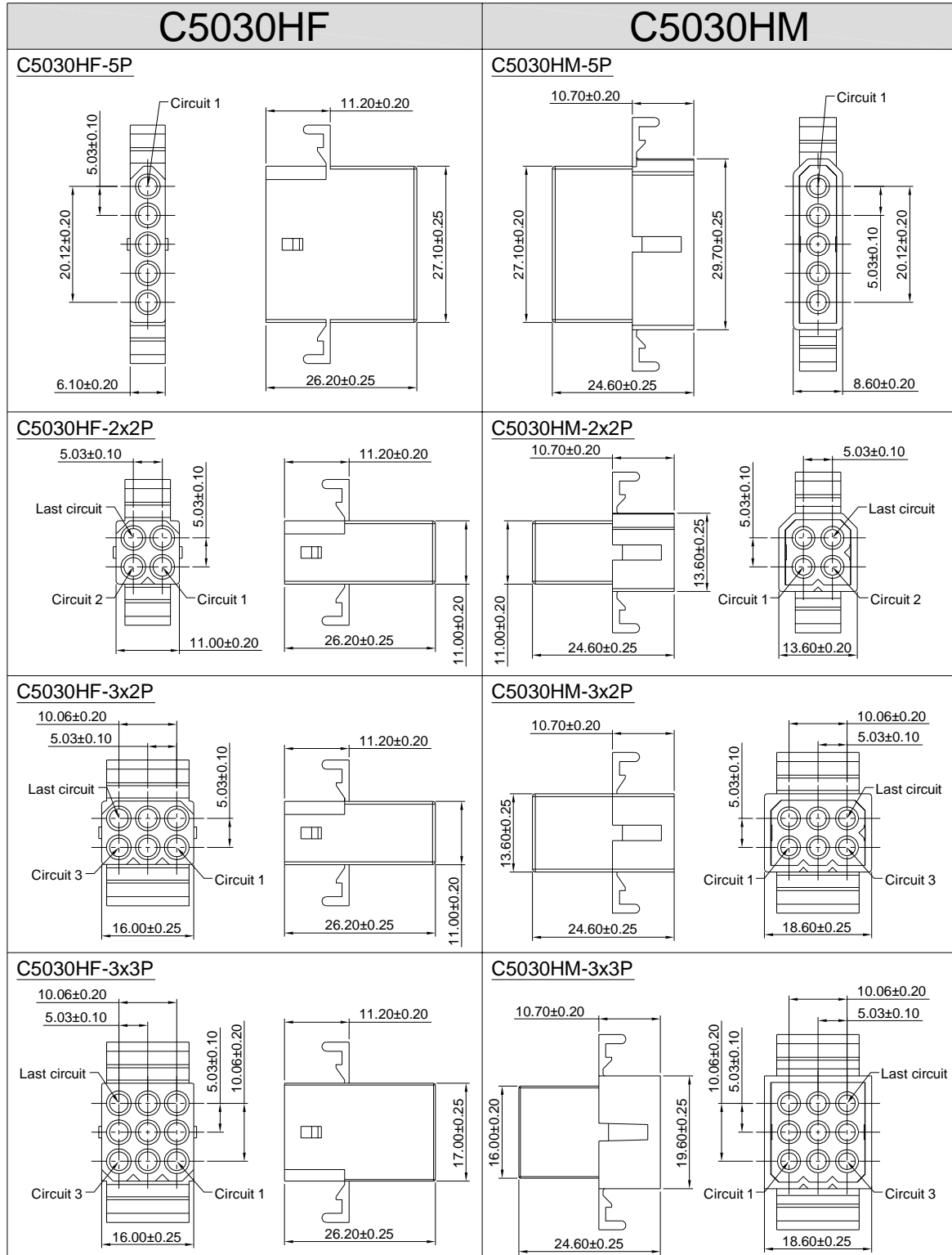

C5030 SERIES

5.03mm pitch wire to wire and wire to board connector

C5030H

5.03mm Pitch Housing

Reference Informations:

*Material:Nylon 66,UL94V-2

*Suitable C5030F(H) and C5030M(H) series Terminal

*Color:Natural

Unit: mm

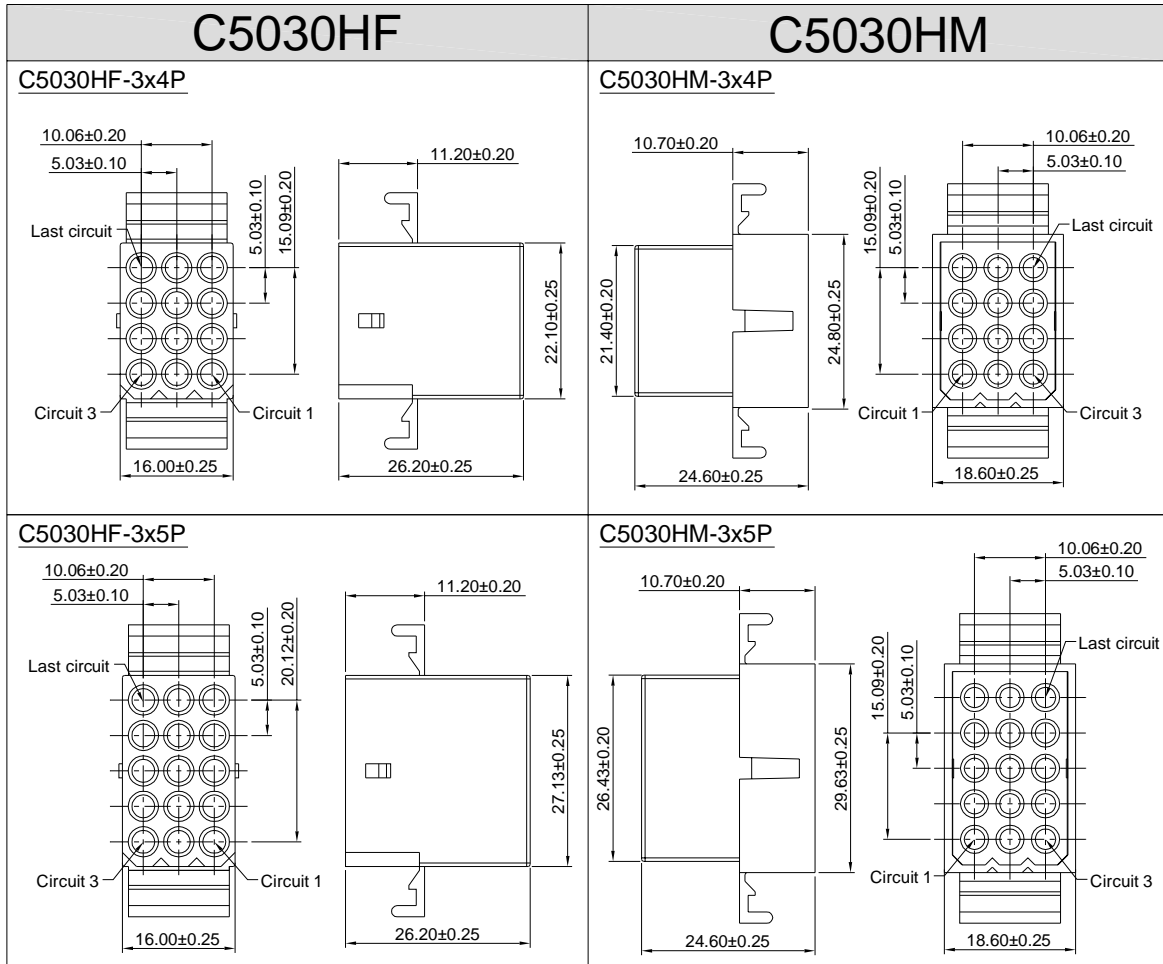

C5030 SERIES

5.03mm pitch wire to wire and wire to board connector

C5030H

5.03mm Pitch Housing

Reference Informations:

*Material: Nylon 66, UL94V-2

*Suitable C5030F(H) and C5030M(H) series Terminal

*Color: Natural

Unit: mm

C5030HFA	C5030HMA
<p>C5030HFA-2P</p>	<p>C5030HMA-2P</p>
<p>C5030HFA-3P</p>	<p>C5030HMA-3P</p>
<p>C5030HFA-4P</p>	<p>C5030HMA-4P</p>
<p>C5030HFA-5P</p>	<p>C5030HMA-5P</p>

C5030 SERIES

5.03mm pitch wire to wire and wire to board connector

C5030H

5.03mm Pitch Housing

Reference Informations:

*Material: Nylon 66, UL94V-2

*Suitable C5030F(H) and C5030M(H) series Terminal

*Color: Natural

Unit: mm

C5030HFA	C5030HMA
<p>C5030HFA-2x2P</p>	<p>C5030HMA-2x2P</p>
<p>C5030HFA-3x2P</p>	<p>C5030HMA-3x2P</p>
<p>C5030HFA-3x3P</p>	<p>C5030HMA-3x3P</p>
<p>C5030HFA-3x4P</p>	<p>C5030HMA-3x4P</p>

C5030 SERIES

5.03mm pitch wire to wire and wire to board connector

C5030H

5.03mm Pitch Housing

Reference Informations:

*Material:Nylon 66,UL94V-2

*Suitable C5030F(H) and C5030M(H) series Terminal

*Color:Natural

Unit: mm

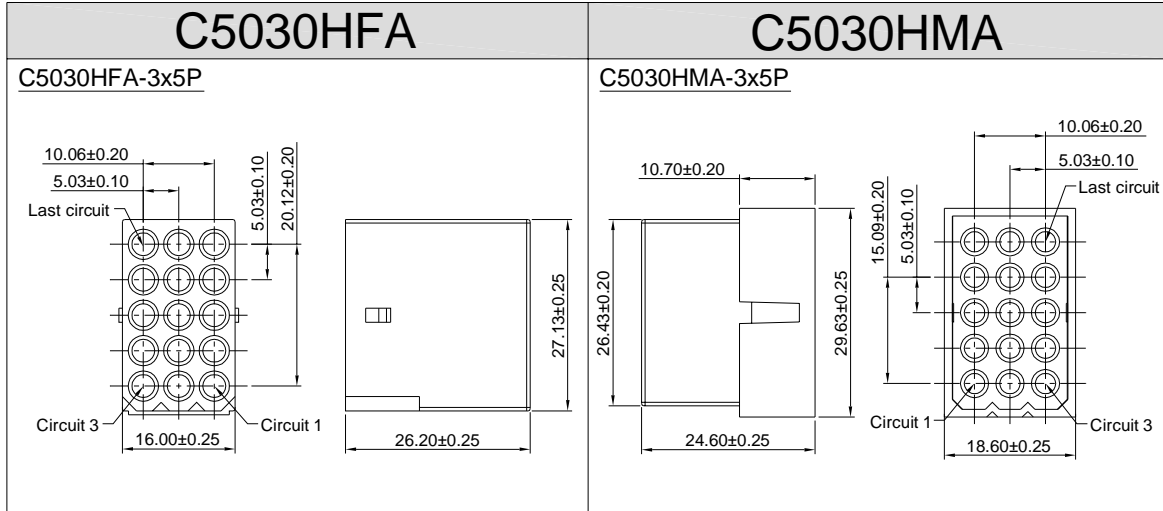

C5030 SERIES

5.03mm pitch wire to wire and wire to board connector

C5030WV-3x2P

5.03mm Pitch Triple Row Wafer

Reference Informations:

- *Material:Pin:Brass/Gold over Nickel
Insulator:Nylon 66,UL94V-2
- *Mates with C5030HF-3x2P,C5030HFA-3x2P Housing
- *Color:Natural

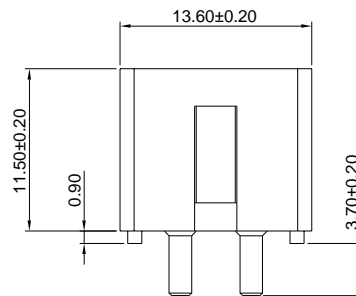
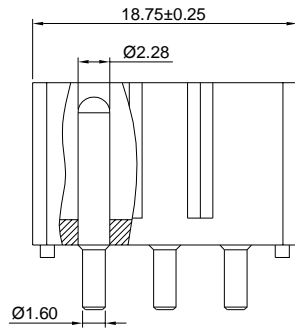
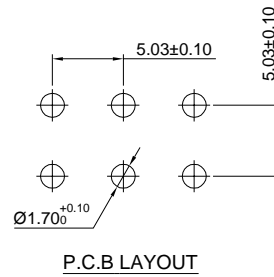
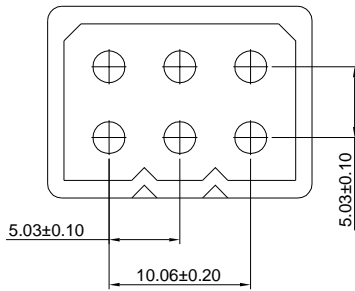
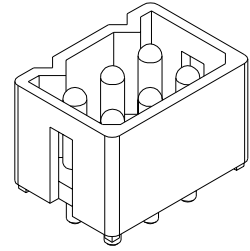

Unit: mm