

A1255 SERIES

1.25mm pitch wire to board connector

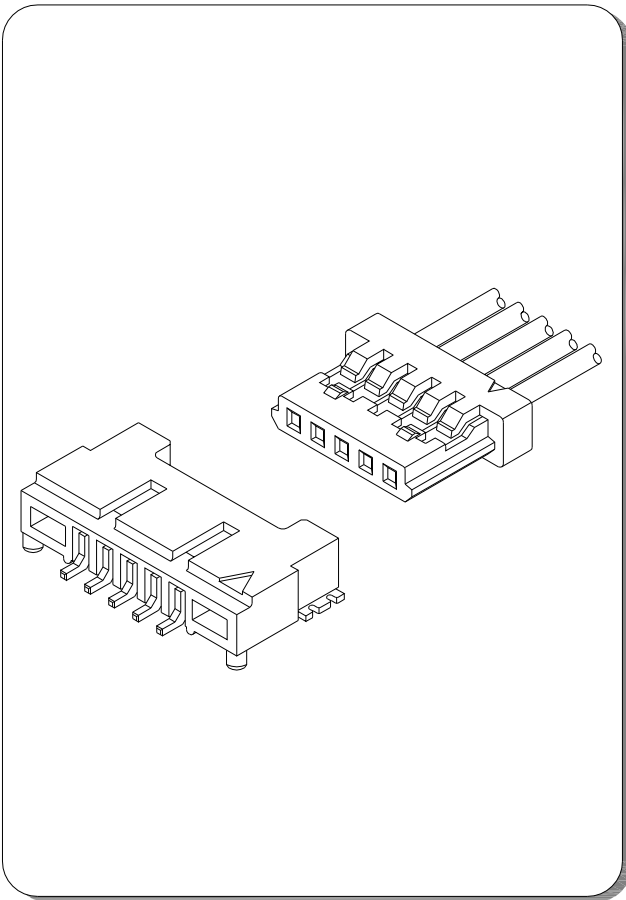

Specifications

- Current rating: 1A AC, DC
- Voltage rating: 150V AC, DC
- Temperature range: -40°C ~ +105°C
- Contact resistance: 30mΩ Max.
- Insulation resistance: 500MΩ Min.
- Withstanding voltage: 500V AC/minute
- *Compliant with RoHS and REACH*
- *Meet the HF/Halogen Free, need to customize*
- *Contact for details*

Standards



Assembly layout

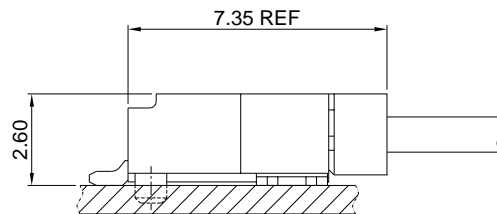
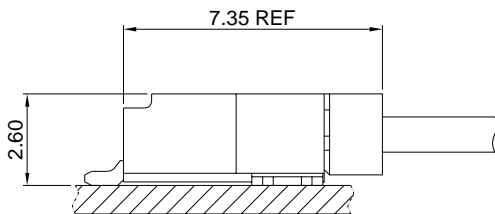

A1255 SERIES

1.25mm pitch wire to board connector

A1255-T

1.25mm pitch Crimp Terminal

Reference Informations:

*Used in A1255 series Housing

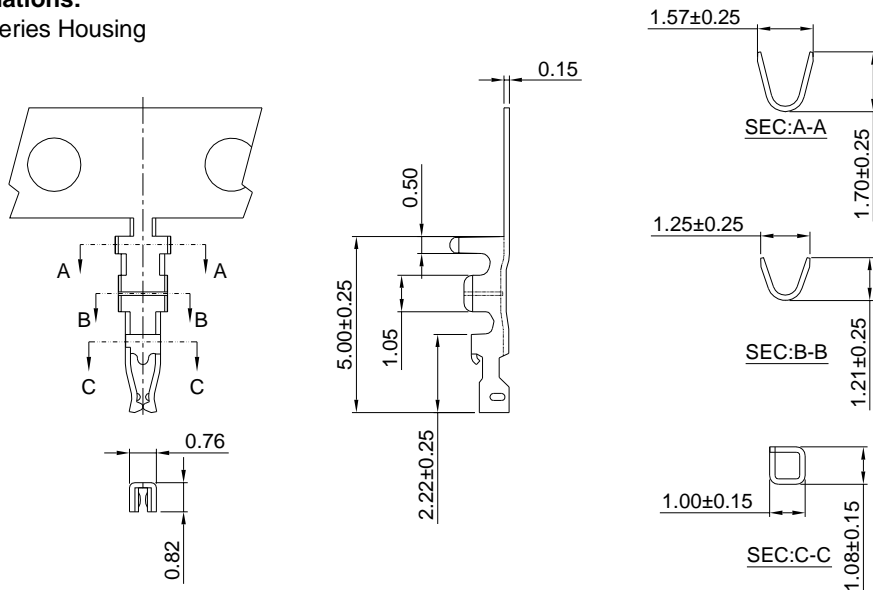

Ordering information & Specifications:

Unit:mm

Part NO.	Wire Range	Insulation O.D.	Material	Finish	Qty/reel
A1255-TP	AWG#26-#32	1.00mm(max)	Phosphor Bronze	Tin over Nickel	10,000 PCS
A1255-GP	AWG#26-#32	1.00mm(max)	Phosphor Bronze	Gold over Nickel	10,000 PCS

Optional Gold plating available but MOQ requested

A1255-T-A

1.25mm pitch Crimp Terminal

Reference Informations:

*Used in A1255A series Housing

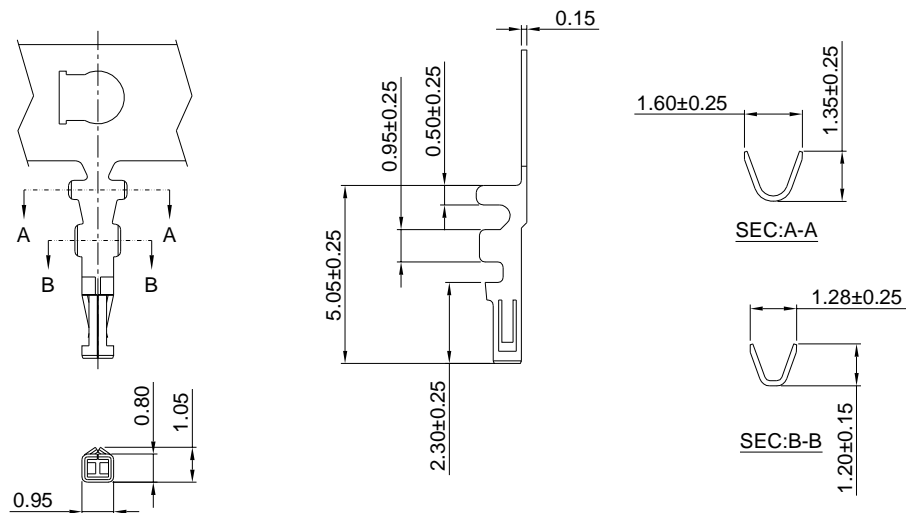

Ordering information & Specifications:

Unit:mm

Part NO.	Wire Range	Insulation O.D.	Material	Finish	Qty/reel
A1255-TP-A	AWG#28-#32	0.90mm(max)	Phosphor Bronze	Tin over Nickel	15,000 PCS
A1255-GP-A	AWG#28-#32	0.90mm(max)	Phosphor Bronze	Gold over Nickel	15,000 PCS

Optional Gold plating available but MOQ requested

A1255 SERIES

1.25mm pitch wire to board connector

A1255H

1.25mm pitch Housing

Reference Informations:

- *Material:Nylon 66,UL94V-0
- *Suitble A1255 series Terminal
- *Mates with A1255 series Wafer
- *Color:Gray

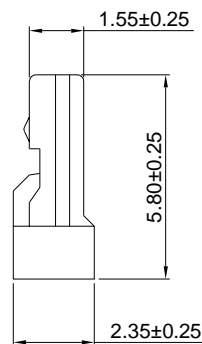
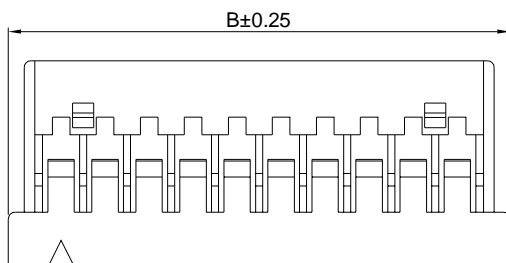
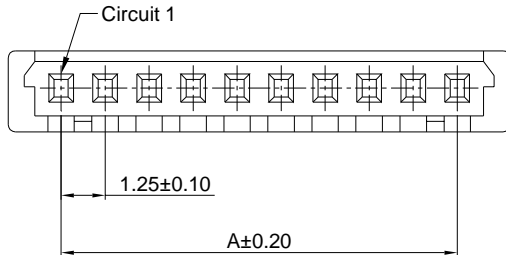
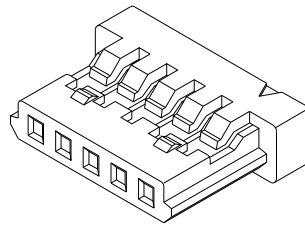

Ordering Information & Dimensions:

PART NO.	Dimensions	
	A	B
A1255H-2P	1.25	4.35
A1255H-3P	2.50	5.60
A1255H-4P	3.75	6.85
A1255H-5P	5.00	8.10
A1255H-6P	6.25	9.35
A1255H-7P	7.50	10.60
A1255H-8P	8.75	11.85
A1255H-9P	10.00	13.10
A1255H-10P	11.25	14.35
A1255H-11P	12.50	15.60
A1255H-12P	13.75	16.85
A1255H-13P	15.00	18.10
A1255H-14P	16.25	19.35
A1255H-15P	17.50	20.60
A1255H-20P	23.75	26.85
A1255H-25P	30.00	33.10
A1255H-30P	36.25	39.35

Unit: mm

A1255HA

1.25mm pitch Housing

Reference Informations:

- *Material:Nylon 66,UL94V-0
- *Suitble A1255-A series Terminal
- *Mates with A1255 series Wafer
- *Color:White

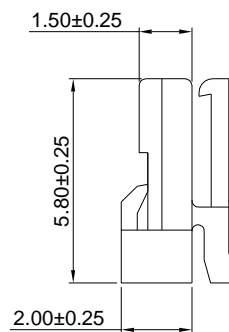
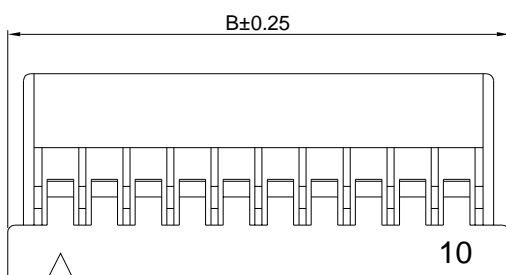
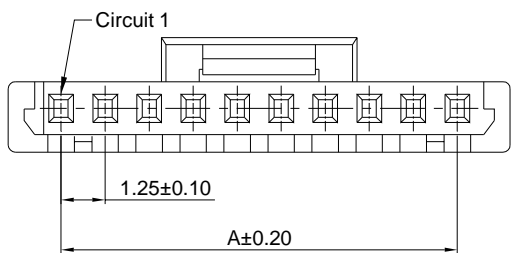

Ordering Information & Dimensions:

PART NO.	Dimensions	
	A	B
A1255HA-2P	1.25	4.35
A1255HA-3P	2.50	5.60
A1255HA-4P	3.75	6.85
A1255HA-5P	5.00	8.10
A1255HA-6P	6.25	9.35
A1255HA-7P	7.50	10.60
A1255HA-8P	8.75	11.85
A1255HA-9P	10.00	13.10
A1255HA-10P	11.25	14.35
A1255HA-11P	12.50	15.60
A1255HA-12P	13.75	16.85
A1255HA-13P	15.00	18.10
A1255HA-14P	16.25	19.35
A1255HA-15P	17.50	20.60
A1255HA-20P	23.75	26.85
A1255HA-25P	30.00	33.10
A1255HA-30P	36.25	39.35

Unit: mm

A1255 SERIES

1.25mm pitch wire to board connector

A1255WR-S

1.25mm pitch 90° Wafer Without Boss -SMT TYPE

Reference Informations:

- *Material:Pin:Brass/Tin over Nickel
Solder Tabs:Brass/Tin over Nickel
Insulator:Nylon 9T,UL94V-0
- *Mates with A1255 series Housing
- *Color:Ivory

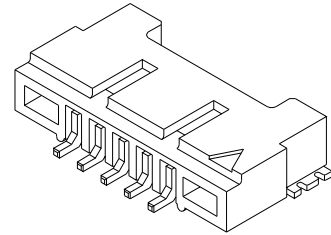
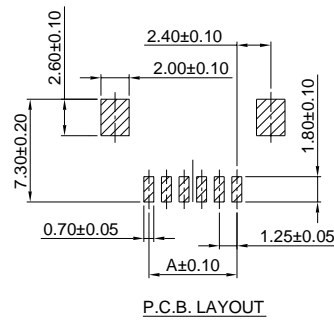

Ordering Information & Dimensions:

PART NO.	Dimensions	
	A	B
A1255WR-S-2P	1.25	7.45
A1255WR-S-3P	2.50	8.70
A1255WR-S-4P	3.75	9.95
A1255WR-S-5P	5.00	11.20
A1255WR-S-6P	6.25	12.45
A1255WR-S-7P	7.50	13.70
A1255WR-S-8P	8.75	14.95
A1255WR-S-9P	10.00	16.20
A1255WR-S-10P	11.25	17.45
A1255WR-S-11P	12.50	18.70
A1255WR-S-12P	13.75	19.95
A1255WR-S-13P	15.00	21.20
A1255WR-S-14P	16.25	22.45
A1255WR-S-15P	17.50	23.70
A1255WR-S-20P	23.75	29.95
A1255WR-S-25P	30.00	36.20
A1255WR-S-30P	36.25	42.45

Unit: mm

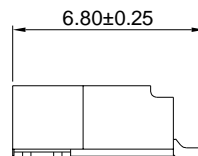
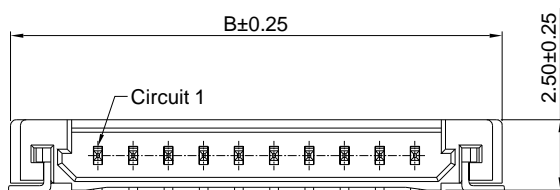
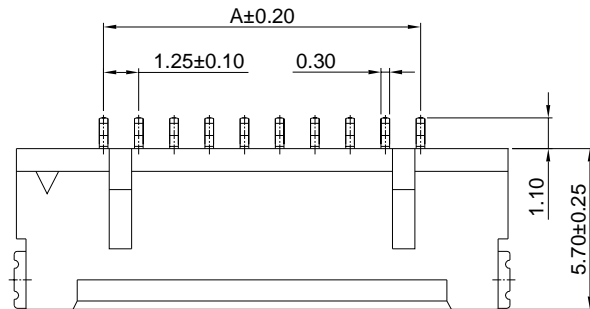

A1255WR-S-F

1.25mm pitch 90° Wafer With Boss-SMT TYPE

Reference Informations:

- *Material:Pin:Brass/Tin over Nickel
Solder Tabs:Brass/Tin over Nickel
Insulator:Nylon 9T,UL94V-0
- *Mates with A1255 series Housing
- *Color:Ivory

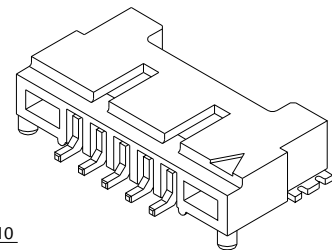
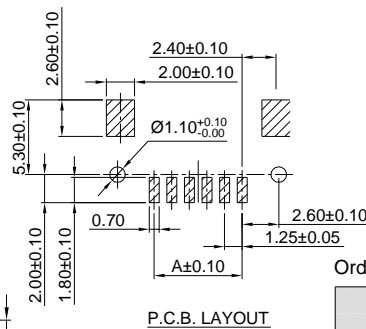

Ordering Information & Dimensions:

PART NO.	Dimensions	
	A	B
A1255WR-S-F-2P	1.25	7.45
A1255WR-S-F-3P	2.50	8.70
A1255WR-S-F-4P	3.75	9.95
A1255WR-S-F-5P	5.00	11.20
A1255WR-S-F-6P	6.25	12.45
A1255WR-S-F-7P	7.50	13.70
A1255WR-S-F-8P	8.75	14.95
A1255WR-S-F-9P	10.00	16.20
A1255WR-S-F-10P	11.25	17.45
A1255WR-S-F-11P	12.50	18.70
A1255WR-S-F-12P	13.75	19.95
A1255WR-S-F-13P	15.00	21.20
A1255WR-S-F-14P	16.25	22.45
A1255WR-S-F-15P	17.50	23.70
A1255WR-S-F-20P	23.75	29.95
A1255WR-S-F-25P	30.00	36.20
A1255WR-S-F-30P	36.25	42.45

Unit: mm

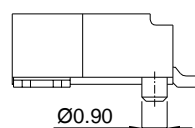
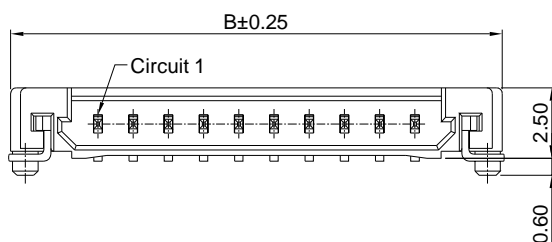
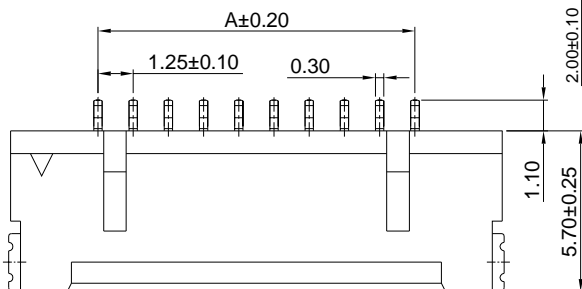

A1255 SERIES

1.25mm pitch wire to board connector

A1255WRA-S

1.25mm pitch 90° Wafer Without Boss -SMT TYPE

Reference Informations:

- *Material:Pin:Brass/Tin over Nickel
Solder Tabs:Brass/Tin over Nickel
Insulator:Nylon 6T,UL94V-0
- *Mates with A1255HA series Housing
- *Color:Beige

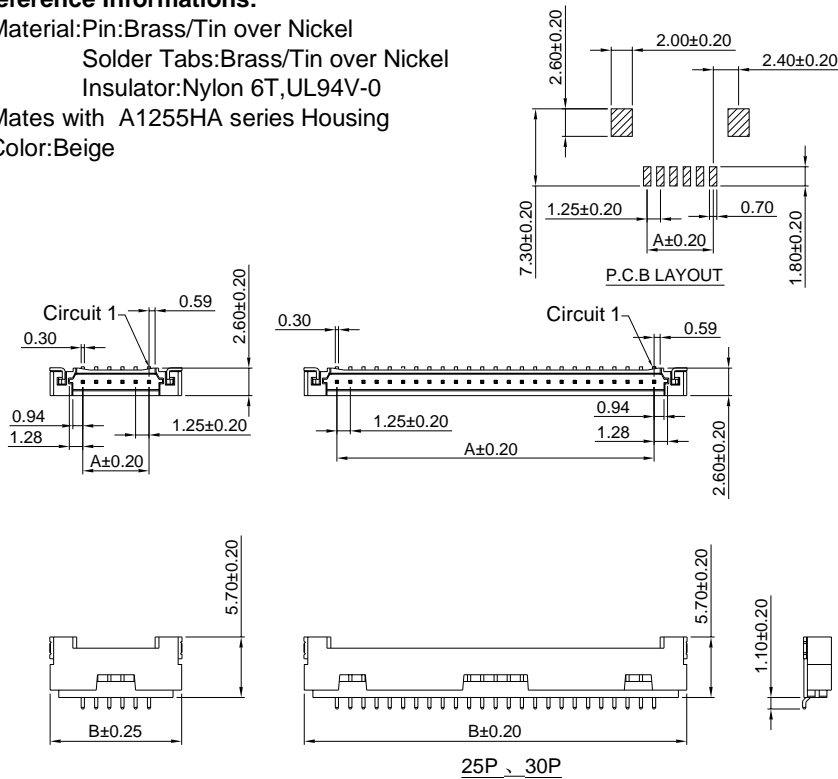
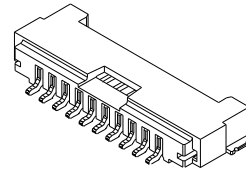

Ordering Information & Dimensions:

PART NO.	Dimensions	
	A	B
A1255WRA-S-2P	1.25	7.45
A1255WRA-S-3P	2.50	8.70
A1255WRA-S-4P	3.75	9.95
A1255WRA-S-5P	5.00	11.20
A1255WRA-S-6P	6.25	12.45
A1255WRA-S-7P	7.50	13.70
A1255WRA-S-8P	8.75	14.95
A1255WRA-S-9P	10.00	16.20
A1255WRA-S-10P	11.25	17.45
A1255WRA-S-11P	12.50	18.70
A1255WRA-S-12P	13.75	19.95
A1255WRA-S-13P	15.00	21.20
A1255WRA-S-14P	16.25	22.45
A1255WRA-S-15P	17.50	23.70
A1255WRA-S-20P	23.75	29.95
A1255WRA-S-25P	30.00	36.20
A1255WRA-S-30P	36.25	42.45

Unit: mm