

# A1561 SERIES

7.50-5.00mm pitch wire to board connector

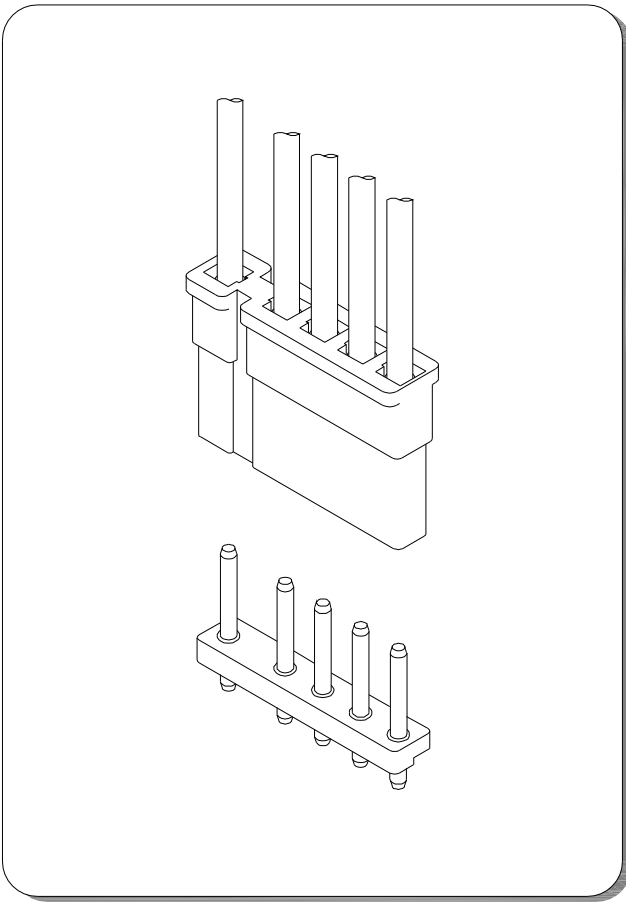

## Specifications

- Current rating:7A AC,DC
- Voltage rating:250V AC,DC
- Temperature range:-40°C~+105°C
- Contact resistance:10mΩMax.
- Insulation resistance:1000MΩMin.
- Withstanding voltage:1500V AC/minute
- \*Compliant with RoHS and REACH\*
- \*Meet the HF/Halogen Free,GWT/Glow wire Test (IEC60335-1) request,need to customize\*
- \*Contact for details\*

## Standards



## Assembly layout

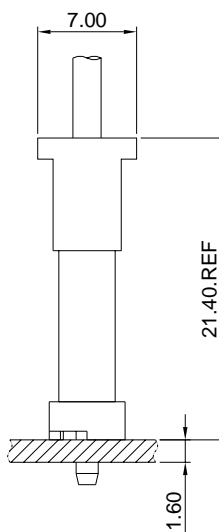

# A1561 SERIES

7.50-5.00mm pitch wire to board connector

## A1561-T

7.50-5.00mm pitch Crimp Terminal

### Reference Informations:

\* Used in A1561 series Housing

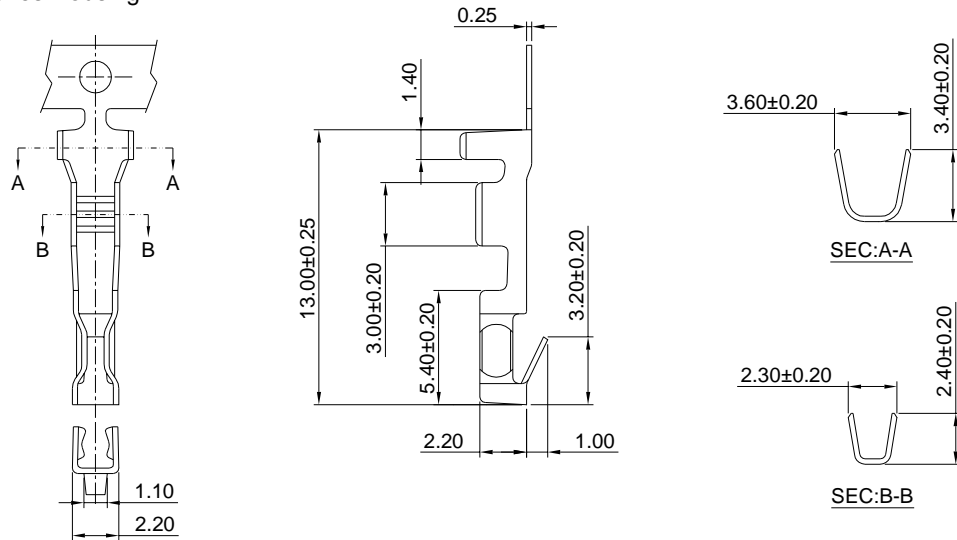

Ordering information & Specifications:

Unit:mm

Part NO.	Wire Range	Insulation O.D.	Material	Finish	Qty/reel
A1561-TB	AWG#18-#24	2.70mm(max)	Brass	Tin over Nickel	6,000 PCS
A1561-TP	AWG#18-#24	2.70mm(max)	Phosphor Bronze	Tin over Nickel	6,000 PCS
A1561-GB	AWG#18-#24	2.70mm(max)	Brass	Gold over Nickel	6,000 PCS
A1561-GP	AWG#18-#24	2.70mm(max)	Phosphor Bronze	Gold over Nickel	6,000 PCS

Optional Gold plating available but MOQ requested

## A1561H

7.50-5.00mm pitch Housing

### Reference Informations:

\*Material:Nylon 66,UL94V-0

\*Suitable A1561 series Terminal

\*Mates with A1561 series Wafer

\*Color:White

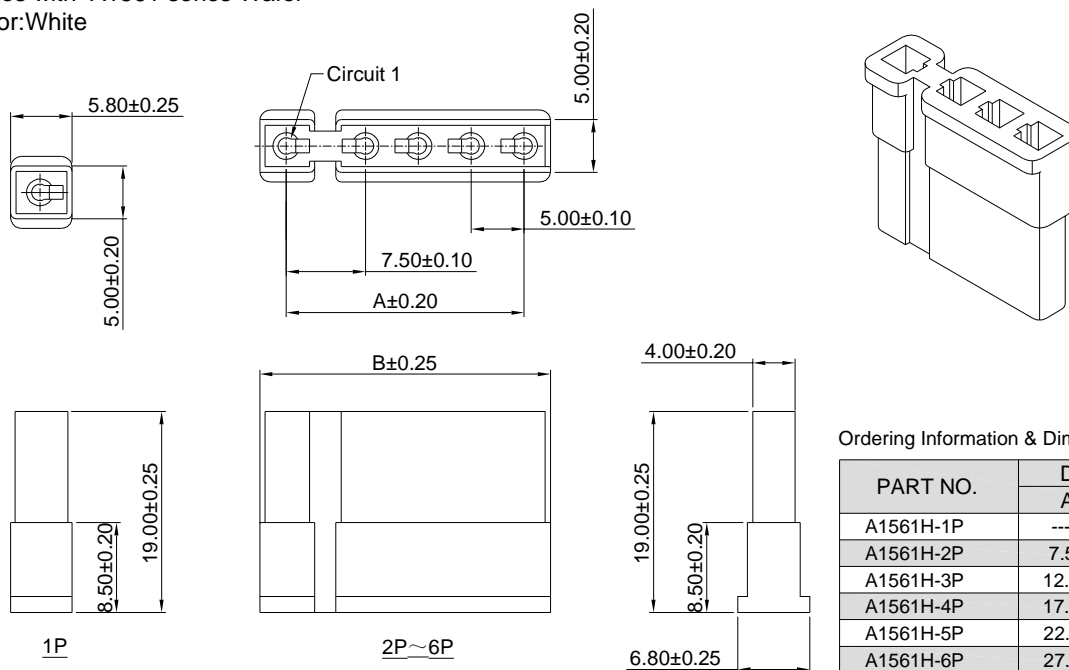

Ordering Information & Dimensions

PART NO.	Dimensions	
	A	B
A1561H-1P	-----	5.80
A1561H-2P	7.50	12.50
A1561H-3P	12.50	17.50
A1561H-4P	17.50	22.50
A1561H-5P	22.50	27.50
A1561H-6P	27.50	32.50

Unit: mm

# A1561 SERIES

7.50-5.00mm pitch wire to board connector

## A1561HA

7.50-5.00mm pitch Housing

### Reference Informations:

- \*Material:Nylon 66,UL94V-0
- \*Suitable A1561 series Terminal
- \*Mates with A1561WVA series Wafer
- \*Color:White

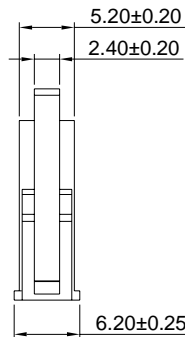
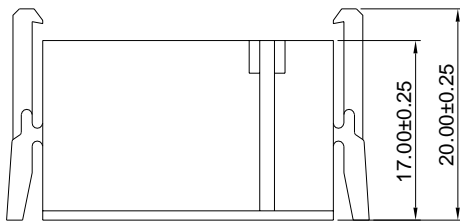
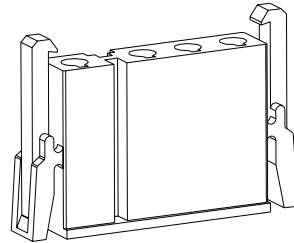
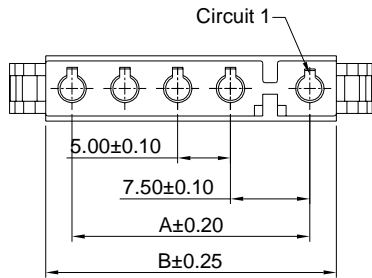

### Ordering Information & Dimensions

PART NO.	Dimensions	
	A	B
A1561HA-2P	7.50	12.50
A1561HA-3P	12.50	17.50
A1561HA-4P	17.50	22.50
A1561HA-5P	22.50	27.50
A1561HA-6P	27.50	32.50

Unit: mm

## A1561WV

7.50-5.00mm pitch 180° Wafer

### Reference Informations:

- \*Material:Pin:Brass/Tin over Nickel  
Insulator:Nylon 66,UL94V-0
- \*Mates with A1561 series Housing
- \*Color:White

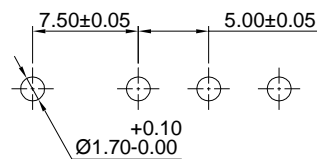
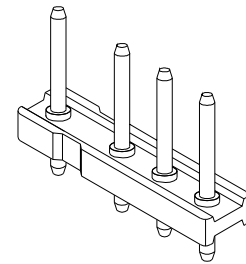
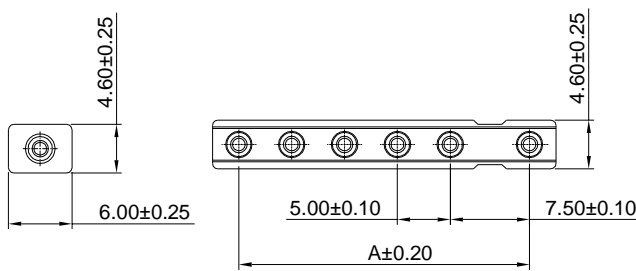

### P.C.B LAYOUT

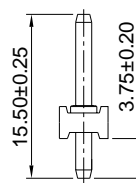
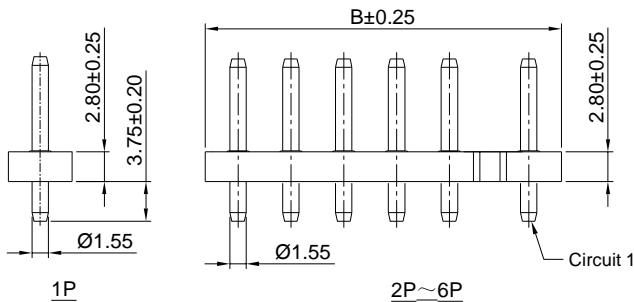

### Ordering Information & Dimensions

PART NO.	Dimensions	
	A	B
A1561WV-1P	---	6.00
A1561WV-2P	7.50	12.60
A1561WV-3P	12.50	17.60
A1561WV-4P	17.50	22.60
A1561WV-5P	22.50	27.60
A1561WV-6P	27.50	32.60

Unit: mm

# A1561 SERIES

7.50-5.00mm pitch wire to board connector

## A1561WVA

7.50-5.00mm pitch 180° Wafer

### Reference Informations:

- \*Material:Pin:Brass/Tin over Nickel  
Insulator:Nylon 66,UL94V-0
- \*Mates with A1561HA series Housing
- \*Color:White

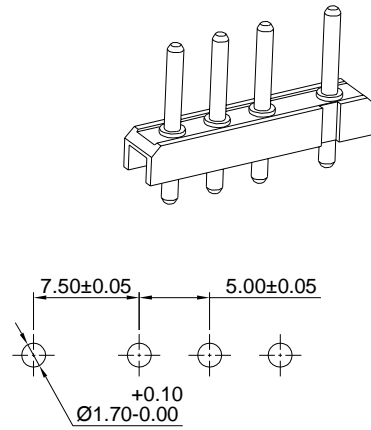
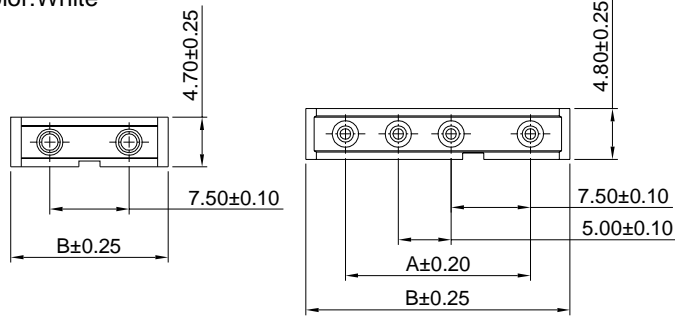

P.C.B LAYOUT

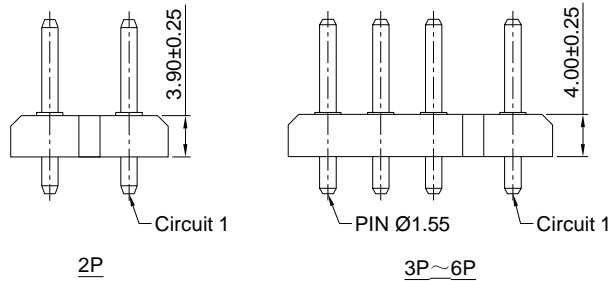

### Ordering Information & Dimensions

PART NO.	Dimensions	
	A	B
A1561WVA-2P	7.50	14.90
A1561WVA-3P	12.50	20.00
A1561WVA-4P	17.50	25.00
A1561WVA-5P	22.50	30.00
A1561WVA-6P	27.50	35.00

Unit: mm