

A2007 SERIES

2.00mm pitch wire to board connector

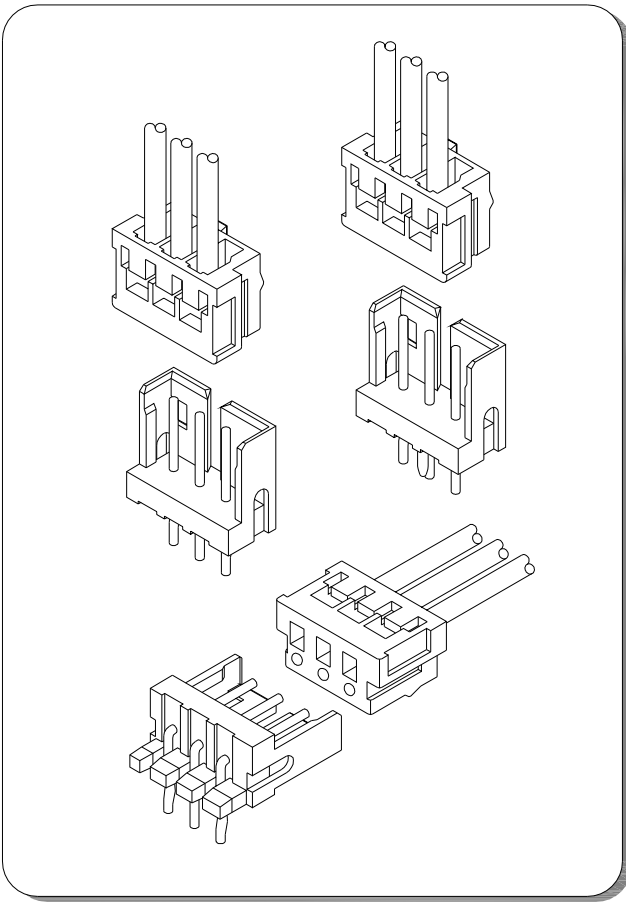

Specifications

- Current rating:4A AC,DC
- Voltage rating:125V AC,DC
- Temperature range:-40°C~+105°C
- Contact resistance:10mΩMax.
- Insulation resistance:1000MΩMin.
- Withstanding voltage:1000V AC/minute
- *Compliant with RoHS and REACH*
- *Meet the HF/Halogen Free,need to customize*
- *Contact for details*

Standards



Assembly layout

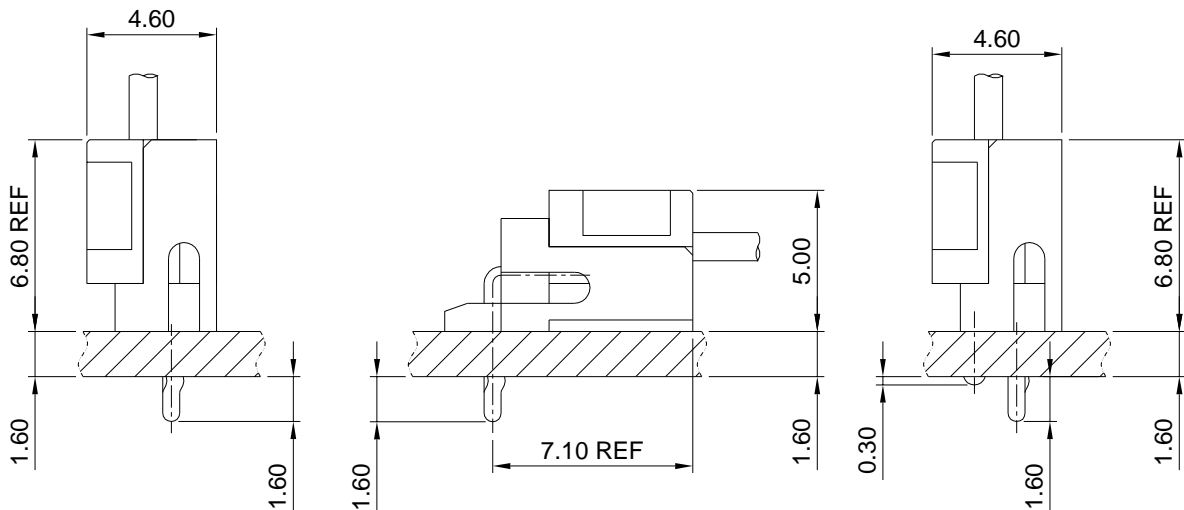

A2007 SERIES

2.00mm pitch wire to board connector

A2007-T

2.00mm pitch Crimp Terminal

Reference Informations:

*Used in A2007 series Housing

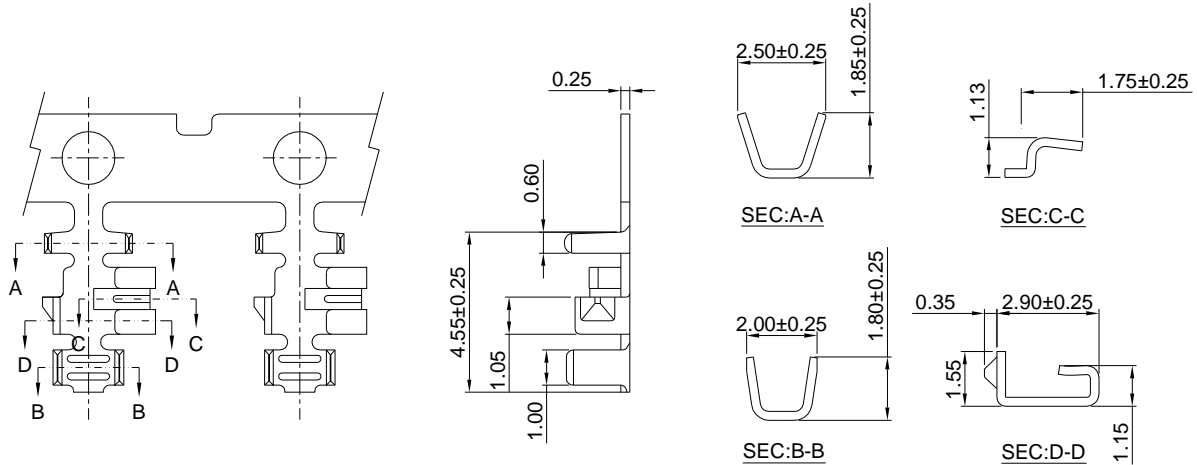

Ordering information & Specifications:

Unit:mm

Part NO.	Wire Range	Insulation O.D.	Material	Finish	Qty/reel
A2007-TP	AWG#22-#26	1.50mm(max)	Phosphor Bronze	Tin over Nickel	10,000 PCS
A2007-GP	AWG#22-#26	1.50mm(max)	Phosphor Bronze	Gold over Nickel	10,000 PCS

Optional Gold plating available but MOQ requested

A2007H

2.00mm pitch Housing

Reference Informations:

*Material:Nylon 66,UL94V-0

*Suitable A2007 series Terminal

*Mates with A2007 series Wafer

*Color:White

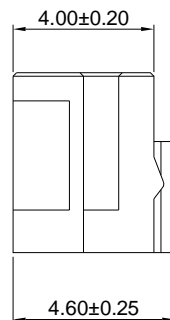
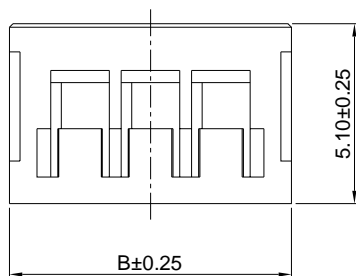
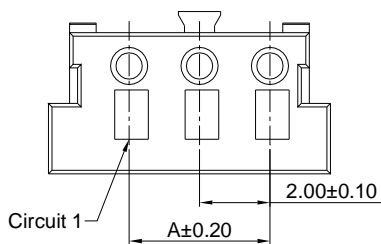
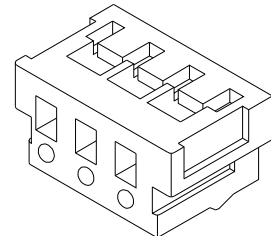

Ordering Information & Dimensions:

PART NO.	Dimensions	
	A	B
A2007H-2P	2.00	5.60
A2007H-3P	4.00	7.60
A2007H-4P	6.00	9.60
A2007H-5P	8.00	11.60
A2007H-6P	10.00	13.60
A2007H-7P	12.00	15.60
A2007H-8P	14.00	17.60
A2007H-9P	16.00	19.60
A2007H-10P	18.00	21.60
A2007H-11P	20.00	23.60
A2007H-12P	22.00	25.60
A2007H-13P	24.00	27.60
A2007H-14P	26.00	29.60
A2007H-15P	28.00	31.60

Unit: mm

A2007 SERIES

2.00mm pitch wire to board connector

A2007WV

2.00mm pitch 180° Wafer

Reference Informations:

- *Material:Pin:Brass/Tin over Nickel
Insulator:Nylon 66,UL94V-0
- *Mates with A2007 series Housing
- *Color:White

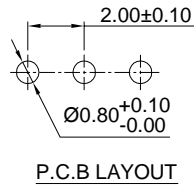
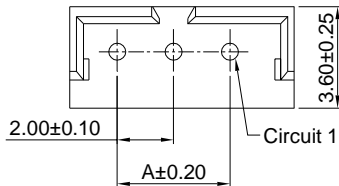

P.C.B LAYOUT

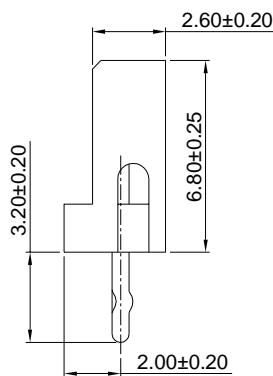
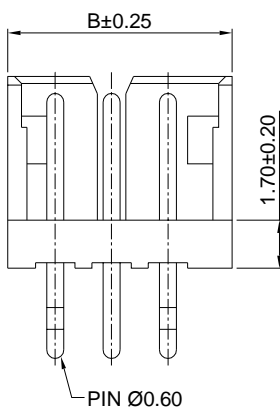
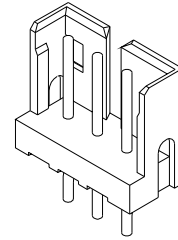

Ordering Information & Dimensions:

PART NO.	Dimensions	
	A	B
A2007WV-2P	2.00	5.96
A2007WV-3P	4.00	7.96
A2007WV-4P	6.00	9.96
A2007WV-5P	8.00	11.96
A2007WV-6P	10.00	13.96
A2007WV-7P	12.00	15.96
A2007WV-8P	14.00	17.96
A2007WV-9P	16.00	19.96
A2007WV-10P	18.00	21.96
A2007WV-11P	20.00	23.96
A2007WV-12P	22.00	25.96
A2007WV-13P	24.00	27.96
A2007WV-14P	26.00	29.96
A2007WV-15P	28.00	31.96

Unit: mm

A2007WR

2.00mm pitch 90° Wafer

Reference Informations:

- *Material:Pin:Brass/Tin over Nickel
Insulator:Nylon 66,UL94V-0
- *Mates with A2007 series Housing
- *Color:White

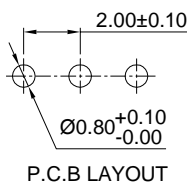
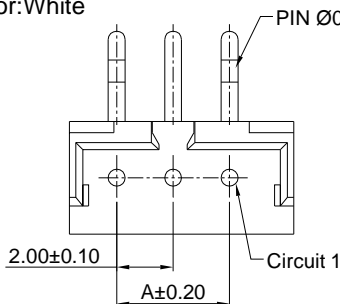

P.C.B LAYOUT

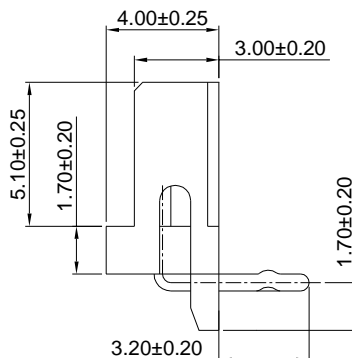
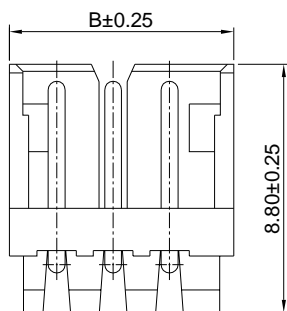
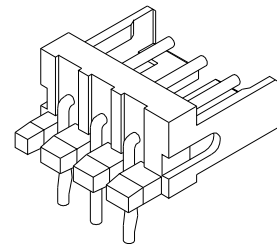

Ordering Information & Dimensions:

PART NO.	Dimensions	
	A	B
A2007WR-2P	2.00	5.96
A2007WR-3P	4.00	7.96
A2007WR-4P	6.00	9.96
A2007WR-5P	8.00	11.96
A2007WR-6P	10.00	13.96
A2007WR-7P	12.00	15.96
A2007WR-8P	14.00	17.96
A2007WR-9P	16.00	19.96
A2007WR-10P	18.00	21.96
A2007WR-11P	20.00	23.96
A2007WR-12P	22.00	25.96
A2007WR-13P	24.00	27.96
A2007WR-14P	26.00	29.96
A2007WR-15P	28.00	31.96

Unit: mm

A2007 SERIES

2.00mm pitch wire to board connector

A2007WVD

2.00mm pitch 180° Wafer

Reference Informations:

- *Material:Pin:Brass/Tin over Nickel
Insulator:Nylon 66,UL94V-0
- *Mates with A2007 series Housing
- *Color:White

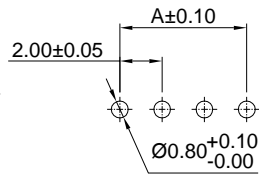
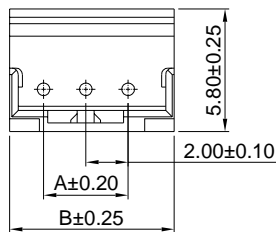
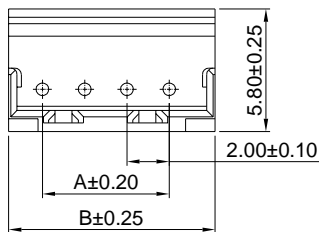

P.C.B LAYOUT

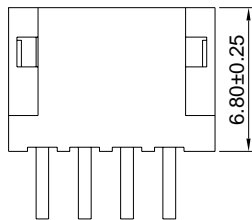
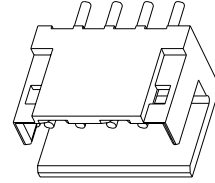

4P~15P

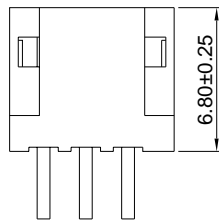

2P~3P

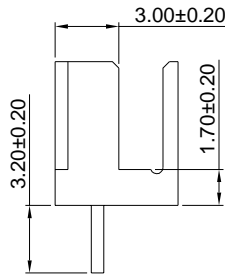

Ordering Information & Dimensions:

PART NO.	Dimensions	
	A	B
A2007WVD-2P	2.00	5.80
A2007WVD-3P	4.00	7.80
A2007WVD-4P	6.00	9.80
A2007WVD-5P	8.00	11.80
A2007WVD-6P	10.00	13.80
A2007WVD-7P	12.00	15.80
A2007WVD-8P	14.00	17.80
A2007WVD-9P	16.00	19.80
A2007WVD-10P	18.00	21.80
A2007WVD-11P	20.00	23.80
A2007WVD-12P	22.00	25.80
A2007WVD-13P	24.00	27.80
A2007WVD-14P	26.00	29.80
A2007WVD-15P	28.00	31.80

Unit: mm

A2007WRD

2.00mm pitch 90° Wafer

Reference Informations:

- *Material:Pin:Brass/Tin over Nickel
Insulator:Nylon 66,UL94V-0
- *Mates with A2007 series Housing
- *Color:White

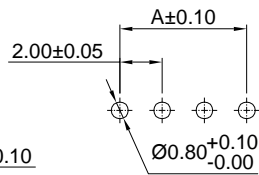
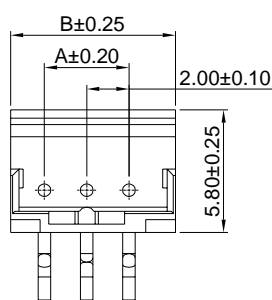
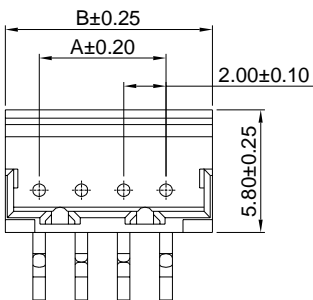

P.C.B LAYOUT

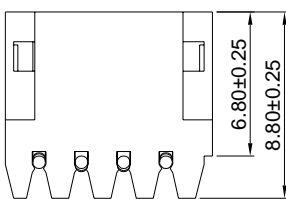
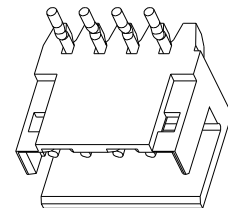

4P~15P

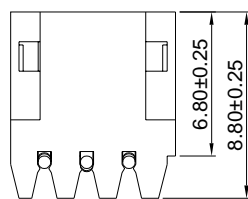

2P~3P

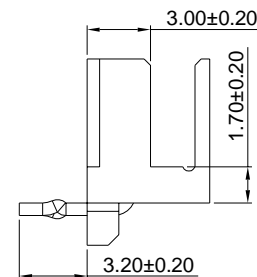

Ordering Information & Dimensions:

PART NO.	Dimensions	
	A	B
A2007WRD-2P	2.00	5.80
A2007WRD-3P	4.00	7.80
A2007WRD-4P	6.00	9.80
A2007WRD-5P	8.00	11.80
A2007WRD-6P	10.00	13.80
A2007WRD-7P	12.00	15.80
A2007WRD-8P	14.00	17.80
A2007WRD-9P	16.00	19.80
A2007WRD-10P	18.00	21.80
A2007WRD-11P	20.00	23.80
A2007WRD-12P	22.00	25.80
A2007WRD-13P	24.00	27.80
A2007WRD-14P	26.00	29.80
A2007WRD-15P	28.00	31.80

Unit: mm

A2007 SERIES

2.00mm pitch wire to board connector

A2007WV-F-3P

2.00mm pitch 180° Wafer With Foot

Reference Informations:

- *Material:Pin:Brass/Tin over Nickel
Insulator:Nylon 66,UL94V-0
- *Mates with A2007 series Housing
- *Color:White

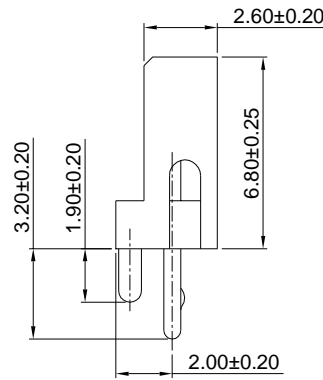
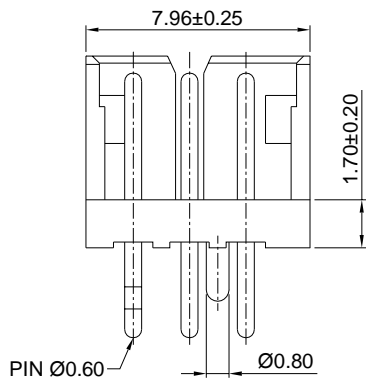
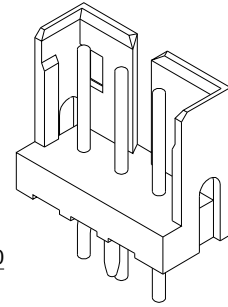
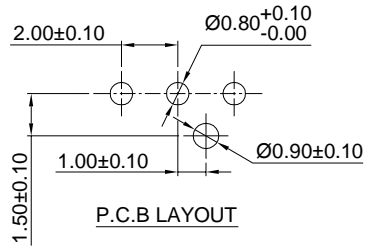
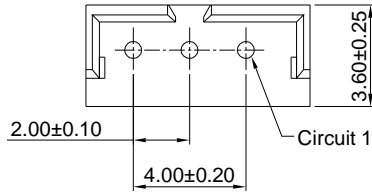

Unit: mm