

# A2511 SERIES

2.50mm pitch wire to board connector

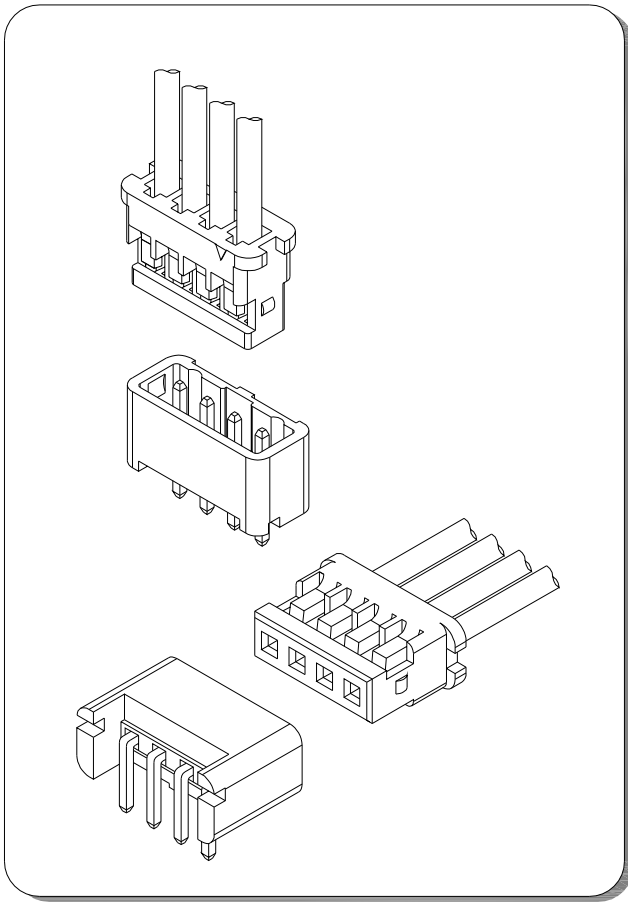

## Specifications

- Current rating: 3A AC, DC
- Voltage rating: 500V AC, DC
- Temperature range: -40°C ~ +105°C
- Contact resistance: 20mΩ Max.
- Insulation resistance: 500MΩ Min.
- Withstanding voltage: 1000V AC/minute
- \*Compliant with RoHS and REACH\*
- \*Meet the HF/Halogen Free need to customize\*
- \*Contact for details\*

## Standards



## Assembly layout

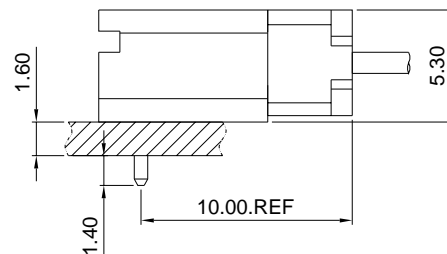
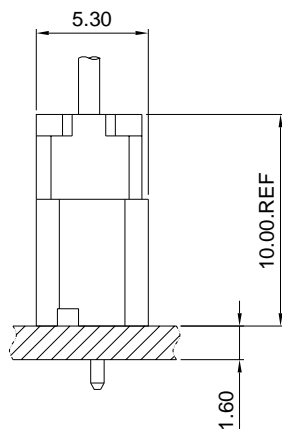

# A2511 SERIES

2.50mm pitch wire to board connector

## A2511-T

2.50mm Pitch Crimp Terminal

### Reference Informations:

\*Used in A2511 series Housing

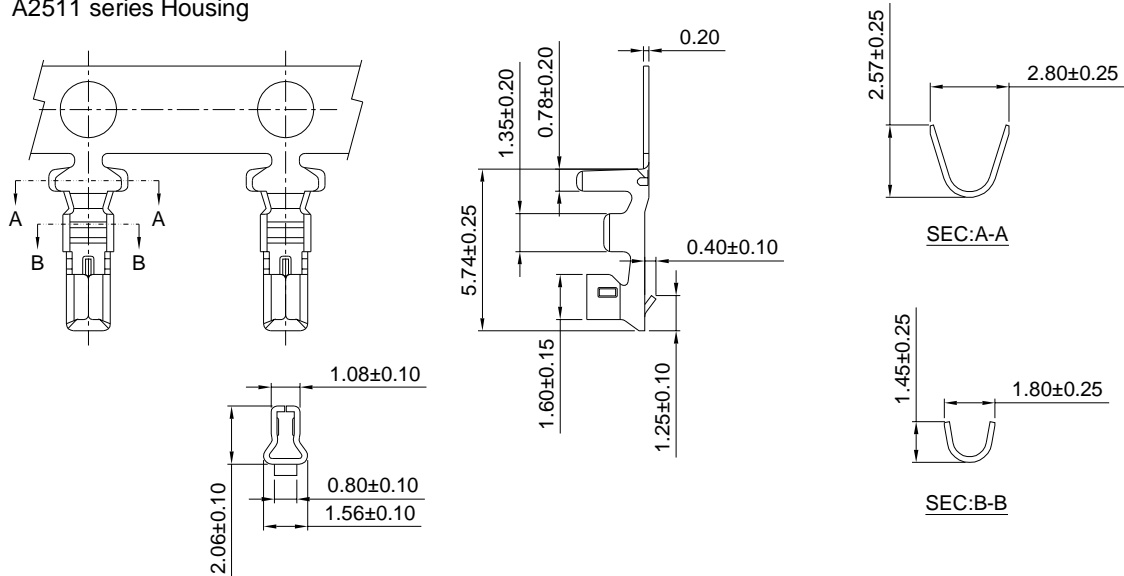

### Ordering information & Specifications:

Unit:mm

Part NO.	Wire Range	Insulation O.D.	Material	Finish	Qty/reel
A2511-TP	AWG#22-#30	1.90mm(max)	Phosphor Bronze	Tin over Nickel	10,000 PCS
A2511-GP	AWG#22-#30	1.90mm(max)	Phosphor Bronze	Gold over Nickel	10,000 PCS

Optional Gold plating available but MOQ requested

## A2511H

2.50mm Pitch Housing

### Reference Informations:

\*Material:PBT, UL94V-0

\*Suitable A2511 series Terminal

\*Mates with A2511 series Wafer

\*Color:Black

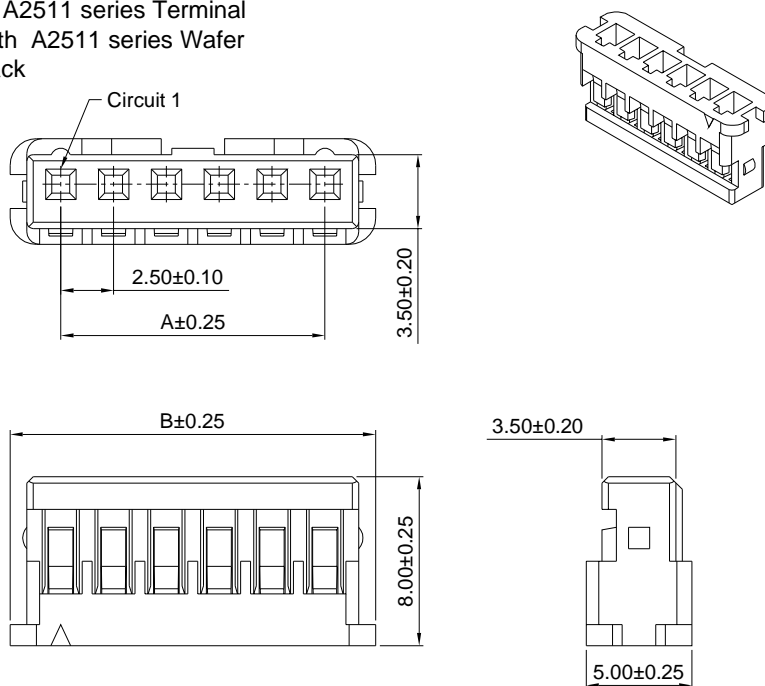

### Ordering Information & Dimensions:

PART NO.	Dimensions	
	A	B
A2511H-2P	2.50	7.30
A2511H-3P	5.00	9.80
A2511H-4P	7.50	12.30
A2511H-5P	10.00	14.80
A2511H-6P	12.50	17.30
A2511H-7P	15.00	19.80
A2511H-8P	17.50	22.30
A2511H-9P	20.00	24.80
A2511H-10P	22.50	27.30
A2511H-11P	25.00	29.80
A2511H-12P	27.50	32.30
A2511H-13P	30.00	34.80
A2511H-14P	32.50	37.30
A2511H-15P	35.00	39.80

Unit: mm

# A2511 SERIES

2.50mm pitch wire to board connector

## A2511WV

2.50mm pitch 180° Wafer

### Reference Informations:

- \*Material:Pin:Brass/Tin over Nickel  
Insulator:PBT,UL94V-0
- \*Mates with A2511 series Housing
- \*Color:Black

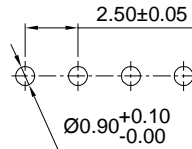
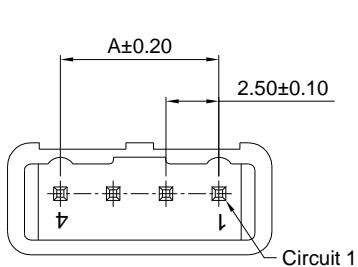
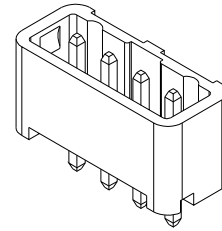

P.C.B LAYOUT

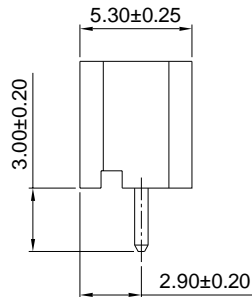
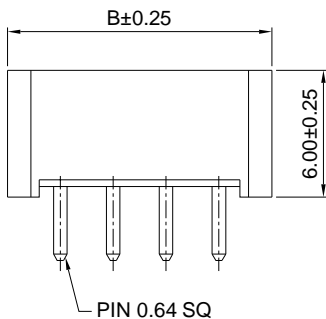

### Ordering Information & Dimensions:

PART NO.	Dimensions	
	A	B
A2511WV-2P	2.50	7.50
A2511WV-3P	5.00	10.00
A2511WV-4P	7.50	12.50
A2511WV-5P	10.00	15.00
A2511WV-6P	12.50	17.50
A2511WV-7P	15.00	20.00
A2511WV-8P	17.50	22.50
A2511WV-9P	20.00	25.00
A2511WV-10P	22.50	27.50
A2511WV-11P	25.00	30.00
A2511WV-12P	27.50	32.50
A2511WV-13P	30.00	35.00
A2511WV-14P	32.50	37.50
A2511WV-15P	35.00	40.00

Unit: mm

## A2511WR

2.50mm pitch 90° Wafer

### Reference Informations:

- \*Material:Pin:Brass/Tin over Nickel  
Insulator:PBT,UL94V-0
- \*Mates with A2511 series Housing
- \*Color:Black

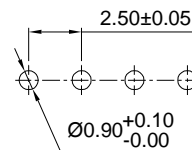
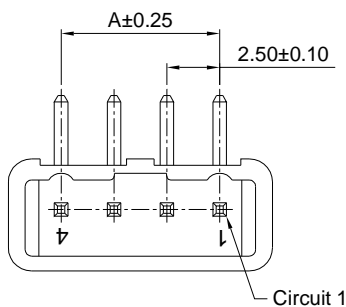
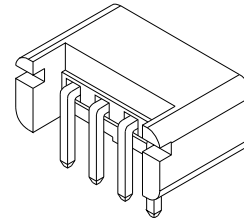

P.C.B LAYOUT

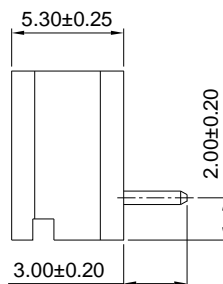
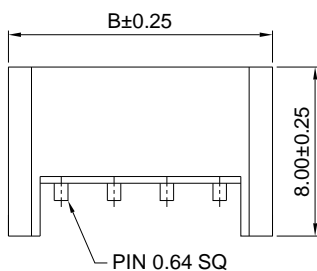

### Ordering Information & Dimensions:

PART NO.	Dimensions	
	A	B
A2511WR-2P	2.50	7.50
A2511WR-3P	5.00	10.00
A2511WR-4P	7.50	12.50
A2511WR-5P	10.00	15.00
A2511WR-6P	12.50	17.50
A2511WR-7P	15.00	20.00
A2511WR-8P	17.50	22.50
A2511WR-9P	20.00	25.00
A2511WR-10P	22.50	27.50
A2511WR-11P	25.00	30.00
A2511WR-12P	27.50	32.50
A2511WR-13P	30.00	35.00
A2511WR-14P	32.50	37.50
A2511WR-15P	35.00	40.00

Unit: mm