

A2547 SERIES

2.54mm pitch wire to board and wire to wire connector

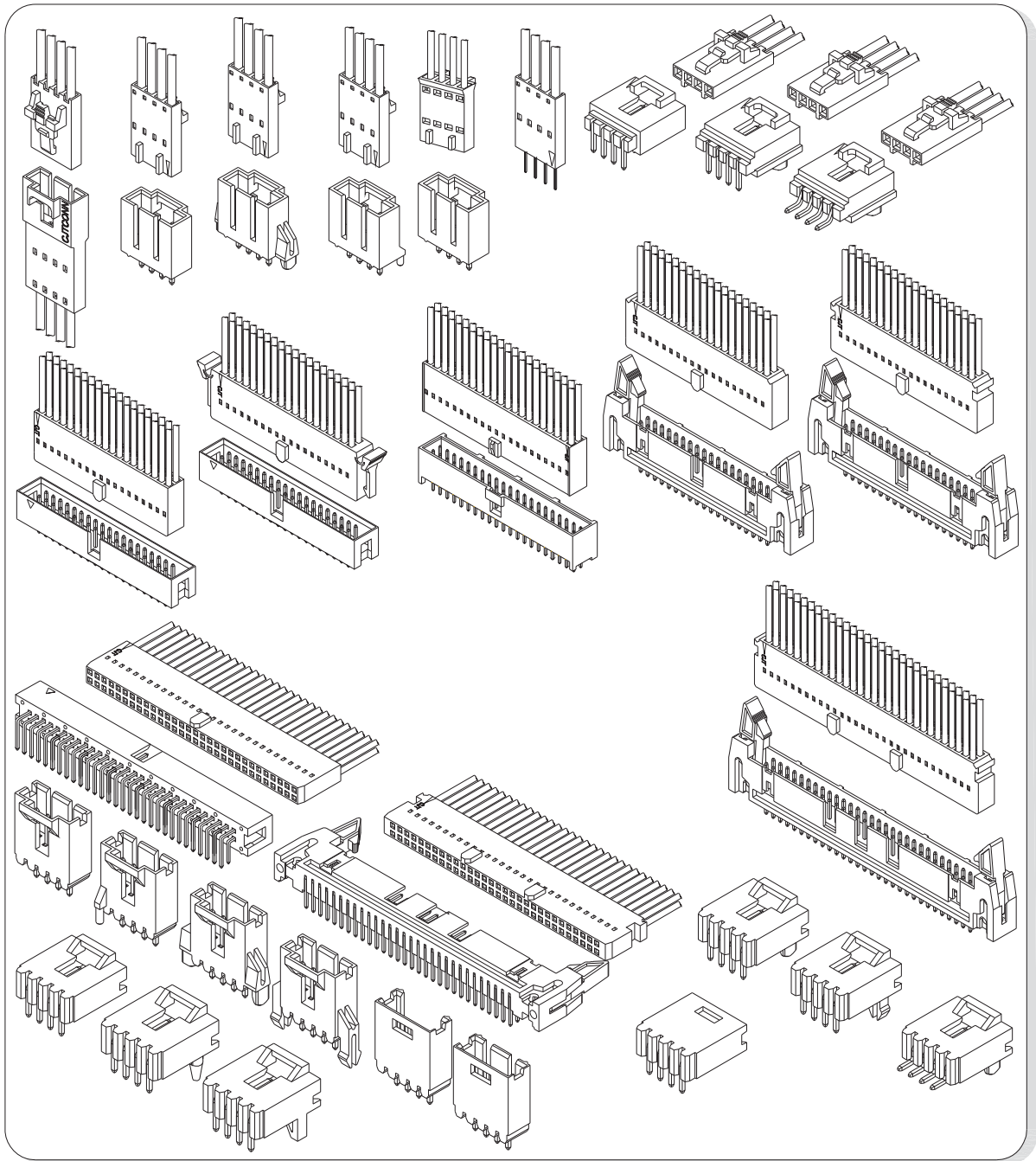

Specifications

- Current rating:3A AC,DC
- Voltage rating:250V AC,DC
- Temperature range:-40°C~+105°C
- Contact resistance:20mΩ Max.
- Insulation resistance:1000MΩ Min.
- Withstanding voltage:1500V AC/minute
- *Compliant with RoHS and REACH*
- *Meet the HF/Halogen Free,need to customize*
- *Contact for details*

Standards



Assembly layout

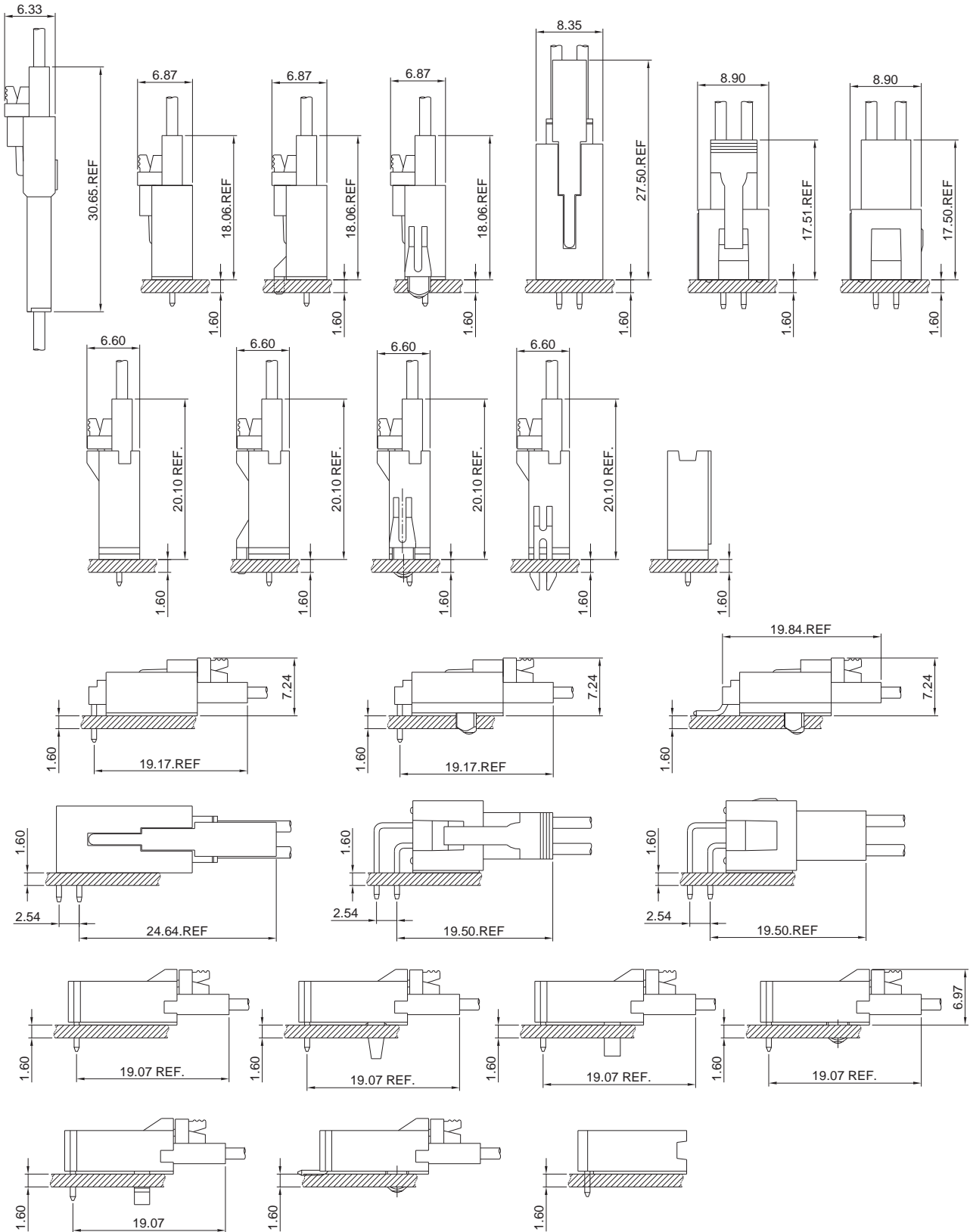

A2547 SERIES 2.54mm pitch wire to board and wire to wire connector

A2547-T

2.54mm Pitch Crimp Terminal

Reference Informations:

*Used in A2547 series Housing

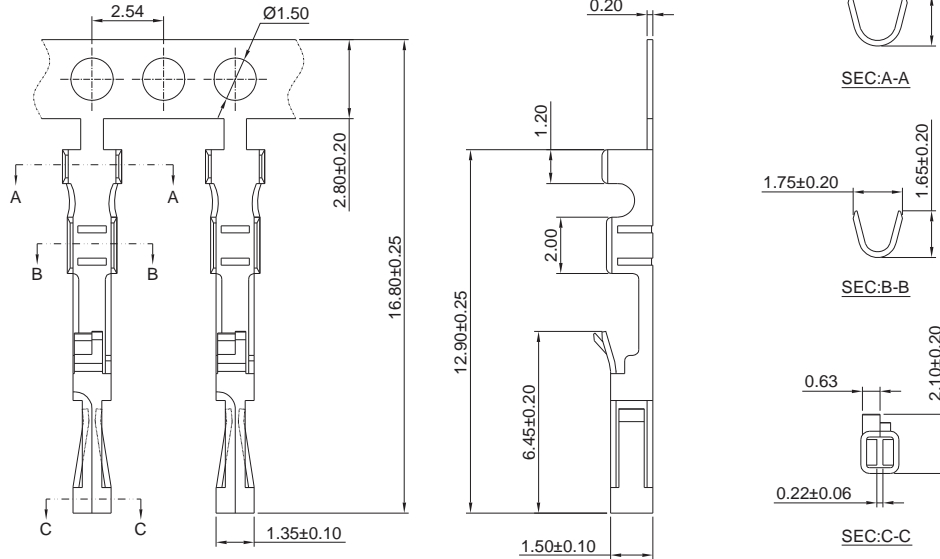

Ordering information & Specifications:

Unit:mm

Part NO.	Wire Range	Insulation O.D.	Material	Finish	Qty/reel
A2547-TP	AWG#22-#24	1.60mm(max)	Phosphor Bronze	Tin over Nickel	15,000 PCS
A2547-GP	AWG#22-#24	1.60mm(max)	Phosphor Bronze	Gold over Nickel	15,000 PCS

Optional Gold plating available but MOQ requested

A2547-T-L

2.54mm Pitch Crimp Terminal

Reference Informations:

*Used in A2547 series Housing

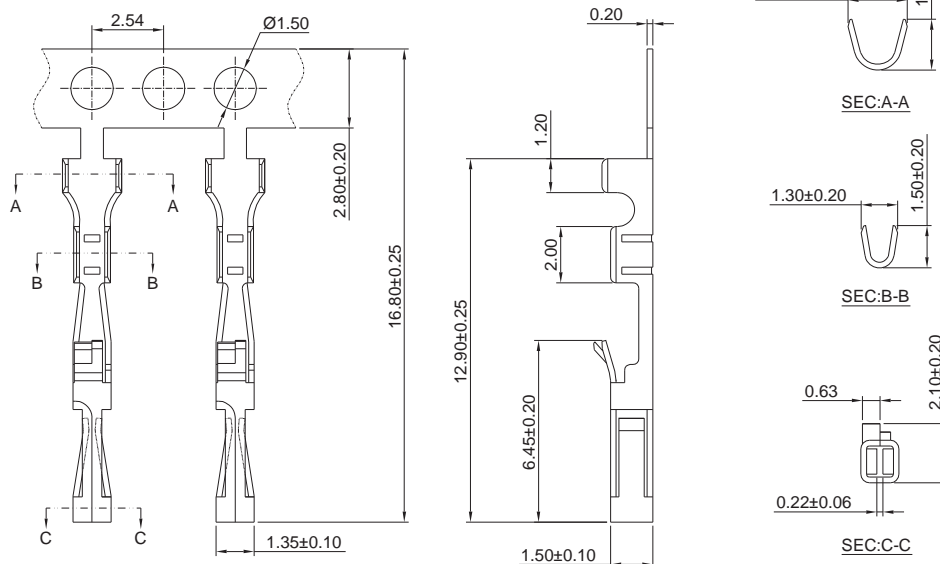

Ordering information & Specifications:

Unit:mm

Part NO.	Wire Range	Insulation O.D.	Material	Finish	Qty/reel
A2547-TP-L	AWG#24-#30	1.60mm(max)	Phosphor Bronze	Tin over Nickel	15,000 PCS
A2547-GP-L	AWG#24-#30	1.60mm(max)	Phosphor Bronze	Gold over Nickel	15,000 PCS

A2547 SERIES 2.54mm pitch wire to board and wire to wire connector

A2547-T-C

2.54mm Pitch Crimp Terminal

Reference Informations:

*Used in A2547 series Housing

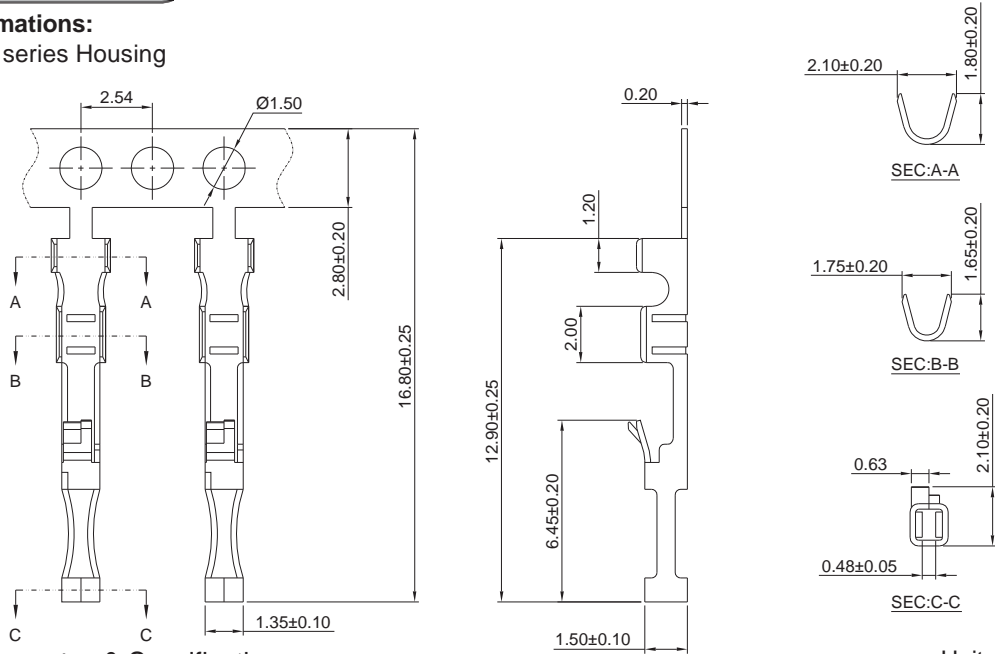

Ordering information & Specifications:

Unit:mm

Part NO.	Wire Range	Insulation O.D.	Material	Finish	Qty/reel
A2547-TP-C	AWG#22-#24	1.60mm(max)	Phosphor Bronze	Tin over Nickel	15,000 PCS
A2547-GP-C	AWG#22-#24	1.60mm(max)	Phosphor Bronze	Gold over Nickel	15,000 PCS

Optional Gold plating available but MOQ requested

A2547-T-C-L

2.54mm Pitch Crimp Terminal

Reference Informations:

*Used in A2547 series Housing

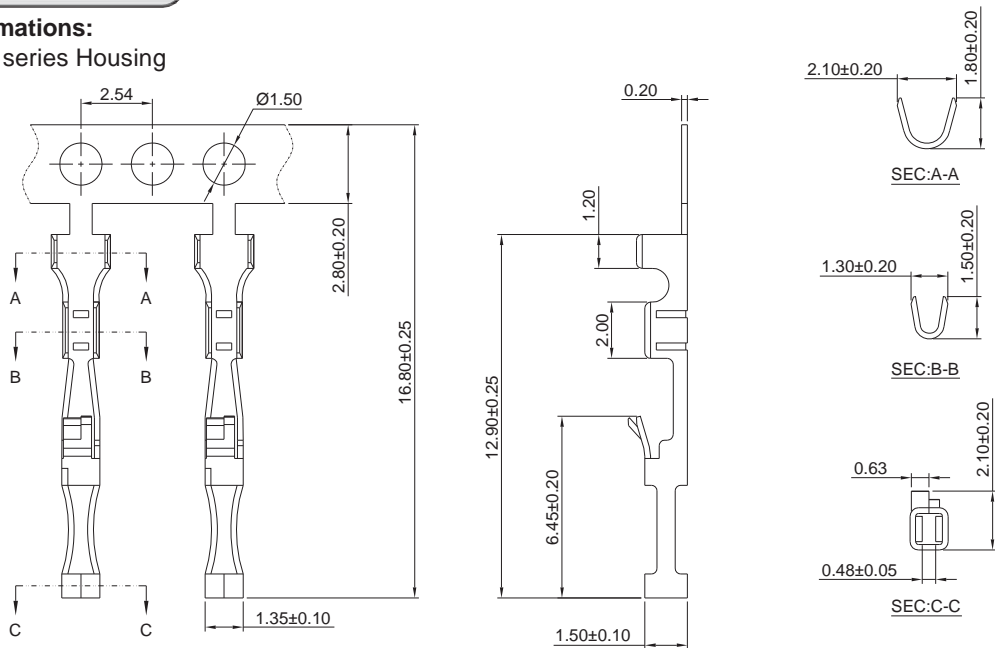

Ordering information & Specifications:

Unit:mm

Part NO.	Wire Range	Insulation O.D.	Material	Finish	Qty/reel
A2547-TP-C-L	AWG#24-#30	1.60mm(max)	Phosphor Bronze	Tin over Nickel	15,000 PCS
A2547-GP-C-L	AWG#24-#30	1.60mm(max)	Phosphor Bronze	Gold over Nickel	15,000 PCS

A2547 SERIES 2.54mm pitch wire to board and wire to wire connector

A2547-T-B

2.54mm Pitch Crimp Terminal

Reference Informations:

*Used in A2547HA A2547HB series Housing

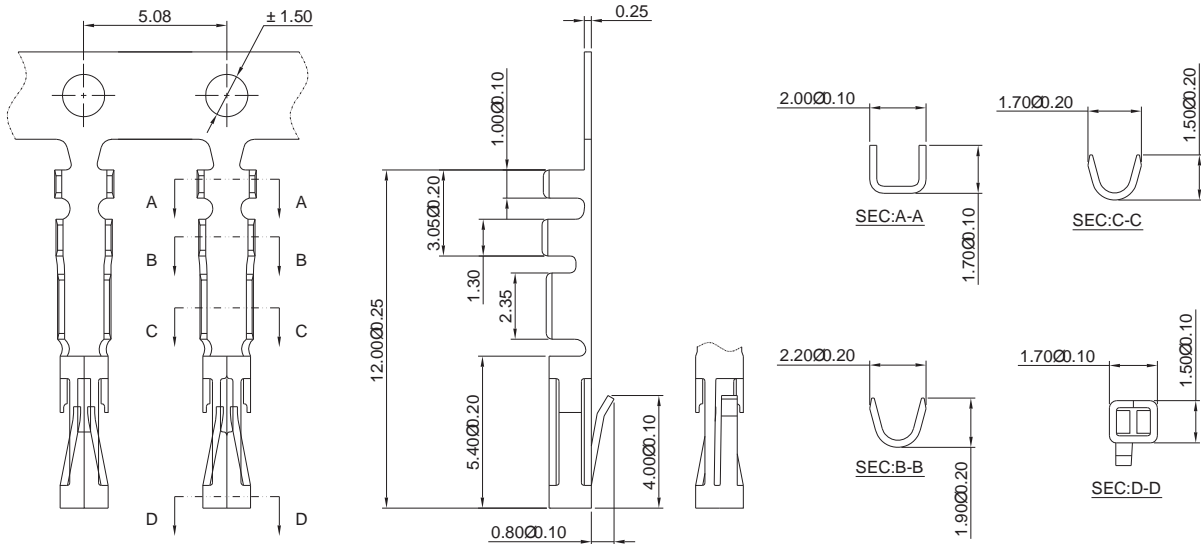

Ordering information & Specifications:

Unit:mm

Part NO.	Wire Range	Insulation O.D.	Material	Finish	Qty/reel
A2547-TP-B	AWG#22-#26	1.55mm(max)	Phosphor Bronze	Tin over Nickel	20,000 PCS
A2547-GP-B	AWG#22-#26	1.55mm(max)	Phosphor Bronze	Gold over Nickel	20,000 PCS

Optional Gold plating available but MOQ requested

A2547-T-D

2.54mm Pitch Insulation Displacement Terminal

Reference Informations:

*Used in A2547 series Housing

Ordering Information:

A2547-TP(GP)-D - **

1. Part No.

2. Finish:
 (blank) - 24 AWG
 26 - 26 AWG
 28 - 28 AWG
 22 - 22 AWG

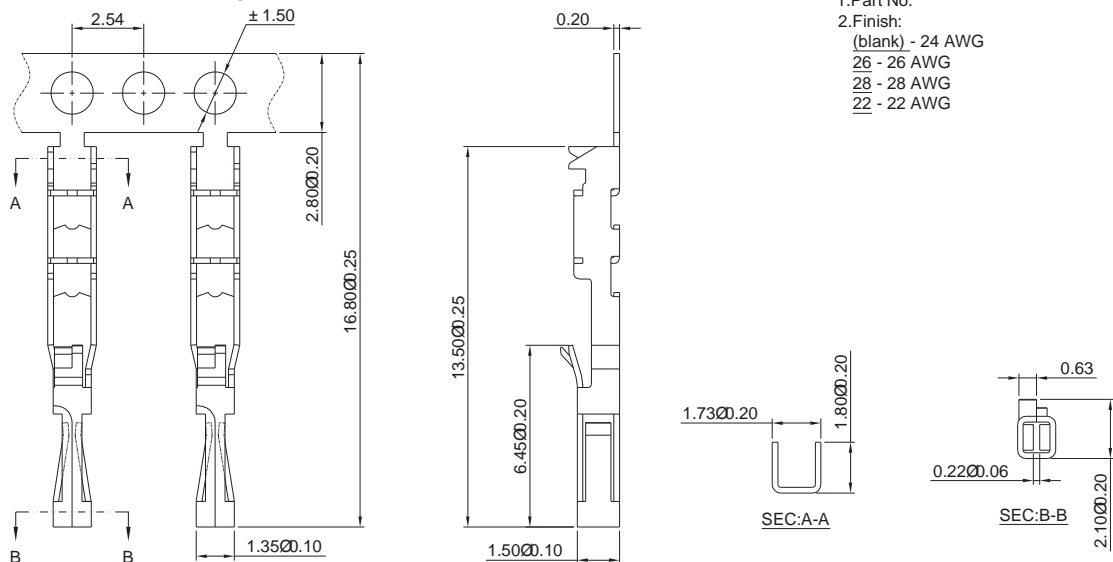

Ordering information & Specifications:

Unit:mm

Part NO.	Wire Range	Insulation O.D.	Material	Finish	Qty/reel
A2547-TP-D	AWG#22-#28	1.60mm(max)	Phosphor Bronze	Tin over Nickel	15,000 PCS
A2547-GP-D	AWG#22-#28	1.60mm(max)	Phosphor Bronze	Gold over Nickel	15,000 PCS

A2547 SERIES 2.54mm pitch wire to board and wire to wire connector

A2547M-T

2.54mm Pitch Crimp Terminal

Reference Informations:

*Used in A2547HM,A2547H-2,A2547HE Single Row,A2547HF series Housing

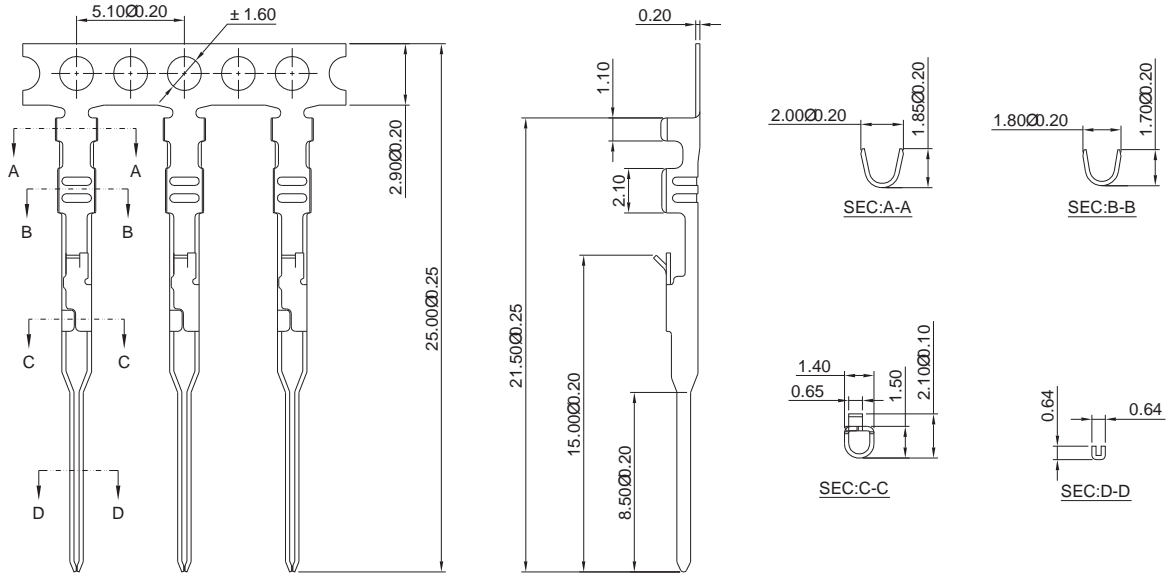

Ordering information & Specifications:

Unit:mm

Part NO.	Wire Range	Insulation O.D.	Material	Finish	Qty/reel
A2547M-TP	AWG#22-#24	1.60mm(max)	Phosphor Bronze	Tin over Nickel	15,000 PCS
A2547M-GP	AWG#22-#24	1.60mm(max)	Phosphor Bronze	Gold over Nickel	15,000 PCS

Optional Gold plating available but MOQ requested

A2547M-T-L

2.54mm Pitch Crimp Terminal

Reference Informations:

*Used in A2547HM,A2547H-2,A2547HE Single Row,A2547HF series Housing

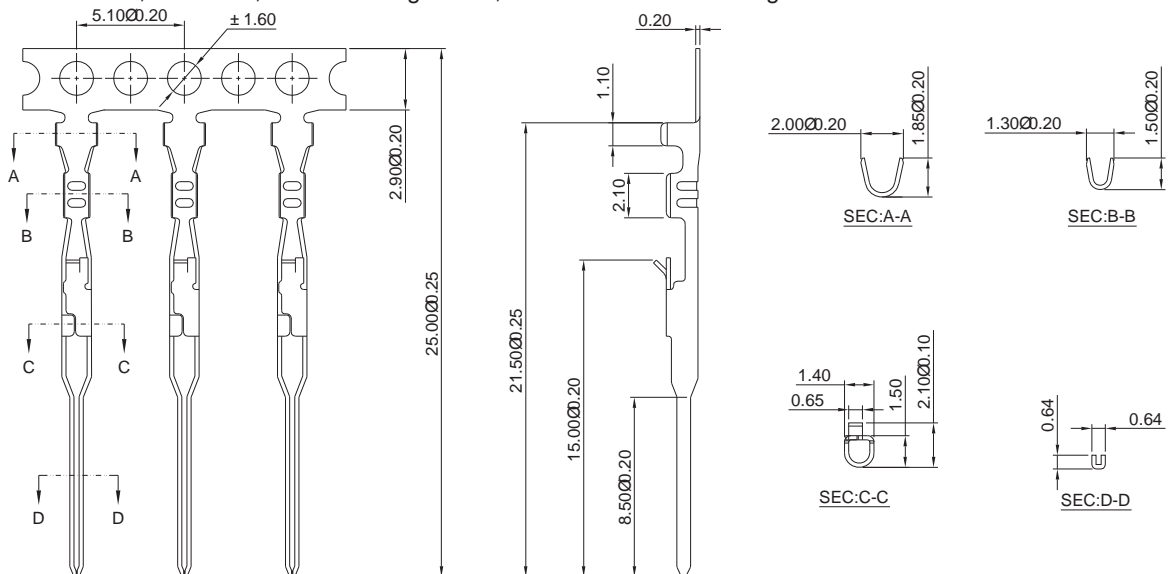

Ordering information & Specifications:

Unit:mm

Part NO.	Wire Range	Insulation O.D.	Material	Finish	Qty/reel
A2547M-TP-L	AWG#24-#30	1.60mm(max)	Phosphor Bronze	Tin over Nickel	15,000 PCS
A2547M-GP-L	AWG#24-#30	1.60mm(max)	Phosphor Bronze	Gold over Nickel	15,000 PCS

A2547 SERIES 2.54mm pitch wire to board and wire to wire connector

A2547M-T-B

2.54mm Pitch Crimp Terminal

Reference Informations:

*Used in A2547HMB series Housing

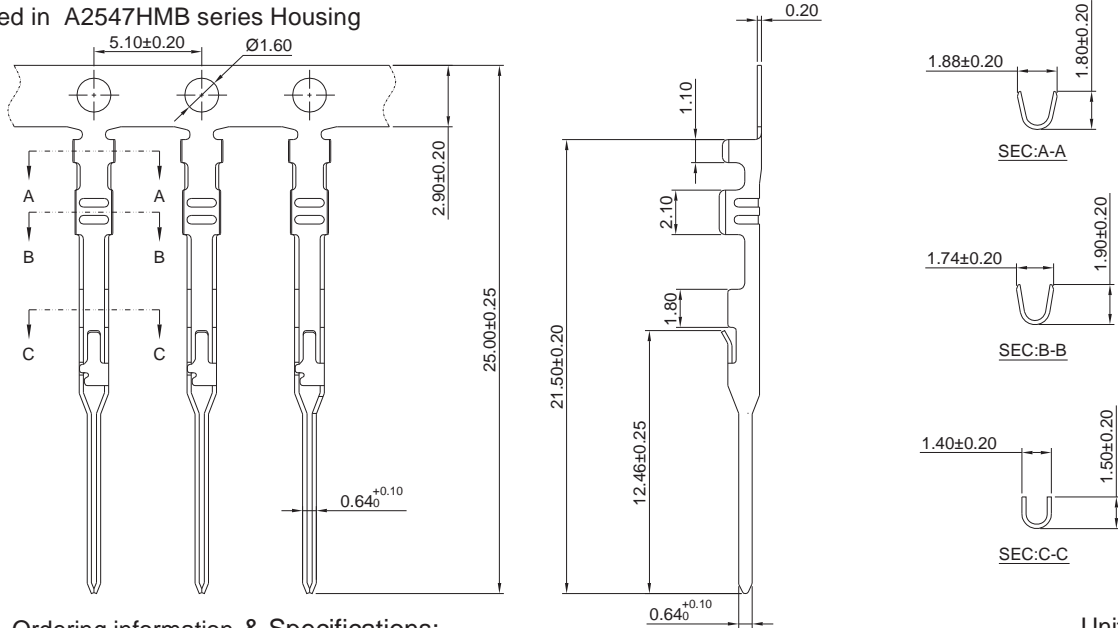

Ordering information & Specifications:

Unit:mm

Part NO.	Wire Range	Insulation O.D.	Material	Finish	Qty/reel
A2547M-TP-B	AWG#22-#26	1.63mm(max)	Phosphor Bronze	Tin over Nickel	15,000 PCS
A2547M-GP-B	AWG#22-#26	1.63mm(max)	Phosphor Bronze	Gold over Nickel	15,000 PCS

Optional Gold plating available but MOQ requested

A2547H

2.54mm Pitch Housing With Lock

Reference Informations:

*Material:PBT30%GF , UL94V-0

*Suitable A2547-T A2547-T-C A2547-T-Dseries Terminal

*Mates with A2547 series single row Housing

or A2547 series single row Wafer

*Color:Black

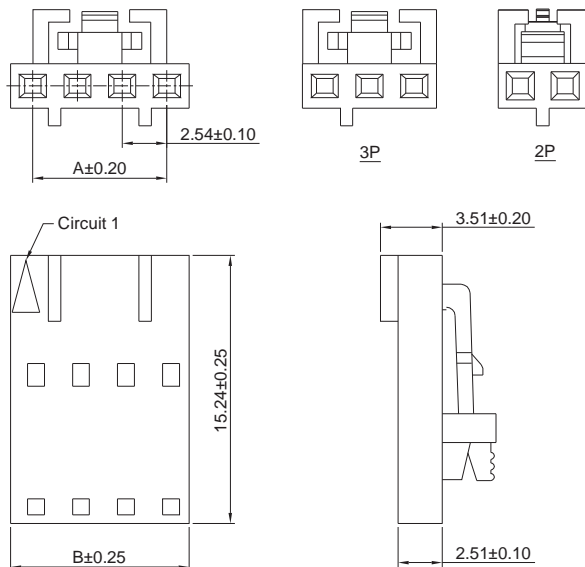
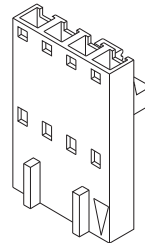

Ordering Information & Dimensions:

PART NO.	Dimensions	
	A	B
A2547H-2P	2.54	5.08
A2547H-3P	5.08	7.62
A2547H-4P	7.62	10.16
A2547H-5P	10.16	12.70
A2547H-6P	12.70	15.24
A2547H-7P	15.24	17.78
A2547H-8P	17.78	20.32
A2547H-9P	20.32	22.86
A2547H-10P	22.86	25.40
A2547H-11P	25.40	27.94
A2547H-12P	27.94	30.48
A2547H-13P	30.48	32.02
A2547H-14P	32.02	35.56
A2547H-15P	35.56	38.10
A2547H-16P	38.10	40.64
A2547H-17P	40.64	43.18
A2547H-18P	43.18	45.72
A2547H-19P	45.72	48.26
A2547H-20P	48.26	50.80
A2547H-21P	50.80	53.34
A2547H-22P	53.34	55.88
A2547H-23P	55.88	58.42
A2547H-24P	58.42	60.96
A2547H-25P	60.96	63.50

Unit: mm

A2547 SERIES 2.54mm pitch wire to board and wire to wire connector

A2547HS-T-S

2.54mm Pitch Crimp Terminal

Reference Informations:

*Used in A2547HS series Housing

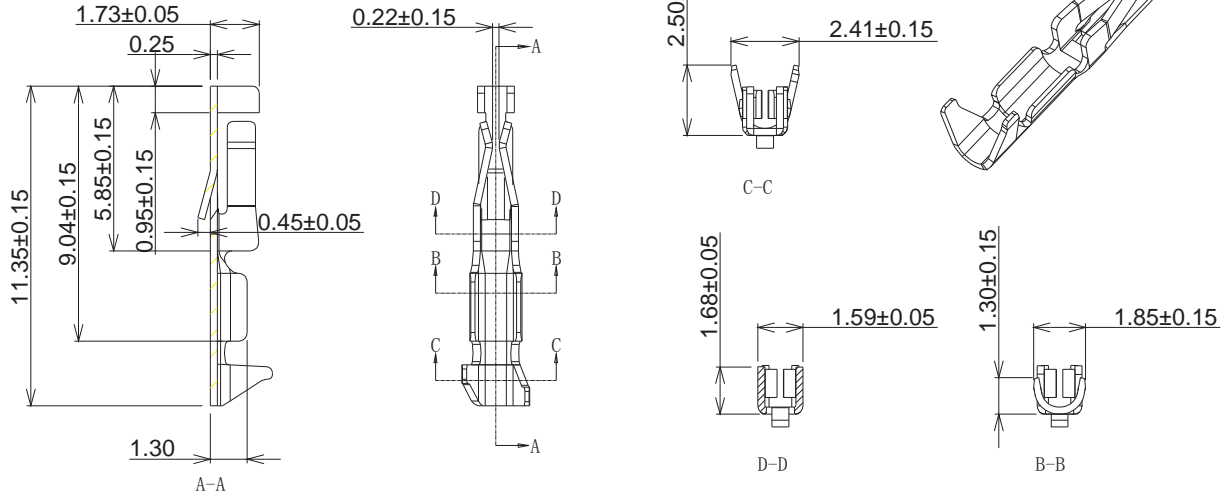

Ordering information & Specifications:

Unit:mm

Part NO.	Wire Range	Insulation O.D.	Material	Finish	Qty/reel
A2547HS-TP-S	AWG#22-#24	1.60mm(max)	Phosphor Bronze	Tin over Nickel	15,000 PCS
A2547HS-GP-S	AWG#22-#24	1.60mm(max)	Phosphor Bronze	Gold over Nickel	15,000 PCS

Optional Gold plating available but MOQ requested

A2547 SERIES 2.54mm pitch wire to board and wire to wire connector

A2547H-2

2.54mm Pitch Housing

Reference Informations:

- *Material: PBT30%GF , UL94V-0
- *Suitable A2547-T A2547M-T A2547-T-C A2547-T-D series Terminal
- *Mates with A2547 series single row Housing or A2547 series single row Wafer
- *Color: Black

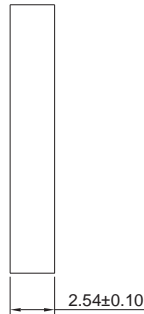
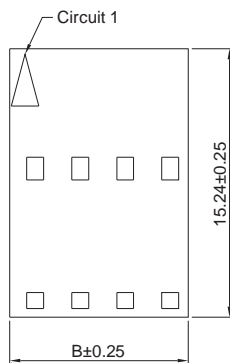
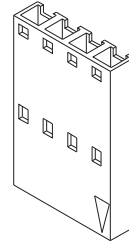
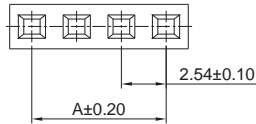

Ordering Information & Dimensions:

PART NO.	Dimensions	
	A	B
A2547H-2P-2	2.54	5.08
A2547H-3P-2	5.08	7.62
A2547H-4P-2	7.62	10.16
A2547H-5P-2	10.16	12.70
A2547H-6P-2	12.70	15.24
A2547H-7P-2	15.24	17.78
A2547H-8P-2	17.78	20.32
A2547H-9P-2	20.32	22.86
A2547H-10P-2	22.86	25.40
A2547H-11P-2	25.40	27.94
A2547H-12P-2	27.94	30.48
A2547H-13P-2	30.48	32.02
A2547H-14P-2	32.02	35.56
A2547H-15P-2	35.56	38.10
A2547H-16P-2	38.10	40.64
A2547H-17P-2	40.64	43.18
A2547H-18P-2	43.18	45.72
A2547H-19P-2	45.72	48.26
A2547H-20P-2	48.26	50.80
A2547H-21P-2	50.80	53.34
A2547H-22P-2	53.34	55.88
A2547H-23P-2	55.88	58.42
A2547H-24P-2	58.42	60.96
A2547H-25P-2	60.96	63.50

Unit: mm

A2547H-3

2.54mm Pitch Housing

Reference Informations:

- *Material: PBT30%GF , UL94V-0
- *Suitable A2547 A2547M series Terminal
- *Mates with A2547 series single row Housing or A2547 series single row Wafer
- *Color: Black

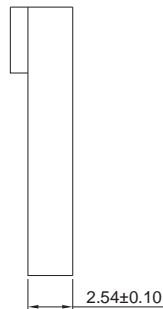
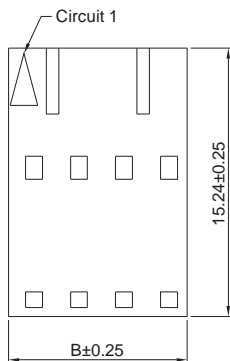
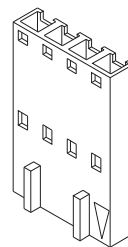
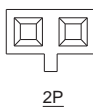
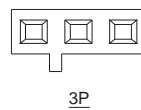
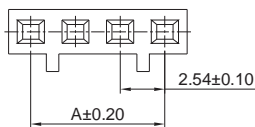

Ordering Information & Dimensions:

PART NO.	Dimensions	
	A	B
A2547H-2P-3	2.54	5.08
A2547H-3P-3	5.08	7.62
A2547H-4P-3	7.62	10.16
A2547H-5P-3	10.16	12.70
A2547H-6P-3	12.70	15.24
A2547H-7P-3	15.24	17.78
A2547H-8P-3	17.78	20.32
A2547H-9P-3	20.32	22.86
A2547H-10P-3	22.86	25.40
A2547H-11P-3	25.40	27.94
A2547H-12P-3	27.94	30.48
A2547H-13P-3	30.48	32.02
A2547H-14P-3	32.02	35.56
A2547H-15P-3	35.56	38.10
A2547H-16P-3	38.10	40.64
A2547H-17P-3	40.64	43.18
A2547H-18P-3	43.18	45.72
A2547H-19P-3	45.72	48.26
A2547H-20P-3	48.26	50.80
A2547H-21P-3	50.80	53.34
A2547H-22P-3	53.34	55.88
A2547H-23P-3	55.88	58.42
A2547H-24P-3	58.42	60.96
A2547H-25P-3	60.96	63.50

Unit: mm

A2547 SERIES 2.54mm pitch wire to board and wire to wire connector

A2547HA

2.54mm Pitch Housing With Lock

Reference Informations:

- *Material:PBT , UL94V-0
- *Suitable A2547-B series Terminal
- *Mates with A2547 series single row Wafer
- *Color:Black

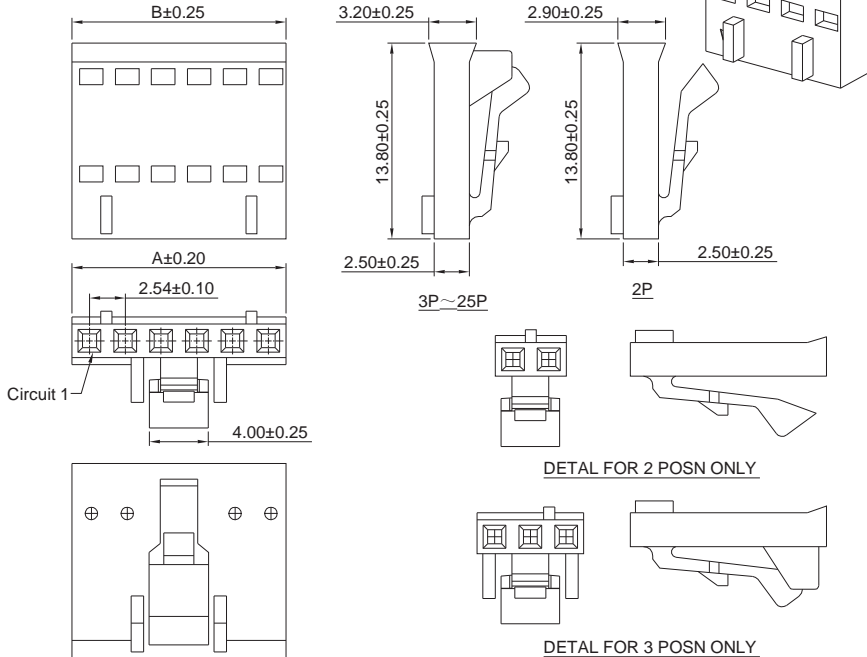

Ordering Information & Dimensions:

PART NO.	Dimensions	
	A	B
A2547HA-2P	2.54	4.92
A2547HA-3P	5.08	7.46
A2547HA-4P	7.62	10.00
A2547HA-5P	10.16	12.54
A2547HA-6P	12.70	15.08
A2547HA-7P	15.24	17.62
A2547HA-8P	17.78	20.16
A2547HA-9P	20.32	22.70
A2547HA-10P	22.86	25.24
A2547HA-11P	25.40	27.78
A2547HA-12P	27.94	30.32
A2547HA-13P	30.48	32.86
A2547HA-14P	32.02	35.40
A2547HA-15P	35.56	37.94
A2547HA-16P	38.10	40.48
A2547HA-17P	40.64	43.02
A2547HA-18P	43.18	45.56
A2547HA-19P	45.72	48.10
A2547HA-20P	48.26	50.64
A2547HA-21P	50.80	53.18
A2547HA-22P	53.34	55.72
A2547HA-23P	55.88	58.26
A2547HA-24P	58.42	60.80
A2547HA-25P	60.96	63.34

Unit: mm

A2547HB

2.54mm Pitch Housing

Reference Informations:

- *Material:PBT , UL94V-0
- *Suitable A2547-B series Terminal
- *Mates with A2547 series single row Wafer
- *Color:Black

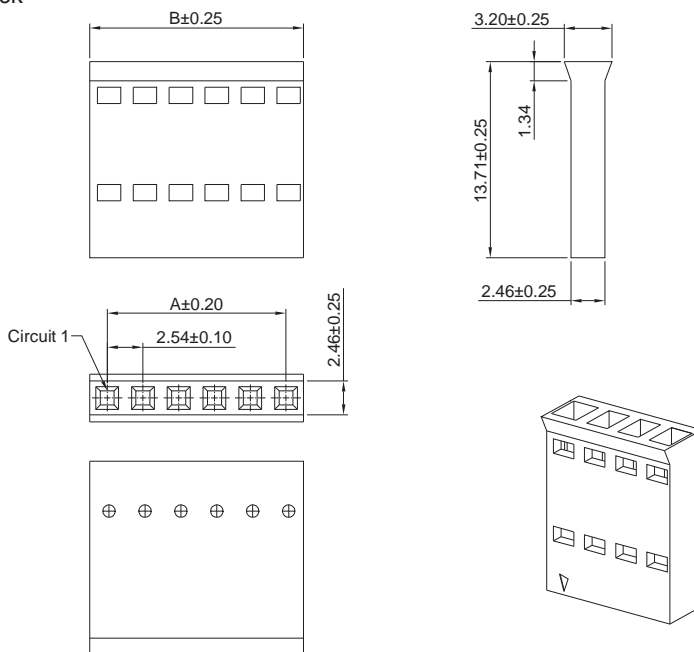

Ordering Information & Dimensions:

PART NO.	Dimensions	
	A	B
A2547HB-2P	2.54	4.92
A2547HB-3P	5.08	7.46
A2547HB-4P	7.62	10.00
A2547HB-5P	10.16	12.54
A2547HB-6P	12.70	15.08
A2547HB-7P	15.24	17.62
A2547HB-8P	17.78	20.16
A2547HB-9P	20.32	22.70
A2547HB-10P	22.86	25.24
A2547HB-11P	25.40	27.78
A2547HB-12P	27.94	30.32
A2547HB-13P	30.48	32.86
A2547HB-14P	32.02	35.40
A2547HB-15P	35.56	37.94
A2547HB-16P	38.10	40.48
A2547HB-17P	40.64	43.02
A2547HB-18P	43.18	45.56
A2547HB-19P	45.72	48.10
A2547HB-20P	48.26	50.64
A2547HB-21P	50.80	53.18
A2547HB-22P	53.34	55.72
A2547HB-23P	55.88	58.26
A2547HB-24P	58.42	60.80
A2547HB-25P	60.96	63.34

Unit: mm

A2547 SERIES 2.54mm pitch wire to board and wire to wire connector

A2547HE

2.54mm Pitch Housing

Reference Informations:

- *Material:PBT30%GF , UL94V-0
- *Suitable A2547-T A2547M-T A2547-T-C A2547-T-D series Terminal
- *Color:Black

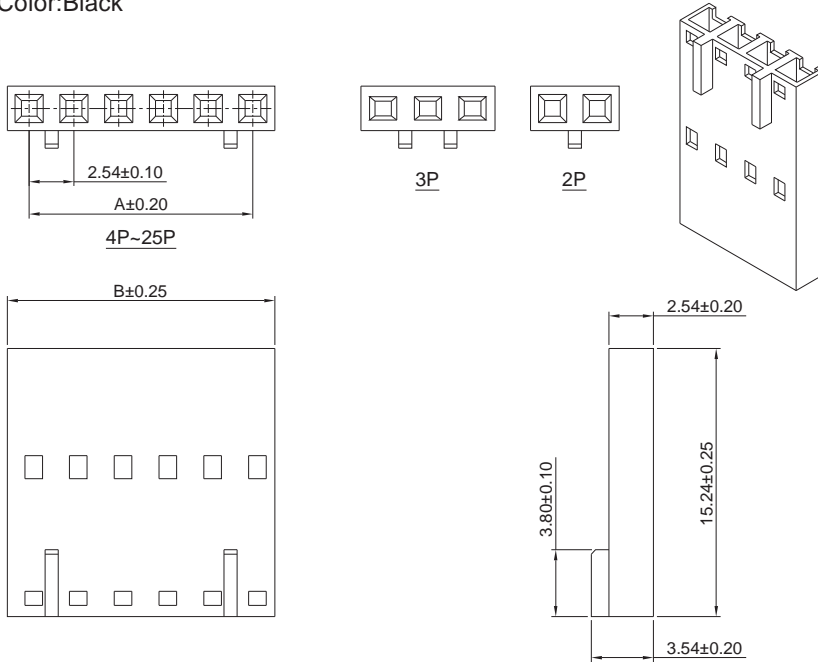

Ordering Information & Dimensions:

PART NO.	Dimensions	
	A	B
A2547HE-2P	2.54	5.08
A2547HE-3P	5.08	7.62
A2547HE-4P	7.62	10.16
A2547HE-5P	10.16	12.70
A2547HE-6P	12.70	15.24
A2547HE-7P	15.24	17.78
A2547HE-8P	17.78	20.32
A2547HE-9P	20.32	22.86
A2547HE-10P	22.86	25.40
A2547HE-11P	25.40	27.94
A2547HE-12P	27.94	30.48
A2547HE-13P	30.48	32.02
A2547HE-14P	32.02	35.56
A2547HE-15P	35.56	38.10
A2547HE-16P	38.10	40.64
A2547HE-17P	40.64	43.18
A2547HE-18P	43.18	45.72
A2547HE-19P	45.72	48.26
A2547HE-20P	48.26	50.80
A2547HE-21P	50.80	53.34
A2547HE-22P	53.34	55.88
A2547HE-23P	55.88	58.42
A2547HE-24P	58.42	60.96
A2547HE-25P	60.96	63.50

Unit: mm

A2547HG

2.54mm Pitch Housing

Reference Informations:

- *Material:PBT30%GF , UL94V-0
- *Suitable A2547-T A2547-T-C A2547-T-D series Terminal
- *Color:Black

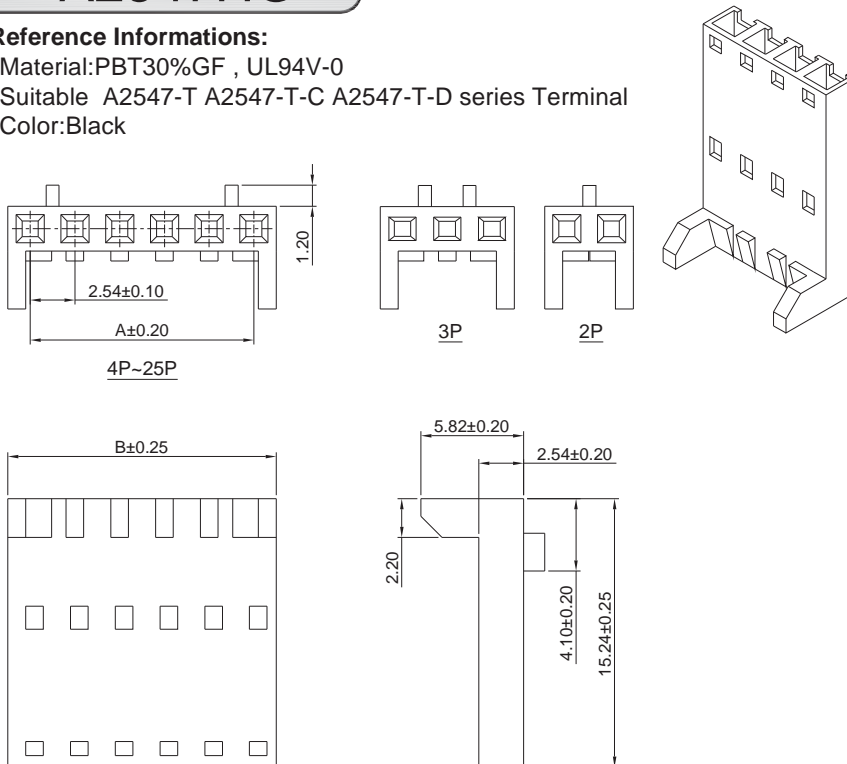

Ordering Information & Dimensions:

PART NO.	Dimensions	
	A	B
A2547HG-2P	2.54	5.08
A2547HG-3P	5.08	7.62
A2547HG-4P	7.62	10.16
A2547HG-5P	10.16	12.70
A2547HG-6P	12.70	15.24
A2547HG-7P	15.24	17.78
A2547HG-8P	17.78	20.32
A2547HG-9P	20.32	22.86
A2547HG-10P	22.86	25.40
A2547HG-11P	25.40	27.94
A2547HG-12P	27.94	30.48
A2547HG-13P	30.48	32.02
A2547HG-14P	32.02	35.56
A2547HG-15P	35.56	38.10
A2547HG-16P	38.10	40.64
A2547HG-17P	40.64	43.18
A2547HG-18P	43.18	45.72
A2547HG-19P	45.72	48.26
A2547HG-20P	48.26	50.80
A2547HG-21P	50.80	53.34
A2547HG-22P	53.34	55.88
A2547HG-23P	55.88	58.42
A2547HG-24P	58.42	60.96
A2547HG-25P	60.96	63.50

Unit: mm

A2547 SERIES 2.54mm pitch wire to board and wire to wire connector

A2547HC-2P

2.54mm Pitch Housing

Reference Informations:

- *Material:Nylon 66 , UL94V-0
- *Suitable A2547 series Terminal
- *Mates with A2547HMC-2P Housing
- *Color:White

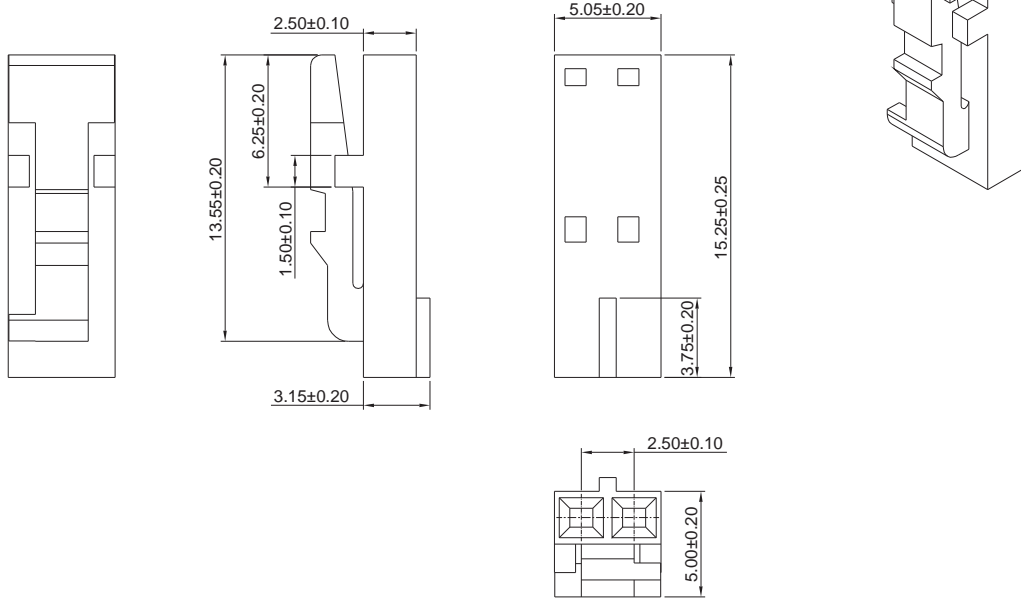

Unit: mm

A2547HD-2P

2.54mm Pitch Housing

Reference Informations:

- *Material:Nylon 66 , UL94V-0
- *Suitable A2547 series Terminal
- *Mates with A2547HMD-2P Housing
- *Color:Black

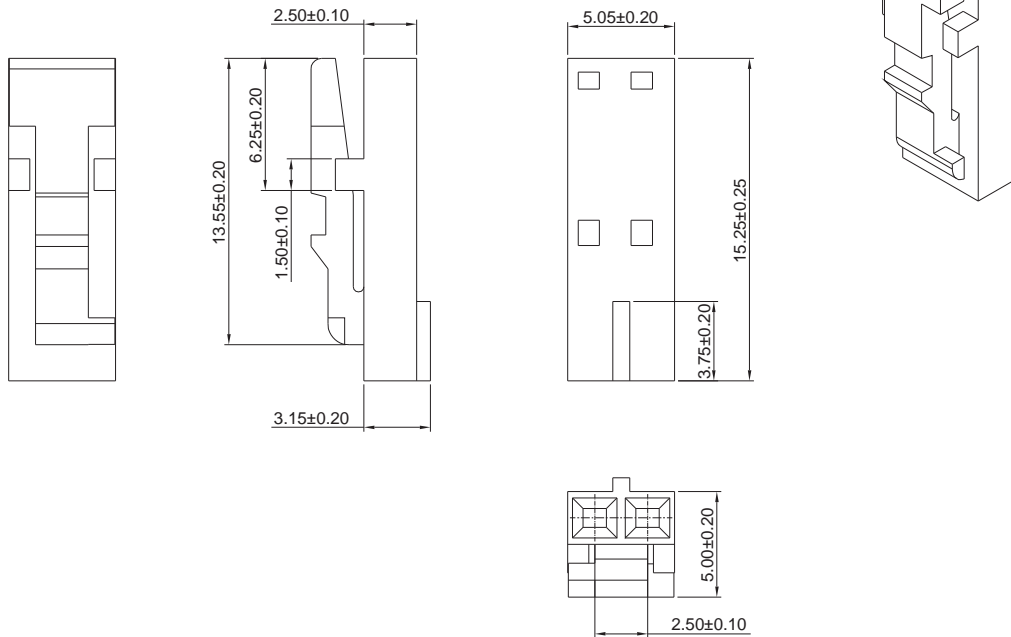

Unit: mm

A2547 SERIES 2.54mm pitch wire to board and wire to wire connector

A2547HMC-2P

2.54mm Pitch Housing

Reference Informations:

- *Material:Nylon 66 , UL94V-0
- *Suitable A2547M series Terminal
- *Mates with A2547HC-2P Housing
- *Color:White

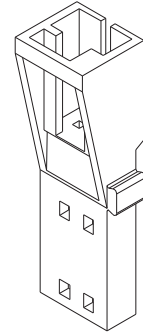
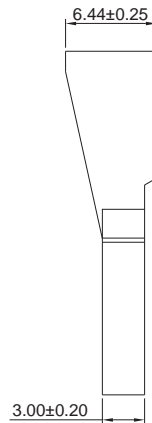
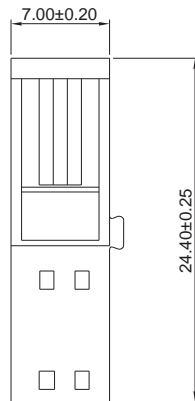
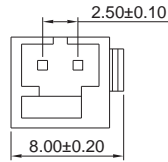

Unit: mm

A2547HMD-2P

2.54mm Pitch Housing

Reference Informations:

- *Material:Nylon 66 , UL94V-0
- *Suitable A2547M series Terminal
- *Mates with A2547HD-2P Housing
- *Color:White

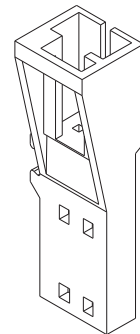
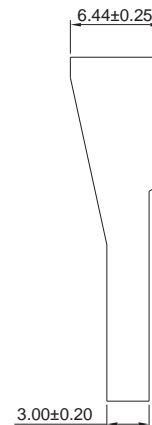
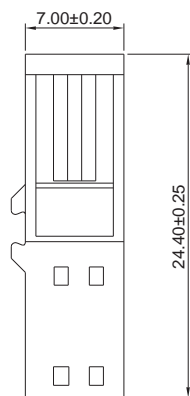
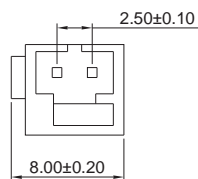

Unit: mm

A2547 SERIES 2.54mm pitch wire to board and wire to wire connector

A2547HM

2.54mm Pitch Housing With Lock

Reference Informations:

- *Material:PBT30%GF , UL94V-0
- *Suitable A2547M series Terminal
- *Mates with A2547H A2550H series single row Housing
- *Color:Black

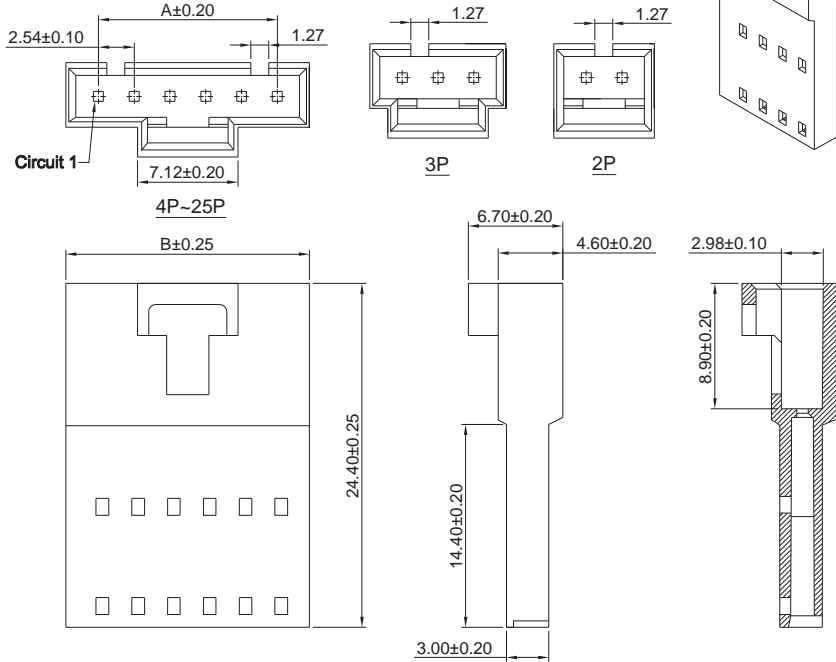

Ordering Information & Dimensions:

PART NO.	Dimensions	
	A	B
A2547HM-2P	2.54	7.12
A2547HM-3P	5.08	9.66
A2547HM-4P	7.62	12.20
A2547HM-5P	10.16	14.74
A2547HM-6P	12.70	17.28
A2547HM-7P	15.24	19.82
A2547HM-8P	17.78	22.36
A2547HM-9P	20.32	24.90
A2547HM-10P	22.86	27.44
A2547HM-11P	25.40	29.98
A2547HM-12P	27.94	32.52
A2547HM-13P	30.48	35.06
A2547HM-14P	32.02	37.60
A2547HM-15P	35.56	40.14
A2547HM-16P	38.10	42.68
A2547HM-17P	40.64	45.22
A2547HM-18P	43.18	47.76
A2547HM-19P	45.72	50.30
A2547HM-20P	48.26	52.84
A2547HM-21P	50.80	55.38
A2547HM-22P	53.34	57.92
A2547HM-23P	55.88	60.46
A2547HM-24P	58.42	63.00
A2547HM-25P	60.96	65.54

Unit: mm

A2547HMA

2.54mm Pitch Housing With Lock

Reference Informations:

- *Material:PBT30%GF , UL94V-0
- *Suitable A2547M series Terminal
- *Mates with A2547H A2550H series single row Housing
- *Color:Black

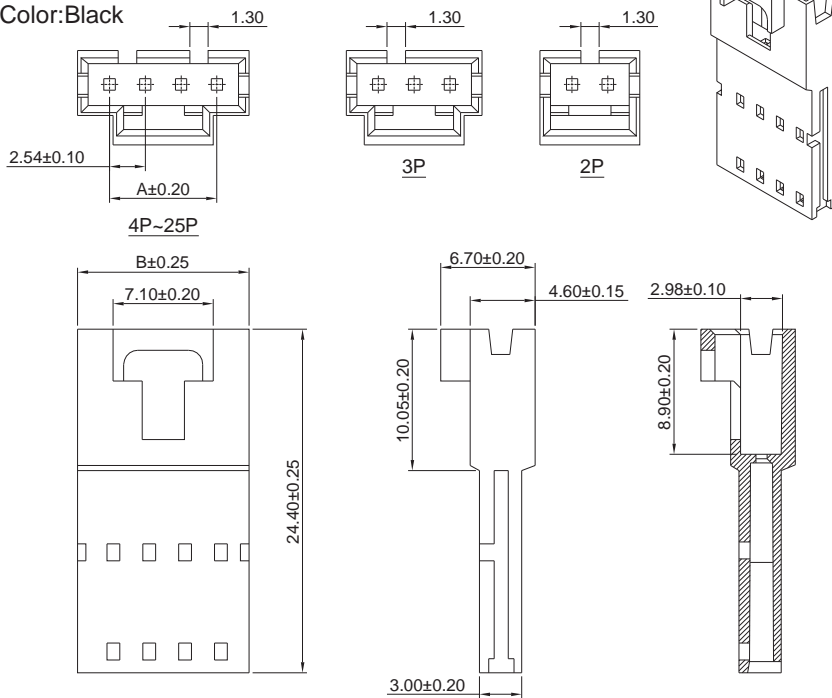

Ordering Information & Dimensions:

PART NO.	Dimensions	
	A	B
A2547HMA-2P	2.54	7.12
A2547HMA-3P	5.08	9.66
A2547HMA-4P	7.62	12.20
A2547HMA-5P	10.16	14.74
A2547HMA-6P	12.70	17.28
A2547HMA-7P	15.24	19.82
A2547HMA-8P	17.78	22.36
A2547HMA-9P	20.32	24.90
A2547HMA-10P	22.86	27.44
A2547HMA-11P	25.40	29.98
A2547HMA-12P	27.94	32.52
A2547HMA-13P	30.48	35.06
A2547HMA-14P	32.02	37.60
A2547HMA-15P	35.56	40.14
A2547HMA-16P	38.10	42.68
A2547HMA-17P	40.64	45.22
A2547HMA-18P	43.18	47.76
A2547HMA-19P	45.72	50.30
A2547HMA-20P	48.26	52.84
A2547HMA-21P	50.80	55.38
A2547HMA-22P	53.34	57.92
A2547HMA-23P	55.88	60.46
A2547HMA-24P	58.42	63.00
A2547HMA-25P	60.96	65.54

Unit: mm

A2547 SERIES 2.54mm pitch wire to board and wire to wire connector

A2547HMB

2.54mm Pitch Housing With Lock

Reference Informations:

- *Material: PBT30%GF, UL94V-0
- *Suitable A2547M-B series Terminal
- *Mates with A2547H A2550H series single row Housing
- *Color: Black

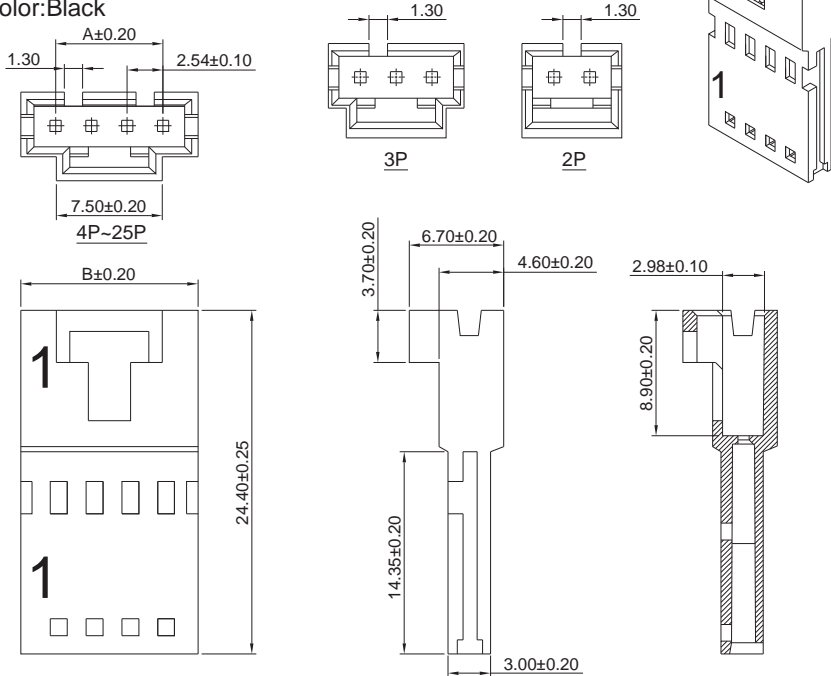

Ordering Information & Dimensions:

PART NO.	Dimensions	
	A	B
A2547HMB-2P	2.54	7.50
A2547HMB-3P	5.08	10.04
A2547HMB-4P	7.62	12.58
A2547HMB-5P	10.16	15.12
A2547HMB-6P	12.70	17.66
A2547HMB-7P	15.24	20.20
A2547HMB-8P	17.78	22.74
A2547HMB-9P	20.32	25.28
A2547HMB-10P	22.86	27.82
A2547HMB-11P	25.40	30.36
A2547HMB-12P	27.94	32.90
A2547HMB-13P	30.48	35.44
A2547HMB-14P	32.02	37.98
A2547HMB-15P	35.56	40.52
A2547HMB-16P	38.10	43.06
A2547HMB-17P	40.64	45.60
A2547HMB-18P	43.18	48.14
A2547HMB-19P	45.72	50.68
A2547HMB-20P	48.26	53.22
A2547HMB-21P	50.80	55.76
A2547HMB-22P	53.34	58.30
A2547HMB-23P	55.88	60.84
A2547HMB-24P	58.42	63.38
A2547HMB-25P	60.96	65.92

Unit: mm

A2547HMB-4P-A

2.54mm Pitch Housing With Lock

Reference Informations:

- *Material: PBT30%GF, UL94V-0
- *Suitable A2547M-B series Terminal
- *Mates with A2550H series single row Housing
- *Color: Black

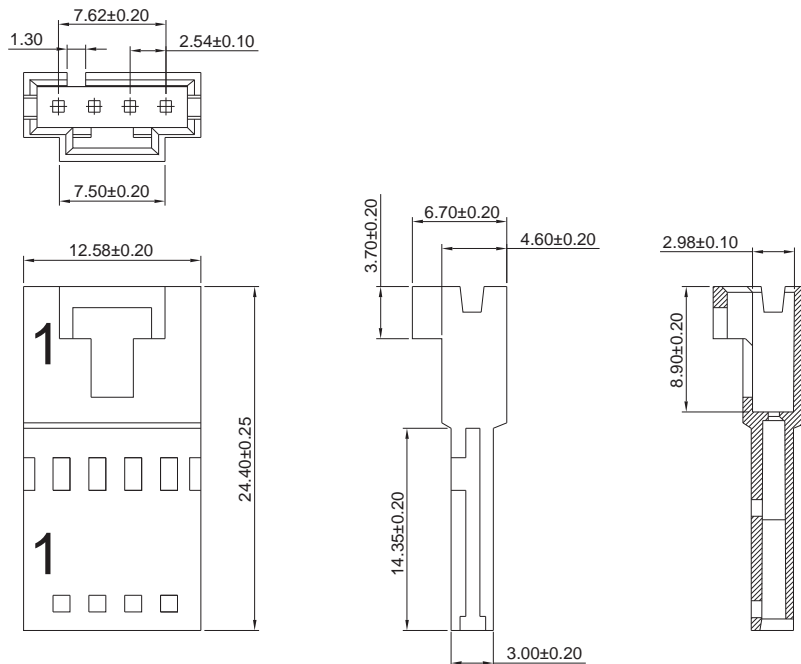

Unit: mm

A2547 SERIES

2.54mm pitch wire to board and wire to wire connector

A2547H-2

2.54mm Pitch Dual Row Housing

Reference Informations:

- *Material: PBT30%GF, UL94V-0
- *Suitable A2547 series Terminal
- *Mates with A2547WV-2 series Wafer or CJT A2547WR-2 series Wafer
- *Color: Black

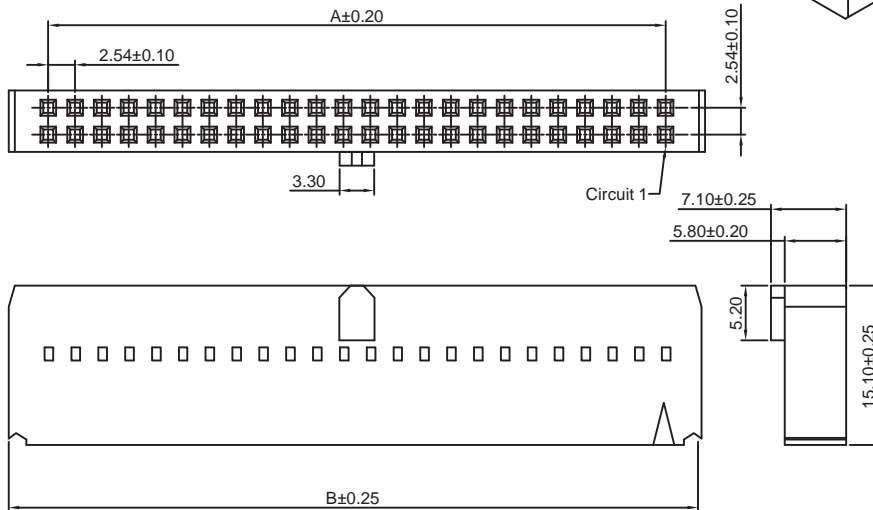
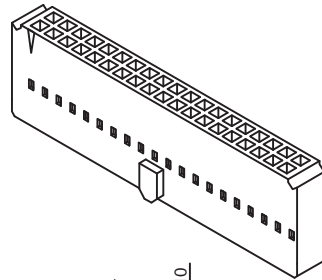

Ordering Information & Dimensions:

PART NO.	Dimensions	
	A	B
A2547H-2x3P	5.08	12.22
A2547H-2x4P	7.62	14.76
A2547H-2x5P	10.16	17.30
A2547H-2x6P	12.70	19.84
A2547H-2x7P	15.24	22.38
A2547H-2x8P	17.78	24.92
A2547H-2x9P	20.32	27.46
A2547H-2x10P	22.86	30.00
A2547H-2x11P	25.40	32.54
A2547H-2x12P	27.94	35.08
A2547H-2x13P	30.48	37.62
A2547H-2x14P	33.02	40.16
A2547H-2x15P	35.56	42.70
A2547H-2x16P	38.10	45.24
A2547H-2x17P	40.64	47.78
A2547H-2x18P	43.18	50.32
A2547H-2x19P	45.72	52.86
A2547H-2x20P	48.26	55.40
A2547H-2x21P	50.80	57.94
A2547H-2x22P	53.34	60.48
A2547H-2x23P	55.88	63.02
A2547H-2x24P	58.42	65.56
A2547H-2x25P	60.96	68.10
A2547H-2x26P	63.50	70.64
A2547H-2x27P	66.04	73.18
A2547H-2x28P	68.58	75.72
A2547H-2x29P	71.12	78.26
A2547H-2x30P	73.66	80.80
A2547H-2x31P	76.20	83.34
A2547H-2x32P	78.74	85.88

Unit: mm

A2547HA-2

2.54mm Pitch Dual Row Housing

Reference Informations:

- *Material: PBT30%GF, UL94V-0
- *Suitable A2547 series Terminal
- *Mates with A2547WV-2 series Wafer or CJT A2547WR-2 series Wafer
- *Color: Black

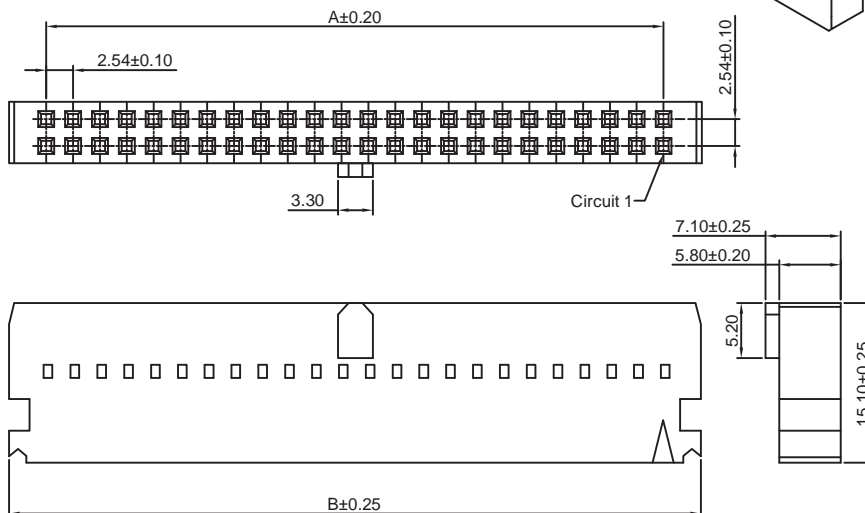
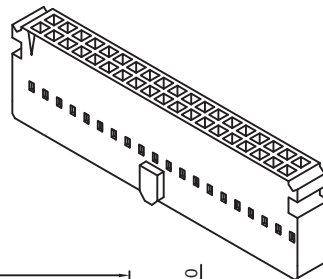

Ordering Information & Dimensions:

PART NO.	Dimensions	
	A	B
A2547HA-2x3P	5.08	12.22
A2547HA-2x4P	7.62	14.76
A2547HA-2x5P	10.16	17.30
A2547HA-2x6P	12.70	19.84
A2547HA-2x7P	15.24	22.38
A2547HA-2x8P	17.78	24.92
A2547HA-2x9P	20.32	27.46
A2547HA-2x10P	22.86	30.00
A2547HA-2x11P	25.40	32.54
A2547HA-2x12P	27.94	35.08
A2547HA-2x13P	30.48	37.62
A2547HA-2x14P	33.02	40.16
A2547HA-2x15P	35.56	42.40
A2547HA-2x16P	38.10	45.24
A2547HA-2x17P	40.64	47.78
A2547HA-2x18P	43.18	50.32
A2547HA-2x19P	45.72	52.86
A2547HA-2x20P	48.26	55.40
A2547HA-2x21P	50.80	57.94
A2547HA-2x22P	53.34	60.48
A2547HA-2x23P	55.88	63.02
A2547HA-2x24P	58.42	65.56
A2547HA-2x25P	60.96	68.10
A2547HA-2x26P	63.50	70.64
A2547HA-2x27P	66.04	73.18
A2547HA-2x28P	68.58	75.72
A2547HA-2x29P	71.12	78.26
A2547HA-2x30P	73.66	80.80
A2547HA-2x31P	76.20	83.34
A2547HA-2x32P	78.74	85.88

Unit: mm

A2547 SERIES

2.54mm pitch wire to board and wire to wire connector

A2547HD-2

2.54mm Pitch Dual Row Housing

Reference Informations:

- *Material: PBT30%GF, UL94V-0
- *Suitable A2547 series Terminal
- *Mates with A2547WVA-2 series Wafer or CJT A2547WRA-2 series Wafer
- *Color: Black

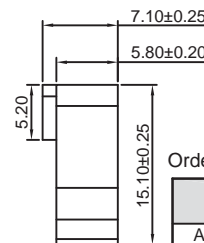
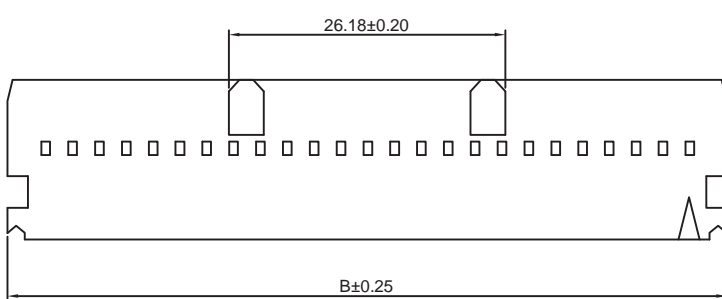
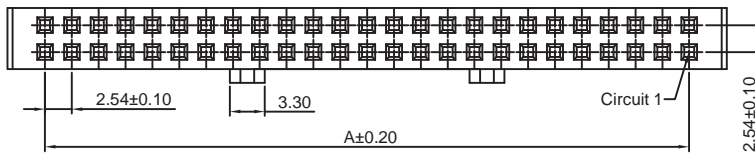
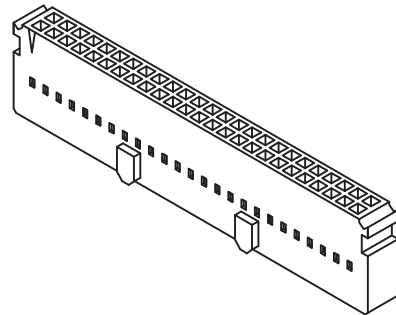

Ordering Information & Dimensions:

PART NO.	Dimensions	
	A	B
A2547HD-2x25P	60.96	68.10
A2547HD-2x30P	73.66	80.80
A2547HD-2x32P	78.74	85.88

Unit: mm

A2547HE-2

2.54mm Pitch Dual Row Housing

Reference Informations:

- *Material: PBT30%GF, UL94V-0
- *Suitable A2547 series Terminal
- *Mates with A2547WV-N-2 series Wafer or CJT A2547WR-N-2 series Wafer
- *Color: Black

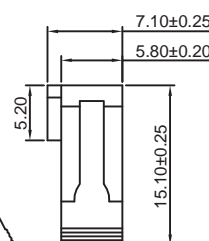
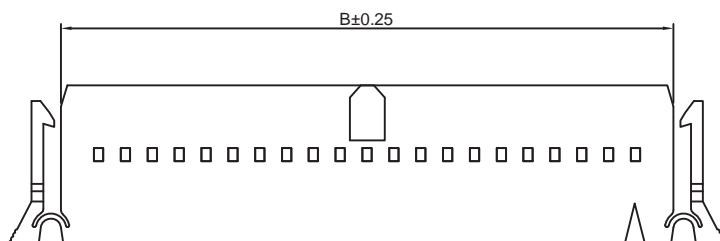
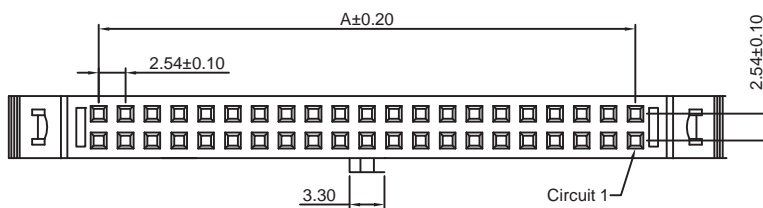
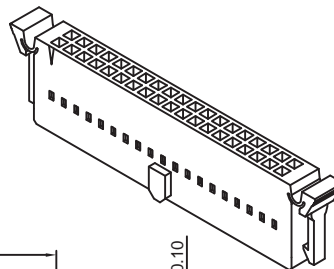

Ordering Information & Dimensions:

PART NO.	Dimensions	
	A	B
A2547HE-2x3P	5.08	12.22
A2547HE-2x4P	7.62	14.76
A2547HE-2x5P	10.16	17.30
A2547HE-2x6P	12.70	19.84
A2547HE-2x7P	15.24	22.38
A2547HE-2x8P	17.78	24.92
A2547HE-2x9P	20.32	27.46
A2547HE-2x10P	22.86	30.00
A2547HE-2x11P	25.40	32.54
A2547HE-2x12P	27.94	35.08
A2547HE-2x13P	30.48	37.62
A2547HE-2x14P	33.02	40.16
A2547HE-2x15P	35.56	42.40
A2547HE-2x16P	38.10	45.24
A2547HE-2x17P	40.64	47.78
A2547HE-2x18P	43.18	50.32
A2547HE-2x19P	45.72	52.86
A2547HE-2x20P	48.26	55.40
A2547HE-2x21P	50.80	57.94
A2547HE-2x22P	53.34	60.48
A2547HE-2x23P	55.88	63.02
A2547HE-2x24P	58.42	65.56
A2547HE-2x25P	60.96	68.10
A2547HE-2x26P	63.50	70.64
A2547HE-2x27P	66.04	73.18
A2547HE-2x28P	68.58	75.72
A2547HE-2x29P	71.12	78.26
A2547HE-2x30P	73.66	80.80
A2547HE-2x31P	76.20	83.34
A2547HE-2x32P	78.74	85.88

Unit: mm

A2547 SERIES

2.54mm pitch wire to board and wire to wire connector

A2547HF-2

2.54mm Pitch Dual Row Housing

Reference Informations:

- *Material:PBT30%GF , UL94V-0
- *Suitable A2547 series Terminal
- *Mates with A2547WV-2 series Wafer or CJT A2547WR-2 series Wafer
- *Color:Black

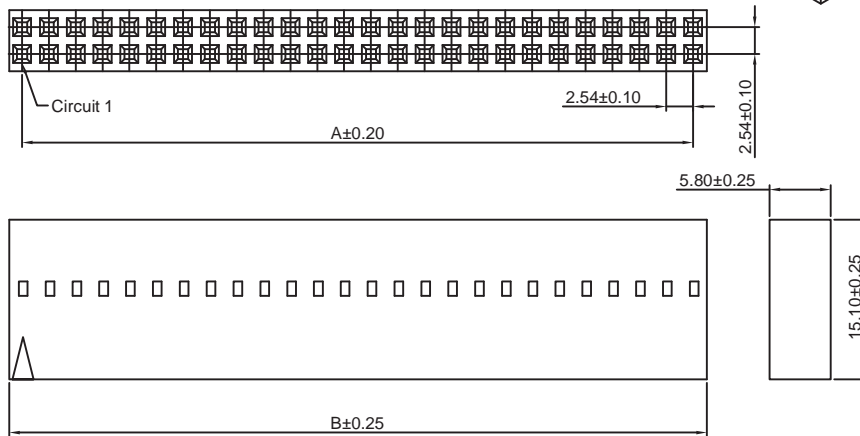
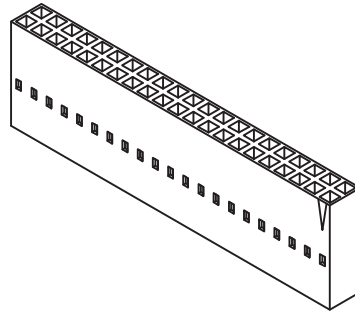

Ordering Information & Dimensions:

PART NO.	Dimensions	
	A	B
A2547HF-2x2P	2.54	5.05
A2547HF-2x3P	5.08	7.59
A2547HF-2x4P	7.62	10.13
A2547HF-2x5P	10.16	12.67
A2547HF-2x6P	12.70	15.21
A2547HF-2x7P	15.24	17.75
A2547HF-2x8P	17.78	20.29
A2547HF-2x9P	20.32	22.83
A2547HF-2x10P	22.86	25.37
A2547HF-2x11P	25.40	27.91
A2547HF-2x12P	27.94	30.45
A2547HF-2x13P	30.48	32.99
A2547HF-2x14P	33.02	35.53
A2547HF-2x15P	35.56	38.07
A2547HF-2x16P	38.10	40.61
A2547HF-2x17P	40.64	43.15
A2547HF-2x18P	43.18	45.69
A2547HF-2x19P	45.72	48.23
A2547HF-2x20P	48.26	50.77
A2547HF-2x21P	50.80	53.31
A2547HF-2x22P	53.34	55.85
A2547HF-2x23P	55.88	58.39
A2547HF-2x24P	58.42	60.93
A2547HF-2x25P	60.96	63.47
A2547HF-2x26P	63.50	66.01
A2547HF-2x27P	66.04	68.55
A2547HF-2x28P	68.58	71.09
A2547HF-2x29P	71.12	73.63
A2547HF-2x30P	73.66	76.17
A2547HF-2x31P	76.20	78.71
A2547HF-2x32P	78.74	81.25

Unit: mm

A2547HG-2

2.54mm Pitch Dual Row Housing

Reference Informations:

- *Material:PBT30%GF , UL94V-0
- *Suitable A2547 series Terminal
- *Mates with A2547WV-2 series Wafer or CJT A2547WR-2 series Wafer
- *Color:Black

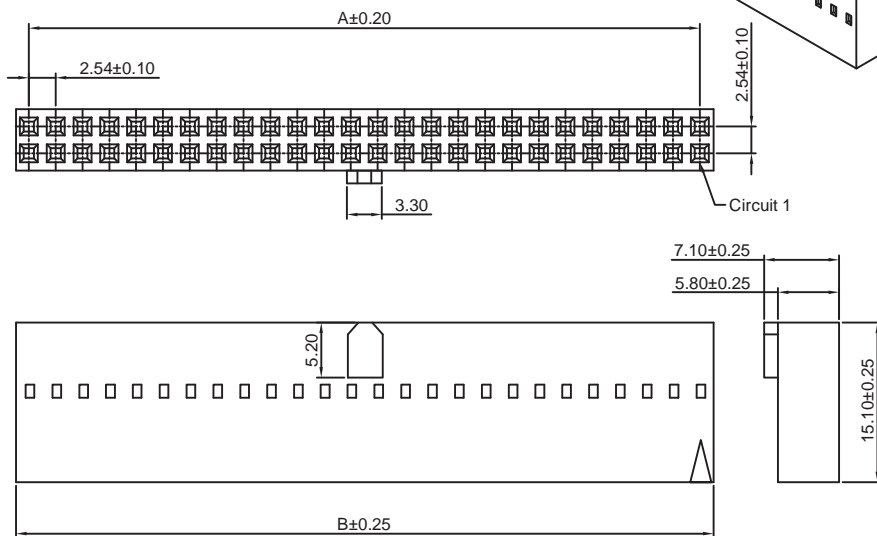
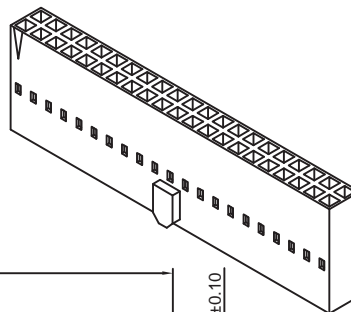

Ordering Information & Dimensions:

PART NO.	Dimensions	
	A	B
A2547HG-2x3P	5.08	7.59
A2547HG-2x4P	7.62	10.13
A2547HG-2x5P	10.16	12.67
A2547HG-2x6P	12.70	15.21
A2547HG-2x7P	15.24	17.75
A2547HG-2x8P	17.78	20.29
A2547HG-2x9P	20.32	22.83
A2547HG-2x10P	22.86	25.37
A2547HG-2x11P	25.40	27.91
A2547HG-2x12P	27.94	30.45
A2547HG-2x13P	30.48	32.99
A2547HG-2x14P	33.02	35.53
A2547HG-2x15P	35.56	38.07
A2547HG-2x16P	38.10	40.61
A2547HG-2x17P	40.64	43.15
A2547HG-2x18P	43.18	45.69
A2547HG-2x19P	45.72	48.23
A2547HG-2x20P	48.26	50.77
A2547HG-2x21P	50.80	53.31
A2547HG-2x22P	53.34	55.85
A2547HG-2x23P	55.88	58.39
A2547HG-2x24P	58.42	60.93
A2547HG-2x25P	60.96	63.47
A2547HG-2x26P	63.50	66.01
A2547HG-2x27P	66.04	68.55
A2547HG-2x28P	68.58	71.09
A2547HG-2x29P	71.12	73.63
A2547HG-2x30P	73.66	76.17
A2547HG-2x31P	76.20	78.71
A2547HG-2x32P	78.74	81.25

Unit: mm

A2547 SERIES

2.54mm pitch wire to board and wire to wire connector

A2547HJ-2

2.54mm Pitch Dual Row Housing

Reference Informations:

- *Material:PBT30%GF , UL94V-0
- *Suitable A2547 series Terminal
- *Mates with A2547WVB , A2547WRB series Dual row Wafer
- *Color:Black

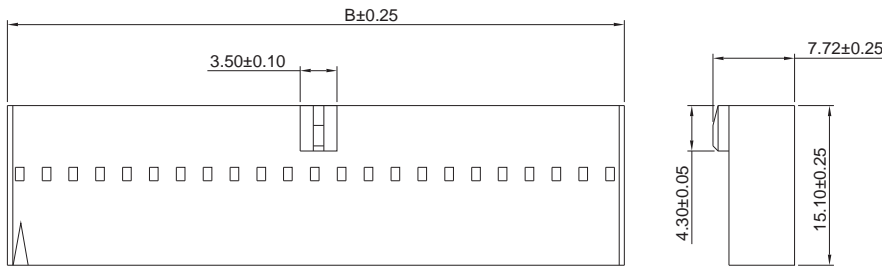
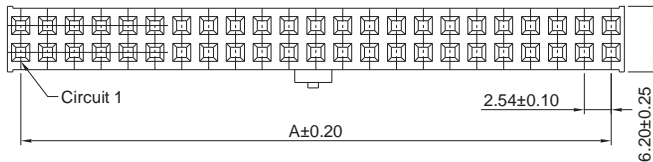
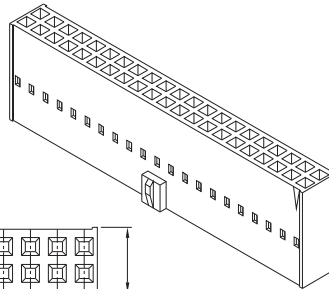

Ordering Information & Dimensions:

PART NO.	Dimensions	
	A	B
A2547HJ-2x3P	5.08	7.59
A2547HJ-2x4P	7.62	10.13
A2547HJ-2x5P	10.16	12.67
A2547HJ-2x6P	12.70	15.21
A2547HJ-2x7P	15.24	17.75
A2547HJ-2x8P	17.78	20.29
A2547HJ-2x9P	20.32	22.83
A2547HJ-2x10P	22.86	25.37
A2547HJ-2x11P	25.40	27.91
A2547HJ-2x12P	27.94	30.45
A2547HJ-2x13P	30.48	32.99
A2547HJ-2x14P	33.02	35.53
A2547HJ-2x15P	35.56	38.07
A2547HJ-2x16P	38.10	40.61
A2547HJ-2x17P	40.64	43.15
A2547HJ-2x18P	43.18	45.69
A2547HJ-2x19P	45.72	48.23
A2547HJ-2x20P	48.26	50.77
A2547HJ-2x21P	50.80	53.31
A2547HJ-2x22P	53.34	55.85
A2547HJ-2x23P	55.88	58.39
A2547HJ-2x24P	58.42	60.93
A2547HJ-2x25P	60.96	63.47
A2547HJ-2x26P	63.50	66.01
A2547HJ-2x27P	66.04	68.55
A2547HJ-2x28P	68.58	71.09
A2547HJ-2x29P	71.12	73.63
A2547HJ-2x30P	73.66	76.17
A2547HJ-2x31P	76.20	78.71
A2547HJ-2x32P	78.74	81.25

Unit: mm

A2547HJ

2.54mm Pitch Single Row Housing

Reference Informations:

- *Material:PBT , UL94V-0
- *Suitable A2547 series Terminal
- *Mates with A2547WVB A2547WRB series Single Row Wafer
- *Color:Black

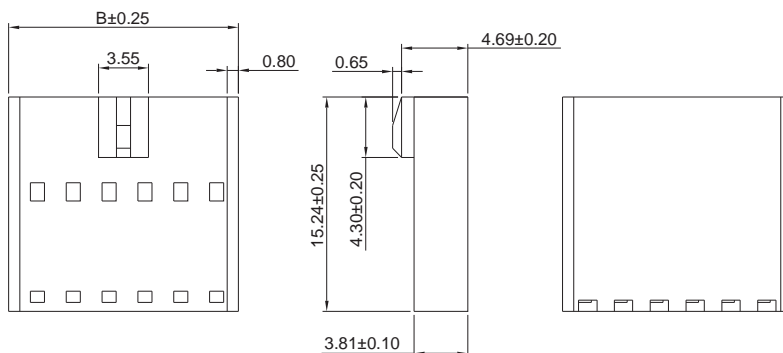
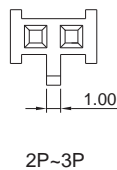
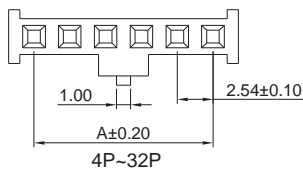
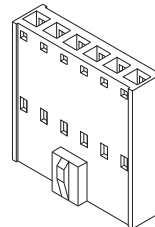

Ordering Information & Dimensions:

PART NO.	Dimensions	
	A	B
A2547HJ-2P	2.54	6.14
A2547HJ-3P	5.08	8.68
A2547HJ-4P	7.62	11.22
A2547HJ-5P	10.16	13.76
A2547HJ-6P	12.70	16.30
A2547HJ-7P	15.24	18.84
A2547HJ-8P	17.78	21.38
A2547HJ-9P	20.32	23.92
A2547HJ-10P	22.86	26.46
A2547HJ-11P	25.40	29.00
A2547HJ-12P	27.94	31.54
A2547HJ-13P	30.48	34.08
A2547HJ-14P	33.02	36.62
A2547HJ-15P	35.56	39.16
A2547HJ-16P	38.10	41.70
A2547HJ-17P	40.64	44.24
A2547HJ-18P	43.18	46.78
A2547HJ-19P	45.72	49.32
A2547HJ-20P	48.26	51.86
A2547HJ-21P	50.80	54.40
A2547HJ-22P	53.34	56.94
A2547HJ-23P	55.88	59.48
A2547HJ-24P	58.42	62.02
A2547HJ-25P	60.96	64.56
A2547HJ-26P	63.50	67.10
A2547HJ-27P	66.04	69.64
A2547HJ-28P	68.58	72.18
A2547HJ-29P	71.12	74.72
A2547HJ-30P	73.66	77.26
A2547HJ-31P	76.20	79.80
A2547HJ-32P	78.74	82.34

Unit: mm

A2547 SERIES

2.54mm pitch wire to board and wire to wire connector

A2547HS-2

2.54mm Pitch 180° Box Header

Reference Informations:

- *Material: PBT15%GF , UL94V-0
- *Suitable A2547 series Terminal
- *Mates with A2547WVB , A2547WRB series Dual row Wafer
- *Color: Black

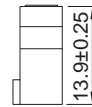
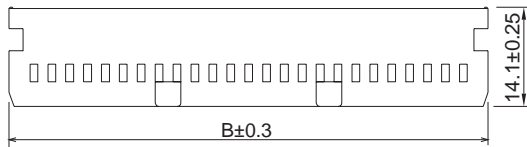
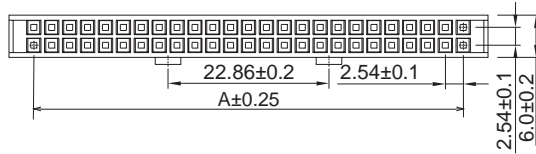
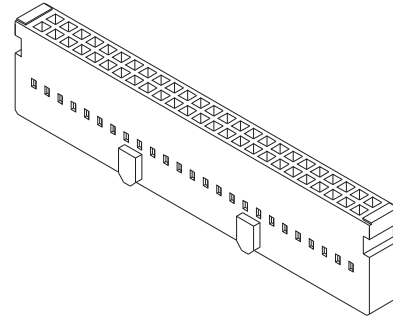

Ordering Information & Dimensions:

PART NO.	Dimensions	
	A	B
A2547HS-2x25P	60.96	68.00
A2547HS-2x30P	73.66	80.70
A2547HS-2x32P	78.74	85.78

Unit: mm

A2547 SERIES

2.54mm pitch wire to board and wire to wire connector

A2547WV

2.54mm Pitch 180° Wafer

Reference Informations:

- *Material:Pin:Brass/Gold over Nickel
Insulator:PBT30%GF , UL94V-0
- *Mates with A2547 series Housing
- *Color:Black

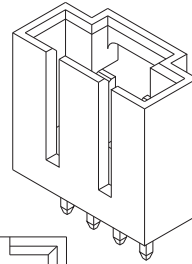
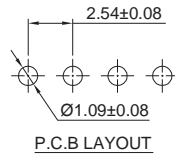

Ordering Information & Dimensions:

PART NO.	Dimensions	
	A	B
A2547WV-2P	2.54	7.62
A2547WV-3P	5.08	10.16
A2547WV-4P	7.62	12.70
A2547WV-5P	10.16	15.24
A2547WV-6P	12.70	17.78
A2547WV-7P	15.24	20.32
A2547WV-8P	17.78	22.86
A2547WV-9P	20.32	25.40
A2547WV-10P	22.86	27.94
A2547WV-11P	25.40	30.48
A2547WV-12P	27.94	32.02
A2547WV-13P	30.48	35.56
A2547WV-14P	32.02	38.10
A2547WV-15P	35.56	40.64
A2547WV-16P	38.10	43.18
A2547WV-17P	40.64	45.72
A2547WV-18P	43.18	48.26
A2547WV-19P	45.72	50.80
A2547WV-20P	48.26	53.34
A2547WV-21P	50.80	55.88
A2547WV-22P	53.34	58.42
A2547WV-23P	55.88	60.96
A2547WV-24P	58.42	63.50
A2547WV-25P	60.96	66.04

Unit: mm

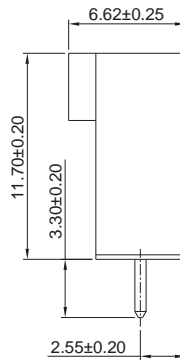
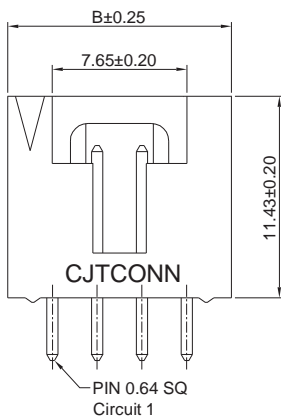
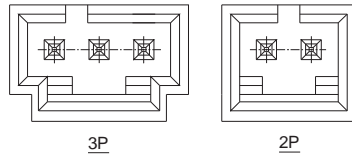
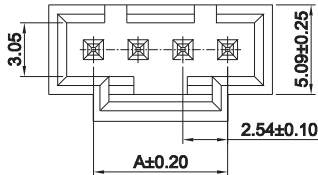

A2547WR

2.54mm Pitch 90° Wafer

Reference Informations:

- *Material:Pin:Brass/Gold over Nickel
Insulator:PBT30%GF , UL94V-0
- *Mates with A2547 series Housing
- *Color:Black

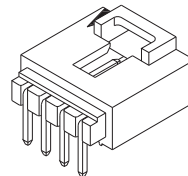
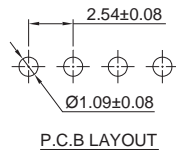

Ordering Information & Dimensions:

PART NO.	Dimensions	
	A	B
A2547WR-2P	2.54	7.62
A2547WR-3P	5.08	10.16
A2547WR-4P	7.62	12.70
A2547WR-5P	10.16	15.24
A2547WR-6P	12.70	17.78
A2547WR-7P	15.24	20.32
A2547WR-8P	17.78	22.86
A2547WR-9P	20.32	25.40
A2547WR-10P	22.86	27.94
A2547WR-11P	25.40	30.48
A2547WR-12P	27.94	32.02
A2547WR-13P	30.48	35.56
A2547WR-14P	32.02	38.10
A2547WR-15P	35.56	40.64
A2547WR-16P	38.10	43.18
A2547WR-17P	40.64	45.72
A2547WR-18P	43.18	48.26
A2547WR-19P	45.72	50.80
A2547WR-20P	48.26	53.34
A2547WR-21P	50.80	55.88
A2547WR-22P	53.34	58.42
A2547WR-23P	55.88	60.96
A2547WR-24P	58.42	63.50
A2547WR-25P	60.96	66.04

Unit: mm

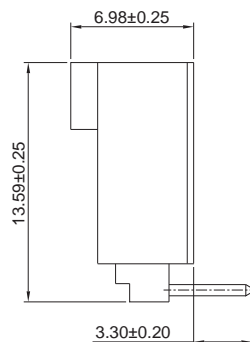
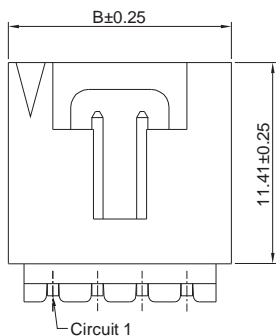
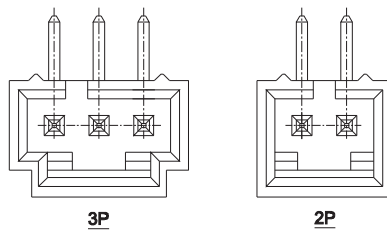
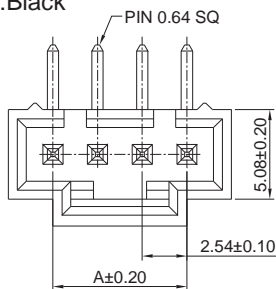

A2547 SERIES

2.54mm pitch wire to board and wire to wire connector

A2547WVA-G

2.54mm Pitch 180° Wafer

Reference Informations:

*Material:Pin:Brass/Gold over Nickel

Insulator:PBT , UL94V-0

*Mates with A2547 A2550 series Single Row Housing

*Color:Black

Ordering Information:

A2547WVA-XP - *

1 2

1.Part No.

2.Finish:

G - Gold over Nickel

(blank) - Tin over Nickel

Ordering Information & Dimensions:

PART NO.	Dimensions		
	A	B	C
A2547WVA-2P-G	2.54	7.62	5.59
A2547WVA-3P-G	5.08	10.16	8.13
A2547WVA-4P-G	7.62	12.70	10.67
A2547WVA-5P-G	10.16	15.24	13.21
A2547WVA-6P-G	12.70	17.78	15.75
A2547WVA-7P-G	15.24	20.32	18.29
A2547WVA-8P-G	17.78	22.86	20.83
A2547WVA-9P-G	20.32	25.40	23.37
A2547WVA-10P-G	22.86	27.94	25.91
A2547WVA-11P-G	25.40	30.48	28.45
A2547WVA-12P-G	27.94	32.02	30.99
A2547WVA-13P-G	30.48	35.56	33.53
A2547WVA-14P-G	32.02	38.10	36.07
A2547WVA-15P-G	35.56	40.64	38.61
A2547WVA-16P-G	38.10	43.18	41.15
A2547WVA-17P-G	40.64	45.72	43.69
A2547WVA-18P-G	43.18	48.26	46.23
A2547WVA-19P-G	45.72	50.80	48.77
A2547WVA-20P-G	48.26	53.34	51.31
A2547WVA-21P-G	50.80	55.88	53.85
A2547WVA-22P-G	53.34	58.42	56.39
A2547WVA-23P-G	55.88	60.96	58.93
A2547WVA-24P-G	58.42	63.50	61.47
A2547WVA-25P-G	60.96	66.04	64.01

Unit: mm

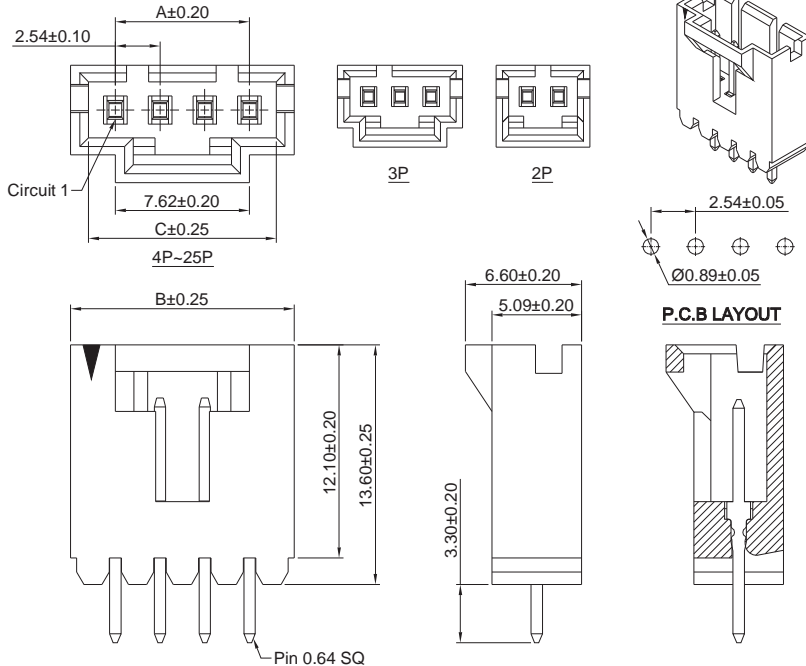

A2547WRA-G

2.54mm Pitch 90° Wafer

Reference Informations:

*Material:Pin:Brass/Gold over Nickel

Insulator:PBT , UL94V-0

*Mates with A2547 A2550 series Single Row Housing

*Color:Black

Ordering Information:

A2547WRA-XP - *

1 2

1.Part No.

2.Finish:

G - Gold over Nickel

(blank) - Tin over Nickel

Ordering Information & Dimensions:

PART NO.	Dimensions		
	A	B	C
A2547WRA-2P-G	2.54	7.62	5.59
A2547WRA-3P-G	5.08	10.16	8.13
A2547WRA-4P-G	7.62	12.70	10.67
A2547WRA-5P-G	10.16	15.24	13.21
A2547WRA-6P-G	12.70	17.78	15.75
A2547WRA-7P-G	15.24	20.32	18.29
A2547WRA-8P-G	17.78	22.86	20.83
A2547WRA-9P-G	20.32	25.40	23.37
A2547WRA-10P-G	22.86	27.94	25.91
A2547WRA-11P-G	25.40	30.48	28.45
A2547WRA-12P-G	27.94	32.02	30.99
A2547WRA-13P-G	30.48	35.56	33.53
A2547WRA-14P-G	32.02	38.10	36.07
A2547WRA-15P-G	35.56	40.64	38.61
A2547WRA-16P-G	38.10	43.18	41.15
A2547WRA-17P-G	40.64	45.72	43.69
A2547WRA-18P-G	43.18	48.26	46.23
A2547WRA-19P-G	45.72	50.80	48.77
A2547WRA-20P-G	48.26	53.34	51.31
A2547WRA-21P-G	50.80	55.88	53.85
A2547WRA-22P-G	53.34	58.42	56.39
A2547WRA-23P-G	55.88	60.96	58.93
A2547WRA-24P-G	58.42	63.50	61.47
A2547WRA-25P-G	60.96	66.04	64.01

Unit: mm

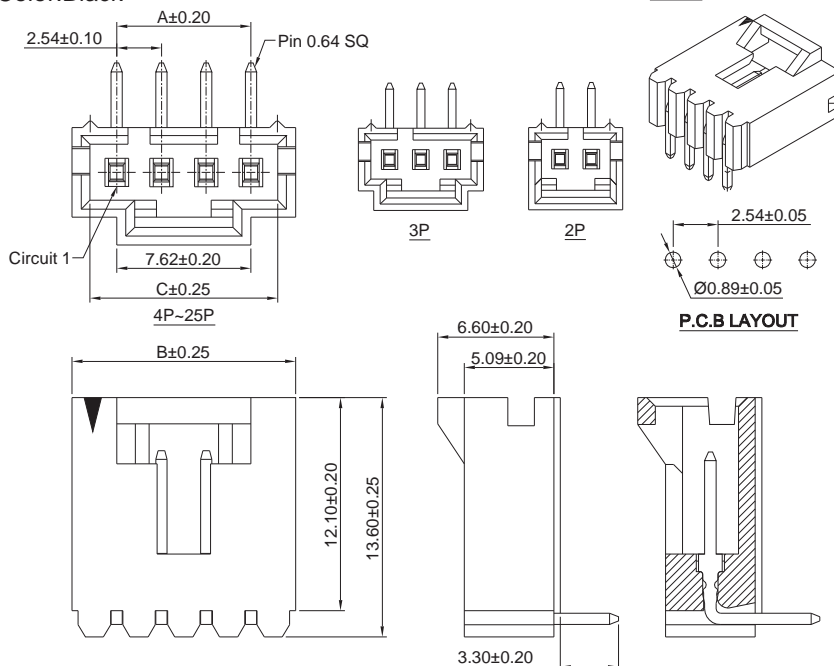

A2547 SERIES

2.54mm pitch wire to board and wire to wire connector

A2547WVA-F1-G

2.54mm Pitch 180° Wafer

Reference Informations:

- *Material: Pin: Brass/Gold over Nickel
Insulator: PBT, UL94V-0
- *Mates with A2547 A2550 series
- Single Row Housing
- *Color: Black

Ordering Information:
A2547WVA-F1-XP - *
1 2

1. Part No.
2. Finish:
G - Gold over Nickel
(blank) - Tin over Nickel

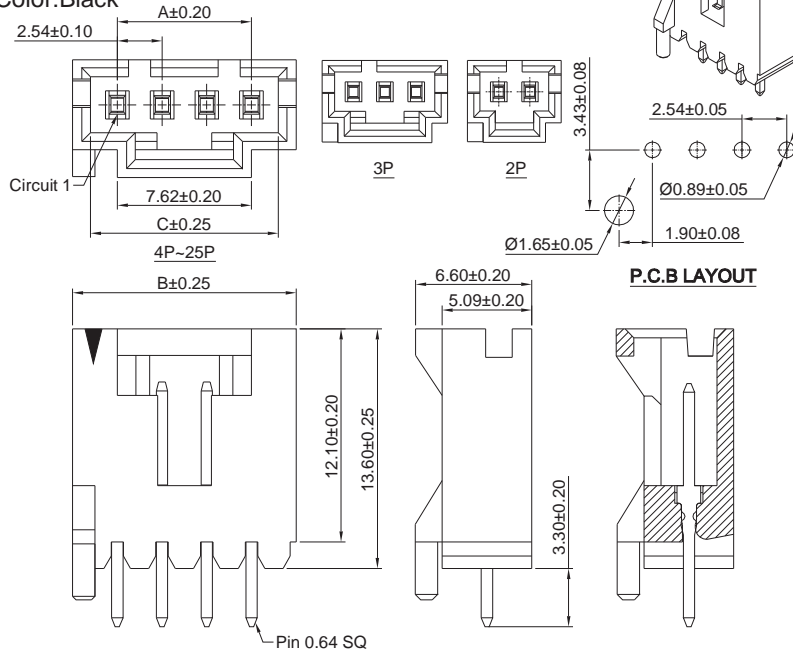

Ordering Information & Dimensions:

PART NO.	Dimensions		
	A	B	C
A2547WVA-F1-2P-G	2.54	7.62	5.59
A2547WVA-F1-3P-G	5.08	10.16	8.13
A2547WVA-F1-4P-G	7.62	12.70	10.67
A2547WVA-F1-5P-G	10.16	15.24	13.21
A2547WVA-F1-6P-G	12.70	17.78	15.75
A2547WVA-F1-7P-G	15.24	20.32	18.29
A2547WVA-F1-8P-G	17.78	22.86	20.83
A2547WVA-F1-9P-G	20.32	25.40	23.37
A2547WVA-F1-10P-G	22.86	27.94	25.91
A2547WVA-F1-11P-G	25.40	30.48	28.45
A2547WVA-F1-12P-G	27.94	32.02	30.99
A2547WVA-F1-13P-G	30.48	35.56	33.53
A2547WVA-F1-14P-G	32.02	38.10	36.07
A2547WVA-F1-15P-G	35.56	40.64	38.61
A2547WVA-F1-16P-G	38.10	43.18	41.15
A2547WVA-F1-17P-G	40.64	45.72	43.69
A2547WVA-F1-18P-G	43.18	48.26	46.23
A2547WVA-F1-19P-G	45.72	50.80	48.77
A2547WVA-F1-20P-G	48.26	53.34	51.31
A2547WVA-F1-21P-G	50.80	55.88	53.85
A2547WVA-F1-22P-G	53.34	58.42	56.39
A2547WVA-F1-23P-G	55.88	60.96	58.93
A2547WVA-F1-24P-G	58.42	63.50	61.47
A2547WVA-F1-25P-G	60.96	66.04	64.01

Unit: mm

A2547WRA-F1-G

2.54mm Pitch 90° Wafer

Reference Informations:

- *Material: Pin: Brass/Gold over Nickel
Insulator: PBT, UL94V-0
- *Mates with A2547 A2550 series
- Single Row Housing
- *Color: Black

Ordering Information:
A2547WRA-F1-XP - *
1 2

1. Part No.
2. Finish:
G - Gold over Nickel
(blank) - Tin over Nickel

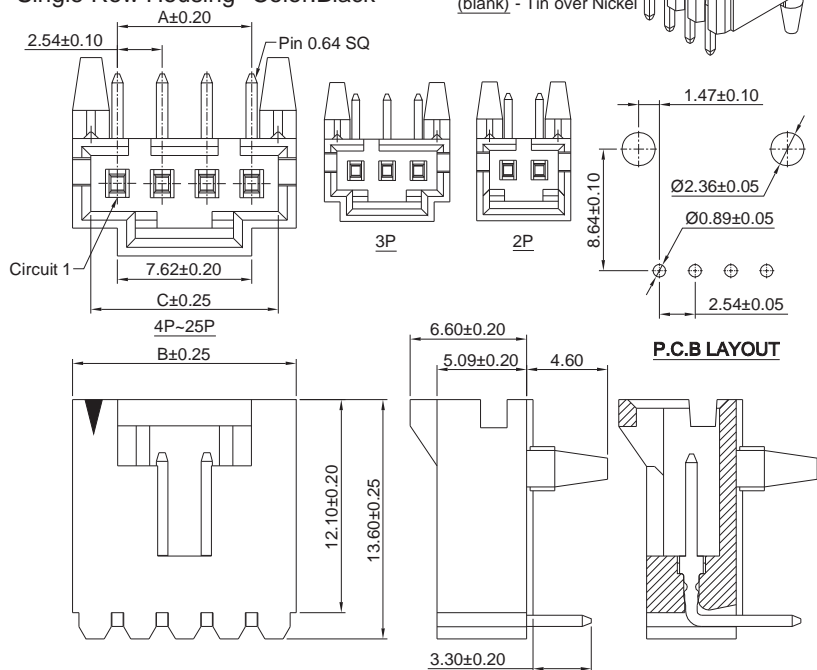

Ordering Information & Dimensions:

PART NO.	Dimensions		
	A	B	C
A2547WRA-F1-2P-G	2.54	7.62	5.59
A2547WRA-F1-3P-G	5.08	10.16	8.13
A2547WRA-F1-4P-G	7.62	12.70	10.67
A2547WRA-F1-5P-G	10.16	15.24	13.21
A2547WRA-F1-6P-G	12.70	17.78	15.75
A2547WRA-F1-7P-G	15.24	20.32	18.29
A2547WRA-F1-8P-G	17.78	22.86	20.83
A2547WRA-F1-9P-G	20.32	25.40	23.37
A2547WRA-F1-10P-G	22.86	27.94	25.91
A2547WRA-F1-11P-G	25.40	30.48	28.45
A2547WRA-F1-12P-G	27.94	32.02	30.99
A2547WRA-F1-13P-G	30.48	35.56	33.53
A2547WRA-F1-14P-G	32.02	38.10	36.07
A2547WRA-F1-15P-G	35.56	40.64	38.61
A2547WRA-F1-16P-G	38.10	43.18	41.15
A2547WRA-F1-17P-G	40.64	45.72	43.69
A2547WRA-F1-18P-G	43.18	48.26	46.23
A2547WRA-F1-19P-G	45.72	50.80	48.77
A2547WRA-F1-20P-G	48.26	53.34	51.31
A2547WRA-F1-21P-G	50.80	55.88	53.85
A2547WRA-F1-22P-G	53.34	58.42	56.39
A2547WRA-F1-23P-G	55.88	60.96	58.93
A2547WRA-F1-24P-G	58.42	63.50	61.47
A2547WRA-F1-25P-G	60.96	66.04	64.01

Unit: mm

A2547 SERIES

2.54mm pitch wire to board and wire to wire connector

A2547WRA-FJ-G

2.54mm Pitch 90° Wafer

Reference Informations:

- *Material: Pin: Brass/Gold over Nickel
Insulator: PBT, UL94V-0
- *Mates with A2547 A2550 series
Single Row Housing *Color: Black

Ordering Information:
A2547WRA-FJ-XP - *
1 2
1. Part No.
2. Finish:
G - Gold over Nickel
(blank) - Tin over Nickel

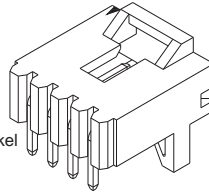

Ordering Information & Dimensions:

PART NO.	Dimensions		
	A	B	C
A2547WRA-FJ-2P-G	2.54	7.62	5.59
A2547WRA-FJ-3P-G	5.08	10.16	8.13
A2547WRA-FJ-4P-G	7.62	12.70	10.67
A2547WRA-FJ-5P-G	10.16	15.24	13.21
A2547WRA-FJ-6P-G	12.70	17.78	15.75
A2547WRA-FJ-7P-G	15.24	20.32	18.29
A2547WRA-FJ-8P-G	17.78	22.86	20.83
A2547WRA-FJ-9P-G	20.32	25.40	23.37
A2547WRA-FJ-10P-G	22.86	27.94	25.91
A2547WRA-FJ-11P-G	25.40	30.48	28.45
A2547WRA-FJ-12P-G	27.94	32.02	30.99
A2547WRA-FJ-13P-G	30.48	35.56	33.53
A2547WRA-FJ-14P-G	32.02	38.10	36.07
A2547WRA-FJ-15P-G	35.56	40.64	38.61
A2547WRA-FJ-16P-G	38.10	43.18	41.15
A2547WRA-FJ-17P-G	40.64	45.72	43.69
A2547WRA-FJ-18P-G	43.18	48.26	46.23
A2547WRA-FJ-19P-G	45.72	50.80	48.77
A2547WRA-FJ-20P-G	48.26	53.34	51.31
A2547WRA-FJ-21P-G	50.80	55.88	53.85
A2547WRA-FJ-22P-G	53.34	58.42	56.39
A2547WRA-FJ-23P-G	55.88	60.96	58.93
A2547WRA-FJ-24P-G	58.42	63.50	61.47
A2547WRA-FJ-25P-G	60.96	66.04	64.01

Unit: mm

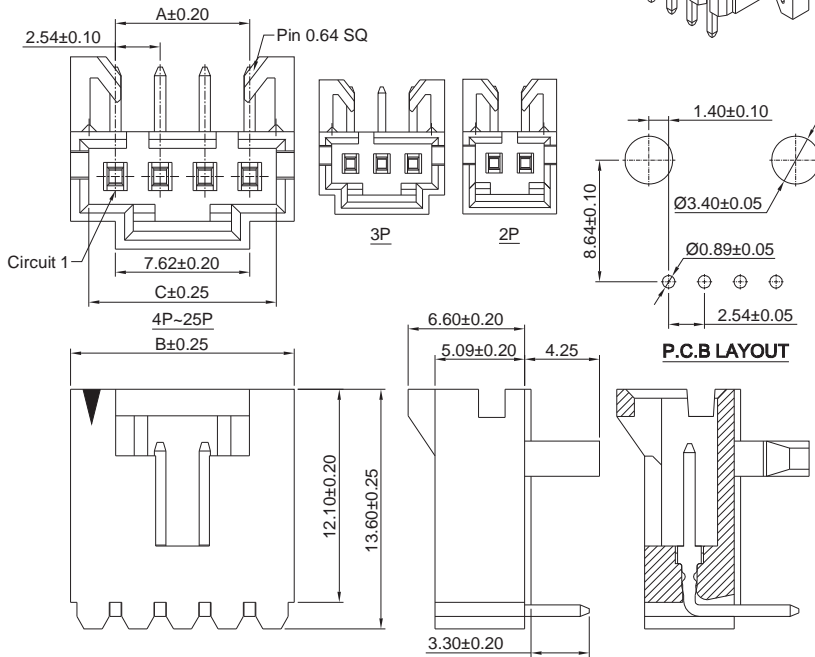

A2547WVA-F-G

2.54mm Pitch 180° Wafer

Reference Informations:

- *Material: Pin: Brass/Gold over Nickel
Insulator: PBT, UL94V-0
- *Mates with A2547 A2550 series
Single Row Housing *Color: Black

Ordering Information:
A2547WVA-F-XP - *
1 2
1. Part No.
2. Finish:
G - Gold over Nickel
(blank) - Tin over Nickel

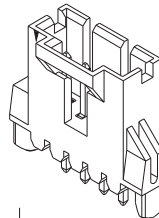

Ordering Information & Dimensions:

PART NO.	Dimensions		
	A	B	C
A2547WVA-F-2P-G	2.54	7.62	5.59
A2547WVA-F-3P-G	5.08	10.16	8.13
A2547WVA-F-4P-G	7.62	12.70	10.67
A2547WVA-F-5P-G	10.16	15.24	13.21
A2547WVA-F-6P-G	12.70	17.78	15.75
A2547WVA-F-7P-G	15.24	20.32	18.29
A2547WVA-F-8P-G	17.78	22.86	20.83
A2547WVA-F-9P-G	20.32	25.40	23.37
A2547WVA-F-10P-G	22.86	27.94	25.91
A2547WVA-F-11P-G	25.40	30.48	28.45
A2547WVA-F-12P-G	27.94	32.02	30.99
A2547WVA-F-13P-G	30.48	35.56	33.53
A2547WVA-F-14P-G	32.02	38.10	36.07
A2547WVA-F-15P-G	35.56	40.64	38.61
A2547WVA-F-16P-G	38.10	43.18	41.15
A2547WVA-F-17P-G	40.64	45.72	43.69
A2547WVA-F-18P-G	43.18	48.26	46.23
A2547WVA-F-19P-G	45.72	50.80	48.77
A2547WVA-F-20P-G	48.26	53.34	51.31
A2547WVA-F-21P-G	50.80	55.88	53.85
A2547WVA-F-22P-G	53.34	58.42	56.39
A2547WVA-F-23P-G	55.88	60.96	58.93
A2547WVA-F-24P-G	58.42	63.50	61.47
A2547WVA-F-25P-G	60.96	66.04	64.01

Unit: mm

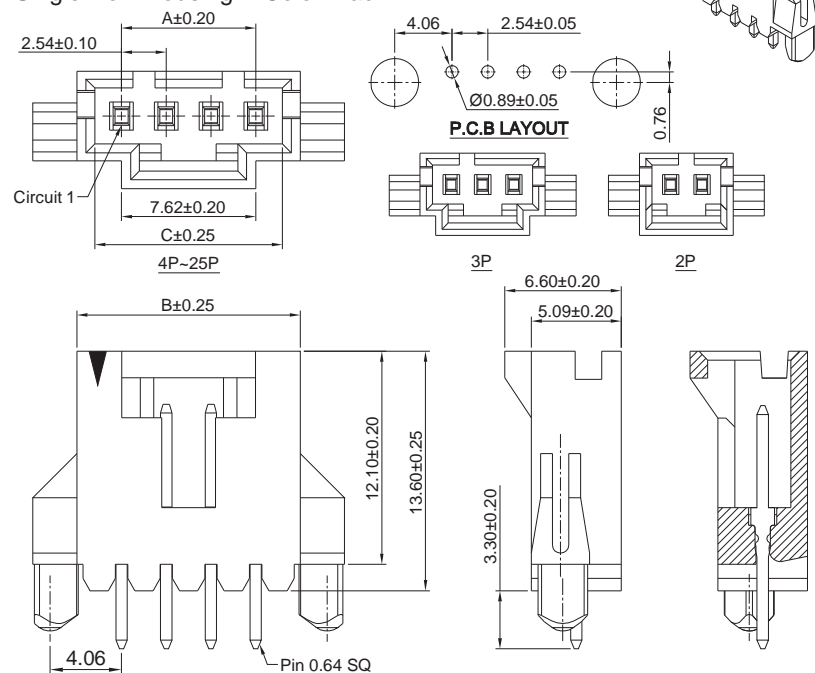

A2547 SERIES

2.54mm pitch wire to board and wire to wire connector

A2547WRA-F-G

2.54mm Pitch 90° Wafer

Reference Informations:

- *Material: Pin: Brass/Gold over Nickel
Insulator: PBT, UL94V-0
- *Mates with A2547 A2550 series
Single Row Housing *Color: Black

Ordering Information:

- A2547WRA-F-XP - *
1 2
1. Part No.
 2. Finish:
G - Gold over Nickel
(blank) - Tin over Nickel

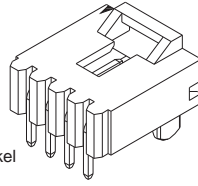

Ordering Information & Dimensions:

PART NO.	Dimensions		
	A	B	C
A2547WRA-F-2P-G	2.54	7.62	5.59
A2547WRA-F-3P-G	5.08	10.16	8.13
A2547WRA-F-4P-G	7.62	12.70	10.67
A2547WRA-F-5P-G	10.16	15.24	13.21
A2547WRA-F-6P-G	12.70	17.78	15.75
A2547WRA-F-7P-G	15.24	20.32	18.29
A2547WRA-F-8P-G	17.78	22.86	20.83
A2547WRA-F-9P-G	20.32	25.40	23.37
A2547WRA-F-10P-G	22.86	27.94	25.91
A2547WRA-F-11P-G	25.40	30.48	28.45
A2547WRA-F-12P-G	27.94	32.02	30.99
A2547WRA-F-13P-G	30.48	35.56	33.53
A2547WRA-F-14P-G	32.02	38.10	36.07
A2547WRA-F-15P-G	35.56	40.64	38.61
A2547WRA-F-16P-G	38.10	43.18	41.15
A2547WRA-F-17P-G	40.64	45.72	43.69
A2547WRA-F-18P-G	43.18	48.26	46.23
A2547WRA-F-19P-G	45.72	50.80	48.77
A2547WRA-F-20P-G	48.26	53.34	51.31
A2547WRA-F-21P-G	50.80	55.88	53.85
A2547WRA-F-22P-G	53.34	58.42	56.39
A2547WRA-F-23P-G	55.88	60.96	58.93
A2547WRA-F-24P-G	58.42	63.50	61.47
A2547WRA-F-25P-G	60.96	66.04	64.01

Unit: mm

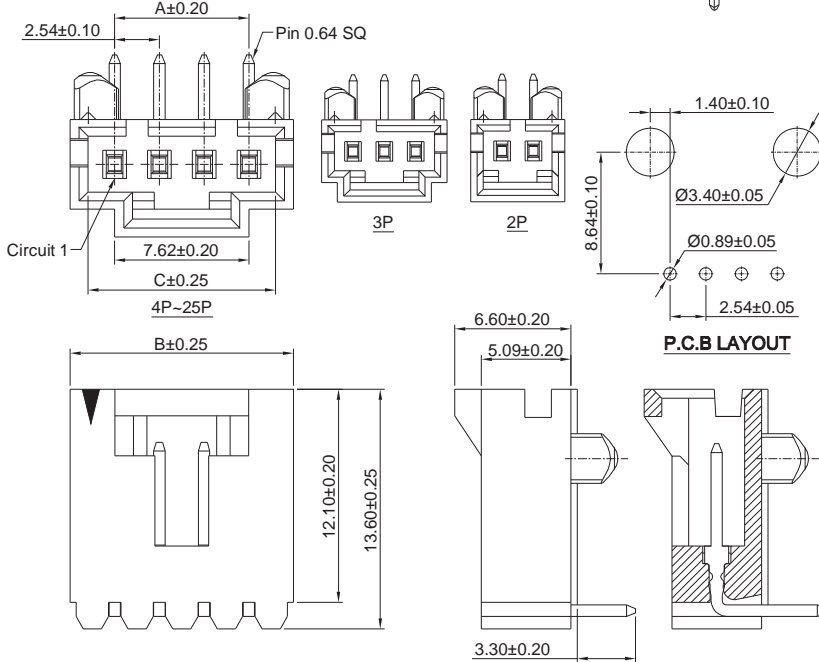

A2547WVA-F2-G

2.54mm Pitch 180° Wafer

Reference Informations:

- *Material: Pin: Brass/Gold over Nickel
Insulator: PBT, UL94V-0
- *Mates with A2547 A2550 series
Single Row Housing *Color: Black

Ordering Information:

- A2547WVA-F2-XP - *
1 2
1. Part No.
 2. Finish:
G - Gold over Nickel
(blank) - Tin over Nickel

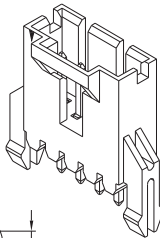

Ordering Information & Dimensions:

PART NO.	Dimensions		
	A	B	C
A2547WVA-F2-2P-G	2.54	7.62	5.59
A2547WVA-F2-3P-G	5.08	10.16	8.13
A2547WVA-F2-4P-G	7.62	12.70	10.67
A2547WVA-F2-5P-G	10.16	15.24	13.21
A2547WVA-F2-6P-G	12.70	17.78	15.75
A2547WVA-F2-7P-G	15.24	20.32	18.29
A2547WVA-F2-8P-G	17.78	22.86	20.83
A2547WVA-F2-9P-G	20.32	25.40	23.37
A2547WVA-F2-10P-G	22.86	27.94	25.91
A2547WVA-F2-11P-G	25.40	30.48	28.45
A2547WVA-F2-12P-G	27.94	32.02	30.99
A2547WVA-F2-13P-G	30.48	35.56	33.53
A2547WVA-F2-14P-G	32.02	38.10	36.07
A2547WVA-F2-15P-G	35.56	40.64	38.61
A2547WVA-F2-16P-G	38.10	43.18	41.15
A2547WVA-F2-17P-G	40.64	45.72	43.69
A2547WVA-F2-18P-G	43.18	48.26	46.23
A2547WVA-F2-19P-G	45.72	50.80	48.77
A2547WVA-F2-20P-G	48.26	53.34	51.31
A2547WVA-F2-21P-G	50.80	55.88	53.85
A2547WVA-F2-22P-G	53.34	58.42	56.39
A2547WVA-F2-23P-G	55.88	60.96	58.93
A2547WVA-F2-24P-G	58.42	63.50	61.47
A2547WVA-F2-25P-G	60.96	66.04	64.01

Unit: mm

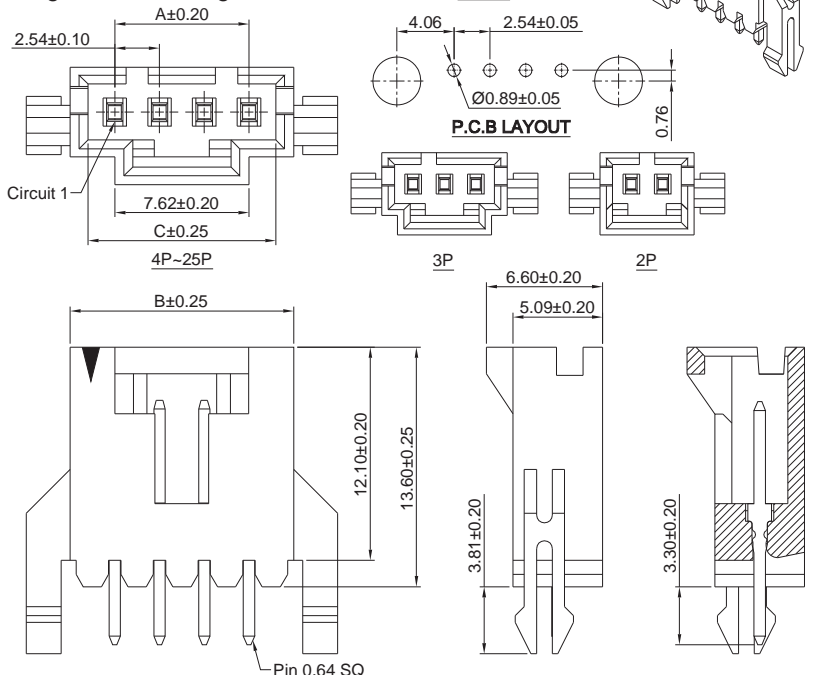

A2547 SERIES

2.54mm pitch wire to board and wire to wire connector

A2547WRA-F2-G

2.54mm Pitch 90° Wafer

Reference Informations:

- *Material: Pin: Brass/Gold over Nickel
Insulator: PBT, UL94V-0
- *Mates with A2547 A2550 series
Single Row Housing *Color: Black

Ordering Information:
A2547WRA-F2-XP - *
1 2
1. Part No.
2. Finish:
G - Gold over Nickel
(blank) - Tin over Nickel

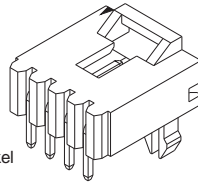

Ordering Information & Dimensions:

PART NO.	Dimensions		
	A	B	C
A2547WRA-F2-2P-G	2.54	7.62	5.59
A2547WRA-F2-3P-G	5.08	10.16	8.13
A2547WRA-F2-4P-G	7.62	12.70	10.67
A2547WRA-F2-5P-G	10.16	15.24	13.21
A2547WRA-F2-6P-G	12.70	17.78	15.75
A2547WRA-F2-7P-G	15.24	20.32	18.29
A2547WRA-F2-8P-G	17.78	22.86	20.83
A2547WRA-F2-9P-G	20.32	25.40	23.37
A2547WRA-F2-10P-G	22.86	27.94	25.91
A2547WRA-F2-11P-G	25.40	30.48	28.45
A2547WRA-F2-12P-G	27.94	32.02	30.99
A2547WRA-F2-13P-G	30.48	35.56	33.53
A2547WRA-F2-14P-G	32.02	38.10	36.07
A2547WRA-F2-15P-G	35.56	40.64	38.61
A2547WRA-F2-16P-G	38.10	43.18	41.15
A2547WRA-F2-17P-G	40.64	45.72	43.69
A2547WRA-F2-18P-G	43.18	48.26	46.23
A2547WRA-F2-19P-G	45.72	50.80	48.77
A2547WRA-F2-20P-G	48.26	53.34	51.31
A2547WRA-F2-21P-G	50.80	55.88	53.85
A2547WRA-F2-22P-G	53.34	58.42	56.39
A2547WRA-F2-23P-G	55.88	60.96	58.93
A2547WRA-F2-24P-G	58.42	63.50	61.47
A2547WRA-F2-25P-G	60.96	66.04	64.01

Unit: mm

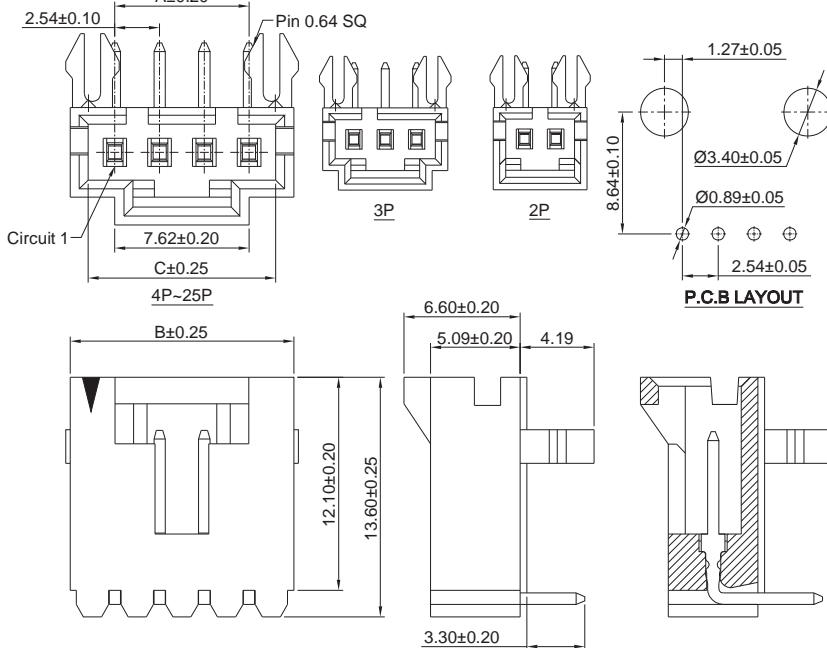

A2547WRA-S-F-G

2.54mm Pitch 90° Wafer - SMT TYPE

Reference Informations:

- *Material: Pin: Brass/Gold over Nickel
Insulator: PBT, UL94V-0
- *Mates with A2547 A2550 series Single
Row Housing *Color: Black

Ordering Information:
A2547WRA-S-F-XP - *
1 2
1. Part No.
2. Finish:
G - Gold over Nickel
(blank) - Tin over Nickel

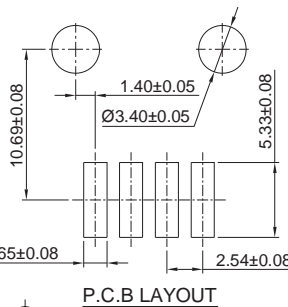

Ordering Information & Dimensions:

PART NO.	Dimensions		
	A	B	C
A2547WRA-S-F-2P-G	2.54	7.62	5.59
A2547WRA-S-F-3P-G	5.08	10.16	8.13
A2547WRA-S-F-4P-G	7.62	12.70	10.67
A2547WRA-S-F-5P-G	10.16	15.24	13.21
A2547WRA-S-F-6P-G	12.70	17.78	15.75
A2547WRA-S-F-7P-G	15.24	20.32	18.29
A2547WRA-S-F-8P-G	17.78	22.86	20.83
A2547WRA-S-F-9P-G	20.32	25.40	23.37
A2547WRA-S-F-10P-G	22.86	27.94	25.91
A2547WRA-S-F-11P-G	25.40	30.48	28.45
A2547WRA-S-F-12P-G	27.94	32.02	30.99
A2547WRA-S-F-13P-G	30.48	35.56	33.53
A2547WRA-S-F-14P-G	32.02	38.10	36.07
A2547WRA-S-F-15P-G	35.56	40.64	38.61
A2547WRA-S-F-16P-G	38.10	43.18	41.15
A2547WRA-S-F-17P-G	40.64	45.72	43.69
A2547WRA-S-F-18P-G	43.18	48.26	46.23
A2547WRA-S-F-19P-G	45.72	50.80	48.77
A2547WRA-S-F-20P-G	48.26	53.34	51.31
A2547WRA-S-F-21P-G	50.80	55.88	53.85
A2547WRA-S-F-22P-G	53.34	58.42	56.39
A2547WRA-S-F-23P-G	55.88	60.96	58.93
A2547WRA-S-F-24P-G	58.42	63.50	61.47
A2547WRA-S-F-25P-G	60.96	66.04	64.01

Unit: mm

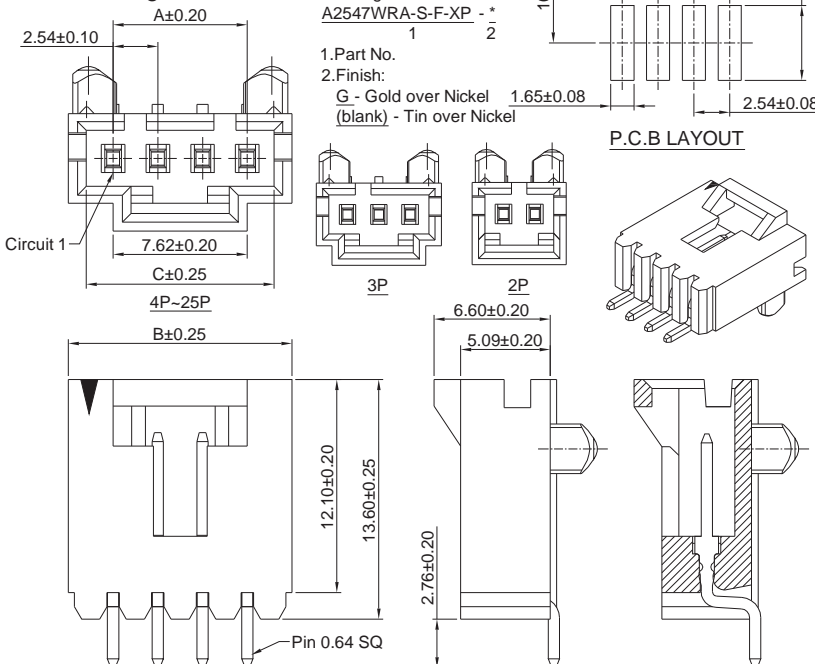

A2547 SERIES

2.54mm pitch wire to board and wire to wire connector

A2547WVE-G

2.54mm Pitch 180° Wafer

Reference Informations:

- *Material: Pin: Brass/Gold over Nickel
Insulator: PBT, UL94V-0
- *Mates with A2549H A2550H-C
A2550H-C1 series Housing
- *Color: Black

Ordering Information:

- A2547WVE-XP - *
1 2
1. Part No.
 2. Finish:
G - Gold over Nickel
(blank) - Tin over Nickel

Ordering Information & Dimensions:

PART NO.	Dimensions		
	A	B	C
A2547WVE-2P-G	2.54	7.62	5.59
A2547WVE-3P-G	5.08	10.16	8.13
A2547WVE-4P-G	7.62	12.70	10.67
A2547WVE-5P-G	10.16	15.24	13.21
A2547WVE-6P-G	12.70	17.78	15.75
A2547WVE-7P-G	15.24	20.32	18.29
A2547WVE-8P-G	17.78	22.86	20.83
A2547WVE-9P-G	20.32	25.40	23.37
A2547WVE-10P-G	22.86	27.94	25.91
A2547WVE-11P-G	25.40	30.48	28.45
A2547WVE-12P-G	27.94	32.02	30.99
A2547WVE-13P-G	30.48	35.56	33.53
A2547WVE-14P-G	32.02	38.10	36.07
A2547WVE-15P-G	35.56	40.64	38.61
A2547WVE-16P-G	38.10	43.18	41.15
A2547WVE-17P-G	40.64	45.72	43.69
A2547WVE-18P-G	43.18	48.26	46.23
A2547WVE-19P-G	45.72	50.80	48.77
A2547WVE-20P-G	48.26	53.34	51.31
A2547WVE-21P-G	50.80	55.88	53.85
A2547WVE-22P-G	53.34	58.42	56.39
A2547WVE-23P-G	55.88	60.96	58.93
A2547WVE-24P-G	58.42	63.50	61.47
A2547WVE-25P-G	60.96	66.04	64.01

Unit: mm

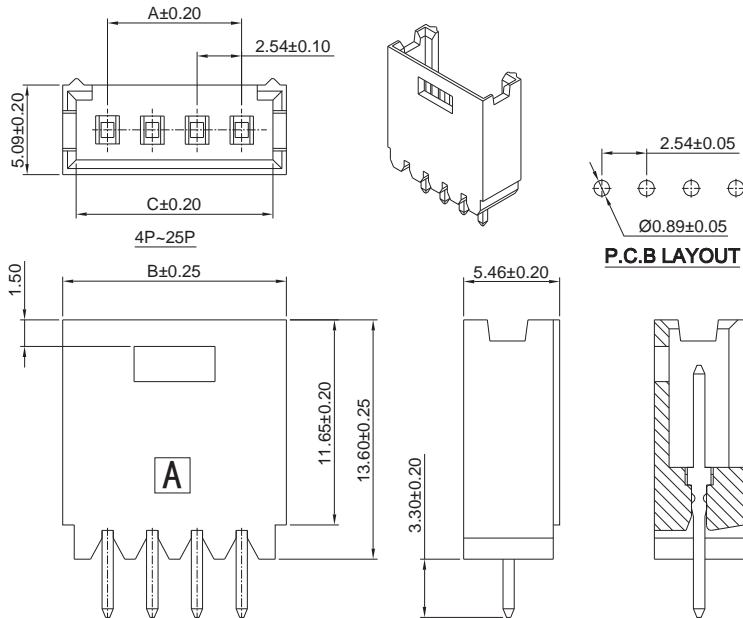

A2547WRE-G

2.54mm Pitch 90° Wafer

Reference Informations:

- *Material: Pin: Brass/Gold over Nickel
Insulator: PBT, UL94V-0
- *Mates with A2549H A2550H-C
A2550H-C1 series Housing
- *Color: Black

Ordering Information:

- A2547WRE-XP - *
1 2
1. Part No.
 2. Finish:
G - Gold over Nickel
(blank) - Tin over Nickel

Ordering Information & Dimensions:

PART NO.	Dimensions		
	A	B	C
A2547WRE-2P-G	2.54	7.62	5.59
A2547WRE-3P-G	5.08	10.16	8.13
A2547WRE-4P-G	7.62	12.70	10.67
A2547WRE-5P-G	10.16	15.24	13.21
A2547WRE-6P-G	12.70	17.78	15.75
A2547WRE-7P-G	15.24	20.32	18.29
A2547WRE-8P-G	17.78	22.86	20.83
A2547WRE-9P-G	20.32	25.40	23.37
A2547WRE-10P-G	22.86	27.94	25.91
A2547WRE-11P-G	25.40	30.48	28.45
A2547WRE-12P-G	27.94	32.02	30.99
A2547WRE-13P-G	30.48	35.56	33.53
A2547WRE-14P-G	32.02	38.10	36.07
A2547WRE-15P-G	35.56	40.64	38.61
A2547WRE-16P-G	38.10	43.18	41.15
A2547WRE-17P-G	40.64	45.72	43.69
A2547WRE-18P-G	43.18	48.26	46.23
A2547WRE-19P-G	45.72	50.80	48.77
A2547WRE-20P-G	48.26	53.34	51.31
A2547WRE-21P-G	50.80	55.88	53.85
A2547WRE-22P-G	53.34	58.42	56.39
A2547WRE-23P-G	55.88	60.96	58.93
A2547WRE-24P-G	58.42	63.50	61.47
A2547WRE-25P-G	60.96	66.04	64.01

Unit: mm

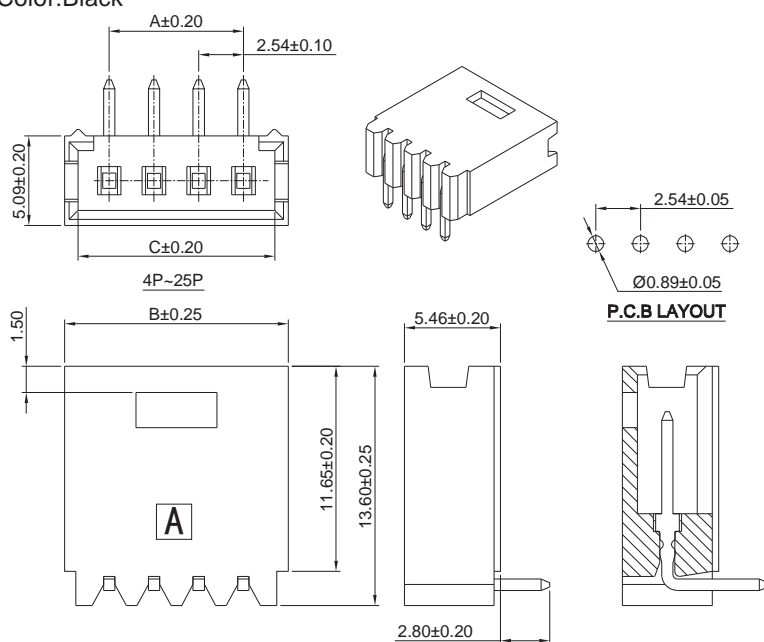

A2547 SERIES

2.54mm pitch wire to board and wire to wire connector

A2547WVF-G

2.54mm Pitch 180° Wafer

Reference Informations:

- *Material: Pin: Brass/Gold over Nickel
Insulator: PBT, UL94V-0
- *Mates with A2549HD series
Single Row Housing
- *Color: Black

Ordering Information:
A2547WVF-XP - *
1 2
1. Part No.
2. Finish:
G - Gold over Nickel
(blank) - Tin over Nickel

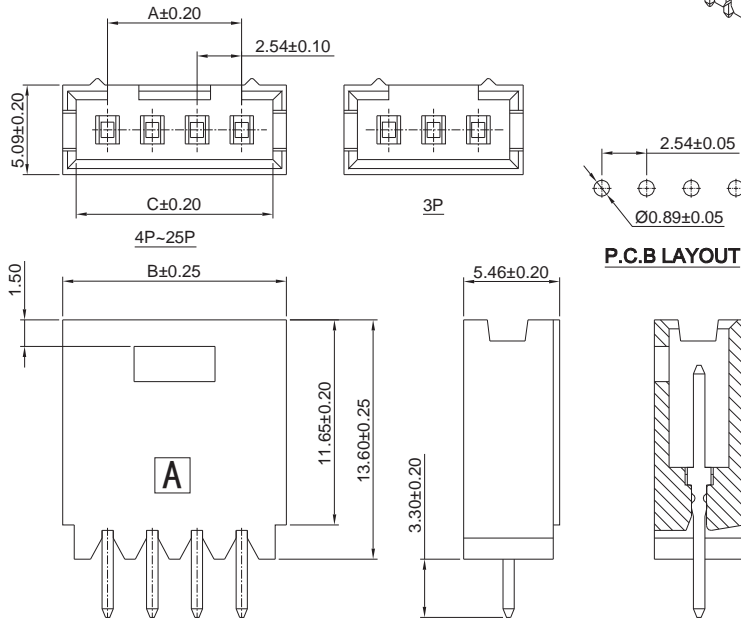
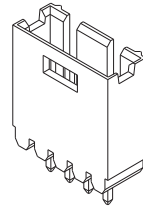

Ordering Information & Dimensions:

PART NO.	Dimensions		
	A	B	C
A2547WVF-3P-G	5.08	10.16	8.13
A2547WVF-4P-G	7.62	12.70	10.67
A2547WVF-5P-G	10.16	15.24	13.21
A2547WVF-6P-G	12.70	17.78	15.75
A2547WVF-7P-G	15.24	20.32	18.29
A2547WVF-8P-G	17.78	22.86	20.83
A2547WVF-9P-G	20.32	25.40	23.37
A2547WVF-10P-G	22.86	27.94	25.91
A2547WVF-11P-G	25.40	30.48	28.45
A2547WVF-12P-G	27.94	32.02	30.99
A2547WVF-13P-G	30.48	35.56	33.53
A2547WVF-14P-G	32.02	38.10	36.07
A2547WVF-15P-G	35.56	40.64	38.61
A2547WVF-16P-G	38.10	43.18	41.15
A2547WVF-17P-G	40.64	45.72	43.69
A2547WVF-18P-G	43.18	48.26	46.23
A2547WVF-19P-G	45.72	50.80	48.77
A2547WVF-20P-G	48.26	53.34	51.31
A2547WVF-21P-G	50.80	55.88	53.85
A2547WVF-22P-G	53.34	58.42	56.39
A2547WVF-23P-G	55.88	60.96	58.93
A2547WVF-24P-G	58.42	63.50	61.47
A2547WVF-25P-G	60.96	66.04	64.01

Unit: mm

A2547WRF-G

2.54mm Pitch 90° Wafer

Reference Informations:

- *Material: Pin: Brass/Gold over Nickel
Insulator: PBT, UL94V-0
- *Mates with A2549HD series
Single Row Housing
- *Color: Black

Ordering Information:
A2547WRF-XP - *
1 2
1. Part No.
2. Finish:
G - Gold over Nickel
(blank) - Tin over Nickel

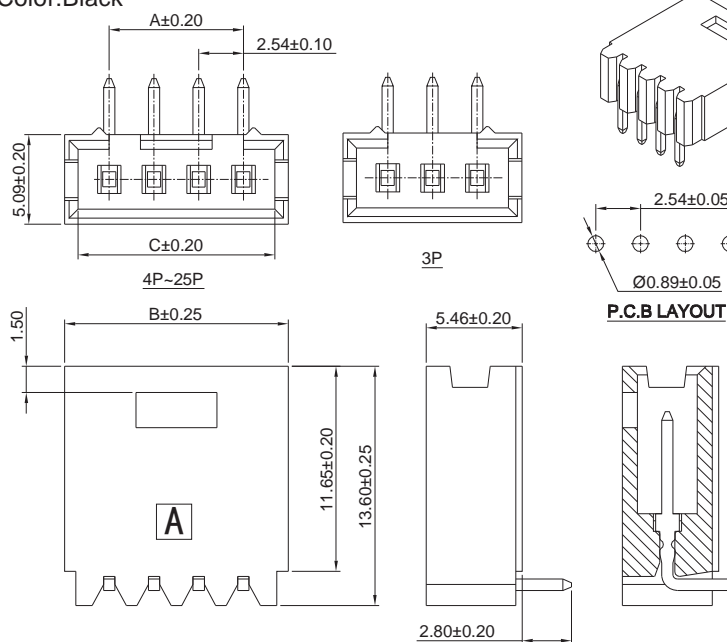
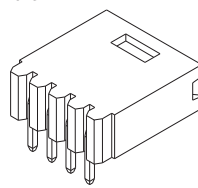

Ordering Information & Dimensions:

PART NO.	Dimensions		
	A	B	C
A2547WRF-3P-G	5.08	10.16	8.13
A2547WRF-4P-G	7.62	12.70	10.67
A2547WRF-5P-G	10.16	15.24	13.21
A2547WRF-6P-G	12.70	17.78	15.75
A2547WRF-7P-G	15.24	20.32	18.29
A2547WRF-8P-G	17.78	22.86	20.83
A2547WRF-9P-G	20.32	25.40	23.37
A2547WRF-10P-G	22.86	27.94	25.91
A2547WRF-11P-G	25.40	30.48	28.45
A2547WRF-12P-G	27.94	32.02	30.99
A2547WRF-13P-G	30.48	35.56	33.53
A2547WRF-14P-G	32.02	38.10	36.07
A2547WRF-15P-G	35.56	40.64	38.61
A2547WRF-16P-G	38.10	43.18	41.15
A2547WRF-17P-G	40.64	45.72	43.69
A2547WRF-18P-G	43.18	48.26	46.23
A2547WRF-19P-G	45.72	50.80	48.77
A2547WRF-20P-G	48.26	53.34	51.31
A2547WRF-21P-G	50.80	55.88	53.85
A2547WRF-22P-G	53.34	58.42	56.39
A2547WRF-23P-G	55.88	60.96	58.93
A2547WRF-24P-G	58.42	63.50	61.47
A2547WRF-25P-G	60.96	66.04	64.01

Unit: mm

A2547 SERIES

2.54mm pitch wire to board and wire to wire connector

A2547WVB

2.54mm Pitch 180° Box Header

Reference Informations:

- *Material:Pin:Brass/Gold over Nickel
Insulator:PBT , UL94V-0
- *Mates with A2547HJ series
Single Row Housing
- *Color:Black

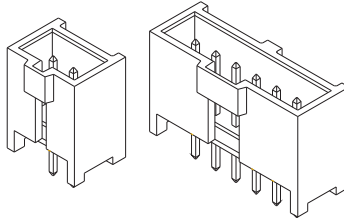

Ordering Information & Dimensions:

PART NO.	Dimensions		
	A	B	C
A2547WVB-2P	2.54	8.43	6.60
A2547WVB-3P	5.08	10.97	9.14
A2547WVB-4P	7.62	13.51	11.68
A2547WVB-5P	10.16	16.05	14.22
A2547WVB-6P	12.70	18.59	16.76
A2547WVB-7P	15.24	21.13	19.30
A2547WVB-8P	17.78	23.67	21.84
A2547WVB-9P	20.32	26.21	24.38
A2547WVB-10P	22.86	28.75	26.92
A2547WVB-11P	25.40	31.29	29.46
A2547WVB-12P	27.94	33.83	32.00
A2547WVB-13P	30.48	36.37	34.54
A2547WVB-14P	33.02	38.91	37.08
A2547WVB-15P	35.56	41.45	39.62
A2547WVB-16P	38.10	43.99	42.16
A2547WVB-17P	40.64	46.53	44.70
A2547WVB-18P	43.18	49.07	47.24
A2547WVB-19P	45.72	51.61	49.78
A2547WVB-20P	48.26	54.15	52.32
A2547WVB-21P	50.80	56.69	54.86
A2547WVB-22P	53.34	59.23	57.40
A2547WVB-23P	55.88	61.77	59.94
A2547WVB-24P	58.42	64.31	62.48
A2547WVB-25P	60.96	66.85	65.02
A2547WVB-26P	63.50	69.39	67.56
A2547WVB-27P	66.04	71.93	70.10
A2547WVB-28P	68.58	74.47	72.64
A2547WVB-29P	71.12	77.01	75.18
A2547WVB-30P	73.66	79.55	77.72
A2547WVB-31P	76.20	82.09	80.26
A2547WVB-32P	78.74	84.63	82.80

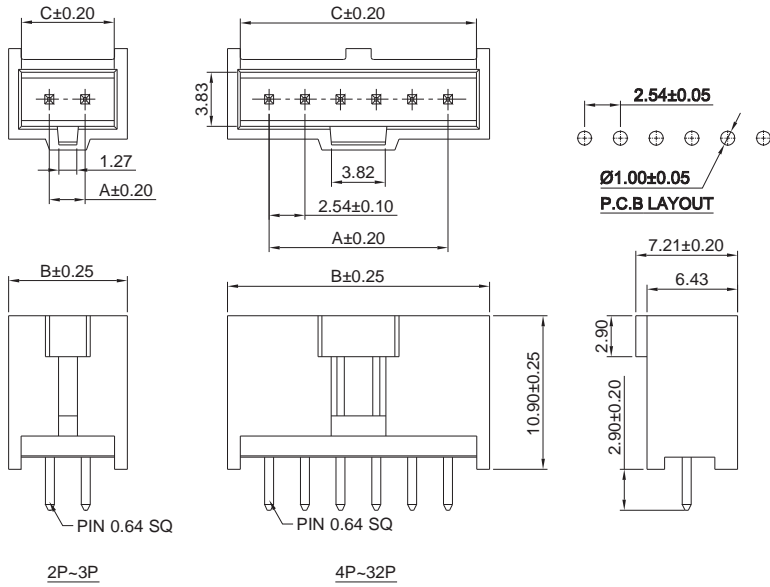

Unit: mm

A2547 SERIES

2.54mm pitch wire to board and wire to wire connector

A2547WRB

2.54mm Pitch 90° Box Header

Reference Informations:

*Material:Pin:Brass/Gold over Nickel

Insulator:PBT , UL94V-0

*Mates with A2547HJ series Single Row Housing

*Color:Black

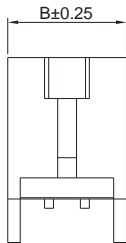
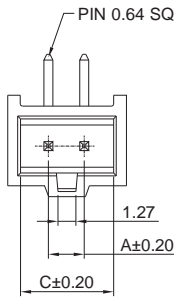
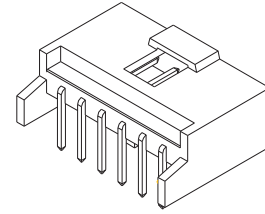

2P-3P

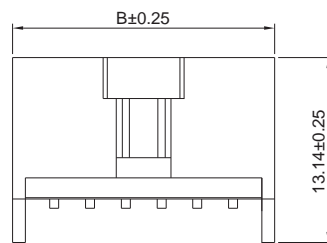
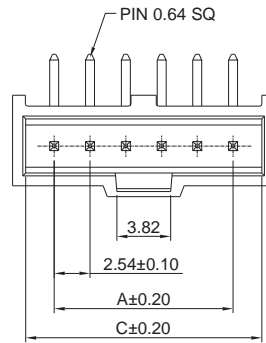

4P-6P

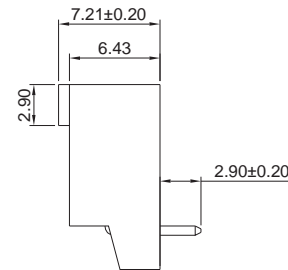

2P-6P

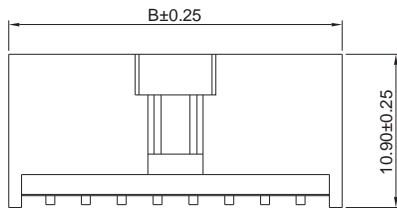
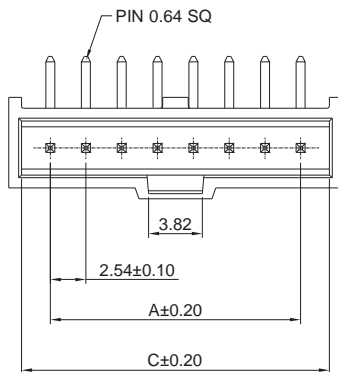

7P-32P

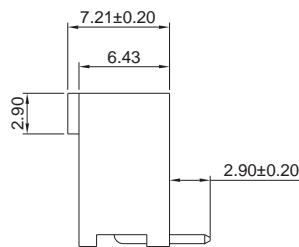
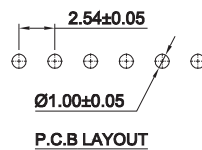

7P-32P

Ordering Information & Dimensions:

PART NO.	Dimensions		
	A	B	C
A2547WRB-2P	2.54	8.43	6.60
A2547WRB-3P	5.08	10.97	9.14
A2547WRB-4P	7.62	13.51	11.68
A2547WRB-5P	10.16	16.05	14.22
A2547WRB-6P	12.70	18.59	16.76
A2547WRB-7P	15.24	21.13	19.30
A2547WRB-8P	17.78	23.67	21.84
A2547WRB-9P	20.32	26.21	24.38
A2547WRB-10P	22.86	28.75	26.92
A2547WRB-11P	25.40	31.29	29.46
A2547WRB-12P	27.94	33.83	32.00
A2547WRB-13P	30.48	36.37	34.54
A2547WRB-14P	33.02	38.91	37.08
A2547WRB-15P	35.56	41.45	39.62
A2547WRB-16P	38.10	43.99	42.16
A2547WRB-17P	40.64	46.53	44.70
A2547WRB-18P	43.18	49.07	47.24
A2547WRB-19P	45.72	51.61	49.78
A2547WRB-20P	48.26	54.15	52.32
A2547WRB-21P	50.80	56.69	54.86
A2547WRB-22P	53.34	59.23	57.40
A2547WRB-23P	55.88	61.77	59.94
A2547WRB-24P	58.42	64.31	62.48
A2547WRB-25P	60.96	66.85	65.02
A2547WRB-26P	63.50	69.39	67.56
A2547WRB-27P	66.04	71.93	70.10
A2547WRB-28P	68.58	74.47	72.64
A2547WRB-29P	71.12	77.01	75.18
A2547WRB-30P	73.66	79.55	77.72
A2547WRB-31P	76.20	82.09	80.26
A2547WRB-32P	78.74	84.63	82.80

Unit: mm

A2547 SERIES

2.54mm pitch wire to board and wire to wire connector

A2547WR-F

2.54mm Pitch 90° Wafer With Peg

Reference Informations:

- *Material: Pin: Brass/Gold over Nickel
Insulator: PBT30%GF, UL94V-0
- *Mates with A2547 series Housing
- *Color: Black

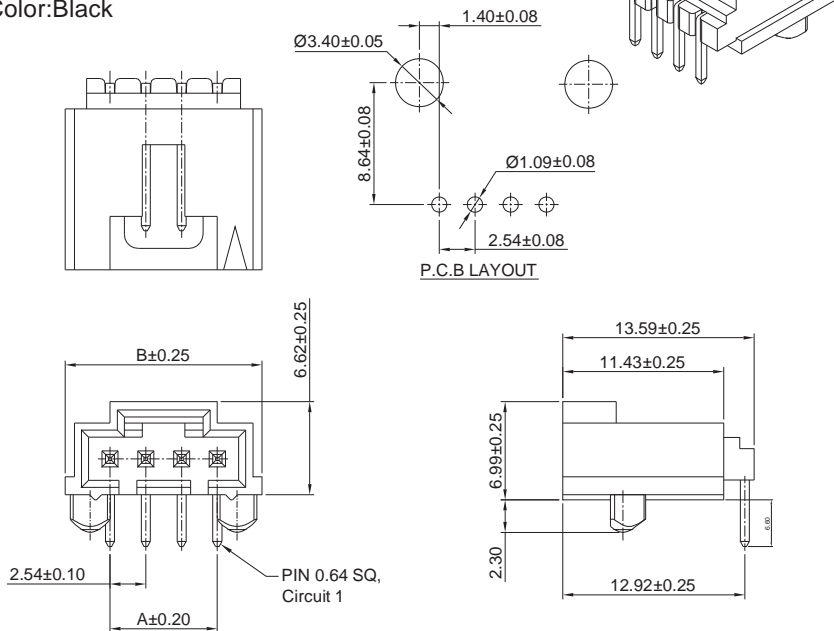

Ordering Information & Dimensions:

PART NO.	Dimensions	
	A	B
A2547WR-F-2P	2.54	8.89
A2547WR-F-3P	5.08	11.43
A2547WR-F-4P	7.62	13.97
A2547WR-F-5P	10.16	16.51
A2547WR-F-6P	12.70	19.05
A2547WR-F-7P	15.24	21.59
A2547WR-F-8P	17.78	24.13
A2547WR-F-9P	20.32	26.67
A2547WR-F-10P	22.86	29.21
A2547WR-F-11P	25.40	31.75
A2547WR-F-12P	27.94	34.29
A2547WR-F-13P	30.48	36.83
A2547WR-F-14P	32.02	39.37
A2547WR-F-15P	35.56	41.91
A2547WR-F-16P	38.10	44.45
A2547WR-F-17P	40.64	46.99
A2547WR-F-18P	43.18	49.53
A2547WR-F-19P	45.72	52.07
A2547WR-F-20P	48.26	54.61
A2547WR-F-21P	50.80	57.15
A2547WR-F-22P	53.34	59.69
A2547WR-F-23P	55.88	62.23
A2547WR-F-24P	58.42	64.77
A2547WR-F-25P	60.96	67.31

Unit: mm

A2547WR-S-F

2.54mm Pitch 90° Wafer SMT TYPE

Reference Informations:

- *Material: Pin: Brass/Gold over Nickel
Insulator: Nylon 6T, UL94V-0
- *Mates with A2547 series Housing
- *Color: Black

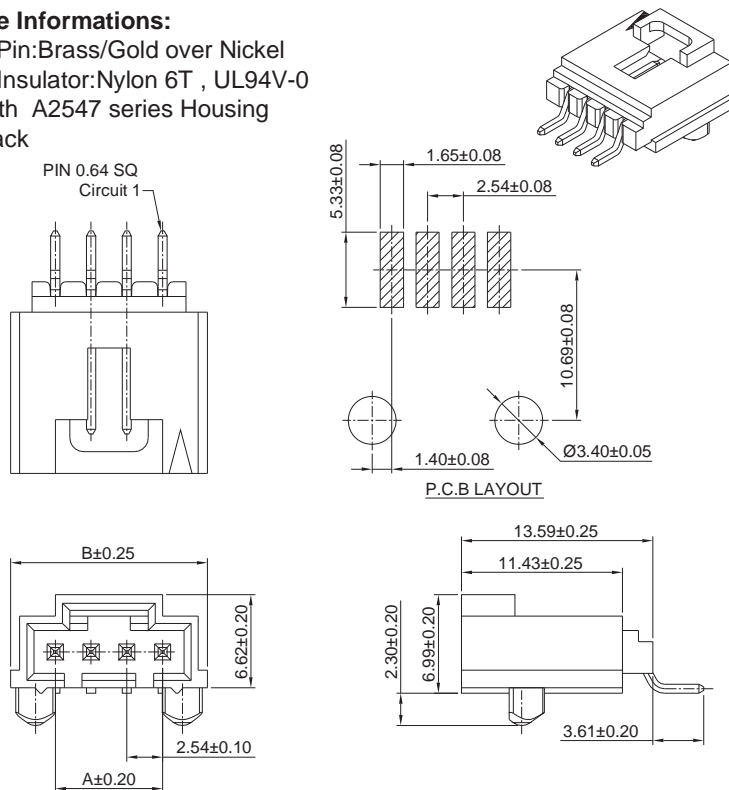

Ordering Information & Dimensions:

PART NO.	Dimensions	
	A	B
A2547WR-S-F-2P	2.54	8.89
A2547WR-S-F-3P	5.08	11.43
A2547WR-S-F-4P	7.62	13.97
A2547WR-S-F-5P	10.16	16.51
A2547WR-S-F-6P	12.70	19.05
A2547WR-S-F-7P	15.24	21.59
A2547WR-S-F-8P	17.78	24.13
A2547WR-S-F-9P	20.32	26.67
A2547WR-S-F-10P	22.86	29.21
A2547WR-S-F-11P	25.40	31.75
A2547WR-S-F-12P	27.94	34.29
A2547WR-S-F-13P	30.48	36.83
A2547WR-S-F-14P	32.02	39.37
A2547WR-S-F-15P	35.56	41.91
A2547WR-S-F-16P	38.10	44.45
A2547WR-S-F-17P	40.64	46.99
A2547WR-S-F-18P	43.18	49.53
A2547WR-S-F-19P	45.72	52.07
A2547WR-S-F-20P	48.26	54.61
A2547WR-S-F-21P	50.80	57.15
A2547WR-S-F-22P	53.34	59.69
A2547WR-S-F-23P	55.88	62.23
A2547WR-S-F-24P	58.42	64.77
A2547WR-S-F-25P	60.96	67.31

Unit: mm

A2547 SERIES

2.54mm pitch wire to board and wire to wire connector

A2547WV-2

2.54mm Pitch 180° Box Header

Reference Informations:

- *Material: Pin: Brass/Gold over Nickel
Insulator: PBT30%GF, UL94V-0
- *Mates with A2547 series Dual row Housing
- *Color: Black

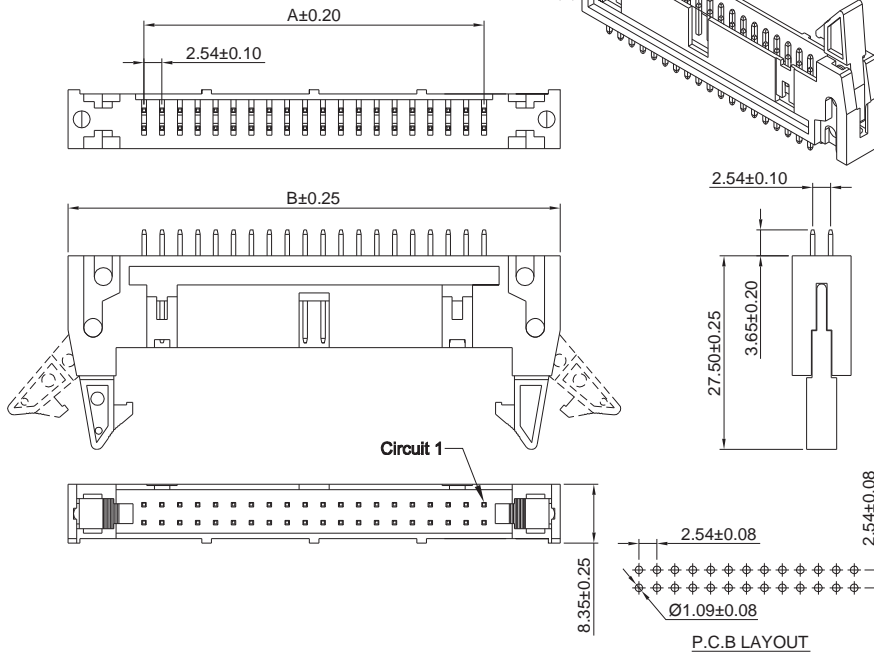

Ordering Information & Dimensions:

PART NO.	Dimensions	
	A	B
A2547WV-2x5P	10.16	32.00
A2547WV-2x6P	12.70	34.54
A2547WV-2x7P	15.24	37.08
A2547WV-2x8P	17.78	39.62
A2547WV-2x9P	20.32	42.16
A2547WV-2x10P	22.86	44.70
A2547WV-2x11P	25.40	47.24
A2547WV-2x12P	27.94	49.78
A2547WV-2x13P	30.48	52.32
A2547WV-2x14P	33.02	54.86
A2547WV-2x15P	35.56	57.40
A2547WV-2x16P	38.10	59.94
A2547WV-2x17P	40.64	62.48
A2547WV-2x18P	43.18	65.02
A2547WV-2x19P	45.72	67.56
A2547WV-2x20P	48.26	70.10
A2547WV-2x21P	50.80	72.64
A2547WV-2x22P	53.34	75.18
A2547WV-2x23P	55.88	77.72
A2547WV-2x24P	58.42	80.26
A2547WV-2x25P	60.96	82.80
A2547WV-2x26P	63.50	85.34
A2547WV-2x27P	66.04	87.88
A2547WV-2x28P	68.58	90.42
A2547WV-2x29P	71.12	92.96
A2547WV-2x30P	73.66	95.50
A2547WV-2x31P	76.20	98.04
A2547WV-2x32P	78.74	100.58

Unit: mm

A2547WR-2

2.54mm Pitch 90° Box Header

Reference Informations:

- *Material: Pin: Brass/Gold over Nickel
Insulator: PBT30%GF, UL94V-0
- *Mates with A2547 series Dual row Housing
- *Color: Black

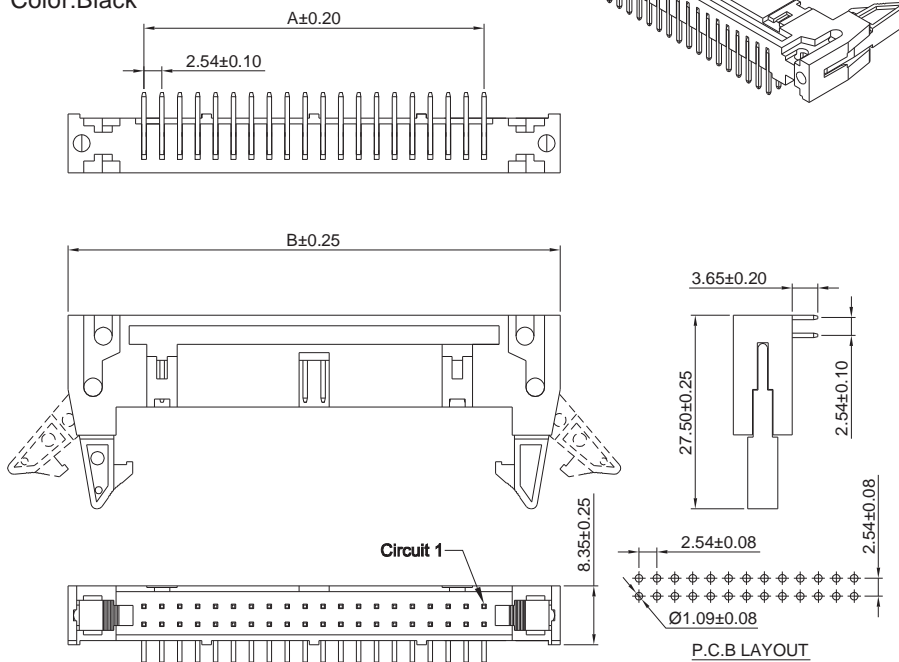

Ordering Information & Dimensions:

PART NO.	Dimensions	
	A	B
A2547WR-2x5P	10.16	32.00
A2547WR-2x6P	12.70	34.54
A2547WR-2x7P	15.24	37.08
A2547WR-2x8P	17.78	39.62
A2547WR-2x9P	20.32	42.16
A2547WR-2x10P	22.86	44.70
A2547WR-2x11P	25.40	47.24
A2547WR-2x12P	27.94	49.78
A2547WR-2x13P	30.48	52.32
A2547WR-2x14P	33.02	54.86
A2547WR-2x15P	35.56	57.40
A2547WR-2x16P	38.10	59.94
A2547WR-2x17P	40.64	62.48
A2547WR-2x18P	43.18	65.02
A2547WR-2x19P	45.72	67.56
A2547WR-2x20P	48.26	70.10
A2547WR-2x21P	50.80	72.64
A2547WR-2x22P	53.34	75.18
A2547WR-2x23P	55.88	77.72
A2547WR-2x24P	58.42	80.26
A2547WR-2x25P	60.96	82.80
A2547WR-2x26P	63.50	85.34
A2547WR-2x27P	66.04	87.88
A2547WR-2x28P	68.58	90.42
A2547WR-2x29P	71.12	92.96
A2547WR-2x30P	73.66	95.50
A2547WR-2x31P	76.20	98.04
A2547WR-2x32P	78.74	100.58

Unit: mm

A2547 SERIES

2.54mm pitch wire to board and wire to wire connector

A2547WVA-2

2.54mm Pitch 180° Box Header

Reference Informations:

- *Material:Pin:Brass/Gold over Nickel
Insulator:PBT30%GF , UL94V-0
- *Mates with A2547HD series Dual row Housing
- *Color:Black

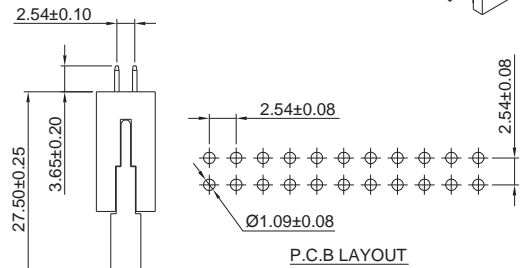
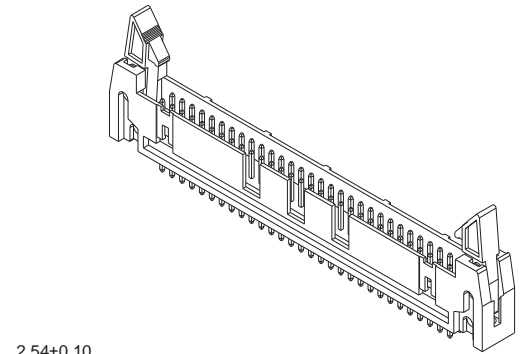
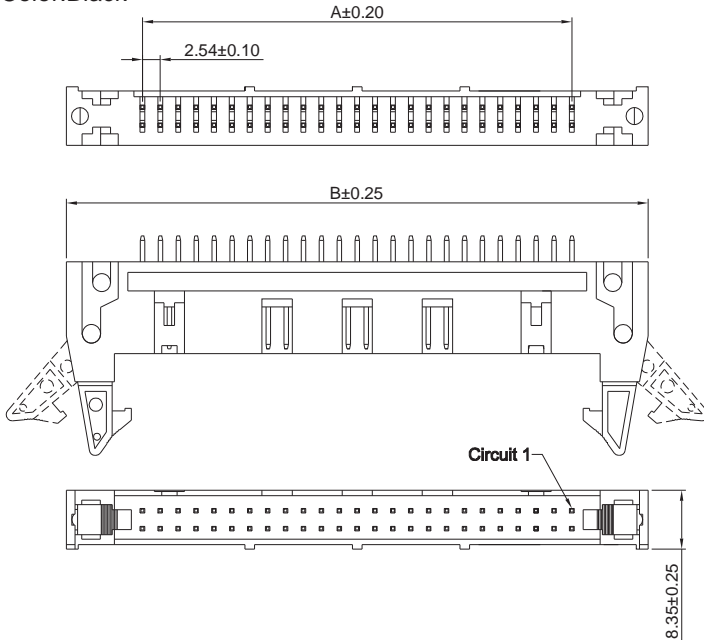

Ordering Information & Dimensions:

PART NO.	Dimensions	
	A	B
A2547WVA-2x25P	60.96	82.80
A2547WVA-2x30P	73.66	95.50
A2547WVA-2x32P	78.74	100.58

Unit: mm

A2547WRA-2

2.54mm Pitch 90° Box Header

Reference Informations:

- *Material:Pin:Brass/Gold over Nickel
Insulator:PBT30%GF , UL94V-0
- *Mates with A2547HD series Dual row Housing
- *Color:Black

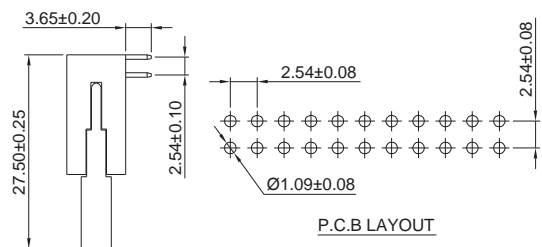
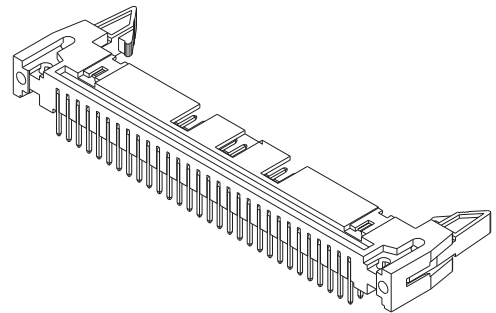
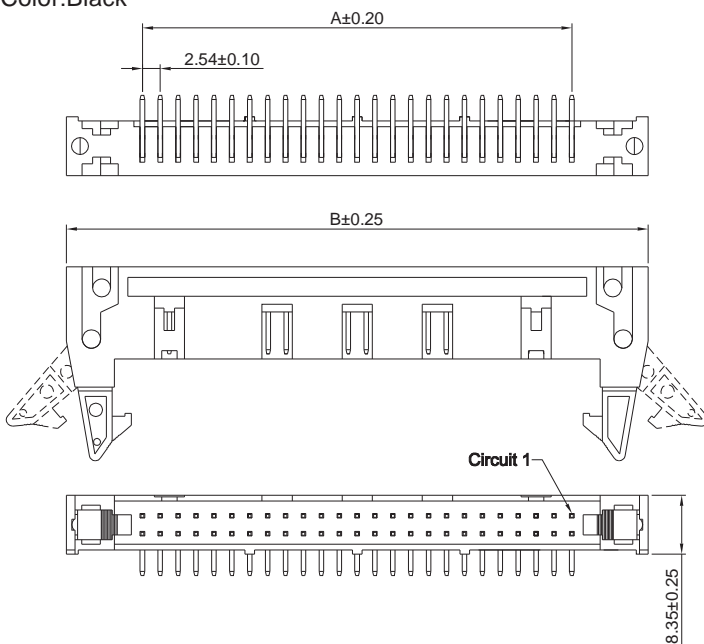

Ordering Information & Dimensions:

PART NO.	Dimensions	
	A	B
A2547WRA-2x25P	60.96	82.80
A2547WRA-2x30P	73.66	95.50
A2547WRA-2x32P	78.74	100.58

Unit: mm

A2547 SERIES

2.54mm pitch wire to board and wire to wire connector

A2547WV-N-2

2.54mm Pitch 180° Box Header

Reference Informations:

- *Material:Pin:Brass/Gold over Nickel
Insulator:PBT15%GF,UL94V-0
- *Mates with A2547H series Dual row Housing
- *Color:Black

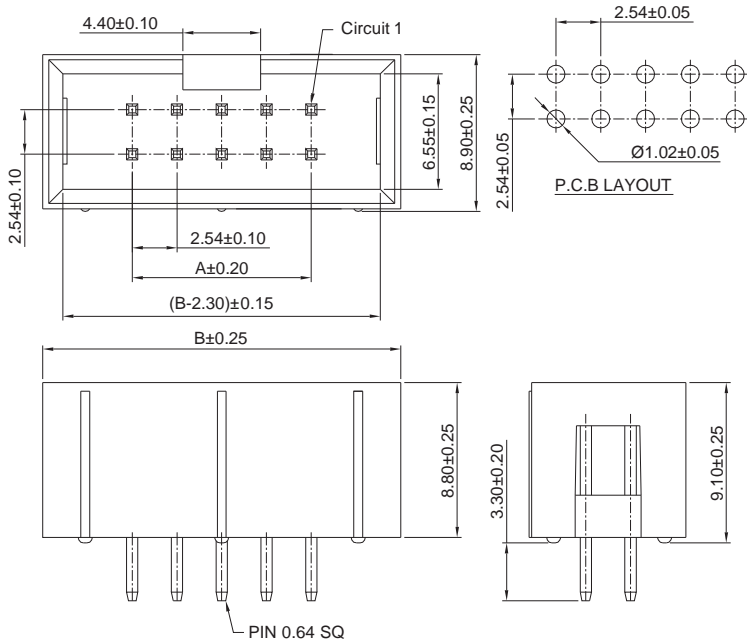
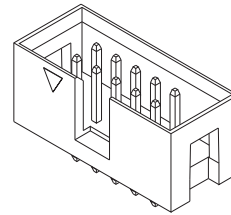

Ordering Information & Dimensions:

PART NO.	Dimensions		PART NO.	Dimensions	
	A	B		A	B
A2547WV-N-2x2P	2.54	12.70	A2547WV-N-2x22P	53.34	63.50
A2547WV-N-2x3P	5.08	15.24	A2547WV-N-2x23P	55.88	66.04
A2547WV-N-2x4P	7.62	17.78	A2547WV-N-2x24P	58.42	68.58
A2547WV-N-2x5P	10.16	20.32	A2547WV-N-2x25P	60.96	71.12
A2547WV-N-2x6P	12.70	22.86	A2547WV-N-2x26P	63.50	73.66
A2547WV-N-2x7P	15.24	25.40	A2547WV-N-2x27P	66.04	76.20
A2547WV-N-2x8P	17.78	27.94	A2547WV-N-2x28P	68.58	78.74
A2547WV-N-2x9P	20.32	30.48	A2547WV-N-2x29P	71.12	81.28
A2547WV-N-2x10P	22.86	33.02	A2547WV-N-2x30P	73.66	83.82
A2547WV-N-2x11P	25.40	35.56	A2547WV-N-2x31P	76.20	86.36
A2547WV-N-2x12P	27.94	38.10	A2547WV-N-2x32P	78.74	88.90
A2547WV-N-2x13P	30.48	40.64	A2547WV-N-2x33P	81.28	91.44
A2547WV-N-2x14P	33.02	43.18	A2547WV-N-2x34P	83.82	93.98
A2547WV-N-2x15P	35.56	45.72	A2547WV-N-2x35P	86.36	96.52
A2547WV-N-2x16P	38.10	48.26	A2547WV-N-2x36P	88.90	99.06
A2547WV-N-2x17P	40.64	50.80	A2547WV-N-2x37P	91.44	101.60
A2547WV-N-2x18P	43.18	53.34	A2547WV-N-2x38P	93.98	104.14
A2547WV-N-2x19P	45.72	55.88	A2547WV-N-2x39P	96.52	106.68
A2547WV-N-2x20P	48.26	58.42	A2547WV-N-2x40P	99.06	109.22
A2547WV-N-2x21P	50.80	60.96			

Unit: mm

A2547WR-N-2

2.54mm Pitch 90° Box Header

Reference Informations:

- *Material:Pin:Brass/Gold over Nickel
Insulator:PBT15%GF,UL94V-0
- *Mates with A2547H series Dual row Housing
- *Color:Black

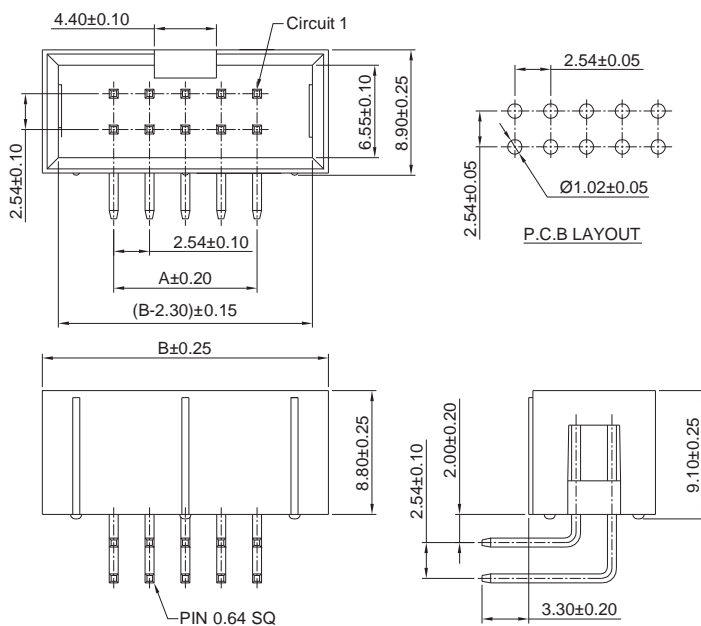
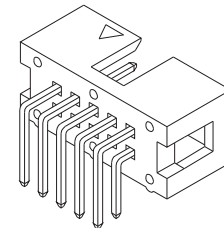

Ordering Information & Dimensions:

PART NO.	Dimensions		PART NO.	Dimensions	
	A	B		A	B
A2547WR-N-2x2P	2.54	12.70	A2547WR-N-2x22P	53.34	63.50
A2547WR-N-2x3P	5.08	15.24	A2547WR-N-2x23P	55.88	66.04
A2547WR-N-2x4P	7.62	17.78	A2547WR-N-2x24P	58.42	68.58
A2547WR-N-2x5P	10.16	20.32	A2547WR-N-2x25P	60.96	71.12
A2547WR-N-2x6P	12.70	22.86	A2547WR-N-2x26P	63.50	73.66
A2547WR-N-2x7P	15.24	25.40	A2547WR-N-2x27P	66.04	76.20
A2547WR-N-2x8P	17.78	27.94	A2547WR-N-2x28P	68.58	78.74
A2547WR-N-2x9P	20.32	30.48	A2547WR-N-2x29P	71.12	81.28
A2547WR-N-2x10P	22.86	33.02	A2547WR-N-2x30P	73.66	83.82
A2547WR-N-2x11P	25.40	35.56	A2547WR-N-2x31P	76.20	86.36
A2547WR-N-2x12P	27.94	38.10	A2547WR-N-2x32P	78.74	88.90
A2547WR-N-2x13P	30.48	40.64	A2547WR-N-2x33P	81.28	91.44
A2547WR-N-2x14P	33.02	43.18	A2547WR-N-2x34P	83.82	93.98
A2547WR-N-2x15P	35.56	45.72	A2547WR-N-2x35P	86.36	96.52
A2547WR-N-2x16P	38.10	48.26	A2547WR-N-2x36P	88.90	99.06
A2547WR-N-2x17P	40.64	50.80	A2547WR-N-2x37P	91.44	101.60
A2547WR-N-2x18P	43.18	53.34	A2547WR-N-2x38P	93.98	104.14
A2547WR-N-2x19P	45.72	55.88	A2547WR-N-2x39P	96.52	106.68
A2547WR-N-2x20P	48.26	58.42	A2547WR-N-2x40P	99.06	109.22
A2547WR-N-2x21P	50.80	60.96			

Unit: mm

A2547 SERIES

2.54mm pitch wire to board and wire to wire connector

A2547WVB-2

2.54mm Pitch 180° Box Header

Reference Informations:

- *Material:Pin:Brass/Gold over Nickel
Insulator:PBT15%GF,UL94V-0
- *Mates with A2547HJ series Housing
- *Color:Black

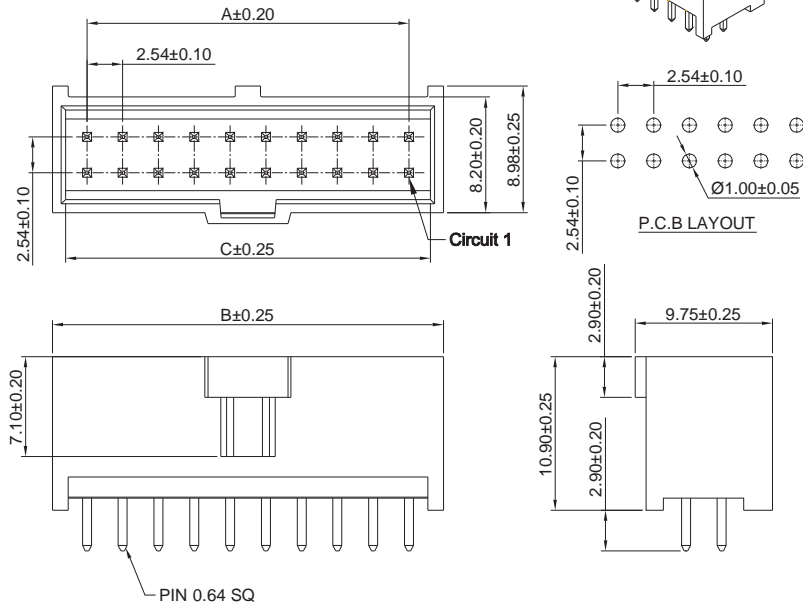

Ordering Information & Dimensions:

PART NO.	Dimensions		
	A	B	C
A2547WVB-2x3P	5.08	9.96	8.12
A2547WVB-2x4P	7.62	12.50	10.66
A2547WVB-2x5P	10.16	15.04	13.20
A2547WVB-2x6P	12.70	17.58	15.74
A2547WVB-2x7P	15.24	20.12	18.28
A2547WVB-2x8P	17.78	22.66	20.82
A2547WVB-2x9P	20.32	25.20	23.36
A2547WVB-2x10P	22.86	27.74	25.90
A2547WVB-2x11P	25.40	30.28	28.44
A2547WVB-2x12P	27.94	32.82	30.98
A2547WVB-2x13P	30.48	35.36	33.52
A2547WVB-2x14P	33.02	37.09	36.06
A2547WVB-2x15P	35.56	40.44	38.60
A2547WVB-2x16P	38.10	42.98	41.14
A2547WVB-2x17P	40.64	45.52	43.68
A2547WVB-2x18P	43.18	48.06	46.22
A2547WVB-2x19P	45.72	50.60	48.76
A2547WVB-2x20P	48.26	53.14	51.30
A2547WVB-2x21P	50.80	55.68	53.84
A2547WVB-2x22P	53.34	58.22	56.38
A2547WVB-2x23P	55.88	60.76	58.92
A2547WVB-2x24P	58.42	63.30	61.46
A2547WVB-2x25P	60.96	65.84	64.00
A2547WVB-2x26P	63.50	68.38	66.54
A2547WVB-2x27P	66.04	70.92	69.08
A2547WVB-2x28P	68.58	73.46	71.62
A2547WVB-2x29P	71.12	76.00	74.16
A2547WVB-2x30P	73.66	78.54	76.70
A2547WVB-2x31P	76.20	81.08	79.24
A2547WVB-2x32P	78.74	83.62	81.78

Unit: mm

A2547WRB-2

2.54mm Pitch 90° Box Header

Reference Informations:

- *Material:Pin:Brass/Gold over Nickel
Insulator:PBT15%GF,UL94V-0
- *Mates with A2547HJ series Housing
- *Color:Black

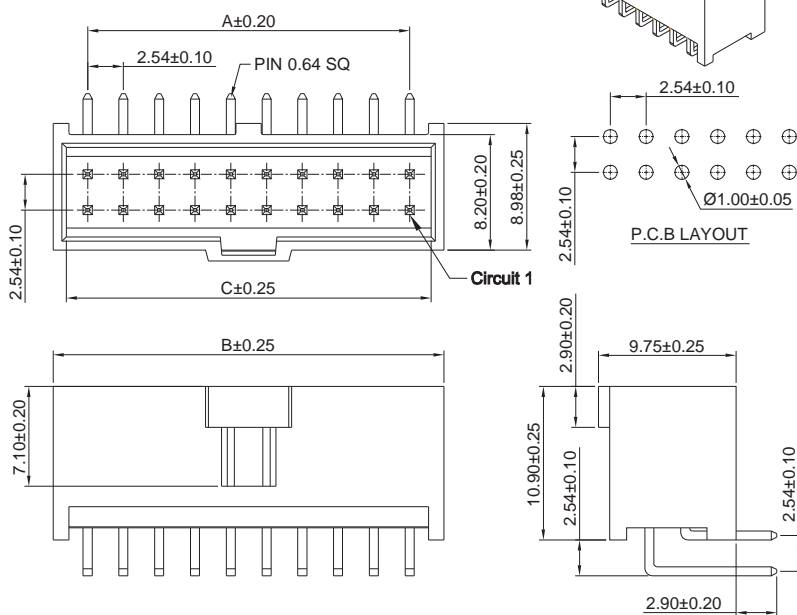

Ordering Information & Dimensions:

PART NO.	Dimensions		
	A	B	C
A2547WRB-2x3P	5.08	9.96	8.12
A2547WRB-2x4P	7.62	12.50	10.66
A2547WRB-2x5P	10.16	15.04	13.20
A2547WRB-2x6P	12.70	17.58	15.74
A2547WRB-2x7P	15.24	20.12	18.28
A2547WRB-2x8P	17.78	22.66	20.82
A2547WRB-2x9P	20.32	25.20	23.36
A2547WRB-2x10P	22.86	27.74	25.90
A2547WRB-2x11P	25.40	30.28	28.44
A2547WRB-2x12P	27.94	32.82	30.98
A2547WRB-2x13P	30.48	35.36	33.52
A2547WRB-2x14P	33.02	37.09	36.06
A2547WRB-2x15P	35.56	40.44	38.60
A2547WRB-2x16P	38.10	42.98	41.14
A2547WRB-2x17P	40.64	45.52	43.68
A2547WRB-2x18P	43.18	48.06	46.22
A2547WRB-2x19P	45.72	50.60	48.76
A2547WRB-2x20P	48.26	53.14	51.30
A2547WRB-2x21P	50.80	55.68	53.84
A2547WRB-2x22P	53.34	58.22	56.38
A2547WRB-2x23P	55.88	60.76	58.92
A2547WRB-2x24P	58.42	63.30	61.46
A2547WRB-2x25P	60.96	65.84	64.00
A2547WRB-2x26P	63.50	68.38	66.54
A2547WRB-2x27P	66.04	70.92	69.08
A2547WRB-2x28P	68.58	73.46	71.62
A2547WRB-2x29P	71.12	76.00	74.16
A2547WRB-2x30P	73.66	78.54	76.70
A2547WRB-2x31P	76.20	81.08	79.24
A2547WRB-2x32P	78.74	83.62	81.78

Unit: mm

A2547 SERIES

2.54mm pitch wire to board and wire to wire connector

A2547WVB-2-A

2.54mm Pitch 180° Box Header

Reference Informations:

- *Material:Pin:Brass/Gold over Nickel
Insulator:PBT15%GF,UL94V-0
- *Mates with A2547HJ series Housing
- *Color:Black

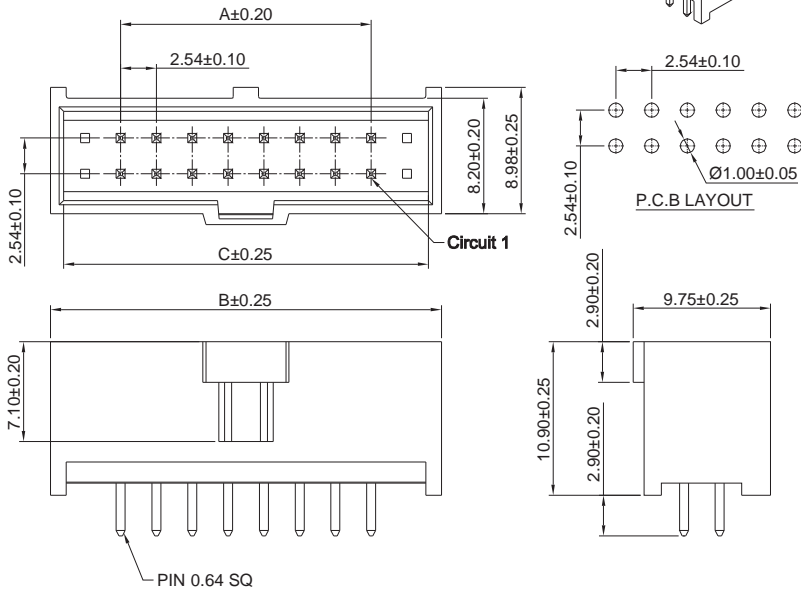
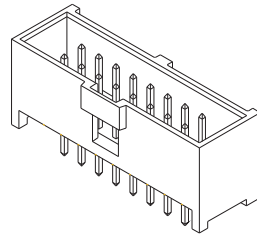

Ordering Information & Dimensions:

PART NO.	Dimensions		
	A	B	C
A2547WVB-2x4P-A	7.62	17.58	15.74
A2547WVB-2x5P-A	10.16	20.12	18.28
A2547WVB-2x6P-A	12.70	22.66	20.82
A2547WVB-2x7P-A	15.24	25.20	23.36
A2547WVB-2x8P-A	17.78	27.74	25.90
A2547WVB-2x9P-A	20.32	30.28	28.44
A2547WVB-2x10P-A	22.86	32.82	30.98
A2547WVB-2x11P-A	25.40	35.36	33.52
A2547WVB-2x12P-A	27.94	37.90	36.06
A2547WVB-2x13P-A	30.48	40.44	38.60
A2547WVB-2x14P-A	33.02	42.98	41.14
A2547WVB-2x15P-A	35.56	45.52	43.68
A2547WVB-2x16P-A	38.10	48.06	46.22
A2547WVB-2x17P-A	40.64	50.60	48.76
A2547WVB-2x18P-A	43.18	53.14	51.30
A2547WVB-2x19P-A	45.72	55.68	53.84
A2547WVB-2x20P-A	48.26	58.22	56.38
A2547WVB-2x21P-A	50.80	60.76	58.92
A2547WVB-2x22P-A	53.34	63.30	61.46
A2547WVB-2x23P-A	55.88	65.84	64.00
A2547WVB-2x24P-A	58.42	68.38	66.54
A2547WVB-2x25P-A	60.96	70.92	69.08
A2547WVB-2x26P-A	63.50	73.46	71.62
A2547WVB-2x27P-A	66.04	76.00	74.16
A2547WVB-2x28P-A	68.58	78.54	76.70
A2547WVB-2x29P-A	71.12	81.08	79.24
A2547WVB-2x30P-A	73.66	83.62	81.78
A2547WVB-2x31P-A	76.20	86.16	84.32
A2547WVB-2x32P-A	78.74	88.70	86.86

Unit: mm

A2547WRB-2-A

2.54mm Pitch 90° Box Header

Reference Informations:

- *Material:Pin:Brass/Gold over Nickel
Insulator:PBT15%GF,UL94V-0
- *Mates with A2547HJ series Housing
- *Color:Black

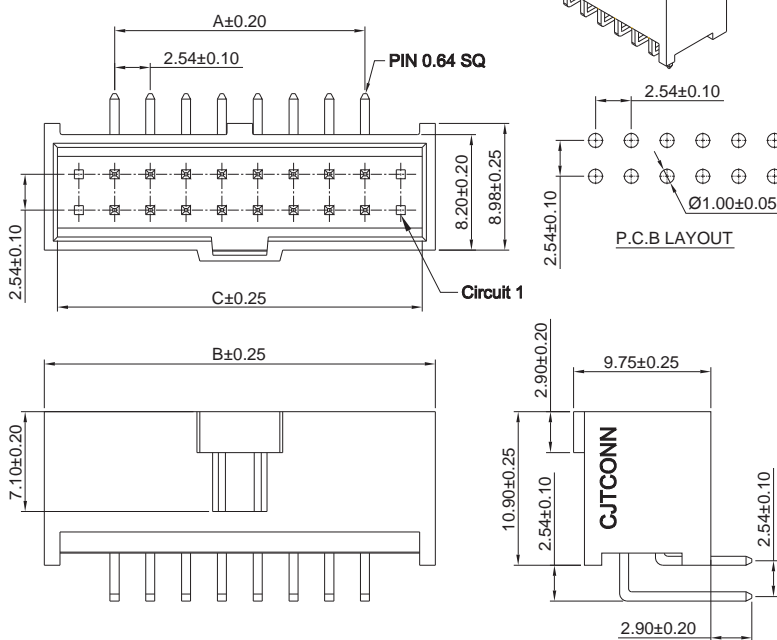
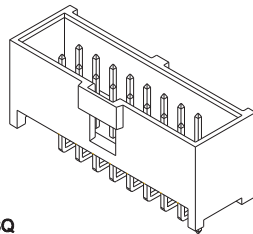

Ordering Information & Dimensions:

PART NO.	Dimensions		
	A	B	C
A2547WRB-2x4P-A	7.62	17.58	15.74
A2547WRB-2x5P-A	10.16	20.12	18.28
A2547WRB-2x6P-A	12.70	22.66	20.82
A2547WRB-2x7P-A	15.24	25.20	23.36
A2547WRB-2x8P-A	17.78	27.74	25.90
A2547WRB-2x9P-A	20.32	30.28	28.44
A2547WRB-2x10P-A	22.86	32.82	30.98
A2547WRB-2x11P-A	25.40	35.36	33.52
A2547WRB-2x12P-A	27.94	37.90	36.06
A2547WRB-2x13P-A	30.48	40.44	38.60
A2547WRB-2x14P-A	33.02	42.98	41.14
A2547WRB-2x15P-A	35.56	45.52	43.68
A2547WRB-2x16P-A	38.10	48.06	46.22
A2547WRB-2x17P-A	40.64	50.60	48.76
A2547WRB-2x18P-A	43.18	53.14	51.30
A2547WRB-2x19P-A	45.72	55.68	53.84
A2547WRB-2x20P-A	48.26	58.22	56.38
A2547WRB-2x21P-A	50.80	60.76	58.92
A2547WRB-2x22P-A	53.34	63.30	61.46
A2547WRB-2x23P-A	55.88	65.84	64.00
A2547WRB-2x24P-A	58.42	68.38	66.54
A2547WRB-2x25P-A	60.96	70.92	69.08
A2547WRB-2x26P-A	63.50	73.46	71.62
A2547WRB-2x27P-A	66.04	76.00	74.16
A2547WRB-2x28P-A	68.58	78.54	76.70
A2547WRB-2x29P-A	71.12	81.08	79.24
A2547WRB-2x30P-A	73.66	83.62	81.78
A2547WRB-2x31P-A	76.20	86.16	84.32
A2547WRB-2x32P-A	78.74	88.70	86.86

Unit: mm

A2547 SERIES

2.54mm pitch wire to board and wire to wire connector

A2547HI-2

2.54mm Pitch 180° Box Header

Reference Informations:

- *Material:Pin:Brass/Gold over Nickel
Insulator:PBT30%GF , UL94V-0
- *Mates with A2547 series Dual row Housing
- *Color:Gray

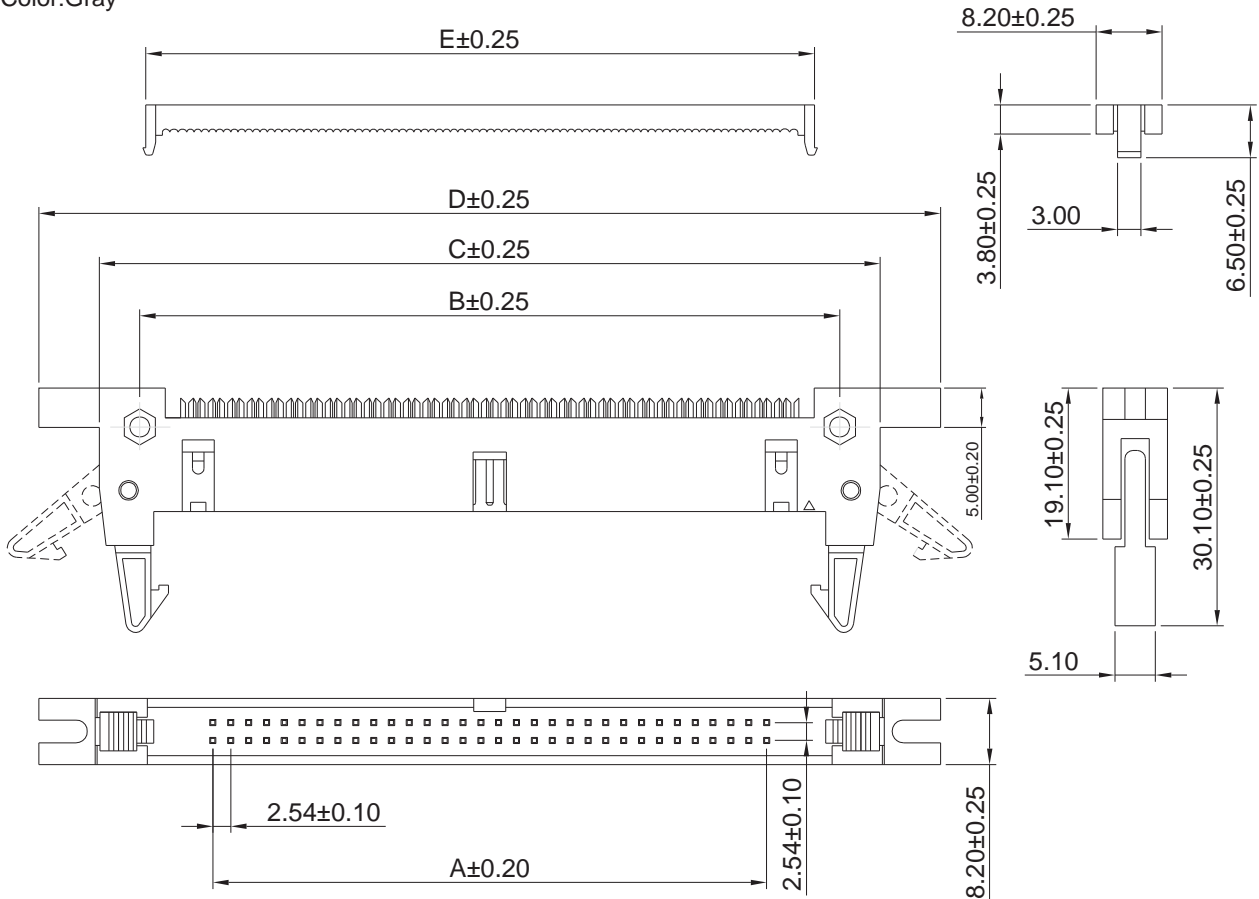

Ordering Information & Dimensions:

PART NO.	Dimensions					PART NO.	Dimensions				
	A	B	C	D	E		A	B	C	D	E
A2547HI-2x5P	10.16	24.39	31.92	47.32	17.27	A2547HI-2x19P	45.72	59.95	67.18	82.88	52.83
A2547HI-2x6P	12.70	26.93	34.46	49.86	19.81	A2547HI-2x20P	48.26	62.49	69.72	85.42	55.37
A2547HI-2x7P	15.24	29.47	37.00	52.40	22.35	A2547HI-2x21P	50.80	65.03	72.26	87.96	57.91
A2547HI-2x8P	17.78	32.01	39.54	54.94	24.89	A2547HI-2x22P	53.34	67.57	74.80	90.50	60.45
A2547HI-2x9P	20.32	34.55	42.08	57.48	27.43	A2547HI-2x23P	55.88	70.11	77.34	93.04	62.99
A2547HI-2x10P	22.86	37.09	44.62	60.02	29.97	A2547HI-2x24P	58.42	72.65	79.88	95.58	65.53
A2547HI-2x11P	25.40	39.63	47.16	62.56	32.51	A2547HI-2x25P	60.96	75.19	82.42	98.12	68.07
A2547HI-2x12P	27.94	42.17	49.70	65.10	35.05	A2547HI-2x26P	63.50	77.73	84.96	100.66	70.61
A2547HI-2x13P	30.48	44.71	52.24	67.64	37.59	A2547HI-2x27P	66.04	80.27	87.50	103.20	73.15
A2547HI-2x14P	33.02	47.25	54.78	70.18	40.13	A2547HI-2x28P	68.58	82.81	90.04	105.74	75.69
A2547HI-2x15P	35.56	49.79	57.32	72.72	42.67	A2547HI-2x29P	71.12	85.35	92.58	108.28	78.23
A2547HI-2x16P	38.10	52.33	59.86	75.26	45.21	A2547HI-2x30P	73.66	87.89	95.12	110.82	80.77
A2547HI-2x17P	40.64	54.87	62.40	77.80	47.75	A2547HI-2x31P	76.20	90.43	97.66	113.36	83.31
A2547HI-2x18P	43.18	57.41	64.94	80.34	50.29	A2547HI-2x32P	78.74	92.97	100.20	115.90	85.85

Unit: mm

A2547 SERIES

2.54mm pitch wire to board and wire to wire connector

A2547HIA-2

2.54mm Pitch 180° Box Header

Reference Informations:

- *Material: Pin: Brass/Gold over Nickel
Insulator: PBT30%GF, UL94V-0
- *Mates with A2547H series Dual row Housing
- *Color: Gray

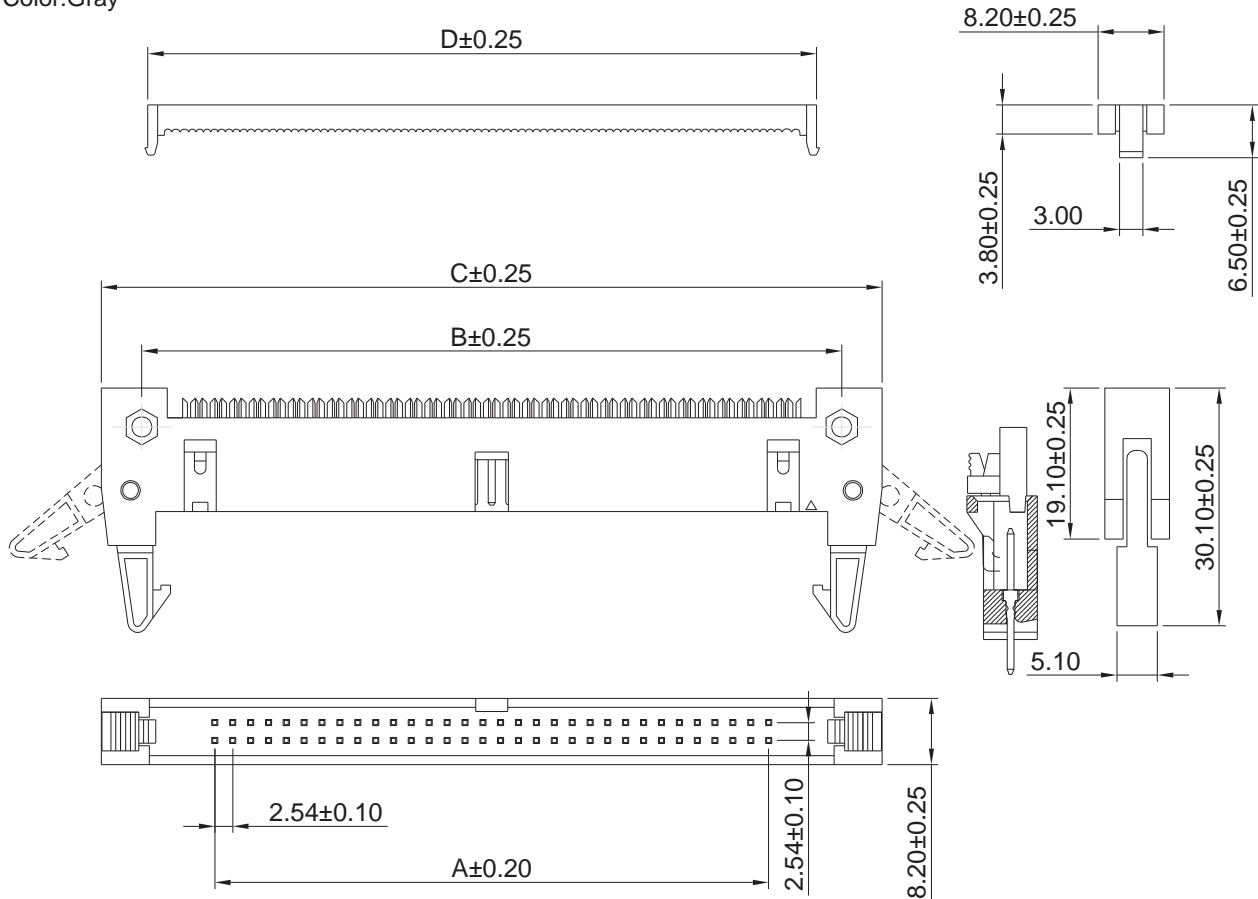

Ordering Information & Dimensions:

PART NO.	Dimensions				PART NO.	Dimensions			
	A	B	C	D		A	B	C	D
A2547HIA-2x5P	10.16	24.39	31.92	17.27	A2547HIA-2x19P	45.72	59.95	67.18	52.83
A2547HIA-2x6P	12.70	26.93	34.46	19.81	A2547HIA-2x20P	48.26	62.49	69.72	55.37
A2547HIA-2x7P	15.24	29.47	37.00	22.35	A2547HIA-2x21P	50.80	65.03	72.26	57.91
A2547HIA-2x8P	17.78	32.01	39.54	24.89	A2547HIA-2x22P	53.34	67.57	74.80	60.45
A2547HIA-2x9P	20.32	34.55	42.08	27.43	A2547HIA-2x23P	55.88	70.11	77.34	62.99
A2547HIA-2x10P	22.86	37.09	44.62	29.97	A2547HIA-2x24P	58.42	72.65	79.88	65.53
A2547HIA-2x11P	25.40	39.63	47.16	32.51	A2547HIA-2x25P	60.96	75.19	82.42	68.07
A2547HIA-2x12P	27.94	42.17	49.70	35.05	A2547HIA-2x26P	63.50	77.73	84.96	70.61
A2547HIA-2x13P	30.48	44.71	52.24	37.59	A2547HIA-2x27P	66.04	80.27	87.50	73.15
A2547HIA-2x14P	33.02	47.25	54.78	40.13	A2547HIA-2x28P	68.58	82.81	90.04	75.69
A2547HIA-2x15P	35.56	49.79	57.32	42.67	A2547HIA-2x29P	71.12	85.35	92.58	78.23
A2547HIA-2x16P	38.10	52.33	59.86	45.21	A2547HIA-2x30P	73.66	87.89	95.12	80.77
A2547HIA-2x17P	40.64	54.87	62.40	47.75	A2547HIA-2x31P	76.20	90.43	97.66	83.31
A2547HIA-2x18P	43.18	57.41	64.94	50.29	A2547HIA-2x32P	78.74	92.97	100.20	85.85

Unit: mm