

A2549 SERIES

2.54mm pitch wire to board connector

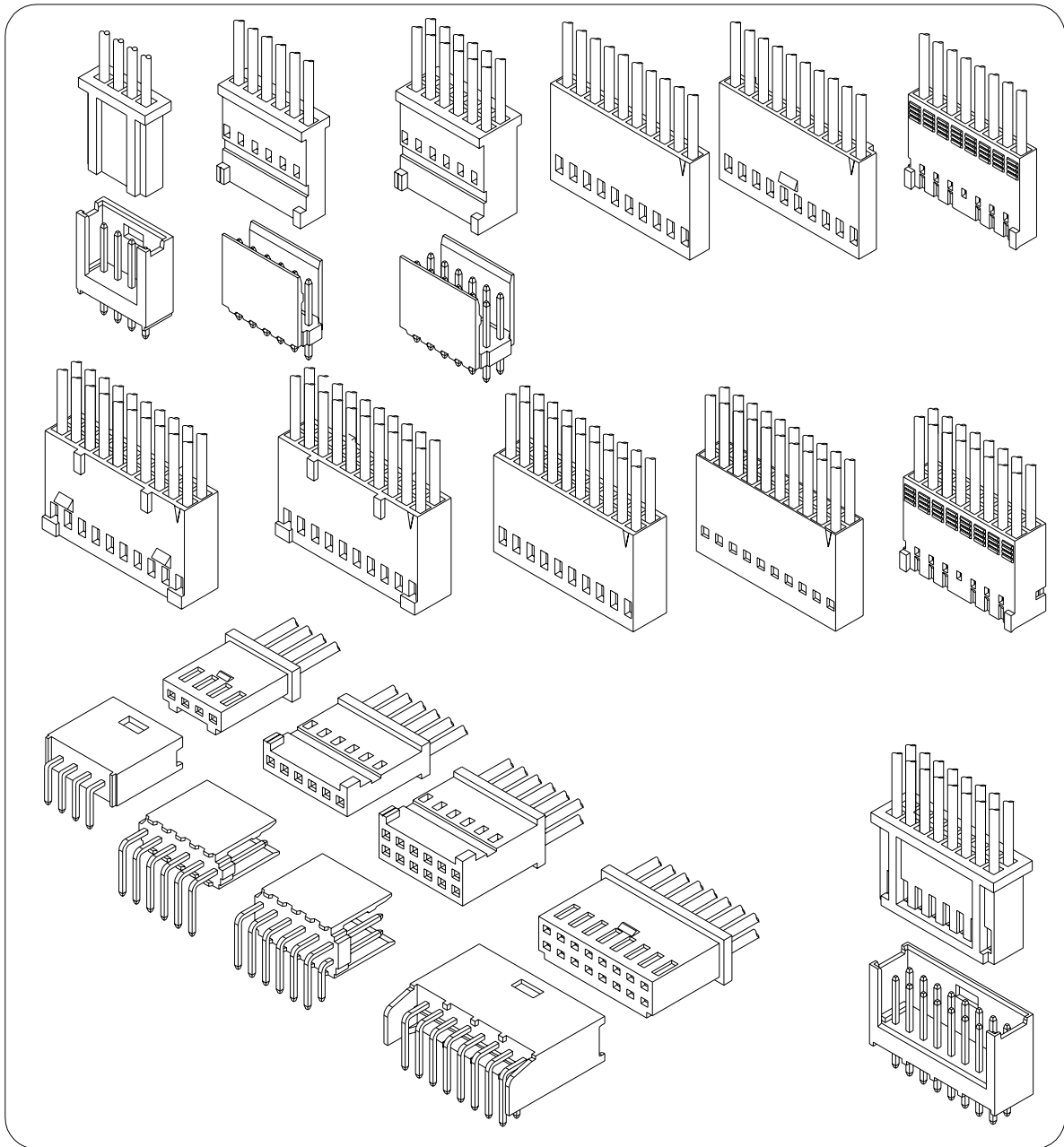

Specifications

- Current rating:3A AC,DC
- Voltage rating:250V AC,DC
- Temperature range:-40°C~+105°C
- Contact resistance:20mΩMax.
- Insulation resistance:1000MΩMin.
- Withstanding voltage:1000V AC/minute
- *Compliant with RoHS and REACH*
- *Meet the HF/Halogen Free,need to customize*
- *Contact for details*

Standards



Assembly layout

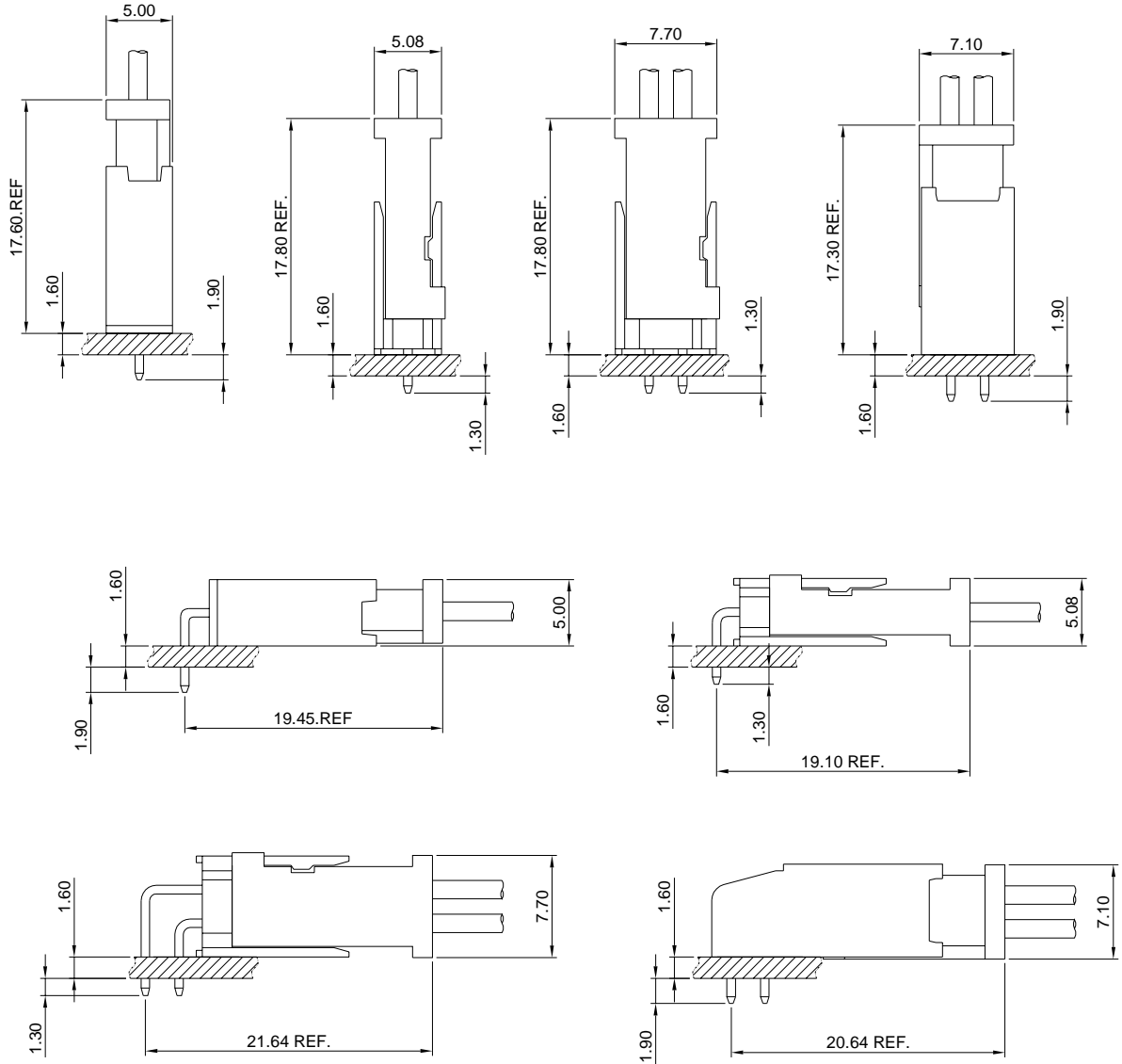

A2549 SERIES

2.54mm pitch wire to board connector

A2549-T-A

2.54mm Pitch Crimp Terminal

Reference Informations:

*Used in A2549HB A2549HB-2 series Housing

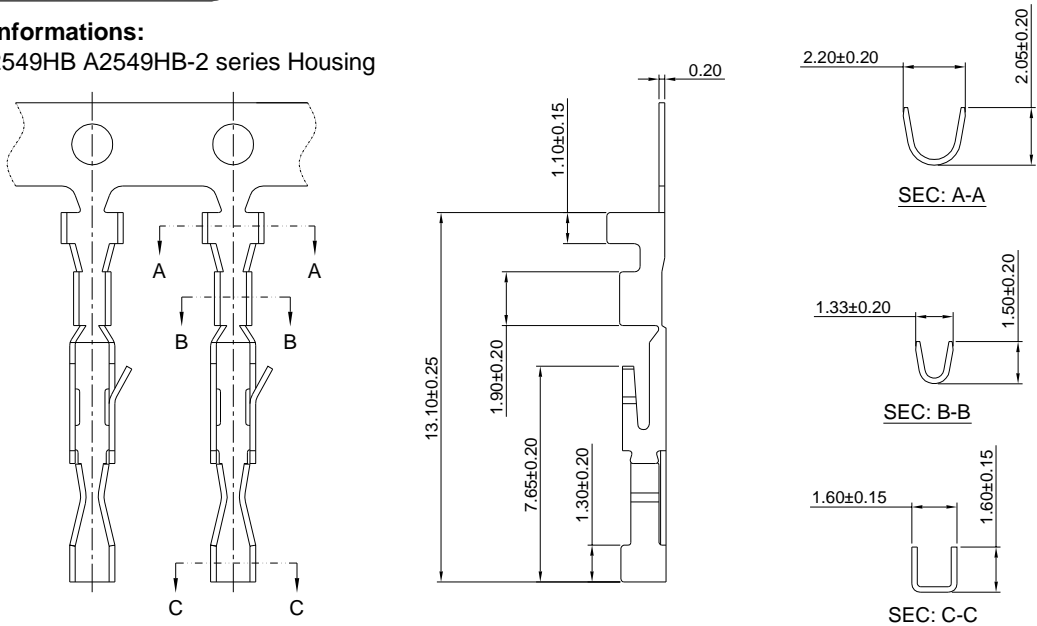

Ordering information & Specifications:

Unit:mm

Part NO.	Wire Range	Insulation O.D.	Material	Finish	Qty/reel
A2549-TP-A	AWG#22-#28	1.55mm(max)	Phosphor Bronze	Tin over Nickel	20,000 PCS
A2549-GP-A	AWG#22-#28	1.55mm(max)	Phosphor Bronze	Gold over Nickel	20,000 PCS

Optional Gold plating available but MOQ requested

A2549-T-B

2.54mm Pitch Crimp Terminal

Reference Informations:

*Used in A2549H A2549H-2 A2549HA series Housing

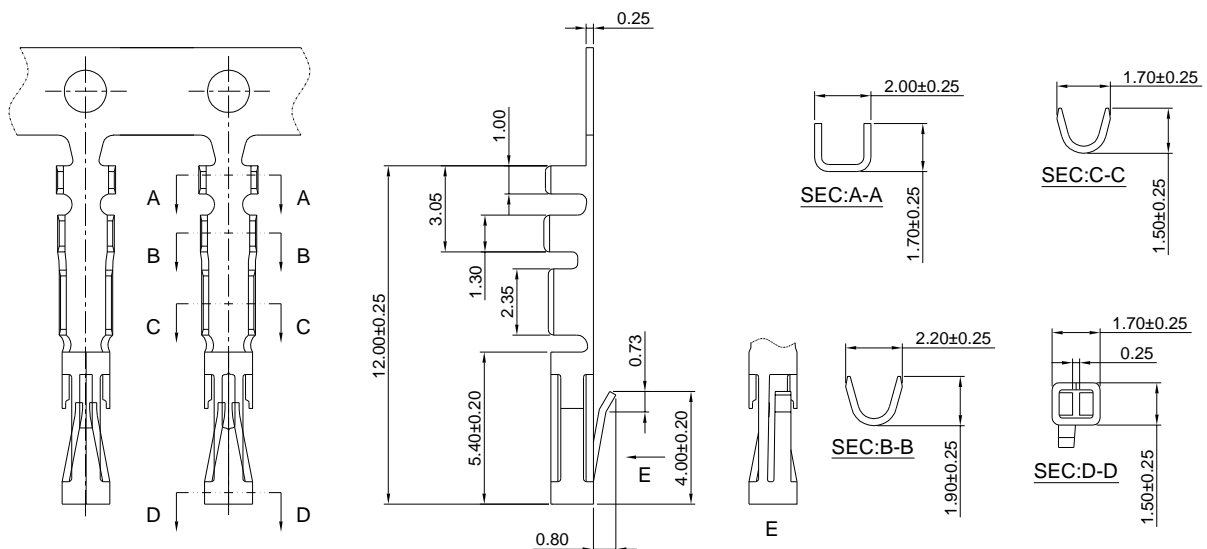

Ordering information & Specifications:

Unit:mm

Part NO.	Wire Range	Insulation O.D.	Material	Finish	Qty/reel
A2549-TP-B	AWG#22-#26	1.55mm(max)	Phosphor Bronze	Tin over Nickel	15,000 PCS
A2549-GP-B	AWG#22-#26	1.55mm(max)	Phosphor Bronze	Gold over Nickel	15,000 PCS

Optional Gold plating available but MOQ requested

A2549 SERIES

2.54mm pitch wire to board connector

A2549-T-C

2.54mm Pitch Crimp Terminal

Reference Informations:

*Used in A2549HC A2549HC-2 A2549HD A2549HD-2 A2549HE-2
A2549HG-2 series Housing

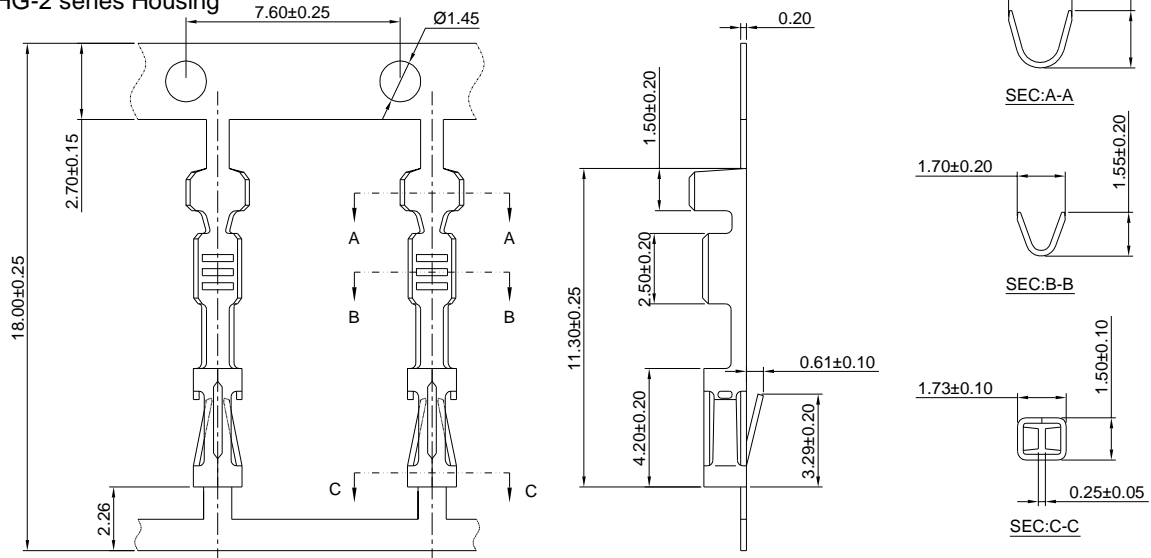

Ordering information & Specifications:

Unit:mm

Part NO.	Wire Range	Insulation O.D.	Material	Finish	Qty/reel
A2549-TP-C	AWG#22-#26	1.55mm(max)	Phosphor Bronze	Tin over Nickel	20,000 PCS
A2549-GP-C	AWG#22-#26	1.55mm(max)	Phosphor Bronze	Gold over Nickel	20,000 PCS

Optional Gold plating available but MOQ requested

A2549-T-C-H

2.54mm Pitch Crimp Terminal

Reference Informations:

*Used in A2549HC A2549HC-2 A2549HD A2549HD-2 A2549HE-2
A2549HG-2 series Housing

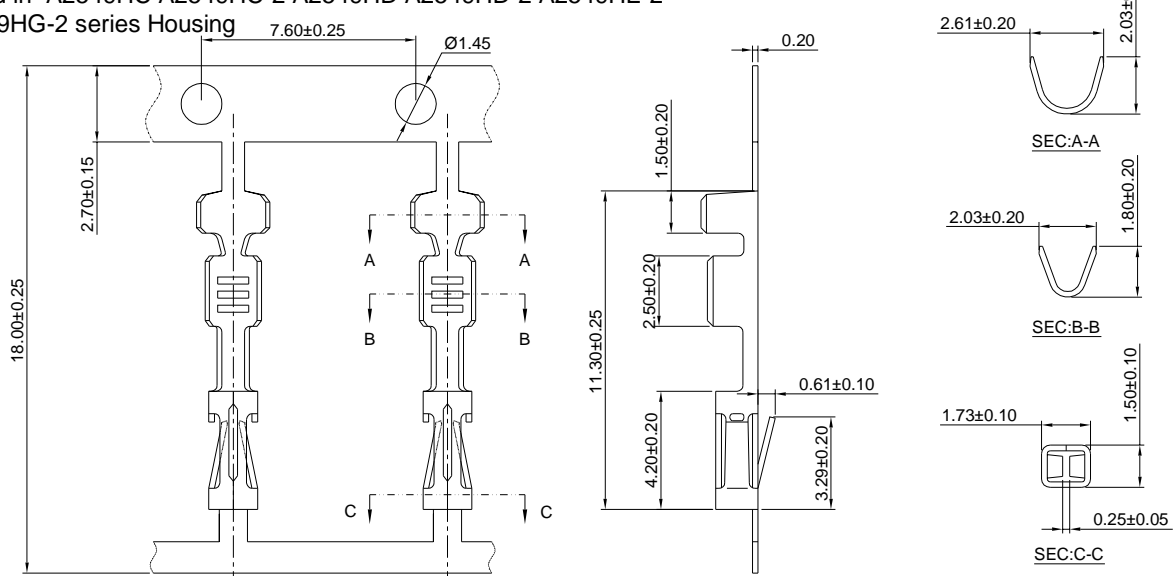

Ordering information & Specifications:

Unit:mm

Part NO.	Wire Range	Insulation O.D.	Material	Finish	Qty/reel
A2549-TP-C-H	AWG#20-#24	1.90mm(max)	Phosphor Bronze	Tin over Nickel	20,000 PCS
A2549-GP-C-H	AWG#20-#24	1.90mm(max)	Phosphor Bronze	Gold over Nickel	20,000 PCS

Optional Gold plating available but MOQ requested

A2549 SERIES

2.54mm pitch wire to board connector

A2549-T-C-L

2.54mm Pitch Crimp Terminal

Reference Informations:

*Used in A2549HC A2549HC-2 A2549HD A2549HD-2 A2549HE-2 A2549HG-2 series Housing

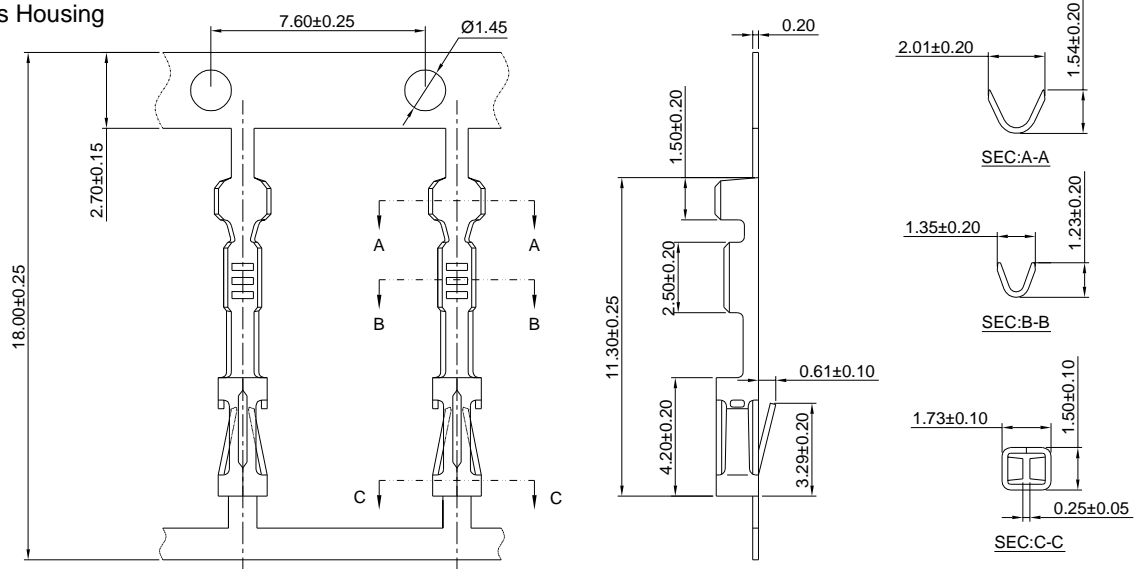

Ordering information & Specifications:

Unit:mm

Part NO.	Wire Range	Insulation O.D.	Material	Finish	Qty/reel
A2549-TP-C-L	AWG#28-#32	0.90mm(max)	Phosphor Bronze	Tin over Nickel	20,000 PCS
A2549-GP-C-L	AWG#28-#32	0.90mm(max)	Phosphor Bronze	Gold over Nickel	20,000 PCS

Optional Gold plating available but MOQ requested

A2550 SERIES

2.54mm pitch FFC Crimp Flex connector

A2549-T-K

2.54mm Pitch Crimp Terminal

Reference Informations:

*Used in A2549HK A2549HK-2 series Housing

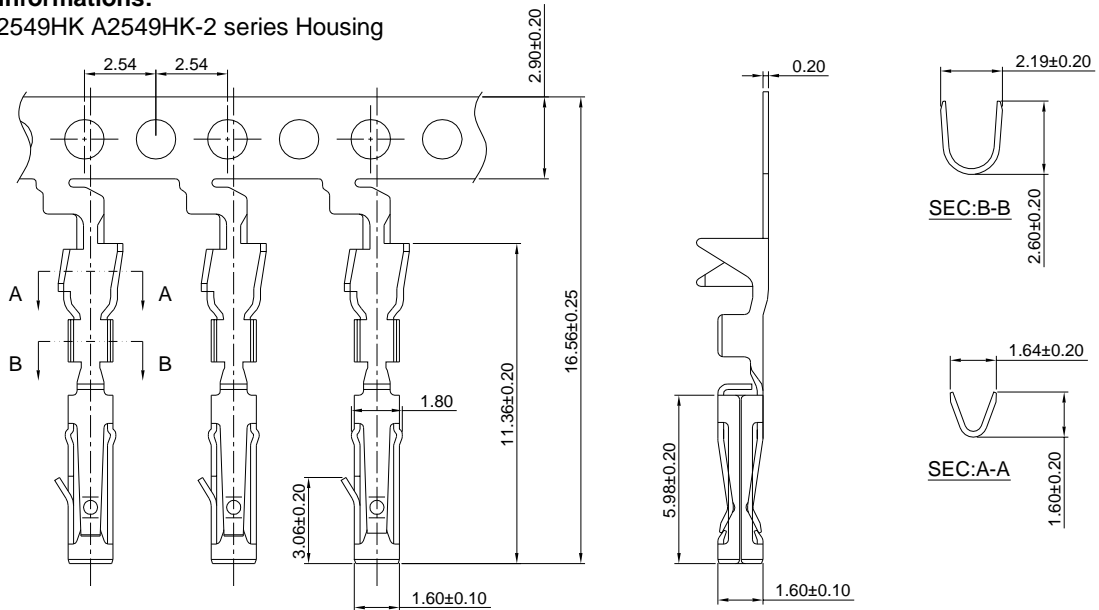

Ordering information & Specifications:

Unit:mm

Part NO.	Wire Range	Insulation O.D.	Material	Finish	Qty/reel
A2549-TP-K	AWG#22-#30	1.50mm(max)	Phosphor Bronze	Tin over Nickel	20,000 PCS
A2549-GP-K	AWG#22-#30	1.50mm(max)	Phosphor Bronze	Gold over Nickel	20,000 PCS

Optional Gold plating available but MOQ requested

A2549-T-K-H

2.54mm Pitch Crimp Terminal

Reference Informations:

*Used in A2549HK A2549HK-2 series Housing

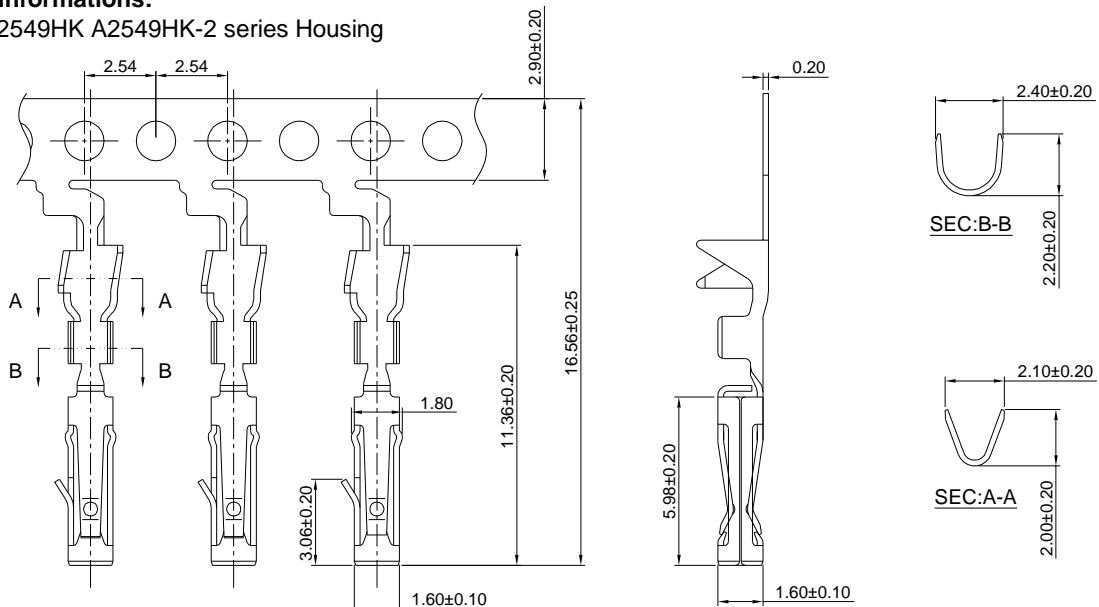

Ordering information & Specifications:

Unit:mm

Part NO.	Wire Range	Insulation O.D.	Material	Finish	Qty/reel
A2549-TP-K-H	AWG#20-#22	1.60mm(max)	Phosphor Bronze	Tin over Nickel	20,000 PCS
A2549-GP-K-H	AWG#20-#22	1.60mm(max)	Phosphor Bronze	Gold over Nickel	20,000 PCS

Optional Gold plating available but MOQ requested

A2549 SERIES

2.54mm pitch wire to board connector

A2549H

2.54mm pitch Housing

Reference Informations:

- *Material:PBT, UL94V-0
- *Suitable A2549-B series Terminal
- *Mates with A2549WV A2549WR A2547WVE A2547WRE series Wafer
- *Color:Black

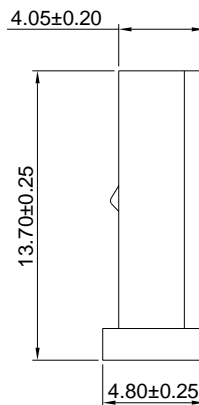
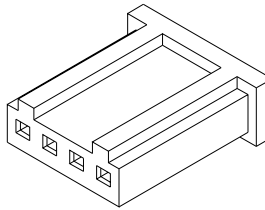
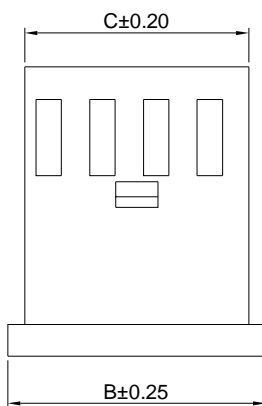
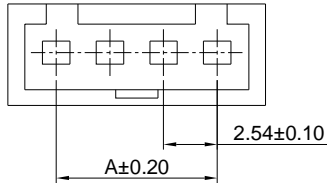

Ordering Information & Dimensions:

PART NO.	Dimensions		
	A	B	C
A2549H-2P	2.54	7.10	5.60
A2549H-3P	5.08	9.64	8.14
A2549H-4P	7.62	12.18	10.68
A2549H-5P	10.16	14.72	13.22
A2549H-6P	12.70	17.26	15.76
A2549H-7P	15.24	19.80	18.30
A2549H-8P	17.78	22.34	20.84
A2549H-9P	20.32	24.88	23.38
A2549H-10P	22.86	27.42	25.92
A2549H-11P	25.40	29.96	28.46
A2549H-12P	27.94	32.50	31.00
A2549H-13P	30.48	35.04	33.54
A2549H-14P	33.02	37.58	36.08
A2549H-15P	35.56	40.12	38.64
A2549H-16P	38.10	42.66	41.16
A2549H-17P	40.64	45.20	43.70
A2549H-18P	43.18	47.74	46.24
A2549H-19P	45.72	50.28	48.78
A2549H-20P	48.26	52.82	51.32
A2549H-21P	50.80	55.36	53.86
A2549H-22P	53.34	57.90	56.40

Unit: mm

A2549HA

2.54mm pitch Housing

Reference Informations:

- *Material:PBT, UL94V-0
- *Suitable A2549-B series Terminal
- *Mates with A2549WV A2549WR A2547WVE A2547WRE series Wafer
- *Color:Black

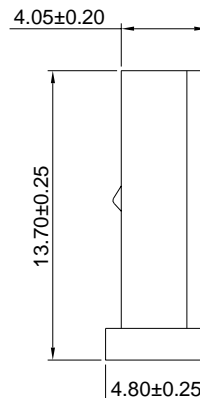
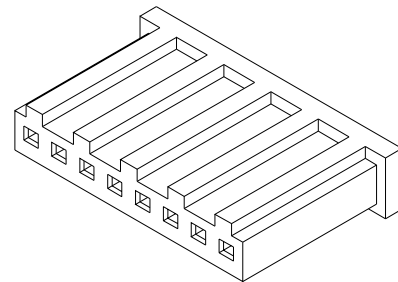
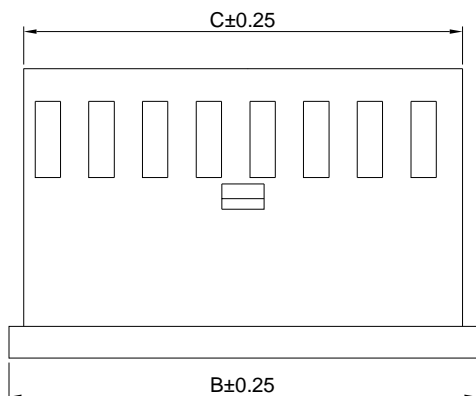
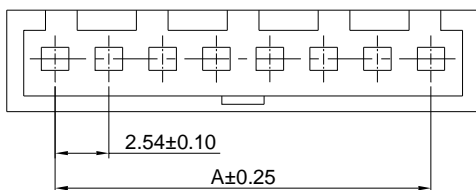

Ordering Information & Dimensions:

PART NO.	Dimensions		
	A	B	C
A2549HA-2P	2.54	7.10	5.60
A2549HA-4P	7.62	12.20	10.68
A2549HA-6P	12.70	17.30	15.76
A2549HA-8P	17.78	22.30	20.84
A2549HA-9P	20.32	24.84	23.38
A2549HA-10P	22.86	27.38	25.92
A2549HA-12P	27.94	32.46	31.00
A2549HA-15P	35.56	41.08	38.62
A2549HA-22P	53.34	58.86	56.40

Unit: mm

A2549 SERIES

2.54mm pitch wire to board connector

A2549HB

2.54mm pitch Single Row Housing

Reference Informations:

- *Material:Nylon 66+15%GF,UL94V-0
- *Suitable A2549-A series Terminal
- *Mates with A2549WVB,A2549WRB series Wafer
- *Color:Blue

Ordering Information:

- A2549HB-XP - **
 1 2
 1.Part No.
 2.Color:
 (blank):Blue
 BK:Black

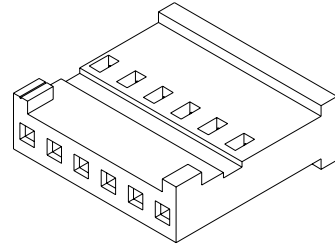
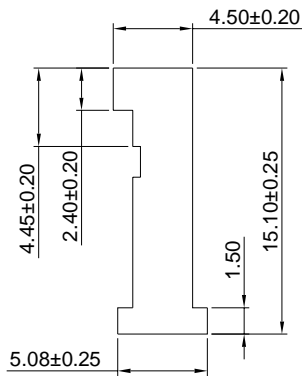
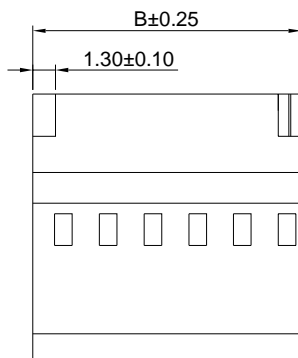
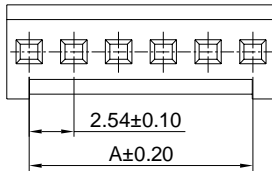

Ordering Information & Dimensions:

PART NO.	Dimensions	
	A	B
A2549HB-2P	2.54	5.08
A2549HB-3P	5.08	7.62
A2549HB-4P	7.62	10.16
A2549HB-5P	10.16	12.70
A2549HB-6P	12.70	15.24
A2549HB-7P	15.24	17.78
A2549HB-8P	17.78	20.32
A2549HB-9P	20.32	22.86
A2549HB-10P	22.86	25.40
A2549HB-12P	27.94	30.48
A2549HB-15P	35.56	38.10
A2549HB-18P	43.18	45.72

Unit: mm

A2549HC

2.54mm pitch Single Row Housing

Reference Informations:

- *Material:PBT,UL94V-0
- *Suitable A2549-C series Terminal
- *Mates with A2541 series Wafer
- *Color:Black

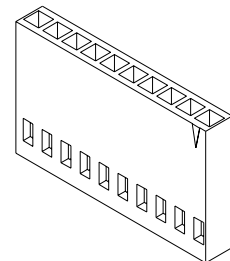
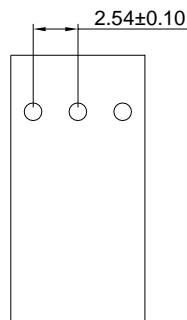
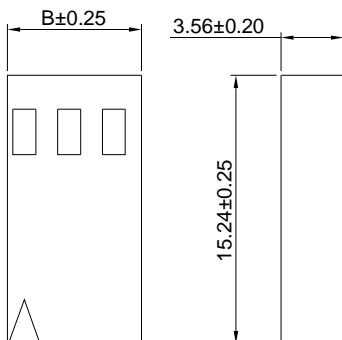
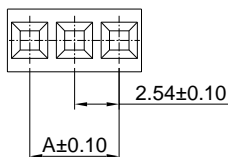

Ordering Information & Dimensions:

PART NO.	Dimensions		PART NO.	Dimensions	
	A	B		A	B
A2549HC-3P	5.08	7.62	A2549HC-20P	48.26	50.80
A2549HC-4P	7.62	10.16	A2549HC-21P	50.80	53.34
A2549HC-5P	10.16	12.70	A2549HC-22P	53.34	55.88
A2549HC-6P	12.70	15.24	A2549HC-23P	55.88	58.42
A2549HC-7P	15.24	17.78	A2549HC-24P	58.42	60.96
A2549HC-8P	17.78	20.32	A2549HC-25P	60.96	63.50
A2549HC-9P	20.32	22.86	A2549HC-26P	63.50	66.04
A2549HC-10P	22.86	25.40	A2549HC-27P	66.04	68.58
A2549HC-11P	25.40	27.94	A2549HC-28P	68.58	71.12
A2549HC-12P	27.94	30.48	A2549HC-29P	71.12	73.66
A2549HC-13P	30.48	33.02	A2549HC-30P	73.66	76.20
A2549HC-14P	33.02	35.56	A2549HC-31P	76.20	78.74
A2549HC-15P	35.56	38.10	A2549HC-32P	78.74	81.28
A2549HC-16P	38.10	40.64	A2549HC-33P	81.28	83.82
A2549HC-17P	40.64	43.18	A2549HC-34P	83.82	86.36
A2549HC-18P	43.18	45.72	A2549HC-35P	86.36	88.90
A2549HC-19P	45.72	48.26	A2549HC-36P	88.90	91.44

Unit: mm

A2549 SERIES

2.54mm pitch wire to board connector

A2549HD

2.54mm pitch Single Row Housing

Reference Informations:

- *Material:PBT,UL94V-0
- *Suitable A2549-C series Terminal
- *Mates with A2547WVF,A2547WRF series Wafer
- *Color:Black

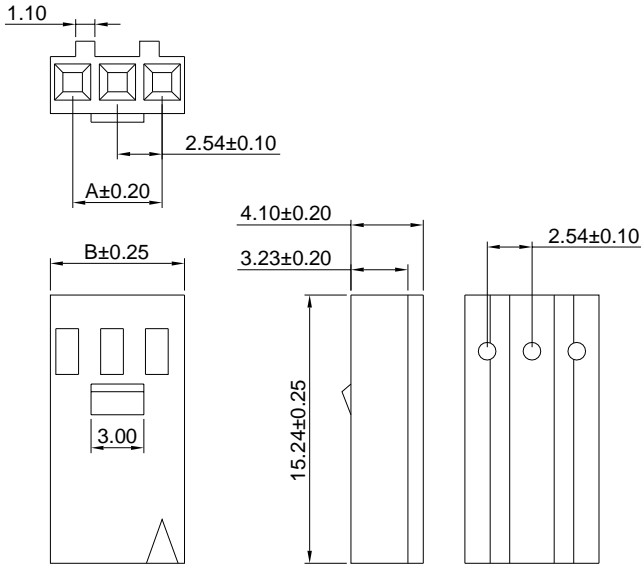
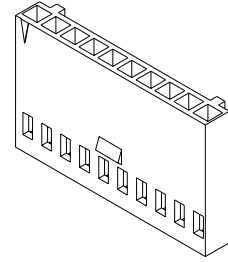

Ordering Information & Dimensions:

PART NO.	Dimensions		PART NO.	Dimensions	
	A	B		A	B
A2549HD-3P	5.08	7.62	A2549HD-20P	48.26	50.80
A2549HD-4P	7.62	10.16	A2549HD-21P	50.80	53.34
A2549HD-5P	10.16	12.70	A2549HD-22P	53.34	55.88
A2549HD-6P	12.70	15.24	A2549HD-23P	55.88	58.42
A2549HD-7P	15.24	17.78	A2549HD-24P	58.42	60.96
A2549HD-8P	17.78	20.32	A2549HD-25P	60.96	63.50
A2549HD-9P	20.32	22.86	A2549HD-26P	63.50	66.04
A2549HD-10P	22.86	25.40	A2549HD-27P	66.04	68.58
A2549HD-11P	25.40	27.94	A2549HD-28P	68.58	71.12
A2549HD-12P	27.94	30.48	A2549HD-29P	71.12	73.66
A2549HD-13P	30.48	33.02	A2549HD-30P	73.66	76.20
A2549HD-14P	33.02	35.56	A2549HD-31P	76.20	78.74
A2549HD-15P	35.56	38.10	A2549HD-32P	78.74	81.28
A2549HD-16P	38.10	40.64	A2549HD-33P	81.28	83.82
A2549HD-17P	40.64	43.18	A2549HD-34P	83.82	86.36
A2549HD-18P	43.18	45.72	A2549HD-35P	86.36	88.90
A2549HD-19P	45.72	48.26	A2549HD-36P	88.90	91.44

Unit: mm

A2549HK

2.54mm pitch Single Row Housing

Reference Informations:

- *Material:PBT,UL94V-0
- *Suitable A2549-K series Terminal
- *Color:Blue

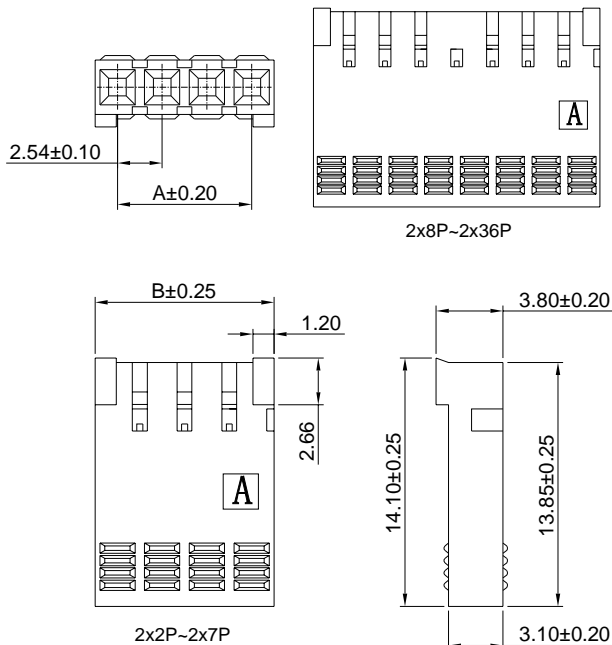
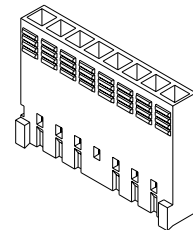

Ordering Information & Dimensions:

PART NO.	Dimensions		PART NO.	Dimensions	
	A	B		A	B
A2549HK-2P	2.54	5.08	A2549HK-20P	48.26	50.80
A2549HK-3P	5.08	7.62	A2549HK-21P	50.80	53.34
A2549HK-4P	7.62	10.16	A2549HK-22P	53.34	55.88
A2549HK-5P	10.16	12.70	A2549HK-23P	55.88	58.42
A2549HK-6P	12.70	15.24	A2549HK-24P	58.42	60.96
A2549HK-7P	15.24	17.78	A2549HK-25P	60.96	63.50
A2549HK-8P	17.78	20.32	A2549HK-26P	63.50	66.04
A2549HK-9P	20.32	22.86	A2549HK-27P	66.04	68.58
A2549HK-10P	22.86	25.40	A2549HK-28P	68.58	71.12
A2549HK-11P	25.40	27.94	A2549HK-29P	71.12	73.66
A2549HK-12P	27.94	30.48	A2549HK-30P	73.66	76.20
A2549HK-13P	30.48	33.02	A2549HK-31P	76.20	78.74
A2549HK-14P	33.02	35.56	A2549HK-32P	78.74	81.28
A2549HK-15P	35.56	38.10	A2549HK-33P	81.28	83.82
A2549HK-16P	38.10	40.64	A2549HK-34P	83.82	86.36
A2549HK-17P	40.64	43.18	A2549HK-35P	86.36	88.90
A2549HK-18P	43.18	45.72	A2549HK-36P	88.90	91.44
A2549HK-19P	45.72	48.26			

Unit: mm

A2549 SERIES

2.54mm pitch wire to board connector

A2549H-2

2.54mm pitch Dual Row Housing

Reference Informations:

- *Material:PBT,UL94V-0
- *Suitable A2549-B series Terminal
- *Mates with A2549WV-2 A2549WR-2 series Wafer
- *Color:Black

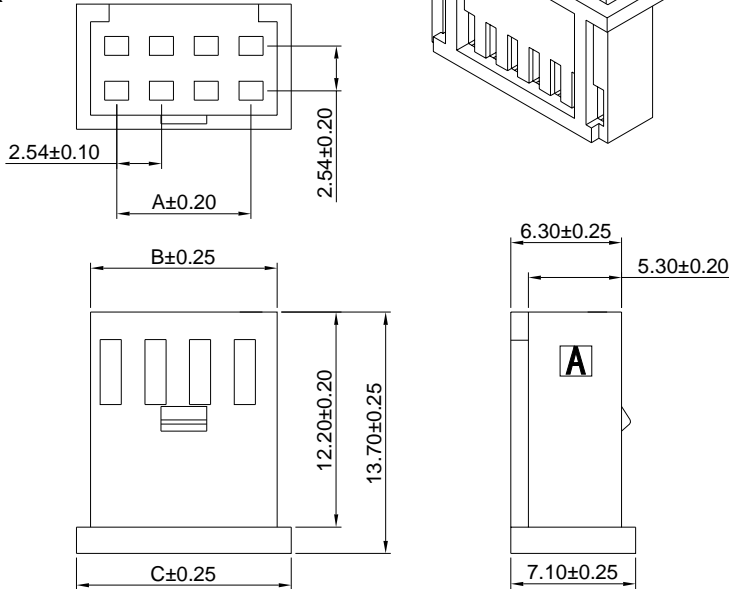

Ordering Information & Dimensions:

PART NO.	Dimensions		
	A	B	C
A2549H-2x2P	2.54	5.60	7.10
A2549H-2x3P	5.08	8.14	9.64
A2549H-2x4P	7.62	10.68	12.18
A2549H-2x5P	10.16	13.22	14.72
A2549H-2x6P	12.70	15.76	17.26
A2549H-2x7P	15.24	18.30	19.80
A2549H-2x8P	17.78	20.84	22.34
A2549H-2x9P	20.32	23.38	24.88
A2549H-2x10P	22.86	25.92	27.42
A2549H-2x11P	25.40	28.46	29.96
A2549H-2x12P	27.94	31.00	32.50
A2549H-2x13P	30.48	33.54	35.04
A2549H-2x14P	33.02	36.08	37.58
A2549H-2x15P	35.56	38.64	40.12
A2549H-2x16P	38.10	41.16	42.66
A2549H-2x17P	40.64	43.70	45.20
A2549H-2x18P	43.18	46.24	47.74
A2549H-2x19P	45.72	48.78	50.28
A2549H-2x20P	48.26	51.32	52.82
A2549H-2x21P	50.80	53.86	55.36
A2549H-2x22P	53.34	56.40	57.90

Unit: mm

A2549HB-2

2.54mm pitch Dual Row Housing

Reference Informations:

- *Material:Nylon 66 ,UL94V-0
- *Suitable A2549-A series Terminal
- *Mates with A2549WVB-2,A2549WRB-2 series Wafer
- *Color:Blue

Ordering Information:

A2549HB-2xXP - **
1 2

- 1.Part No.
- 2.Color:
(blank):Blue
BK:Black

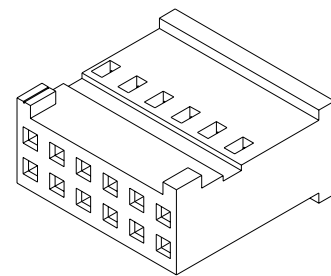
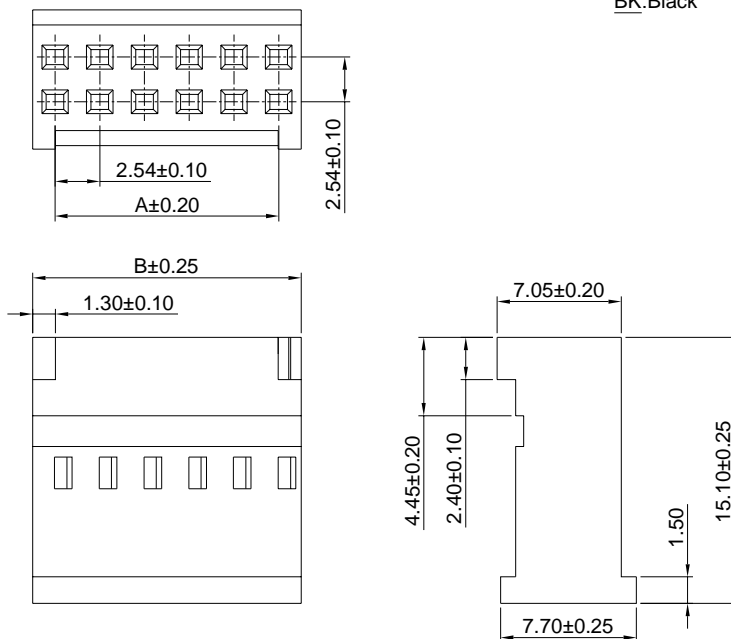

Ordering Information & Dimensions:

PART NO.	Dimensions	
	A	B
A2549HB-2x3P	5.08	7.62
A2549HB-2x4P	7.62	10.16
A2549HB-2x5P	10.16	12.70
A2549HB-2x6P	12.70	15.24
A2549HB-2x7P	15.24	17.78
A2549HB-2x8P	17.78	20.32
A2549HB-2x9P	20.32	22.86
A2549HB-2x10P	22.86	25.40
A2549HB-2x12P	27.94	30.48
A2549HB-2x15P	35.56	38.10
A2549HB-2x18P	43.18	45.72

Unit: mm

A2549 SERIES

2.54mm pitch wire to board connector

A2549HC-2

2.54mm pitch Dual Row Housing

Reference Informations:

- *Material:PBT,UL94V-0
- *Suitable A2549-C series Terminal
- *Color:Black

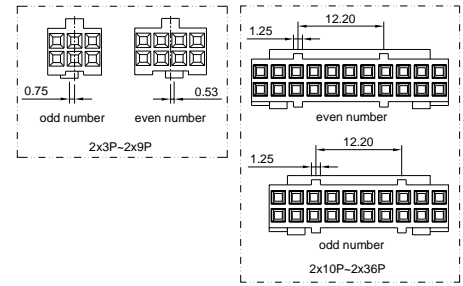
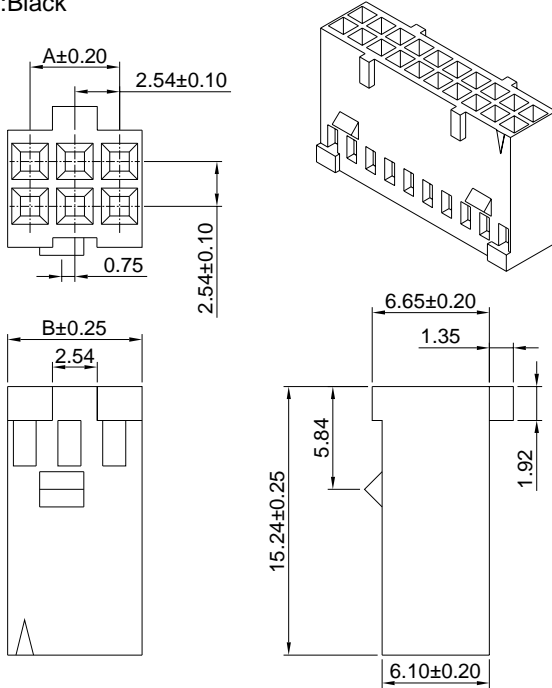

Ordering Information & Dimensions:

PART NO.	Dimensions		PART NO.	Dimensions	
	A	B		A	B
A2549HC-2x3P	5.08	7.62	A2549HC-2x20P	48.26	50.80
A2549HC-2x4P	7.62	10.16	A2549HC-2x21P	50.80	53.34
A2549HC-2x5P	10.16	12.70	A2549HC-2x22P	53.34	55.88
A2549HC-2x6P	12.70	15.24	A2549HC-2x23P	55.88	58.42
A2549HC-2x7P	15.24	17.78	A2549HC-2x24P	58.42	60.96
A2549HC-2x8P	17.78	20.32	A2549HC-2x25P	60.96	63.50
A2549HC-2x9P	20.32	22.86	A2549HC-2x26P	63.50	66.04
A2549HC-2x10P	22.86	25.40	A2549HC-2x27P	66.04	68.58
A2549HC-2x11P	25.40	27.94	A2549HC-2x28P	68.58	71.12
A2549HC-2x12P	27.94	30.48	A2549HC-2x29P	71.12	73.66
A2549HC-2x13P	30.48	33.02	A2549HC-2x30P	73.66	76.20
A2549HC-2x14P	33.02	35.56	A2549HC-2x31P	76.20	78.74
A2549HC-2x15P	35.56	38.10	A2549HC-2x32P	78.74	81.28
A2549HC-2x16P	38.10	40.64	A2549HC-2x33P	81.28	83.82
A2549HC-2x17P	40.64	43.18	A2549HC-2x34P	83.82	86.36
A2549HC-2x18P	43.18	45.72	A2549HC-2x35P	86.36	88.90
A2549HC-2x19P	45.72	48.26	A2549HC-2x36P	88.90	91.44

Unit: mm

A2549HD-2

2.54mm pitch Dual Row Housing

Reference Informations:

- *Material:PBT,UL94V-0
- *Suitable A2549-C series Terminal
- *Color:Black

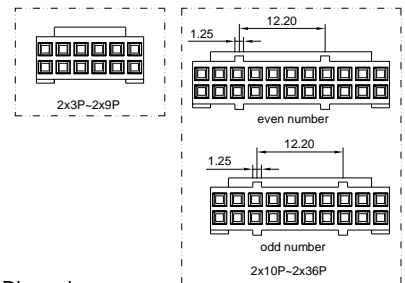
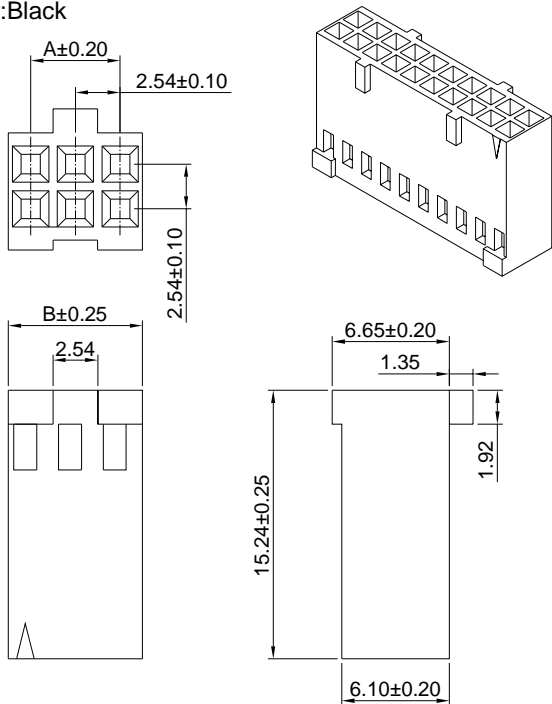

Ordering Information & Dimensions:

PART NO.	Dimensions		PART NO.	Dimensions	
	A	B		A	B
A2549HD-2x3P	5.08	7.62	A2549HD-2x20P	48.26	50.80
A2549HD-2x4P	7.62	10.16	A2549HD-2x21P	50.80	53.34
A2549HD-2x5P	10.16	12.70	A2549HD-2x22P	53.34	55.88
A2549HD-2x6P	12.70	15.24	A2549HD-2x23P	55.88	58.42
A2549HD-2x7P	15.24	17.78	A2549HD-2x24P	58.42	60.96
A2549HD-2x8P	17.78	20.32	A2549HD-2x25P	60.96	63.50
A2549HD-2x9P	20.32	22.86	A2549HD-2x26P	63.50	66.04
A2549HD-2x10P	22.86	25.40	A2549HD-2x27P	66.04	68.58
A2549HD-2x11P	25.40	27.94	A2549HD-2x28P	68.58	71.12
A2549HD-2x12P	27.94	30.48	A2549HD-2x29P	71.12	73.66
A2549HD-2x13P	30.48	33.02	A2549HD-2x30P	73.66	76.20
A2549HD-2x14P	33.02	35.56	A2549HD-2x31P	76.20	78.74
A2549HD-2x15P	35.56	38.10	A2549HD-2x32P	78.74	81.28
A2549HD-2x16P	38.10	40.64	A2549HD-2x33P	81.28	83.82
A2549HD-2x17P	40.64	43.18	A2549HD-2x34P	83.82	86.36
A2549HD-2x18P	43.18	45.72	A2549HD-2x35P	86.36	88.90
A2549HD-2x19P	45.72	48.26	A2549HD-2x36P	88.90	91.44

Unit: mm

A2549 SERIES

2.54mm pitch wire to board connector

A2549HE-2

2.54mm pitch Dual Row Housing

Reference Informations:

- *Material:PBT,UL94V-0
- *Suitable A2549-C series Terminal
- *Mates with A2541series Wafer
- *Color:Black

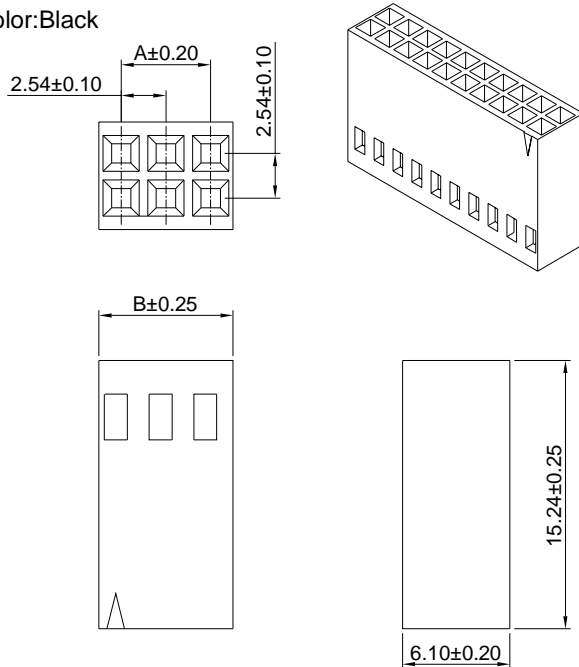

Ordering Information & Dimensions:

PART NO.	Dimensions		PART NO.	Dimensions	
	A	B		A	B
A2549HE-2x3P	5.08	7.62	A2549HE-2x20P	48.26	50.80
A2549HE-2x4P	7.62	10.16	A2549HE-2x21P	50.80	53.34
A2549HE-2x5P	10.16	12.70	A2549HE-2x22P	53.34	55.88
A2549HE-2x6P	12.70	15.24	A2549HE-2x23P	55.88	58.42
A2549HE-2x7P	15.24	17.78	A2549HE-2x24P	58.42	60.96
A2549HE-2x8P	17.78	20.32	A2549HE-2x25P	60.96	63.50
A2549HE-2x9P	20.32	22.86	A2549HE-2x26P	63.50	66.04
A2549HE-2x10P	22.86	25.40	A2549HE-2x27P	66.04	68.58
A2549HE-2x11P	25.40	27.94	A2549HE-2x28P	68.58	71.12
A2549HE-2x12P	27.94	30.48	A2549HE-2x29P	71.12	73.66
A2549HE-2x13P	30.48	33.02	A2549HE-2x30P	73.66	76.20
A2549HE-2x14P	33.02	35.56	A2549HE-2x31P	76.20	78.74
A2549HE-2x15P	35.56	38.10	A2549HE-2x32P	78.74	81.28
A2549HE-2x16P	38.10	40.64	A2549HE-2x33P	81.28	83.82
A2549HE-2x17P	40.64	43.18	A2549HE-2x34P	83.82	86.36
A2549HE-2x18P	43.18	45.72	A2549HE-2x35P	86.36	88.90
A2549HE-2x19P	45.72	48.26	A2549HE-2x36P	88.90	91.44

Unit: mm

A2549HG-2

2.54mm pitch Dual Row Housing

Reference Informations:

- *Material:PBT,UL94V-0
- *Suitable A2549-C series Terminal
- *Mates with A2541series Wafer
- *Color:Black

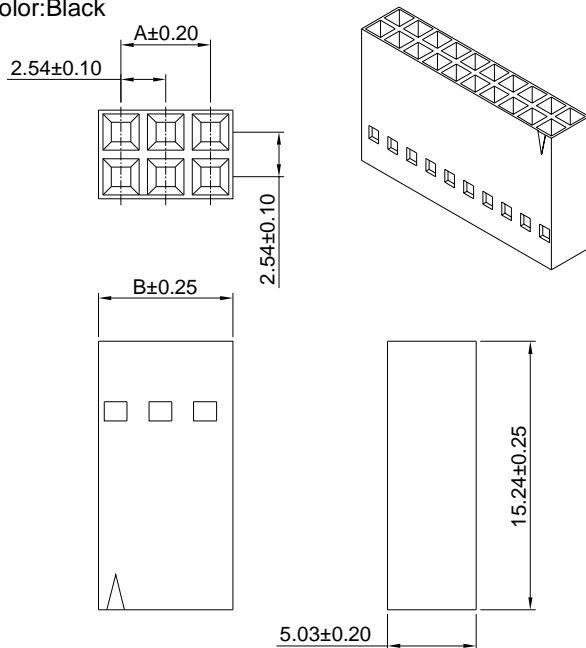

Ordering Information & Dimensions:

PART NO.	Dimensions		PART NO.	Dimensions	
	A	B		A	B
A2549HG-2x3P	5.08	7.62	A2549HG-2x20P	48.26	50.80
A2549HG-2x4P	7.62	10.16	A2549HG-2x21P	50.80	53.34
A2549HG-2x5P	10.16	12.70	A2549HG-2x22P	53.34	55.88
A2549HG-2x6P	12.70	15.24	A2549HG-2x23P	55.88	58.42
A2549HG-2x7P	15.24	17.78	A2549HG-2x24P	58.42	60.96
A2549HG-2x8P	17.78	20.32	A2549HG-2x25P	60.96	63.50
A2549HG-2x9P	20.32	22.86	A2549HG-2x26P	63.50	66.04
A2549HG-2x10P	22.86	25.40	A2549HG-2x27P	66.04	68.58
A2549HG-2x11P	25.40	27.94	A2549HG-2x28P	68.58	71.12
A2549HG-2x12P	27.94	30.48	A2549HG-2x29P	71.12	73.66
A2549HG-2x13P	30.48	33.02	A2549HG-2x30P	73.66	76.20
A2549HG-2x14P	33.02	35.56	A2549HG-2x31P	76.20	78.74
A2549HG-2x15P	35.56	38.10	A2549HG-2x32P	78.74	81.28
A2549HG-2x16P	38.10	40.64	A2549HG-2x33P	81.28	83.82
A2549HG-2x17P	40.64	43.18	A2549HG-2x34P	83.82	86.36
A2549HG-2x18P	43.18	45.72	A2549HG-2x35P	86.36	88.90
A2549HG-2x19P	45.72	48.26	A2549HG-2x36P	88.90	91.44

Unit: mm

A2549 SERIES

2.54mm pitch wire to board connector

A2549HG-N-2

2.54mm pitch Dual Row Housing

Reference Informations:

- *Material:PBT,UL94V-0
- *Suitable A2549-C series Terminal
- *Mates with A2547WV-N-2 A2547WR-N-2 series Wafer
- *Color:Black

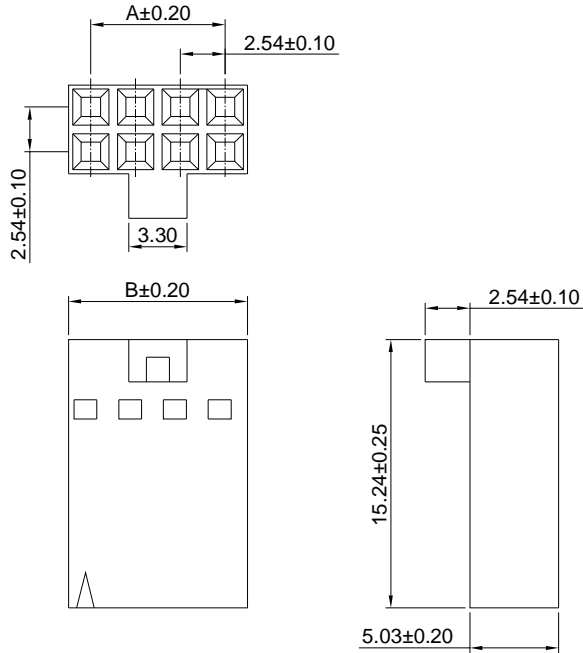
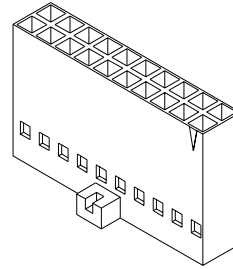

Ordering Information & Dimensions:

PART NO.	Dimensions		PART NO.	Dimensions	
	A	B		A	B
A2549HG-N-2x3P	5.08	7.62	A2549HG-N-2x20P	48.26	50.80
A2549HG-N-2x4P	7.62	10.16	A2549HG-N-2x21P	50.80	53.34
A2549HG-N-2x5P	10.16	12.70	A2549HG-N-2x22P	53.34	55.88
A2549HG-N-2x6P	12.70	15.24	A2549HG-N-2x23P	55.88	58.42
A2549HG-N-2x7P	15.24	17.78	A2549HG-N-2x24P	58.42	60.96
A2549HG-N-2x8P	17.78	20.32	A2549HG-N-2x25P	60.96	63.50
A2549HG-N-2x9P	20.32	22.86	A2549HG-N-2x26P	63.50	66.04
A2549HG-N-2x10P	22.86	25.40	A2549HG-N-2x27P	66.04	68.58
A2549HG-N-2x11P	25.40	27.94	A2549HG-N-2x28P	68.58	71.12
A2549HG-N-2x12P	27.94	30.48	A2549HG-N-2x29P	71.12	73.66
A2549HG-N-2x13P	30.48	33.02	A2549HG-N-2x30P	73.66	76.20
A2549HG-N-2x14P	33.02	35.56	A2549HG-N-2x31P	76.20	78.74
A2549HG-N-2x15P	35.56	38.10	A2549HG-N-2x32P	78.74	81.28
A2549HG-N-2x16P	38.10	40.64	A2549HG-N-2x33P	81.28	83.82
A2549HG-N-2x17P	40.64	43.18	A2549HG-N-2x34P	83.82	86.36
A2549HG-N-2x18P	43.18	45.72	A2549HG-N-2x35P	86.36	88.90
A2549HG-N-2x19P	45.72	48.26	A2549HG-N-2x36P	88.90	91.44

Unit: mm

A2549HK-2

2.54mm pitch Dual Row Housing

Reference Informations:

- *Material:PBT,UL94V-0
- *Suitable A2549-K series Terminal
- *Color:Blue

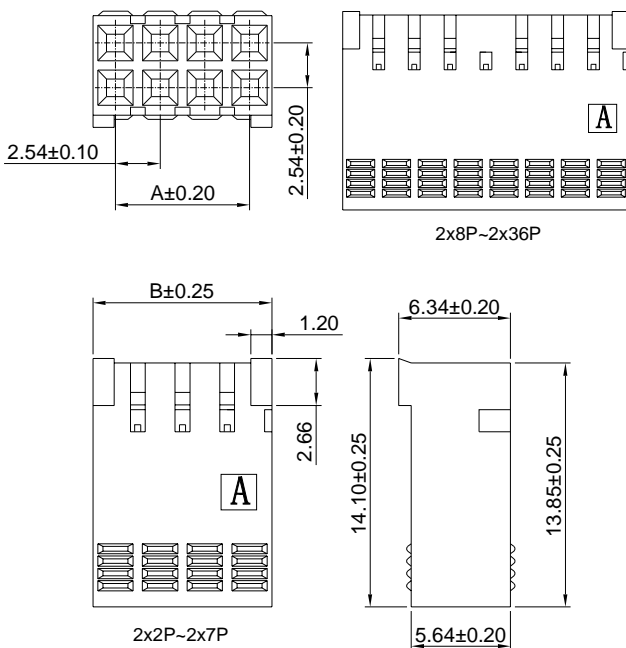
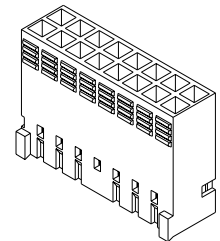

Ordering Information & Dimensions:

PART NO.	Dimensions		PART NO.	Dimensions	
	A	B		A	B
A2549HK-2x3P	5.08	7.62	A2549HK-2x20P	48.26	50.80
A2549HK-2x4P	7.62	10.16	A2549HK-2x21P	50.80	53.34
A2549HK-2x5P	10.16	12.70	A2549HK-2x22P	53.34	55.88
A2549HK-2x6P	12.70	15.24	A2549HK-2x23P	55.88	58.42
A2549HK-2x7P	15.24	17.78	A2549HK-2x24P	58.42	60.96
A2549HK-2x8P	17.78	20.32	A2549HK-2x25P	60.96	63.50
A2549HK-2x9P	20.32	22.86	A2549HK-2x26P	63.50	66.04
A2549HK-2x10P	22.86	25.40	A2549HK-2x27P	66.04	68.58
A2549HK-2x11P	25.40	27.94	A2549HK-2x28P	68.58	71.12
A2549HK-2x12P	27.94	30.48	A2549HK-2x29P	71.12	73.66
A2549HK-2x13P	30.48	33.02	A2549HK-2x30P	73.66	76.20
A2549HK-2x14P	33.02	35.56	A2549HK-2x31P	76.20	78.74
A2549HK-2x15P	35.56	38.10	A2549HK-2x32P	78.74	81.28
A2549HK-2x16P	38.10	40.64	A2549HK-2x33P	81.28	83.82
A2549HK-2x17P	40.64	43.18	A2549HK-2x34P	83.82	86.36
A2549HK-2x18P	43.18	45.72	A2549HK-2x35P	86.36	88.90
A2549HK-2x19P	45.72	48.26	A2549HK-2x36P	88.90	91.44

Unit: mm

A2549 SERIES

2.54mm pitch wire to board connector

A2549WV

2.54mm pitch Single Row 180° Wafer

Reference Informations:

- *Material:Pin:Brass/Tin over Nickel
Insulator:PBT , UL94V-0
- *Mates with A2549H A2550H-C series Housing
- *Nylon 6T is available
- *Color:Black

Ordering Information:

- A2549WV-XP -**
- 1 2
- 1.Part No.
 - 2.Finish
(Blank)-Tin Over Nickel
G-Gold Over Nickel

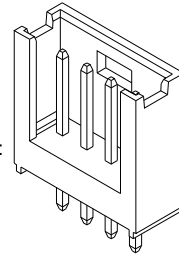

Ordering Information & Dimensions:

PART NO.	Dimensions	
	A	B
A2549WV-2P	2.54	7.62
A2549WV-3P	7.62	10.16
A2549WV-4P	10.16	12.70
A2549WV-5P	12.70	15.24
A2549WV-6P	15.24	17.78
A2549WV-7P	17.78	20.32
A2549WV-8P	20.32	22.86
A2549WV-9P	22.86	25.40
A2549WV-10P	25.40	27.94
A2549WV-11P	27.94	30.48
A2549WV-12P	30.48	33.02
A2549WV-13P	33.02	35.56
A2549WV-14P	35.56	38.10
A2549WV-15P	38.10	40.64
A2549WV-16P	40.64	43.18
A2549WV-17P	43.18	45.72
A2549WV-18P	45.72	48.26
A2549WV-19P	48.26	50.80
A2549WV-20P	50.80	53.34
A2549WV-21P	53.34	55.88
A2549WV-22P	55.88	58.42

Unit: mm

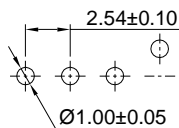
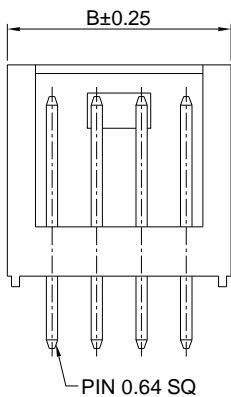
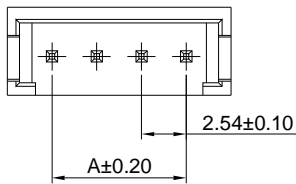

P.C.B LAYOUT

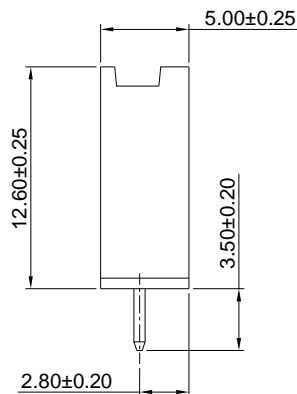

A2549WR

2.54mm pitch Single Row 90° Wafer

Reference Informations:

- *Material:Pin:Brass/Tin over Nickel
Insulator:PBT , UL94V-0
- *Mates with A2549H A2550H-C series Housing
- *Nylon 6T is available
- *Color:Black

Ordering Information:

- A2549WR-XP -**
- 1 2
- 1.Part No.
 - 2.Finish
(Blank)-Tin Over Nickel
G-Gold Over Nickel

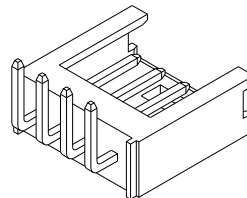

Ordering Information & Dimensions:

PART NO.	Dimensions	
	A	B
A2549WR-2P	2.54	7.62
A2549WR-3P	7.62	10.16
A2549WR-4P	10.16	12.70
A2549WR-5P	12.70	15.24
A2549WR-6P	15.24	17.78
A2549WR-7P	17.78	20.32
A2549WR-8P	20.32	22.86
A2549WR-9P	22.86	25.40
A2549WR-10P	25.40	27.94
A2549WR-11P	27.94	30.48
A2549WR-12P	30.48	33.02
A2549WR-13P	33.02	35.56
A2549WR-14P	35.56	38.10
A2549WR-15P	38.10	40.64
A2549WR-16P	40.64	43.18
A2549WR-17P	43.18	45.72
A2549WR-18P	45.72	48.26
A2549WR-19P	48.26	50.80
A2549WR-20P	50.80	53.34
A2549WR-21P	53.34	55.88
A2549WR-22P	55.88	58.42

Unit: mm

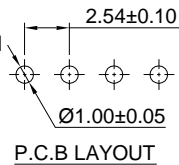
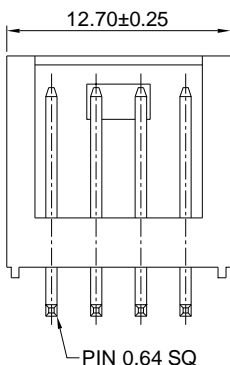
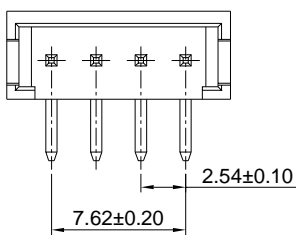

P.C.B LAYOUT

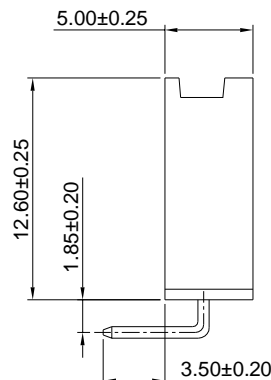

A2549 SERIES

2.54mm pitch wire to board connector

A2549WV-2

2.54mm pitch Dual Row 180° Wafer

Reference Informations:

- *Material:Pin:Brass/Tin over Nickel
Insulator:PBT , UL94V-0
- *Mates with A2549H-2 series Housing
- *Color:Black

Ordering Information:

A2549WV-2xXP -**
1 2

- 1.Part No.
- 2.Finish
(Blank)-Tin Over Nickel
G-Gold Over Nickel

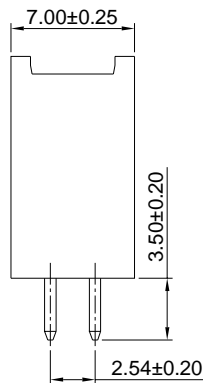
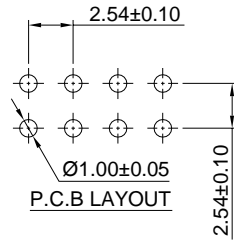
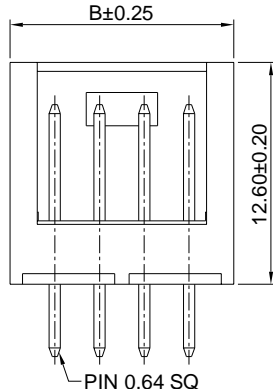
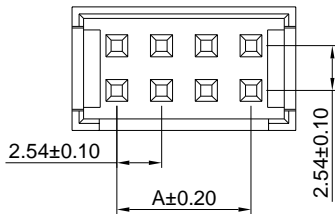
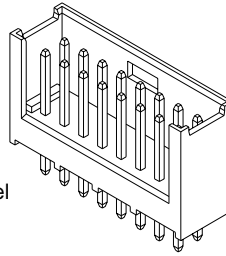

Ordering Information & Dimensions:

PART NO.	Dimensions	
	A	B
A2549WV-2x2P	2.54	7.62
A2549WV-2x3P	7.62	10.16
A2549WV-2x4P	10.16	12.70
A2549WV-2x5P	12.70	15.24
A2549WV-2x6P	15.24	17.78
A2549WV-2x7P	17.78	20.32
A2549WV-2x8P	20.32	22.86
A2549WV-2x9P	22.86	25.40
A2549WV-2x10P	25.40	27.94
A2549WV-2x11P	27.94	30.48
A2549WV-2x12P	30.48	33.02
A2549WV-2x13P	33.02	35.56
A2549WV-2x14P	35.56	38.10
A2549WV-2x15P	38.10	40.64
A2549WV-2x16P	40.64	43.18
A2549WV-2x17P	43.18	45.72
A2549WV-2x18P	45.72	48.26
A2549WV-2x19P	48.26	50.80
A2549WV-2x20P	50.80	53.34
A2549WV-2x21P	53.34	55.88
A2549WV-2x22P	55.88	58.42

Unit: mm

A2549WR-2

2.54mm pitch Dual Row 90° Wafer

Reference Informations:

- *Material:Pin:Brass/Tin over Nickel
Insulator:PBT , UL94V-0
- *Mates with A2549H-2 series Housing
- *Color:Black

Ordering Information:

A2549WR-2xXP -**
1 2

- 1.Part No.
- 2.Finish
(Blank)-Tin Over Nickel
G-Gold Over Nickel

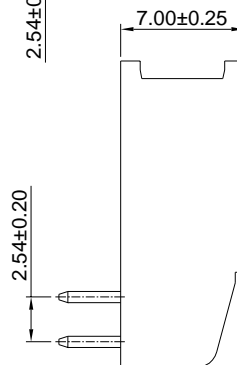
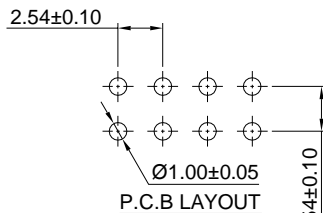
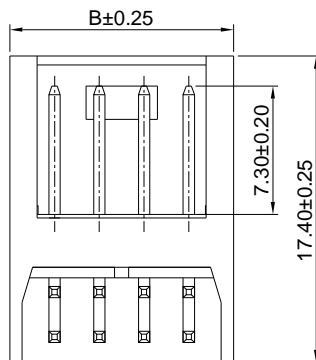
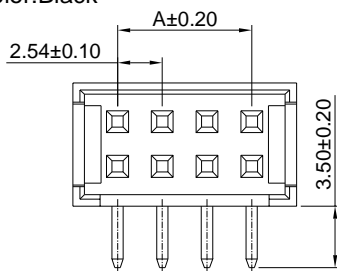
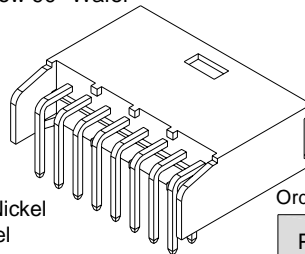

Ordering Information & Dimensions:

PART NO.	Dimensions	
	A	B
A2549WR-2x2P	2.54	7.62
A2549WR-2x3P	7.62	10.16
A2549WR-2x4P	10.16	12.70
A2549WR-2x5P	12.70	15.24
A2549WR-2x6P	15.24	17.78
A2549WR-2x7P	17.78	20.32
A2549WR-2x8P	20.32	22.86
A2549WR-2x9P	22.86	25.40
A2549WR-2x10P	25.40	27.94
A2549WR-2x11P	27.94	30.48
A2549WR-2x12P	30.48	33.02
A2549WR-2x13P	33.02	35.56
A2549WR-2x14P	35.56	38.10
A2549WR-2x15P	38.10	40.64
A2549WR-2x16P	40.64	43.18
A2549WR-2x17P	43.18	45.72
A2549WR-2x18P	45.72	48.26
A2549WR-2x19P	48.26	50.80
A2549WR-2x20P	50.80	53.34
A2549WR-2x21P	53.34	55.88
A2549WR-2x22P	55.88	58.42

Unit: mm

A2549 SERIES

2.54mm pitch wire to board connector

A2549WVB

2.54mm pitch Single Row 180° Wafer

Reference Informations:

- *Material:Pin:Brass/Tin over Nickel
Insulator:Nylon 66 ,UL94V-0
- *Mates with A2549HB A2550HA series Housing
- *Color:Blue

Ordering Information:
A2549WVB-XP -**_**

- | | | |
|---|---|---|
| 1 | 2 | 3 |
|---|---|---|
- 1.Part No.
 - 2.Color:
(blank):Blue
BK:Black
 - 3.Finish
(Blank)-Tin Over Nickel
G-Gold Over Nickel

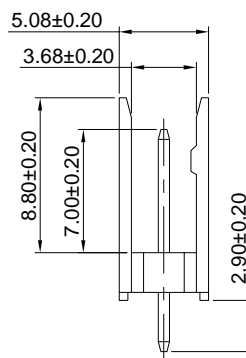
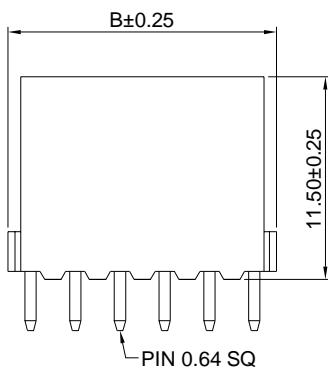
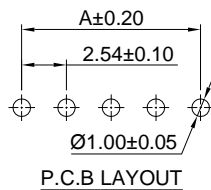
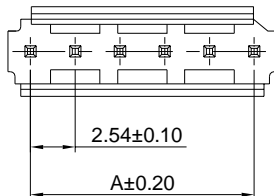
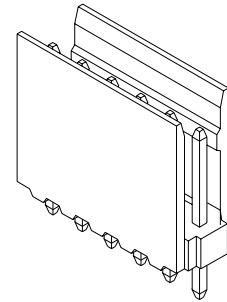

Ordering Information & Dimensions:

PART NO.	Dimensions	
	A	B
A2549WVB-2P	2.54	5.08
A2549WVB-3P	5.08	7.62
A2549WVB-4P	7.62	10.16
A2549WVB-5P	10.16	12.70
A2549WVB-6P	12.70	15.24
A2549WVB-7P	15.24	17.78
A2549WVB-8P	17.78	20.32
A2549WVB-10P	22.86	25.40
A2549WVB-12P	27.94	30.48
A2549WVB-15P	35.56	38.10
A2549WVB-17P	40.64	43.18
A2549WVB-18P	43.18	45.72

Unit: mm

A2549WRB

2.54mm pitch Single Row 90° Wafer

Reference Informations:

- *Material:Pin:Brass/Tin over Nickel
Insulator:Nylon 66 ,UL94V-0
- *Mates with A2549HB A2550HA series Housing
- *Color:Blue

Ordering Information:
A2549WRB-XP - **_**

- | | | |
|---|---|---|
| 1 | 2 | 3 |
|---|---|---|
- 1.Part No.
 - 2.Color:
(blank):Blue
BK:Black
 - 3.Finish
(Blank)-Tin Over Nickel
G-Gold Over Nickel

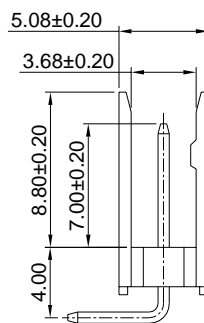
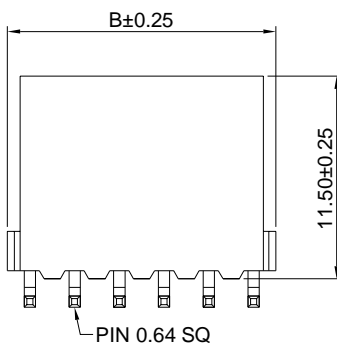
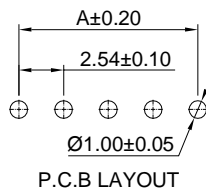
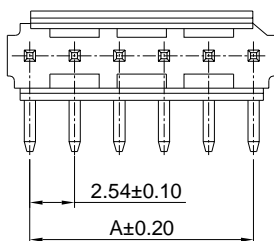
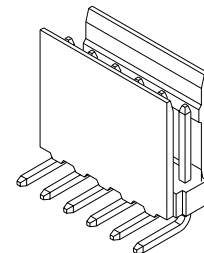

Ordering Information & Dimensions:

PART NO.	Dimensions	
	A	B
A2549WRB-2P	2.54	5.08
A2549WRB-3P	5.08	7.62
A2549WRB-4P	7.62	10.16
A2549WRB-5P	10.16	12.70
A2549WRB-6P	12.70	15.24
A2549WRB-7P	15.24	17.78
A2549WRB-8P	17.78	20.32
A2549WRB-10P	22.86	25.40
A2549WRB-12P	27.94	30.48
A2549WRB-15P	35.56	38.10
A2549WRB-17P	40.64	43.18
A2549WRB-18P	43.18	45.72

Unit: mm

A2549 SERIES

2.54mm pitch wire to board connector

A2549WVB-2

2.54mm pitch Dual Row 180° Wafer

Reference Informations:

- *Material:Pin:Brass/Tin over Nickel
Insulator:Nylon 66 ,UL94V-0
- *Mates with A2549HB-2 A2550HA-2 series Housing
- *Color:Blue

Ordering Information:

A2549WVB-2xXP - **/**

- 1.Part No.
- 2.Color:
(blank):Blue
BK:Black
- 3.Finish
(Blank)-Tin Over Nickel
G-Gold Over Nickel

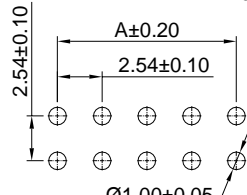
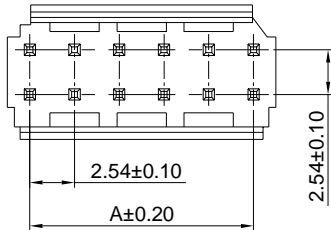
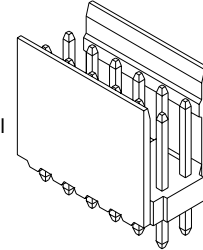

P.C.B LAYOUT

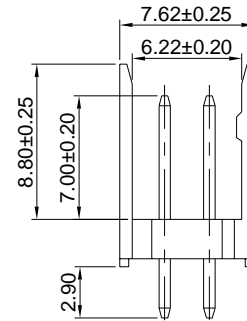
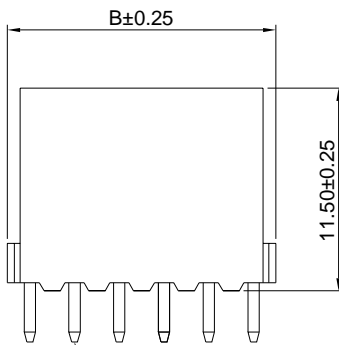

Ordering Information & Dimensions:

PART NO.	Dimensions	
	A	B
A2549WVB-2x2P	2.54	5.08
A2549WVB-2x3P	5.08	7.62
A2549WVB-2x4P	7.62	10.16
A2549WVB-2x5P	10.16	12.70
A2549WVB-2x6P	12.70	15.24
A2549WVB-2x7P	15.24	17.78
A2549WVB-2x8P	17.78	20.32
A2549WVB-2x10P	22.86	25.40
A2549WVB-2x12P	27.94	30.48
A2549WVB-2x15P	35.56	38.10
A2549WVB-2x17P	40.64	43.18
A2549WVB-2x18P	43.18	45.72

Unit: mm

A2549WRB-2

2.54mm pitch Dual Row 90° Wafer

Reference Informations:

- *Material:Pin:Brass/Tin over Nickel
Insulator:Nylon 66 ,UL94V-0
- *Mates with A2549HB-2 A2550HA-2 series Housing
- *Color:Blue

Ordering Information:

A2549WRB-2xXP - **/**

- 1.Part No.
- 2.Color:
(blank):Blue
BK:Black
- 3.Finish
(Blank)-Tin Over Nickel
G-Gold Over Nickel

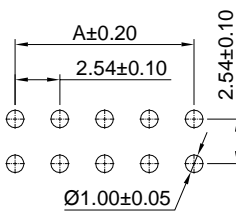
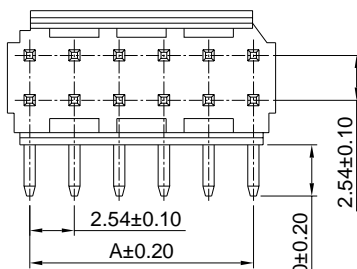
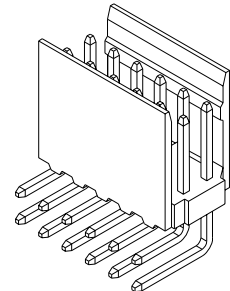

P.C.B LAYOUT

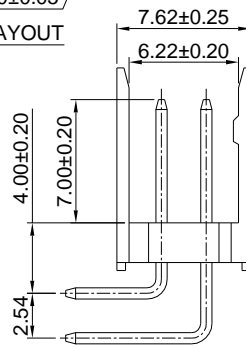
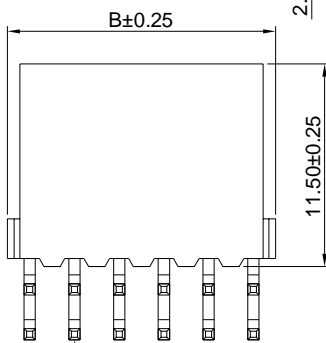

Ordering Information & Dimensions:

PART NO.	Dimensions	
	A	B
A2549WRB-2x2P	2.54	5.08
A2549WRB-2x3P	5.08	7.62
A2549WRB-2x4P	7.62	10.16
A2549WRB-2x5P	10.16	12.70
A2549WRB-2x6P	12.70	15.24
A2549WRB-2x7P	15.24	17.78
A2549WRB-2x8P	17.78	20.32
A2549WRB-2x10P	22.86	25.40
A2549WRB-2x12P	27.94	30.48
A2549WRB-2x15P	35.56	38.10
A2549WRB-2x17P	40.64	43.18
A2549WRB-2x18P	43.18	45.72

Unit: mm